



CL SERIES COVE LIGHT



FEATURES / BENEFITS

- ▲ Extremely low energy use
- ▲ Up to 70,000+ hr life
- ▲ Ultra slim design
- ▲ No IR or UV emissions
- ▲ Low maintenance costs
- ▲ Immediate start-up
- ▲ Interior or exterior option

APPLICATIONS

The CL Series is designed for use in a wide range of lighting applications, especially areas which benefit from its ultra slim profile, low energy and long operating life. Designed around the latest LED technology, the CL series represents true innovation in lighting, delivered in a package which blends seamlessly into its surroundings. Sample applications include, but not limited to: Cove and cornice lighting, shelf lighting, integrated into furniture, under counters, stair hand rails, display cases, task lighting.

OPERATING CONDITIONS

- ▲ Ambient temperature -20C° to +55C° (-4°F to +131°F)
- ▲ Recommended input current 350mA

MECHANICAL DIMENSIONS

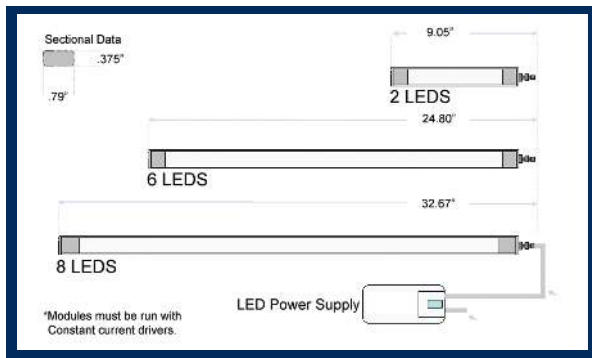

MATERIALS/FINISH

- ▲ Anodized Aluminum

MOUNTING INFORMATION

- ▲ Each module supplied with 108 inch (3M) of cable pre-wired with bare ends
- ▲ Mounting spring clips included.

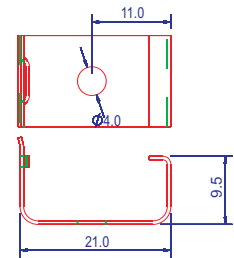

2 supplied per module

Matl: Spring Steel Bright Zinc Plated

Length Inches [mm]	LEDS	Power Consumption (Watts) Typ.	Cable Diameter Inches [mm]	Light Output (Lumens) Typ.
9" [230 mm]	2	2.4W	.16 [4]	80
25" [630 mm]	6	7.2W	.16 [4]	240
33" [830 mm]	8	9.6W	.16 [4]	320

PRIVATE LABEL
OEM PROGRAM



PRELIMINARY

Dialight reserves the right to make changes at any time in order to supply the best product possible.

Contact us directly for the latest information.

Dialight Corporation

1501 Route 34 South • Farmingdale, NJ 07727 USA

Tel: (1) 732-919-3119 • Fax: (1) 732-751-5778 • www.dialight.com



MDEXLUMCL_2

9" (230 MM)

Interior			Exterior (IP-67 rated)		
Part Number	Length Inches [mm]	Color	Part Number	Length Inches [mm]	Color
CL-230-W	9.05 [230]	White	CL-230-W-IP	9.05 [230]	White
CL-230-WW	9.05 [230]	Warm White	CL-230-WW-IP	9.05 [230]	Warm White
CL-230-B	9.05 [230]	Blue	CL-230-B-IP	9.05 [230]	Blue
CL-230-G	9.05 [230]	Green	CL-230-G-IP	9.05 [230]	Green
CL-230-R	9.05 [230]	Red	CL-230-R-IP	9.05 [230]	Red
CL-230-A	9.05 [230]	Amber	CL-230-A-IP	9.05 [230]	Amber

25" (630 MM)

Interior			Exterior (IP-67 rated)		
Part Number	Length Inches [mm]	Color	Part Number	Length Inches [mm]	Color
CL-630-W	24.80 [630]	White	CL-630-W-IP	24.80 [630]	White
CL-630-WW	24.80 [630]	Warm White	CL-630-WW-IP	24.80 [630]	Warm White
CL-630-B	24.80 [630]	Blue	CL-630-B-IP	24.80 [630]	Blue
CL-630-G	24.80 [630]	Green	CL-630-G-IP	24.80 [630]	Green
CL-630-R	24.80 [630]	Red	CL-630-R-IP	24.80 [630]	Red
CL-630-A	24.80 [630]	Amber	CL-630-A-IP	24.80 [630]	Amber

33" (830 MM)

Interior			Exterior (IP-67 rated)		
Part Number	Length Inches [mm]	Color	Part Number	Length Inches [mm]	Color
CL-830-W	32.7 [830]	White	CL-830-W-IP	32.7 [830]	White
CL-830-WW	32.7 [830]	Warm White	CL-830-WW-IP	32.7 [830]	Warm White
CL-830-B	32.7 [830]	Blue	CL-830-B-IP	32.7 [830]	Blue
CL-830-G	32.7 [830]	Green	CL-830-G-IP	32.7 [830]	Green
CL-830-R	32.7 [830]	Red	CL-830-R-IP	32.7 [830]	Red
CL-830-A	32.7 [830]	Amber	CL-830-A-IP	32.7 [830]	Amber

**PRIVATE LABEL
OEM PROGRAM**



PRELIMINARY

Dialight reserves the right to make changes at any time
in order to supply the best product possible.

Contact us directly for the latest information.

Dialight Corporation

1501 Route 34 South • Farmingdale, NJ 07727 USA

Tel: (1) 732-919-3119 • Fax: (1) 732-751-5778 • www.dialight.com



MDEXLUMCL_2