

PART NUMBER	NO. OF POS.	A±.008[0.20]		B±.008[0.20]		C±.015[0.38]		F+.005[0.13] -.015[0.38]	
		IN	MM	IN	MM	IN	MM	IN	MM
_C03DREN-S268	3	0.200	5.08	0.400	10.16	0.575	14.61		
_C04DREN-S268	4	0.300	7.62	0.500	12.70	0.675	17.15	0.330	8.38
_C07DREN-S268	7	0.600	15.24	0.800	20.32	0.975	24.77		

REVISIONS				
REV.	ECO. NO	DESCRIPTION	DATE	BY
A	2832	INITIAL RELEASE (OBSOLETE DWG 5285)	8/26/2013	JH

PART NUMBER CODING

C _ **DREN** - **S268**

MATERIALS (INSULATOR/CONTACT)
E = BLUE PBT & PHOSPHOR BRONZE
 OPERATING TEMP: -65°C TO +125°C
 PROCESSING TEMP: WAVE / MANUAL ONLY

R = BROWN PPS & PHOSPHOR BRONZE
 OPERATING TEMP: -65°C TO +125°C
 PROCESSING TEMP: 260°C FOR 120 SEC. MAX.

H = BLUE PBT & BERYLLIUM COPPER
 OPERATING TEMP: -65°C TO +125°C
 PROCESSING TEMP: WAVE / MANUAL ONLY

A = BROWN PPS & BERYLLIUM COPPER
 OPERATING TEMP: -65°C TO +150°C
 PROCESSING TEMP: 260°C FOR 120 SEC. MAX.

NUMBER OF POSITIONS
 (CONTACTS PER ROW)

PLATING
ALL PLATINGS ARE LEAD FREE AND HAVE .000050" MIN NICKEL UNDERPLATE

CONTACT SURFACE	TERMINATION
B = .000010" GOLD	.000100" PURE TIN, MATTE
C = .000030" GOLD	.000100" PURE TIN, MATTE
G = .000010" GOLD	.000005" GOLD
Y = .000030" GOLD	.000005" GOLD
*E = .000100" PURE TIN, MATTE, OVERALL	
S = .000010" GOLD OVERALL	
M = .000030" GOLD	.000010" GOLD OVERALL

*OVERALL TIN ONLY AVAILABLE ON MATERIAL CODES E OR R ONLY

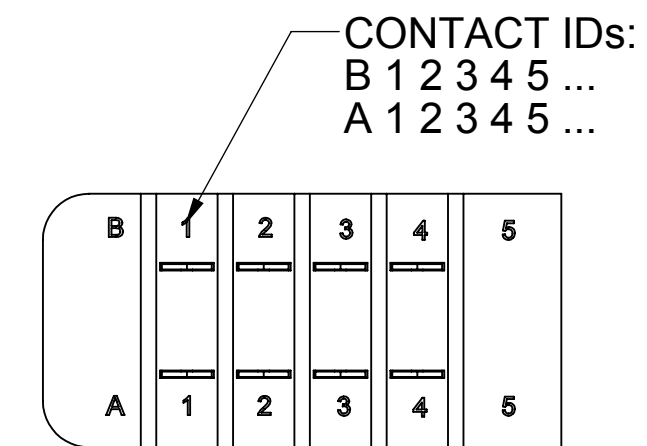
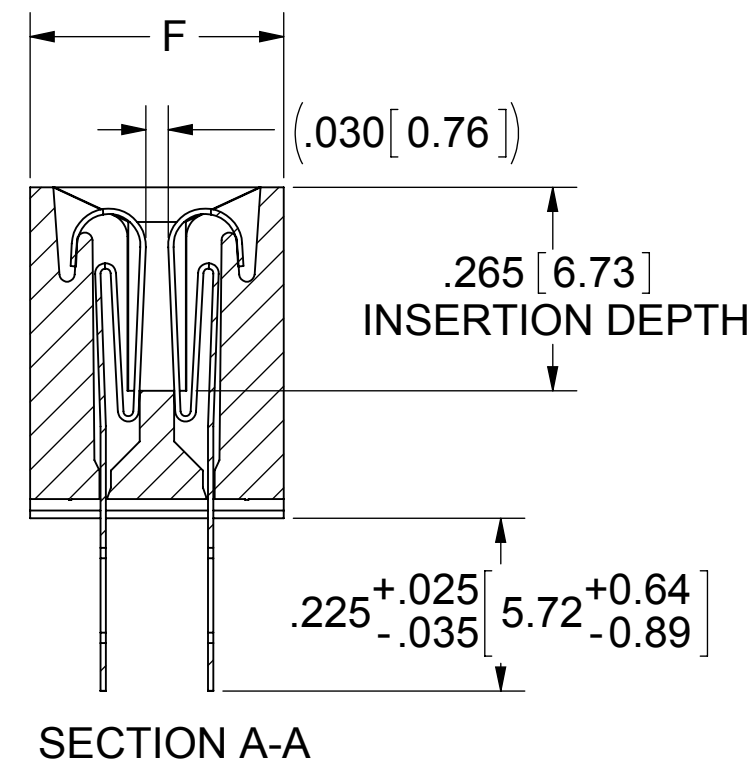
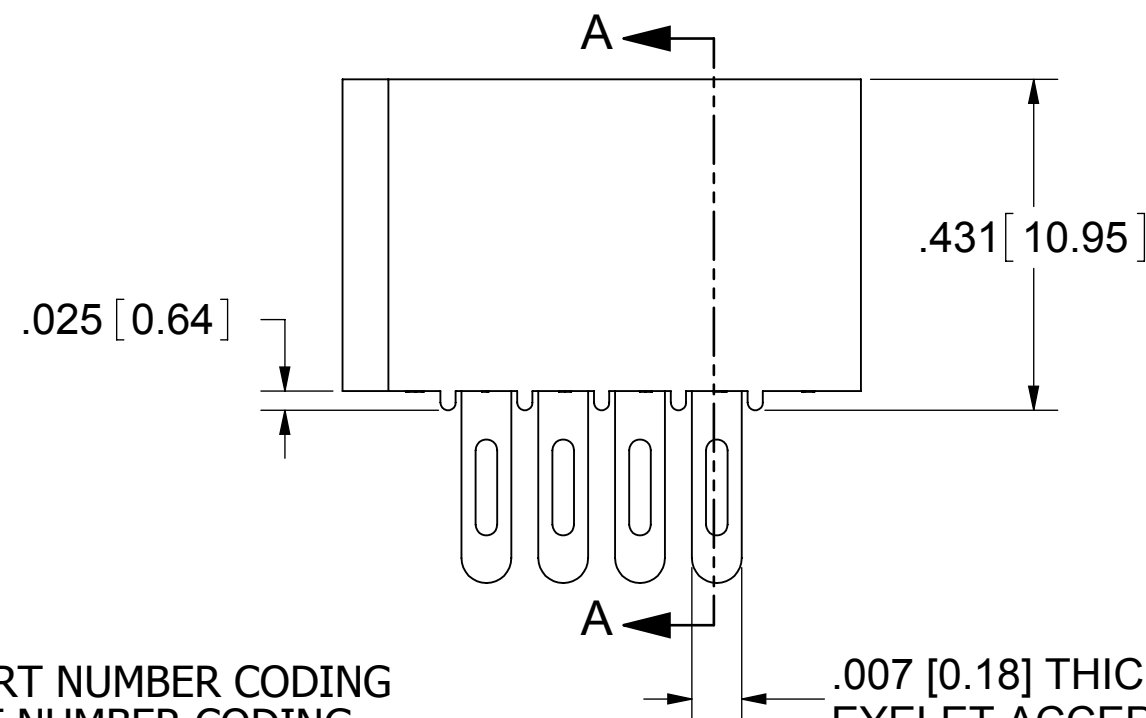
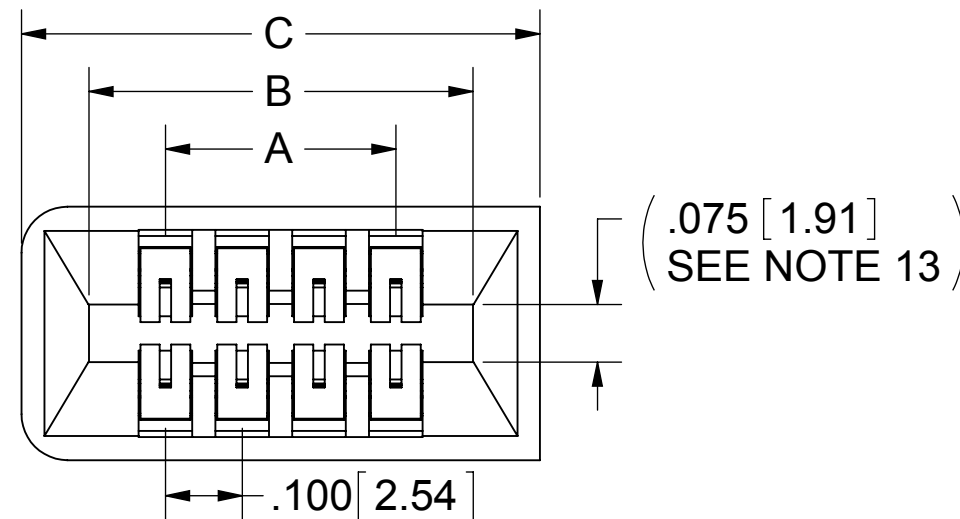
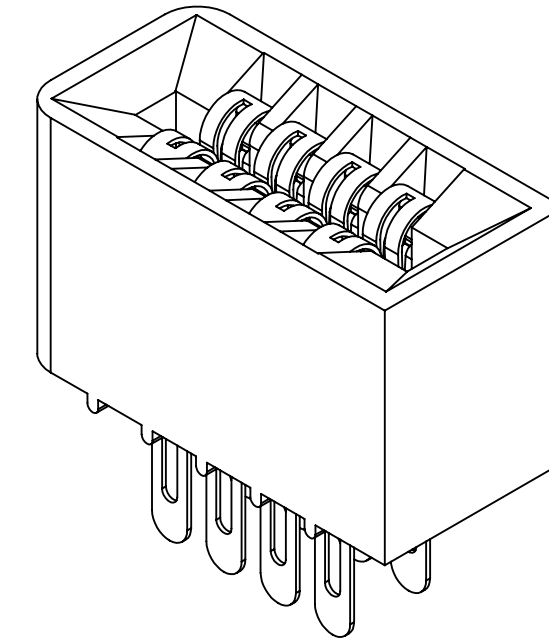

NOTES:

- INSULATOR MATERIAL: SEE PART NUMBER CODING
- CONTACT MATERIAL: SEE PART NUMBER CODING
- PLATING: SEE PART NUMBER CODING
- OPERATING TEMPERATURE: SEE PART NUMBER CODING
- PROCESSING TEMP: SEE PART NUMBER CODING
- UL FLAMMABILITY RATING: 94V-0
- OPERATING VOLTAGE: 700 VAC MINIMUM AT SEA LEVEL
- CURRENT RATING: 3 AMP
- CONTACT RESISTANCE: 30 MILLI OHMS MAX
- INSULATION RESISTANCE: 5000 MEGA OHMS
- DURABILITY: 500 CYCLES MIN
- CONNECTOR IDENTIFICATION: THE PART SHALL BE MARKED WITH A PART NUMBER AND LOT CODE
- BOARD THICKNESS ACCOMMODATED: .062±.008[1.57±0.20]
- INSERTION FORCE: 16 OZ MAX PER CONTACT PAIR WHEN USING A .062[1.57] TEST BLADE
- INTERNAL INSPECTION TO BE PER SULLIN'S WORK INSTRUCTION WI7.3-01
- WITHDRAWAL FORCE: 1 OZ MIN PER CONTACT PAIR USING .062[1.57] PCB
- MODIFICATION: NO EARS, STANDARD RADIUS ONE END, SQUARE CORNER OTHER END

.007 [0.18] THICK
 EYELET ACCEPTS 3 - #26 AWG



CUSTOMER COPY

UNLESS OTHERWISE SPECIFIED: DIMENSIONS ARE IN INCHES [MM]	DRAWN	DATE	NAME	
		6/14/13	JH	
TOLERANCES: ANGULAR: ± 1° DECIMALS .XX=± .02 [.5] .XXX=± .005 [.13] .XXXX=± .0005 [.013]	<small>THE INFORMATION HEREIN CONTAINS PROPRIETARY INFORMATION OF SULLINS ELECTRONICS AND IS NOT TO BE REPRODUCED, USED OR DISCLOSED TO OTHERS FOR ANY PURPOSE EXCEPT AS SPECIFICALLY AUTHORIZED IN WRITING BY AN OFFICER OF SULLINS ELECTRONICS.</small>			TITLE
				EDGE CARD, .100 CC, LP
PART NUMBER				
C DREN-S268				
SIZE	CAGE CODE	DWG. NO.	REV	
C	54453	C12268	A	
SCALE: 4:1			SHEET 1 OF 1	