

REVISIONS					
P	LTR	DESCRIPTION	DATE	DWN	APVD
G		ECO-21-004845	16APR2021	RR	SZ

NOTES:

- MATERIAL:
HOUSING: PBT WITH 30% GF, UL 94V-0, COLOR: BLACK.
CONTACTS: PHOSPHOR BRONZE.
BOARDLOCKS: BRASS.
SHELL: STEEL.
RIVET: COPPER ALLOY (C3602).
- FINISH:
CONTACTS: 0.762µm[30µ"] MIN. GOLD PLATED ON CONTACT AREA,
3.04µm[120µ"] MIN. MATTE-TIN PLATED ON SOLDER TAIL,
1.27µm[50µ"] MIN. NICKEL UNDERPLATED OVER ALL.
BOARDLOCKS: 2.54µm [100µ"] MIN. TIN (SEE CHART),
1.27µm [50µ"] MIN. NICKEL UNDERPLATED OVERALL.
SHELL: 2.54µm[100µ"] MIN. NICKEL PLATED.
RIVET: 1.27µm[50µ"] MIN. NICKEL PLATED.
- RECOMMENDED PCB THICKNESS: 1.6mm.
- FOUR DIGIT DATE CODE IN THIS FORMAT:
YEAR YY WW MANUFACTURING WEEK

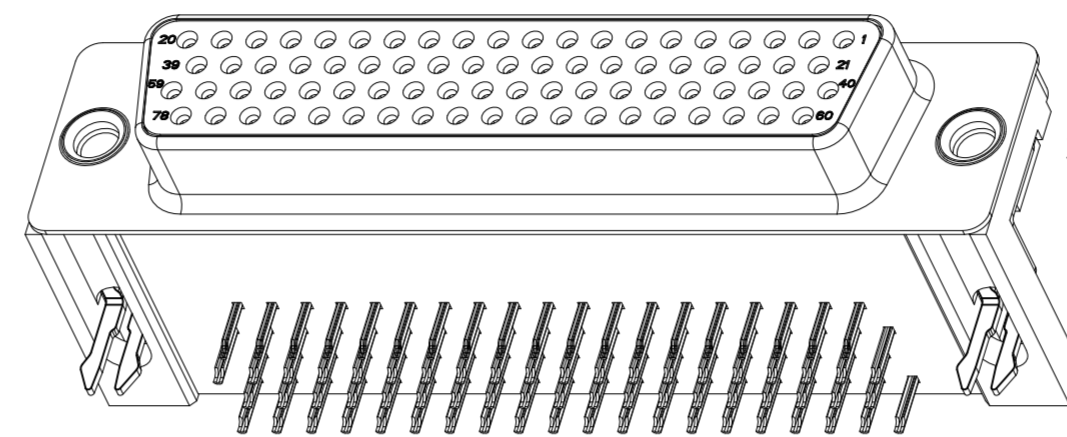
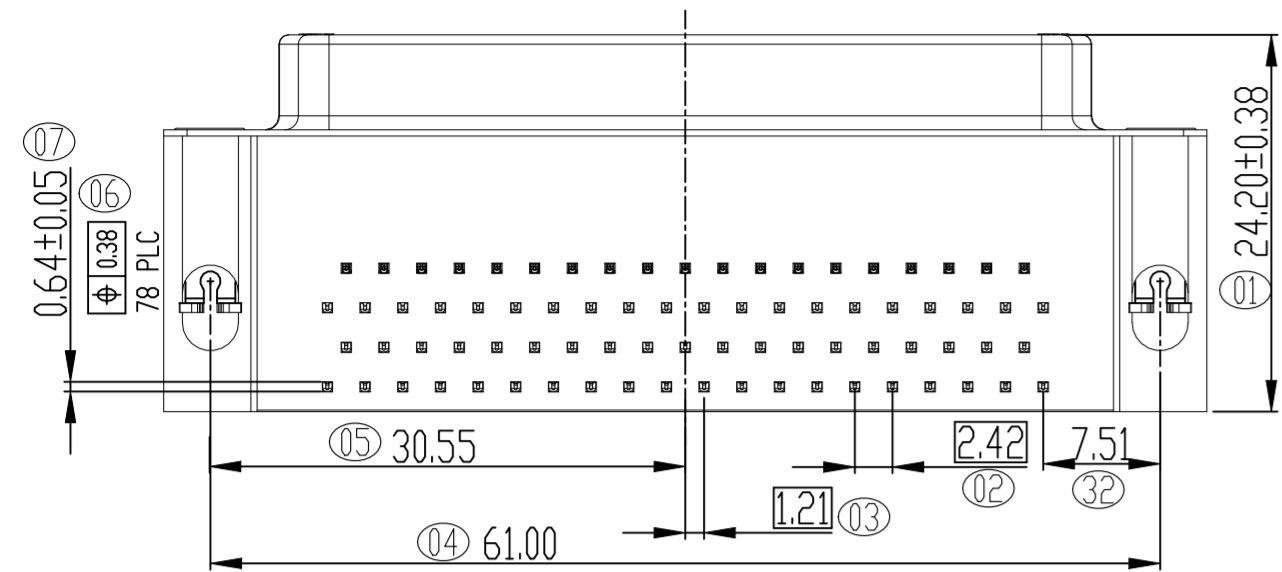

3D VIEW (S=1:1)

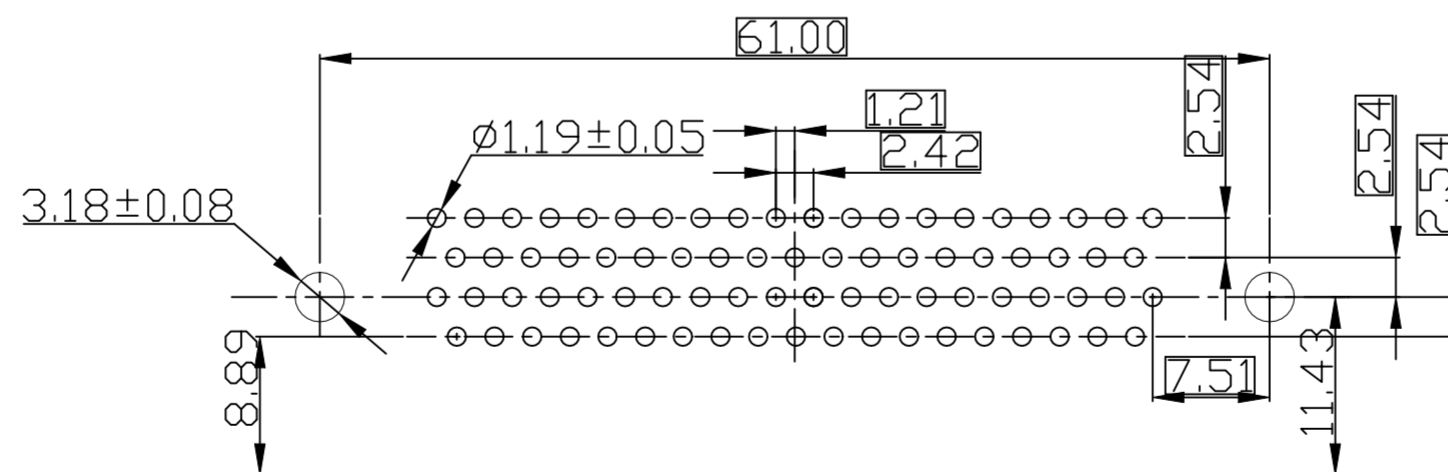
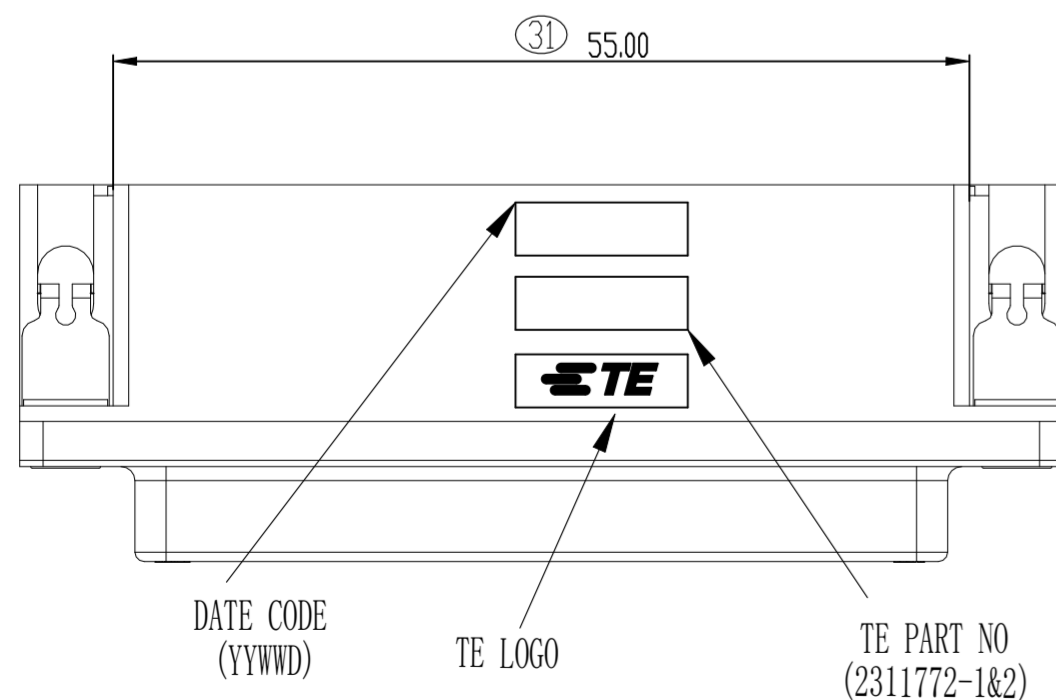
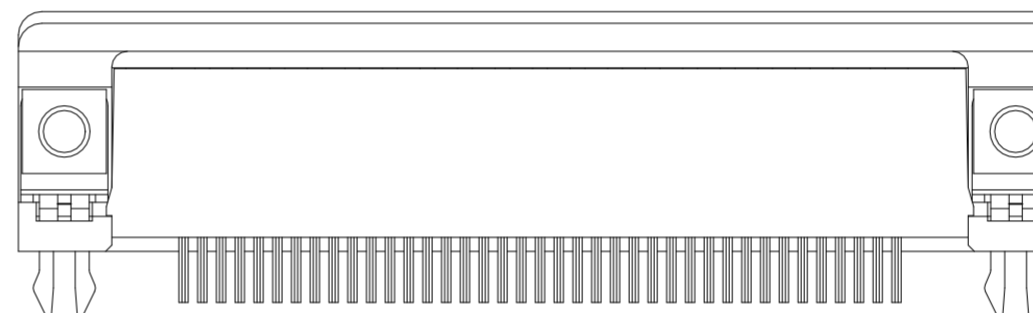
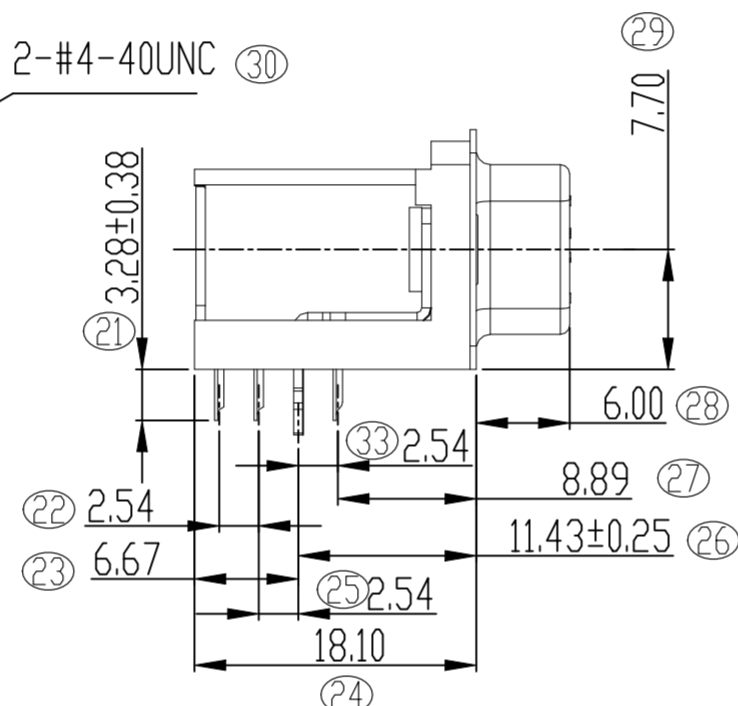
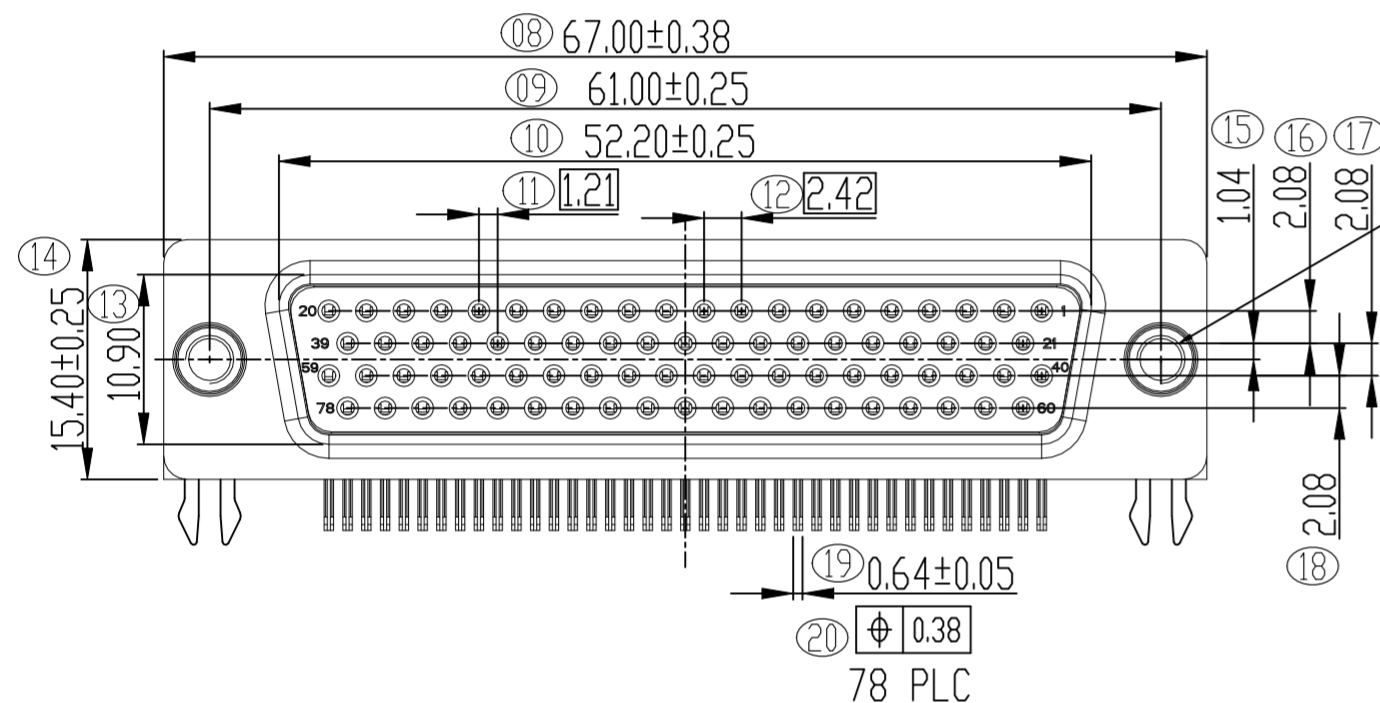

RECOMMENDED PCB LAYOUT
TOLERANCE: ±0.05 (T=1.6mm)

MATTE	THREADED	30µ" Au	2311772-2
BRIGHT	THREADED	30µ" Au	2311772-1
Boardlock Plating	TYPE	Contact Area Plating	P/N

THIS DRAWING IS A CONTROLLED DOCUMENT.		DWN AJITH PAI 10MAR2017	TE Connectivity	
DIMENSIONS: mm		CHK DANIEL GORENC 10MAR2017	NAME AMPLIMITE RECEPTACLE, HD22, RIGHT ANGLE, 78P	
TOLERANCES UNLESS OTHERWISE SPECIFIED:		APVD DANIEL GORENC 10MAR2017	PRODUCT SPEC 108-130024	
0 PLC ± 0.5		APPLICATION SPEC		
1 PLC ± 0.38		SIZE A2		
2 PLC ± 0.25		CAGE CODE 00779		
3 PLC ± -		DRAWING NO C=2311772		
4 PLC ± -		RESTRICTED TO		
ANGLES ± 3°		SCALE 1:1		
MATERIAL		SHEET 1 of 1		
FINISH		REV G		
CUSTOMER DRAWING				