

PART NO. **RFD-1610DS-H8**

REV	DESCRIPTION	DWN	DATE	APPROVED
—	ENGINEERING RELEASE	DM	11/2/20	JDM

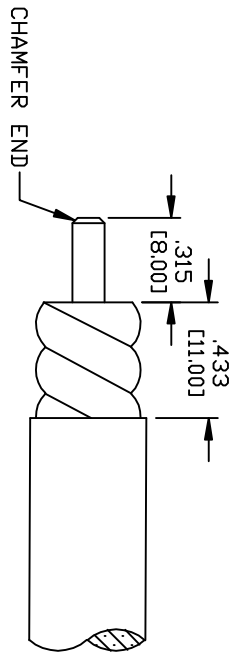
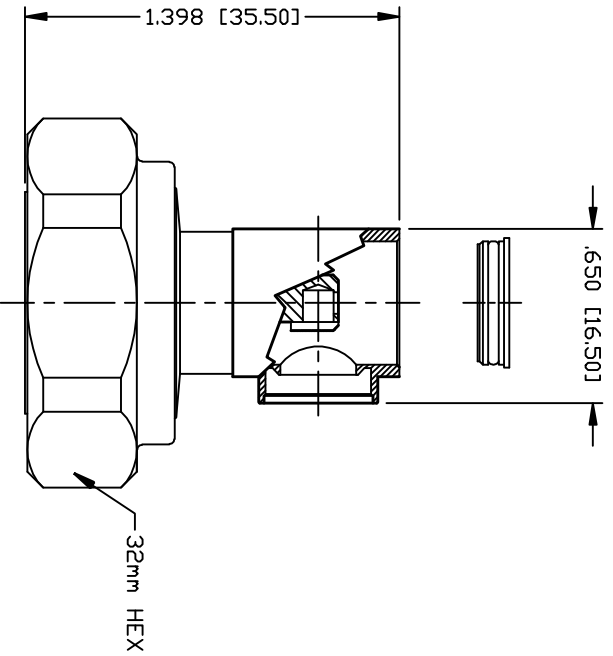

RECOMMENDED STRIPPING DIMENSIONS
 SOLDER CABLE CONDUCTOR TO CONNECTOR INNER CONDUCTOR
 TO THE PIN CAVITY INSIDE THE CONNECTOR

SPECIFICATIONS:

IMPEDANCE: 50 Ohms
 INTERFACE: IEC 61169-4
 FREQUENCY RANGE: 0-7.5 GHz
 INSERTION LOSS: -0.1 dB MAX
 RETURN LOSS: 30 dB 0-700 MHz
 RETURN LOSS: 23 dB 700-5000 MHz
 RETURN LOSS: 19 dB 5-6 GHz
 3rd ORDER IM TEST METHOD: 2x43 dBm
 COUPLING TORQUE: 25 Nm MIN.
 CABLE RETENTION FORCE: 250 Nm
 ENVIRONMENTAL/COMPLIANCE: IP68 MATED / RoHS
 TEMPERATURE RANGE: -55°C +85°C
 DURABILITY: >500 MATING CYCLES
 DIELECTRIC WITHSTANDING VOLTAGE: 4000 VRMS SEA LEVEL
 INSULATION RESISTANCE: > 10,000 MΩ
 NET WEIGHT: 0.15 lb
 FOR FSJ2-50, LCF38-50J, LDF2-50, SCF38-50J, SPF-375,
 SPO-375 & SPP-375 CABLE

#	DESCRIPTION	QTY	MATERIAL	FINISH
1	Coupling Nut	1	BRASS	CuSnZn Alloy
3	Pin	1	BRASS	SILVER
2	Insulator	1	PTFE	NATURAL
1	Body	1	BRASS	CuSnZn Alloy

CUSTOMER OUTLINE DRAWING
 ALL DIMENSIONS ARE REFERENCE ONLY
 UNLESS OTHERWISE SPECIFIED: DIMENSIONS ARE IN INCHES AND [MILLIMETERS]

PROPRIETARY AND CONFIDENTIAL
 THIS DRAWING CONTAINS INFORMATION PROPRIETARY TO RF INDUSTRIES. ANY UNAUTHORIZED USE OF THIS DRAWING IS EXPRESSLY PROHIBITED WITHOUT WRITTEN PERMISSION FROM RF INDUSTRIES. ANY VIOLATION IS PUNISHABLE UNDER U.S. COPYRIGHT LAWS.

RF Industries
 DIVISION OF RF INDUSTRIES, LTD. (858) 549-6346 FAX
 RFINDUSTRIES.COM
 7610 MIRAMAR RD.
 SAN DIEGO, CA 92126
 (858) 549-6340

7/16 DIN MALE R/A DIRECT SOLDER, FOR 3/8" SUPERFLEX

FORMATT	SCALE	CONTROL #	SHEET 1 OF 1
A	NTS	000000	
CABLE GROUP DWG #	REVISION		
H8			
RFD-1610DS-H8			