

PART NUMBER	REV	FIRST USED	TERMINATOR	FEED TYPE	DESCRIPTION
1339630-1	C	-	BENCH & LEADMAKER	MECH POST FEED	HD-I APPLICATOR
7-1339630-1	C	-	BENCH & LEADMAKER	MECH POST FEED	-1 AND SPARE PARTS
7-1339630-7	C	-	-	-	SPARE PARTS KIT

CRIMP DATA AMP TERMINAL AMP CRIMP SPECS			
TERMINAL NAME: .375 SERIES FASTIN-FASTON RECEPTACLE			
CRIMP	SIZE	TYPE	RANGE
WIRE	3.56 [.140 IN]	F	4.00mm ² - 6.00mm ²
INSUL	5.33 [.210 IN]	OVL	3.25-4.20 [.128-.165 IN]
WIRE STRIP LENGTH		APPL INSTRUCTION	
5.80-6.60 [.228-.260 IN]		408-8323	
TERMINAL APPL SPEC	114-3118	FEED	28.19 [1.110 IN]

TERMINALS APPLIED			
151667	-	-	-
-	-	-	-
-	-	-	-
-	-	-	-
-	-	-	-
-	-	-	-
-	-	-	-
-	-	-	-
-	-	-	-

WIRE SIZE mm ² AWG	CRIMP HEIGHT	PIN PN AND LENGTH [IN]
6.00mm ² ⚠	2.90 ±0.05 [.114 ±.002 IN]	2-354778-0 [.2595]
5.00mm ²	2.67 ±0.05 [.105 ±.002 IN]	3-354778-8 [.2685]
4.50mm ²	2.54 ±0.05 [.100 ±.002 IN]	4-354778-7 [.2730]
4.00mm ²	2.44 ±0.05 [.096 ±.002 IN]	5-354778-9 [.2790]
-	-	-
-	-	-
-	-	-
-	-	-
-	-	-
-	-	-
-	-	-
-	-	-
-	-	-
-	-	-
-	-	-
-	-	-
-	-	-
-	-	-
-	-	-
-	-	-

SET UP GAGE 458638-3	LAYOUT L1339630
-------------------------	--------------------

- ⚠ RECOMMENDED SPARE PARTS.
- 2. GREASE RAM, CAM, CAM FOLLOWER AND FEED ROD LIGHTLY.
- 3. LUBRICATE DAILY PER THE APPLICATOR INSTRUCTION SHEET SUPPLIED WITH THE APPLICATOR.
- ⚠ ADJUST ITEM 65 (PIN, FORMING) TO GIVE REQUIRED TERMINAL TAB TO BODY DIMENSION. REFER TO CUSTOMER DRG. NO. 151667
- ⚠ CUT TO LENGTH AT ASSEMBLY.
- ⚠ FOR 6.00MM SQ. WIRE THIS APPLICATOR IS RESTRICTED TO BENCH PRESS USE ONLY. IF THIS WIRE SIZE IS REQD. FOR LEADMAKER APPLICATION AN ALTERNATIVE APPLICATOR WITH A .160" WIRE CRIMP WIDTH WILL BE REQD TO PREVENT STRANDING.(PLEASE NOTE, .160" CRIMP WIDTH IS RESTRICTED FOR USE WITH HOUSING P/N 344040, OR ALTERNATIVES WITH SIMILAR HOUSING CAVITY).
- ⚠ THIS APPLICATOR APPLIES THIN WALL (FLR) INSULATED WIRES.

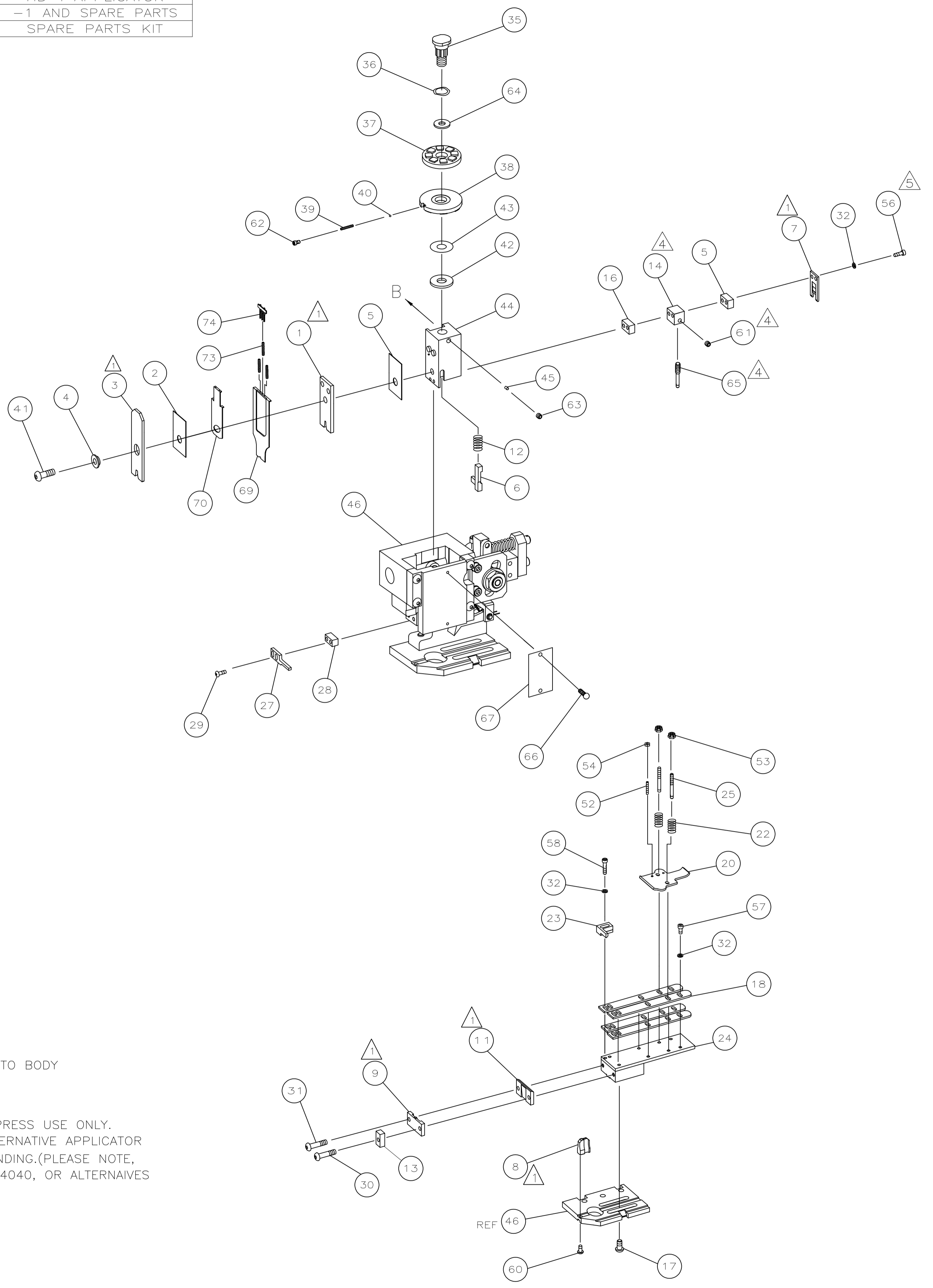
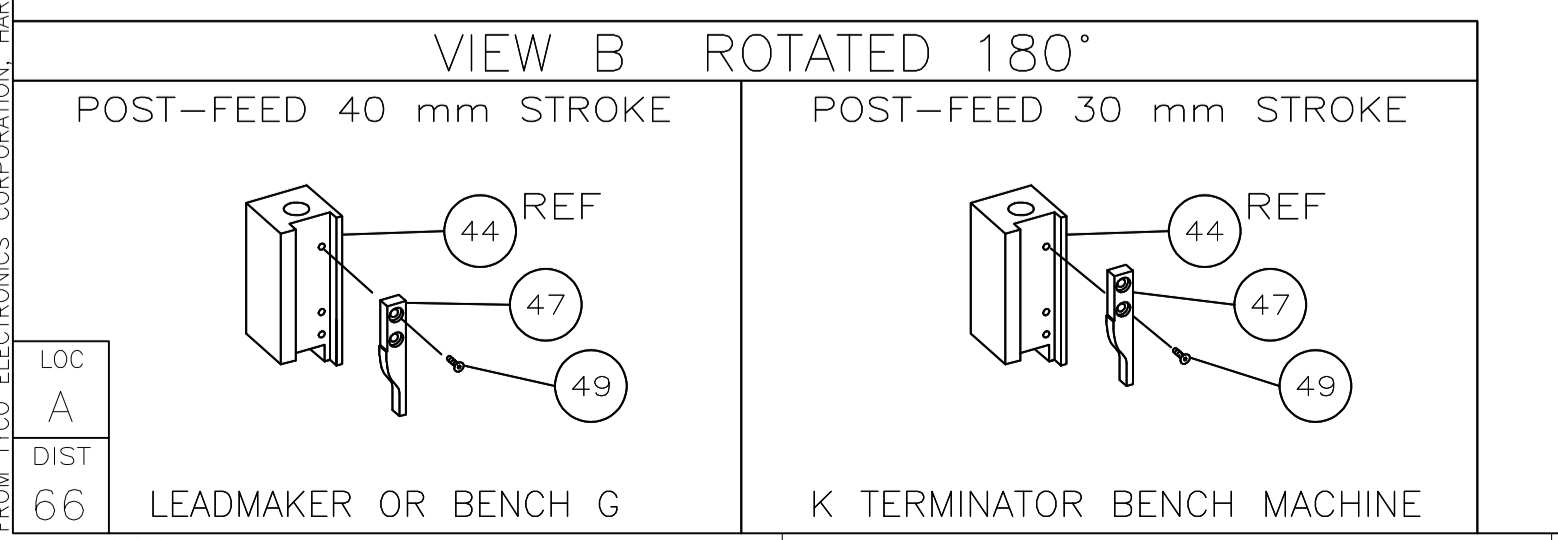

-	1	1	1424350-1	HOLDER, PIN, WIRED	74
-	3	3	1-23147-4	SPRING, DEPRESSOR	73
-	1	1	1339630	PRINT, APPLICATOR LOG SHEET	72
-	1	1	1338705-2	DOCUMENTATION PACKAGE	71
-	1	1	1490524-2	SPACER, DEPRESSOR	70
-	1	1	1490525-1	DEPRESSOR, WIRE	69
-	1	1	461264-1	PLATE, IDENTIFICATION	67
-	2	2	21017-2	SCR,DRIVE(#2X.19)ID PLATE	66
-	1	1	133249-1	PIN, FORMING	65
-	1	1	986950-1	WASHER, FLAT PRECISION	64
-	1	1	3-18031-0	SCR,SKT SET(M6X6)RAM	63
-	1	1	18023-9	SCR,SKT CAP(M4X6)CP DSC	62
-	1	1	18031-1	SCR,SKT SET(M3X5)PIN,FORMING	61
-	1	1	18024-7	SCR,BHC(M4X10)ANVIL	60
-	-	-	-	-	59
-	2	2	1-18023-4	SCR,SHC(M4X20)HOLD DOWN	58
-	5	5	1-18023-0	SCR,SHC(M4X8)STRIP GUIDE	57
-	2	2	1-18023-4	SCR,SHC(M4X20)SLUG BLADE	56
-	-	-	-	-	55
-	2	2	18029-1	NUT,HEX(M3)DRAG	54
-	2	2	986965-1	NUT,HEX SL(M4)DRAG STUD	53
-	2	2	2-18032-2	SCR,SKT SET(M3X10)DRAG	52
-	-	-	-	-	51
-	-	-	-	-	50
-	1	1	18024-3	SCR,BHC(M3X10)CAM	49
-	-	-	-	-	48
-	1	1	1338676-1	CAM, POST-FEED 30 & 40 mm ST	47
-	1	1	1338662-1	APPLICATOR, BASIC (SUBASSY)	46
-	1	1	690191-1	PLUG, NYLON	45
-	1	1	1320998-1	RAM	44
-	1	1	690125-1	WASHER, LAMINATED	43
-	1	1	690124-3	WASHER, RAM	42
-	1	1	2-18024-6	SCREW,BHC(M8X25)CRIMPER	41
-	1	1	23241-1	BALL, STEEL	40
-	1	1	2-22278-7	SPRING, COMPRESSION	39
-	1	1	1320922-1	DISC, INSULATION	38
-	1	1	354777-1	WIRE DISC, PLASTIC	37
-	1	1	22480-5	WASHER, SPRING	36
-	1	1	690212-1	POST, RAM	35
-	-	-	-	-	34
-	-	-	-	-	33
-	9	9	18025-2	WASHER,LOCK(M4)SHEAR BL	32
-	1	1	1-18024-0	SCR,BHC(M4X20)SHEAR PL	31
-	1	1	4-18024-2	SCR,BHC(M4X30)SHEAR PL	30
-	2	2	18024-8	SCR,BHC(M4X12)STRIPPER	29
-	1	1	3-690451-2	SPACER, STRIPPER	28
-	1	1	2-576128-2	STRIPPER	27
-	-	-	-	-	26
-	2	2	1320906-1	DRAG, STUD	25
-	1	1	1-1320995-5	STRIP GUIDE	24
-	1	1	240825-3	PLATE, STRIP HOLD DOWN	23
-	2	2	4-22281-1	SPRING, DRAG	22
-	-	-	-	-	21
-	1	1	1338665-1	DRAG, STOCK	20
-	-	-	-	-	19
-	4	4	1338663-4	GUIDE, LOWER STRIP	18
-	4	4	1-18024-8	SCR,BHC(M6X12)STRIP GD PL	17
-	1	1	1338708-1	SPACER, SLUG BLADE	16
-	-	-	-	-	15
-	1	1	1333248-1	HOLDER, FORMING PIN	14
-	1	1	690481-1	SPACER, HOLD DOWN	13
-	1	1	23846-1	SPRING, HOLD DOWN	12
-	1	1	1-240833-3	PLATE, REAR SHEAR	11
-	-	-	-	-	10
-	1	1	189750-1	PLATE, FRONT SHEAR	9
-	1	2	1333222-4	ANVIL	8
-	1	1	690474-5	BLADE, SLUG	7
-	1	1	5-455892-9	HOLD DOWN, TERMINAL	6
-	1	1	1-240641-2	SPACER, SLUG BLADE	5
-	1	1	238009-1	SPACER, BLOCK CRIMPER	4
-	1	2	805783-2	CRIMPER, INSULATION	3
-	1	1	455888-9	SPACER, CRIMPER	2
-	1	2	1-456425-0	CRIMPER, WIRE	1

QTY REQD PER ASSY

PARTS LIST

LOC A

DIST 66

LEADMAKER OR BENCH G

K TERMINATOR BENCH MACHINE

END FEED HD-I APPLICATOR

SCALE: - A1

DRAWING NO: 1339630

SHEET 1 OF 1

REV C

Tyco Electronics Corporation
Harrisburg, PA 17105-3608

CUSTOMER ACCESSIBLE PRODUCTION DRAWING