

Aluminium Housed Proximity Switch - Normally Open Contacts

Part Number : PRA-SA-001

Product Data Sheet

PICTURE

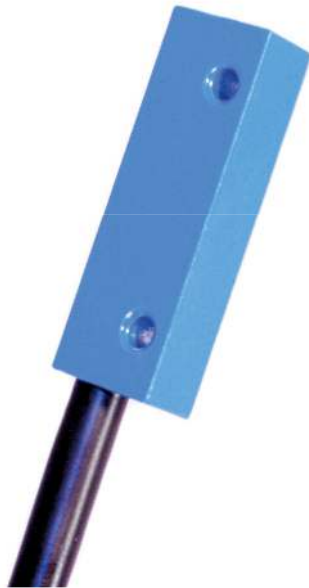

✓ RoHS Compliant

DIMENSIONS

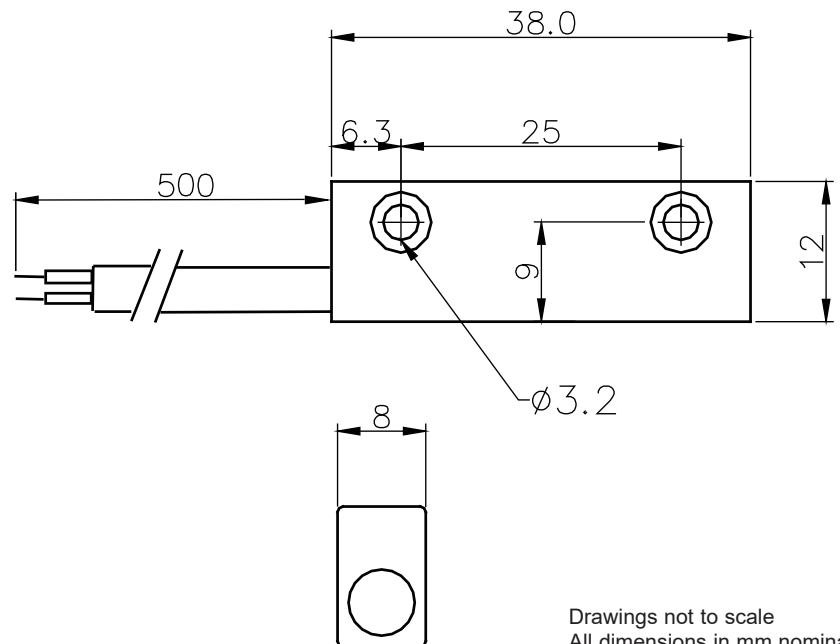

Drawings not to scale
All dimensions in mm nominal

SPECIFICATION

Contact Form / Style		Normally open
Switching voltage	Max Volts	400 AC/DC
Switching Current	Max Amps	0.5
Switching Capacity	Max W/VA	10
Switching distance	Make	15mm (with recommended magnet PRM-SA-001)
	Break	20mm (with recommended magnet PRM-SA-001)
Carry Current	Max Amps	1.0
Contact Resistance	Max Ohms	1
Operating Temperature	Celsius	-20° to 85°
Case Material		Blue powder coated Aluminium
Cable		2 core 0.50mm ² Black PVC insulated, Brown / Blue

Applications Include

- Position sensing.
- Linear actuators.
- Security switching.
- Safety guards/devices

Options/Features

- Robust sealed switch, custom housings available.
- Changeover version available.
- Custom cable types, cable lengths, connectors or crimp terminals available.
- Hermetically sealed reed switch for long life.
- Powder coated housing for added corrosion resistance.

Did you know we also sell?



Rev. No.

1

Revision Note

Datasheet

Date

10-09-12

Signature

ML



ISO 9001:2008
Certificate No. FM21080

As part of the company policy of continued product improvement, specifications may change without notice. Our sales office will be pleased to help you with the latest information on this product range and the details of our full design and manufacturing service. All products are supplied to our standard conditions of sale unless otherwise agreed in writing.

Phone : +44 (0)1255 862236

www.assemtech.co.uk

Fax: +44 (0)1255 862014

©2012 Copyright Assemtech Europe Ltd, Unit 7, Rice Bridge Industrial Estate, Thorpe - Le - Soken, Essex, CO16 0HL, ENGLAND.
USA: Comus International: +1 973 777 6900, Belgium: Comus Belgium BVBA: +32 (0)12 390400