

EBK+x | Spherical revolving handle

Technopolymer

METRIC

RoHS

PP

+176 °F
+32 °F

MATERIAL
High-resilience polypropylene based (PP) technopolymer, black colour, matte finish.

STANDARD EXECUTION
Zinc-plated steel pin, hexagon socket at threaded end.

I.229+x | Revolving handle

Duroplast

METRIC

RoHS

PF

+230 °F
-4 °F

MATERIAL
Phenolic based (PF) Duroplast, black colour, glossy finish.

STANDARD EXECUTION
Zinc-plated steel threaded pin, two flat faces for fitting with 12 mm spanner.



ERGOSTYLE® ELESA Original design

Conversion Table
1 mm = 0.039 inch

D	
mm	inch
50	1.97

Conversion Table
1 mm = 0.039 inch

L	
mm	inch
62	2.44

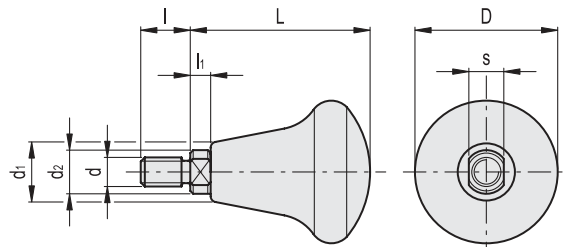
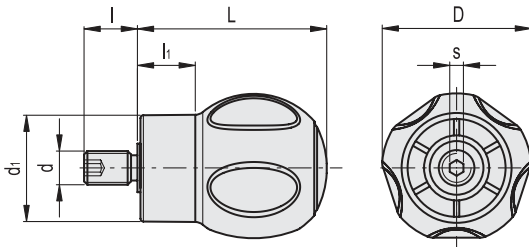

METRIC

METRIC

Code	Description	D	L	d _{6g}	d ₁	l	l ₁	s	⚖
245292	EBK.50+x-M10	50	62	M10	36	17	19	5	90

Code	Description	D	L	d _{6g}	d ₁	d ₂	l	l ₁	s	⚖
21451	I.229/55+x-M10	49	62	M10	20	15	17	7	12	115