

Amphenol
FCi

© 2016 AFCI

| | | | | | | | | | | |
|---------------------------------------|---------------------|-------|----------------|------------|----------------|----|----------|----------------------------------|--------------|----------|
| spec ref | - | dr | Hai-Ling Liu | 2015/11/11 | projection | mm | size | A2 | scale | 1:1 |
| tolerance std | ISO 406 ISO 1101 | eng | Leborn Luo | 2017/09/06 | | mm | ecn no | ELX-DG-27576-1 | rel level | Released |
| TOLERANCES UNLESS OTHERWISE SPECIFIED | | chr | Kaka Zhang | 2017/09/15 | | | | | | |
| surface | ISO 1302 | appr | Pei-Ming Zheng | 2017/09/15 | product family | | cat. no. | HPCE VERT RECEPT 2HP6LP2HP20S | rev | B |
| | linear | 0.X | ±0.5 | | | | divg no | 10137649 | sheet 1 of 4 | |
| | | 0.XX | ±0.25 | | | | | | | |
| | | 0.XXX | ±0.050 | | | | | | | |
| | angular | 0° | ±2° | | | | | | | |

PDS: Rev :B

STATUS:Released

Printed: Sep 15, 2017

| CONTACT TYPE | TOP LAYER DESCRIPTION | TABLE 1 (HPCE / SOLDER TAILS) PLATED THROUGH-HOLE REQUIREMENTS | | | | | |
|----------------|-----------------------|---|------------------|--------------------|---------------|------------------------------|-------------------------------|
| | | DRILLED HOLE DIAMETER | COPPER THICKNESS | TIN-LEAD THICKNESS | TIN THICKNESS | POWER FINISHED HOLE DIAMETER | SIGNAL FINISHED HOLE DIAMETER |
| POWER & SIGNAL | TIN-LEAD | 1.10-1.16 (1.15 DRILL) | 0.025 - 0.050 | 0.005 - 0.015 | -- | 0.94 - 1.10 | 0.90-1.00 |
| | IMMERSION TIN | 1.10-1.16 (1.15 DRILL) | 0.025 - 0.050 | -- | 0.9 - 1.5um | 0.94 - 1.10 | 0.90-1.00 |
| | COPPER (SEE NOTE 8) | 1.10-1.16 (1.15 DRILL) | 0.025 - 0.050 | -- | -- | 0.94 - 1.10 | 0.90-1.00 |

| CONTACT TYPE | TOP LAYER DESCRIPTION | TABLE 2 (HPCE / PRESS-FIT TAILS) PLATED THROUGH-HOLE REQUIREMENTS | | | | |
|----------------|-----------------------|--|------------------|--------------------|---------------|------------------------|
| | | DRILLED HOLE DIAMETER | COPPER THICKNESS | TIN-LEAD THICKNESS | TIN THICKNESS | FINISHED HOLE DIAMETER |
| POWER & SIGNAL | TIN-LEAD | 0.81-0.86 (0.85 DRILL) | 0.025 - 0.050 | 0.005 - 0.015 | -- | 0.65 - 0.80 |
| | IMMERSION TIN | 0.81-0.86 (0.85 DRILL) | 0.025 - 0.050 | -- | 0.9 - 1.5um | 0.70 - 0.80 |
| | COPPER (SEE NOTE 8) | 0.81-0.86 (0.85 DRILL) | 0.025 - 0.050 | -- | -- | 0.70 - 0.80 |

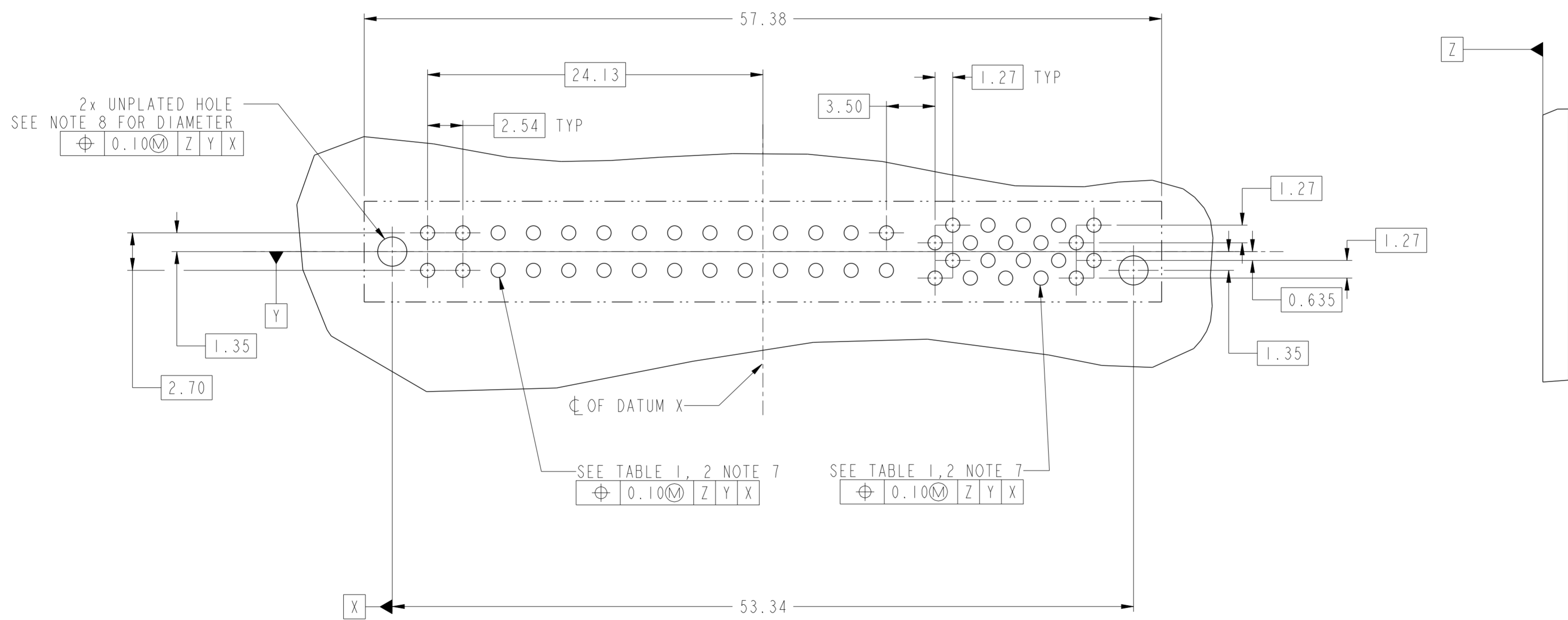

Amphenol FCI

© 2016 AFCI

| | | | | | | | | | | | | | | | | |
|---------------|---------------------|------|--------------|--------------|------------|----|--------|----------------|-----------|----------|-------|------------------|--------|----------|-----|---|
| spec ref | - | dr | Hai-Ling Liu | 2015/11/11 | projection | mm | size | A2 | scale | 1:1 | | | | | | |
| tolerance std | ISO 406 ISO 1101 | eng | Leborn Luo | 2017/09/06 | | | ecn no | ELX-DG-27576-1 | rel level | Released | | | | | | |
| surface | linear | 0.X | ±0.5 | Amphenol FCI | | | | | | | title | HPCE VERT RECEPT | drg no | 10137649 | rev | B |
| | | 0.XX | ±0.25 | | | | | | | | | | | | | |
| | angular | 0° | ±2° | | | | | | | | | | | | | |

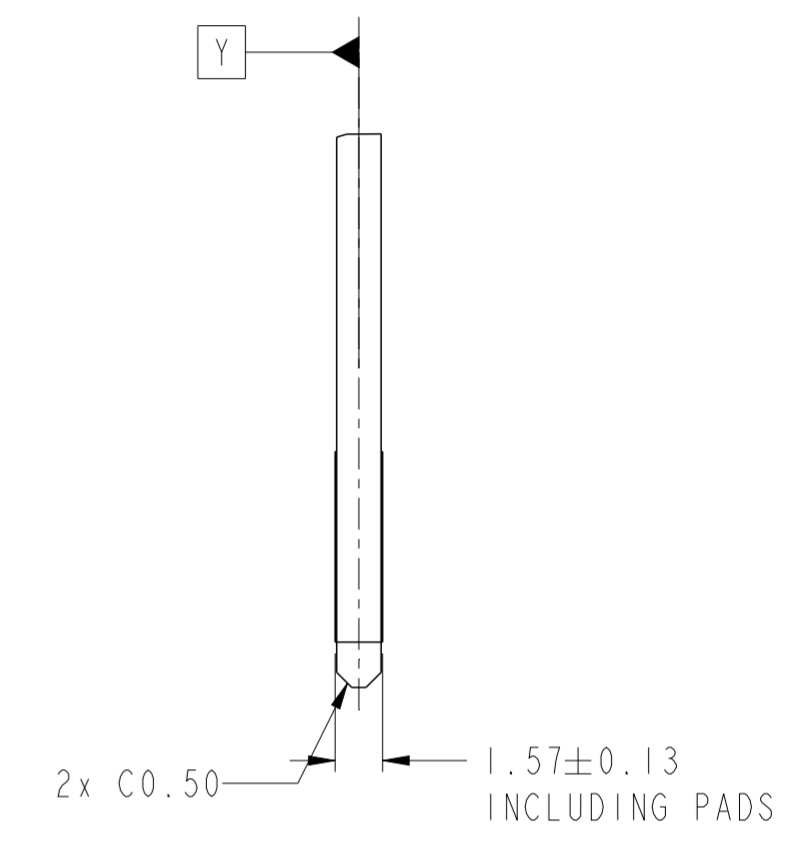
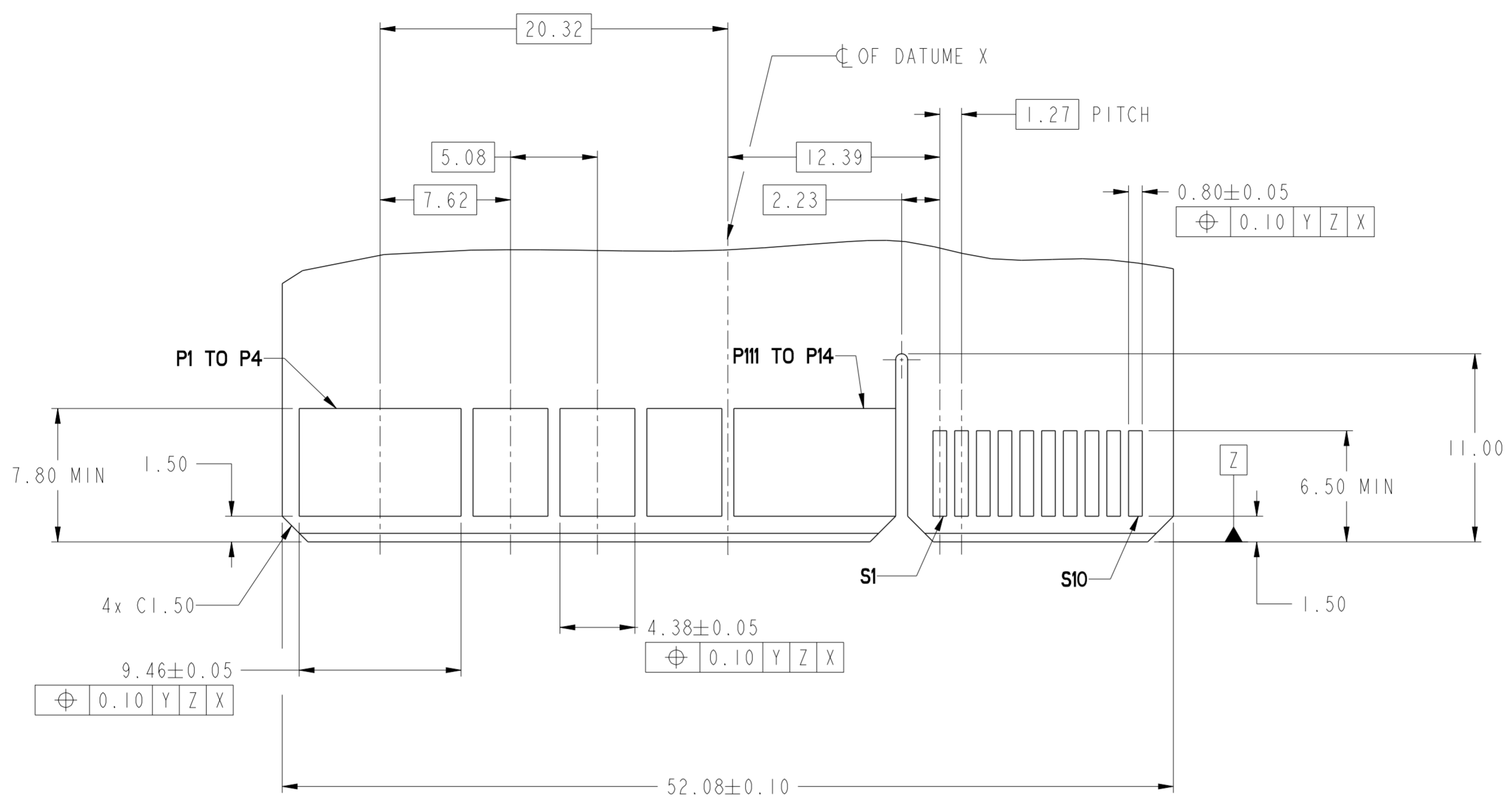

| | | | | | | | | | | | |
|---------------------------------------|---------------------|---------|----------------|------------|------------|------------------------|----------------|----------------------------------|-----------|--------------------|----------|
| spec ref | - | dr | Hai-Ling Liu | 2015/11/11 | projection | mm | size | A2 | scale | 1:1 | |
| tolerance std | ISO 406 ISO 1101 | eng | Leborn Luo | 2017/09/06 | | | ecn no | ELX-DG-27576-1 | rel level | Released | |
| TOLERANCES UNLESS OTHERWISE SPECIFIED | | chr | Kaka Zhang | 2017/09/15 | | | | | | | |
| | | appr | Pei-Ming Zheng | 2017/09/15 | | | | | | | |
| surface | ISO 1302 | linear | 0.X | ±0.5 | | | product family | HPCE VERT RECEPT 2HP6LP2HP20S | | dwg no 10137649 | rev B |
| | | angular | 0° | ±2° | cat. no. | Product - Customer Drw | | sheet 3 of 4 | | | |

HPCE PART NUMBER (TABLE 3)

| PART NUMBER | TAIL TYPE | ORIENTATION KEY | DIM "A" TYPICAL TAIL LENGTH | DIM "B" RECOMMENDED BOARD THICKNESS |
|----------------|-----------|-----------------|-----------------------------|-------------------------------------|
| 10137649-001LF | SOLDER | YES | 3.17 ±0.25 | 2.36±0.13 |
| 10137649-002LF | SOLDER | NO | | |
| 10137649-003LF | PRESS-FIT | YES | 3.17±0.25 | 1.57 MIN |

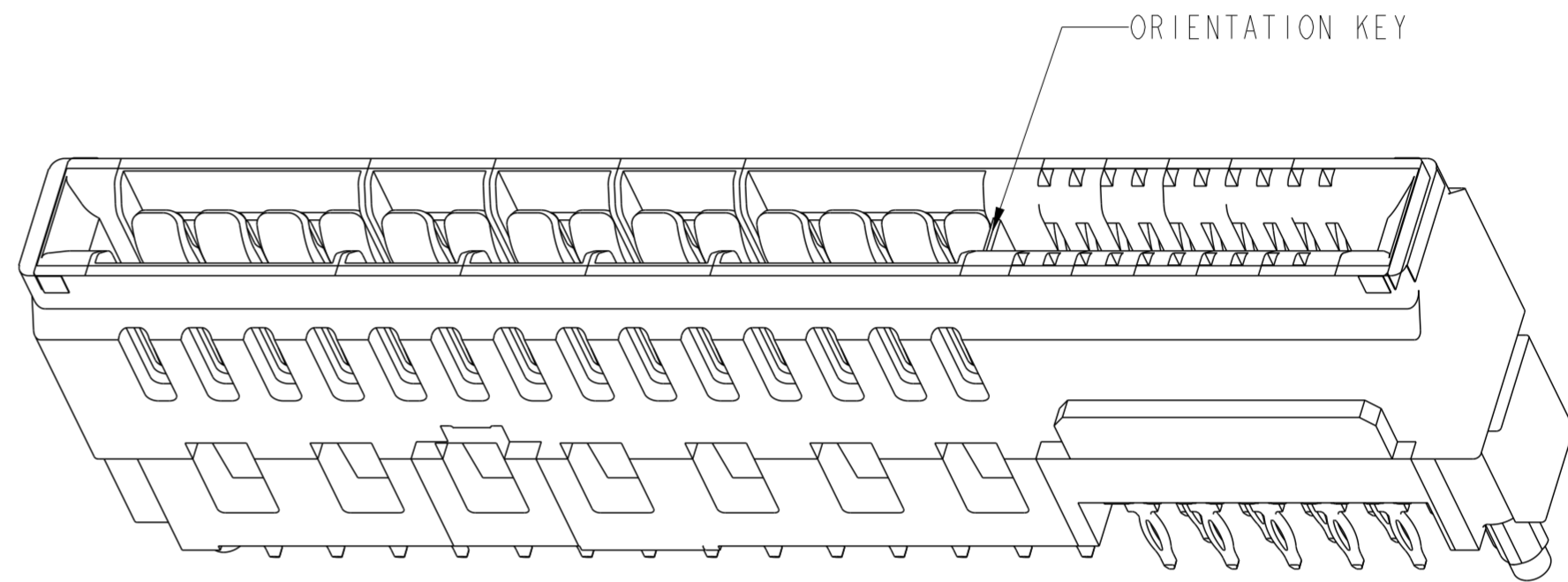

NOTES:

- CONNECTOR MATERIALS:
 HOUSING: HIGH TEMPERATURE THERMAL PLASTIC, BLACK
 UL 94V-0 COMPLIANT
 CONTACTS: HIGH PERFORMANCE COPPER ALLOY.
- CONTACT FINISH REF. GS-12-604 SECTION 5.2.
- PRODUCT SPECIFICATION: GS-12-604.
- APPLICATION SPECIFICATION: GS-20-128.
- PRODUCT MARKING ON HOUSING IN AREA SHOWN MEETS FCI SPECIFICATION GS-24-007.
- PACKAGING MEETS FCI SPECIFICATION GS-14-937.
- ALL HOLE SIZES ARE FINISHED HOLE SIZES.
- MOUNTING HOLES ARE UNPLATED
 Ø 2.40 +/- 0.1 FOR PRESS-FIT TAILS
 Ø 2.18 +/- 0.03 FOR SOLDER TAILS
- PRESS FIT APPLICATION TOOL DRAWING : 10119453.

Amphenol FCI

© 2016 AFCI

| | | | | | | | | | | |
|---------------------------------------|---------------------|-------|--------------|------------|----------------|----|---|--------------------|----------|--|
| spec ref | - | dr | Hai-Ling Liu | 2015/11/11 | projection | mm | size | A2 | scale | 1:1 |
| tolerance std | ISO 406 ISO 1101 | eng | Leborn Luo | 2017/09/06 | | | ecn no | ELX-DG-27576-1 | | |
| TOLERANCES UNLESS OTHERWISE SPECIFIED | | chr | Kaka Zhang | 2017/09/15 | | | | rel level | Released | |
| surface | linear | 0.X | ±0.5 | | product family | | title HPCE VERT RECEPT 2HP6LP2HP20S | dwg no 10137649 | rev B | cat. no. Product - Customer Drw sheet 4 of 4 |
| | | 0.XX | ±0.25 | | | | | | | |
| | | 0.XXX | ±0.050 | | | | | | | |
| | angular | 0° | ±2° | | | | | | | |

PDS: Rev :B

STATUS:Released

Printed: Sep 15, 2017