

NOTES

1. MATERIAL: BRASS, 0.39mm THICK
2. FINISH: UNPLATED (35725-3000/1800/1900)
POST-TIN PLATED (35725-3010/1810/1910)
3. MATING RECEPTACLE TERMINAL: 35725-36*0(L)
35725-37*0(M)
35725-38*0(S)

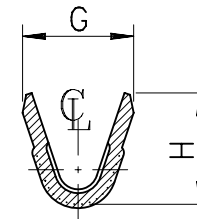

SECTION A-A''

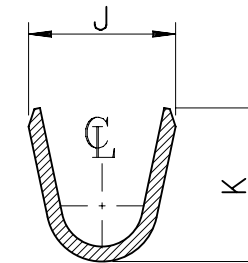

SECTION B-B''

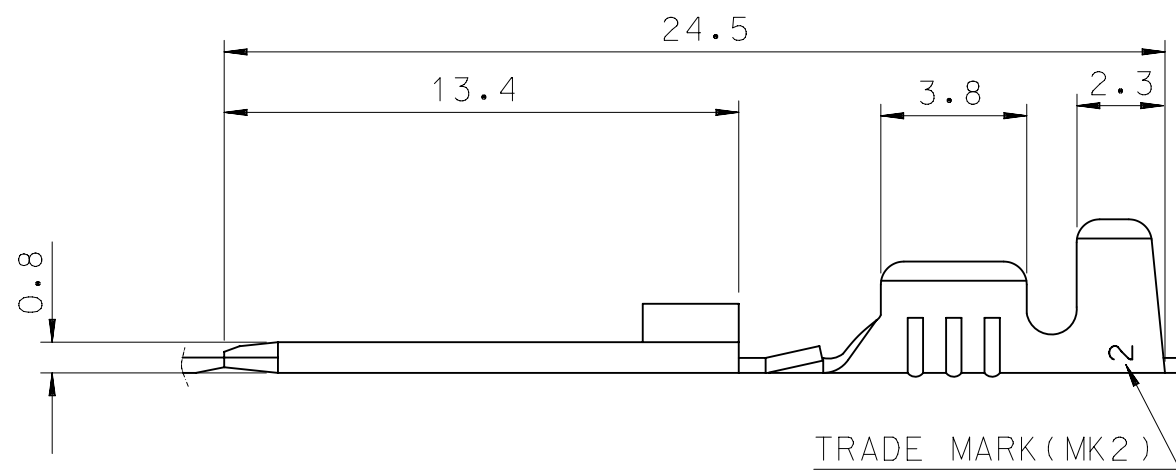

ENG.NO.	G	H	J	K	WIRE RANGE	SIZE
35725-30*0	2.85	2.9	3.8	4.0	AWG#22-#20	S
35725-18*0	3.4	3.6	5.2	5.2	AWG#18-#14	M
35725-19*0	5.3	4.5	6.2	5.6	AWG#14-#12	L

THIS DRAWING CONTAINS INFORMATION THAT IS PROPRIETARY TO MOLEX ELECTRONIC TECHNOLOGIES, LLC AND SHOULD NOT BE USED WITHOUT WRITTEN PERMISSION									
DIMENSION UNITS mm		SCALE 5:1		CURRENT REV DESC: OBSOLETE PART NO			molex		
GENERAL TOLERANCES (UNLESS SPECIFIED)				EC NO: 628886					
		MM	INCH	DRWN: VLOKESHA 2019/10/11			DOCUMENT NUMBER		
4 PLACES ±				CHK'D: GGA 2020/01/13			SD-35725-XXX0		
3 PLACES ±				APPR: GGA 2020/01/13			PSD 001 C1		
2 PLACES ±				INITIAL REVISION:			PRODUCT CUSTOMER DRAWING		
1 PLACE ±				DRWN: W.Y.YANG 1993/03/05			MATERIAL NUMBER		
0 PLACES ±				APPR: C.W.LEE 1993/03/05			CUSTOMER		
ANGULAR TOL ± 0.5°				THIRD ANGLE PROJECTION		DRAWING		SERIES	
DRAFT WHERE APPLICABLE MUST REMAIN WITHIN DIMENSIONS				B-SIZE		35725		SHEET NUMBER	
				SEE CHART		GENERAL MARKET		1 OF 1	