

THIS DRAWING IS UNPUBLISHED. RELEASED FOR PUBLICATION  
 © COPYRIGHT 20 BY - ALL RIGHTS RESERVED.

RECOMMANDATION DECOUPE PANNEAU  
 RECOMMENDED PANEL CUTOUT

VUE DE DESSUS / VIEW FROM TOP

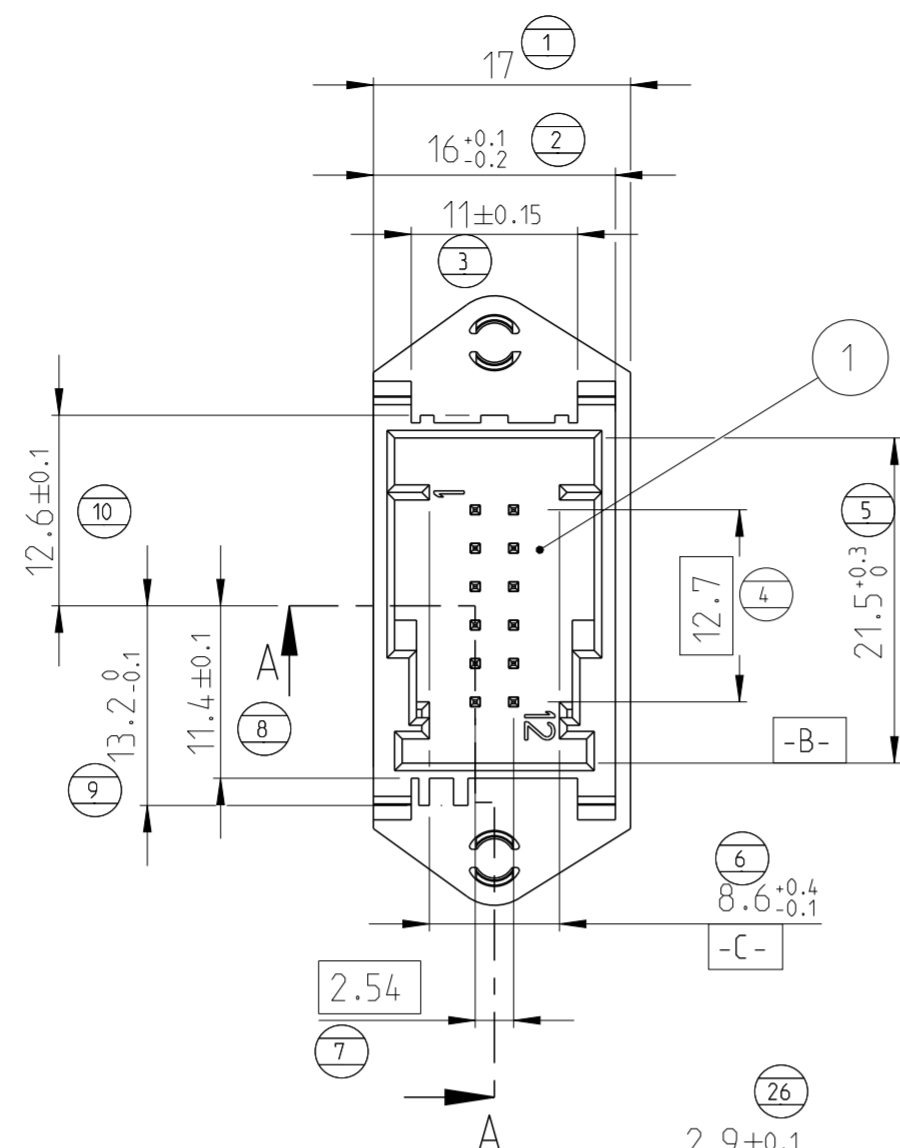
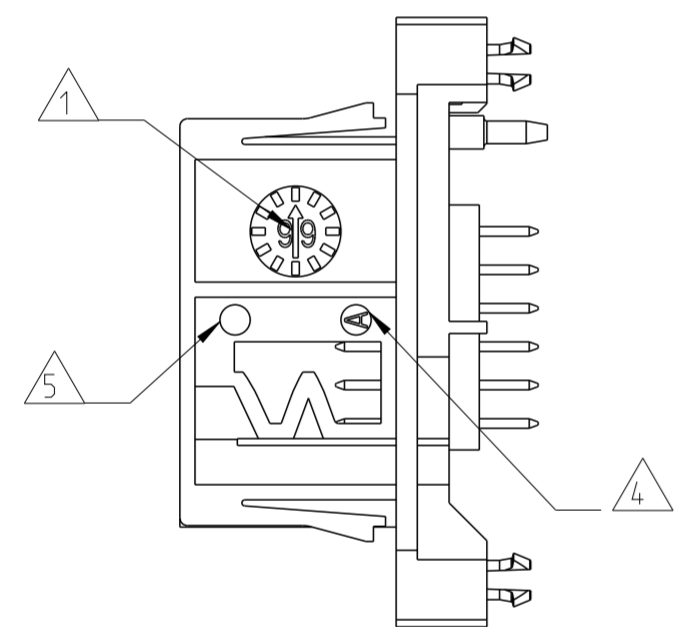
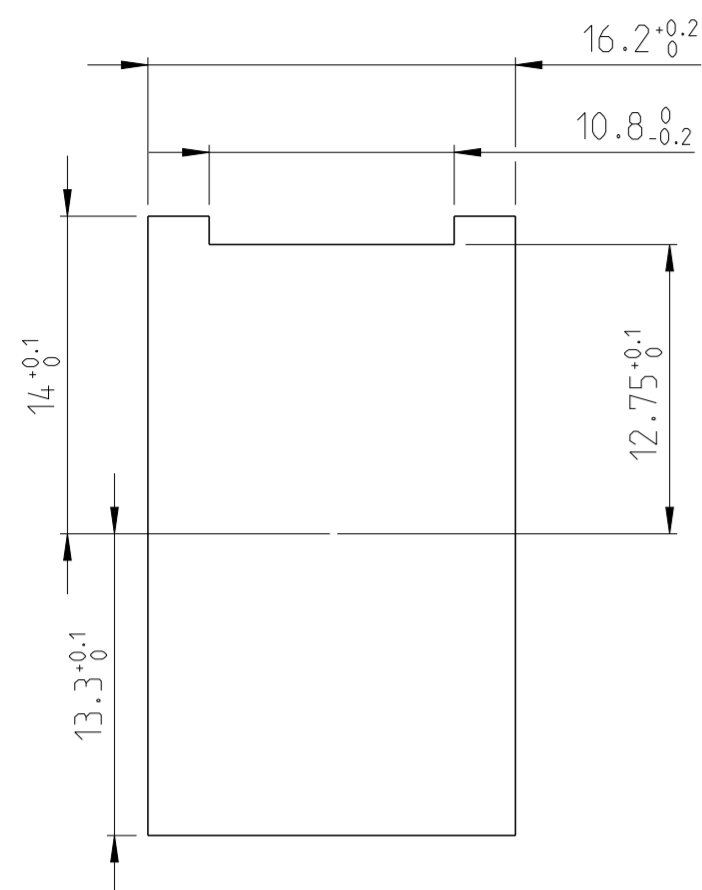

SEE DETAIL B  
 (VOIR DETAIL)

DETAIL B  
 SCALE 4:1  
 (ECHELLE)

Pincement admis  
 jusqu'à Ø3.20

SECTION A-A  
 (COUPE)

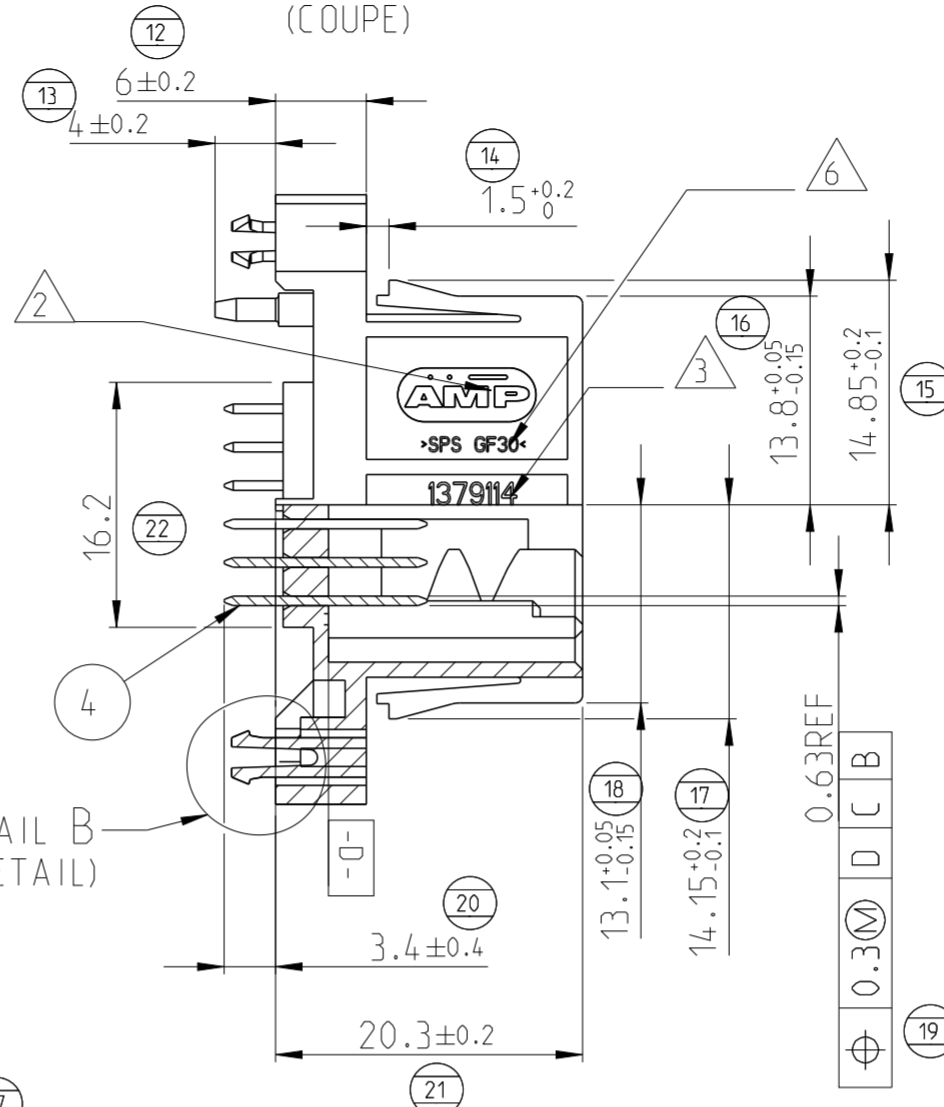

REVISIONS				
P	LTR	DESCRIPTION	DATE	APVD
A		ADD INFORMATION - UPDATED	03NOV2000	JL JLQ
B		CHANGE SPS MATERIAL	10OCT2001	SG JLQ
C		MODIFY MATERIAL TYPE IN TABLE	27FEB2009	SG JL
D		NEW P/N 1-1379114-1 FOR SPECIFIC PACKAGING	21JAN2015	NT.N JL

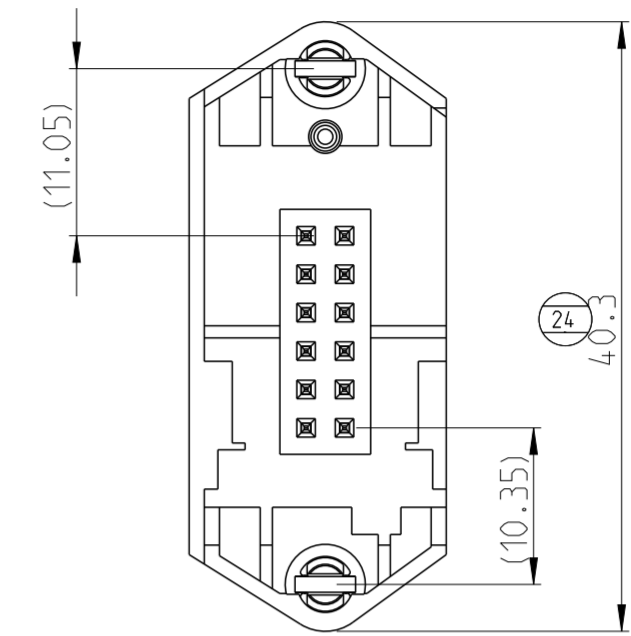

RECOMMANDATION IMPLANTATION CI  
 RECOMMENDED PCB DETAILS

VUE DE DESSUS / VIEW FROM TOP

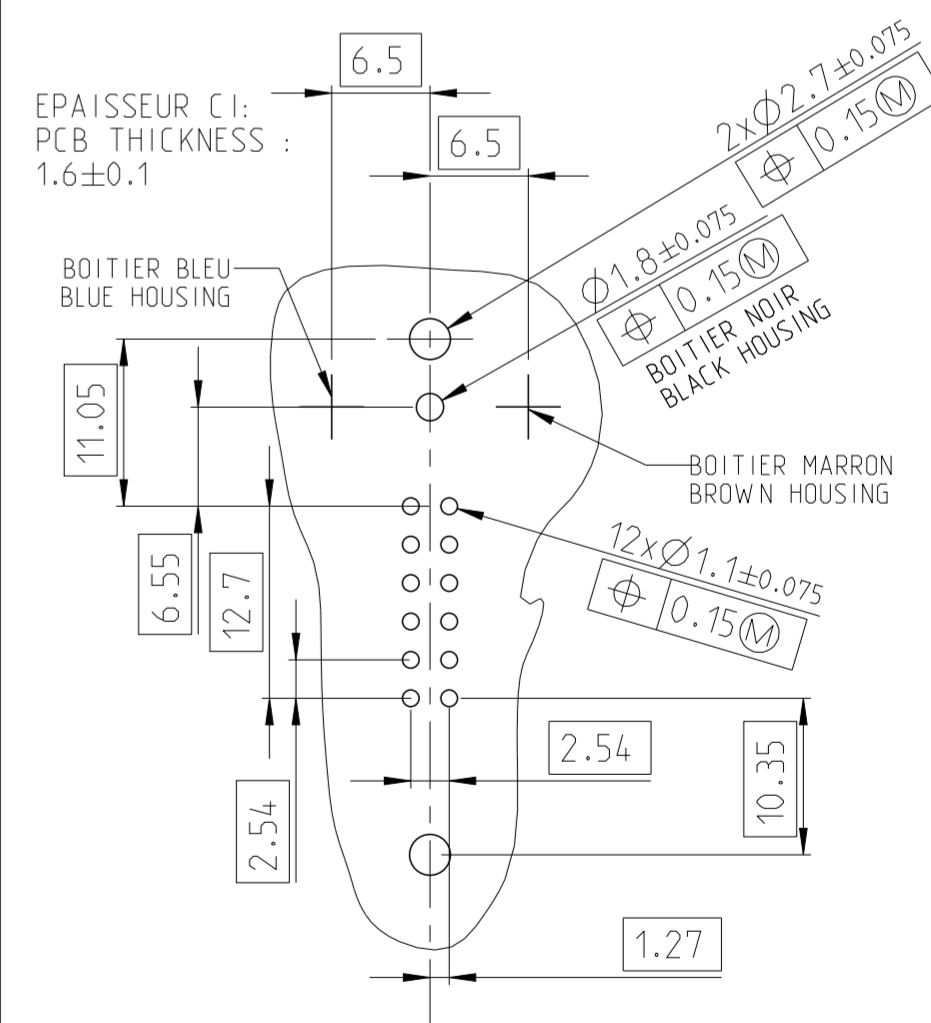

- 1 DATE CODE
- 2 TE LOGO LOGO DE TE
- 3 ASSY PART NUMBER REFERENCE DU PRODUIT ASSEMBLE
- 4 REVISION STATUS REVISION DU MOULE
- 5 CAVITY MARKING N° D'EMPREINTE DU MOULE
- 6 NO CONTRACTUAL MARKING MARQUAGE NON CONTRACTUEL
- 7 MATING PART : CONNECTORS PN 185341 AND 185343  
 CONTRE PARTIE : CONNECTEURS REF 185341 AND 185343

DETROMPAGES / CODINGS

SCALE 1:1  
 (ECHELLE)

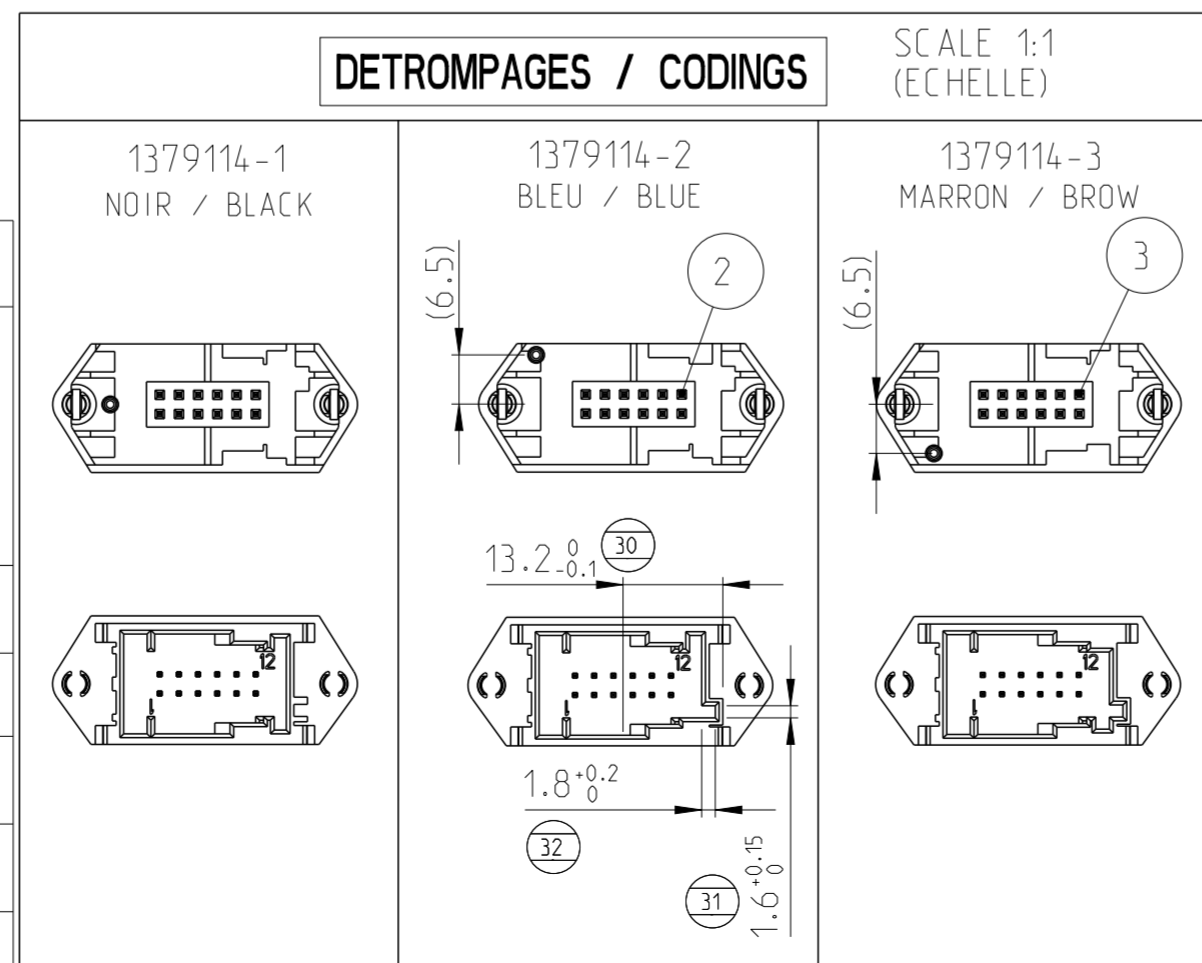

REF / ASSY PN	QTY	MATERIAL	DESIGNATION / NAME	COULEUR / COLOR	REP.
1379114-1	12	CuSn6	CONTACT MQS 0.63x0.63	POST ETAME / POST TIN	4
1379114-2	-	SPS GF20	BOITIER / HOUSING	MARRON / BROWN	3
1379114-3	-	SPS GF20	BOITIER / HOUSING	BLEU / BLUE	2
1-1379114-1	1	SPS GF20	BOITIER / HOUSING	NOIR / BLACK	1

PACKAGING SPECIFIC IN TRAY WITH STRAP  
 CONDITIONNEMENT EN PLATEAU SPECIFIQUE AVEC COURROIE

THIS DRAWING IS A CONTROLLED DOCUMENT.

DIMENSIONS: mm	TOLERANCES UNLESS OTHERWISE SPECIFIED:
MATERIAL	FINISH
	SEE TABLE

DWN J. DREUX 25APR2000	CHK J. LAQUERRE 25APR2000	APVD JJ. REVIL 25APR2000
PRODUCT SPEC 108-15180	APPLICATION SPEC	WEIGHT 3.7 g
Customer Drawing	SCALE 2:1	SHEET 1 OF 1

STE TE Connectivity

12W MQS HEADER  
 WITH /WITHOUT BOARD-LOCKS  
 EMBASE 12V MQS AVEC /SANS B-LOCKS

SIZE A2	CAGE CODE	DRAWING NO 1379114	RESTRICTED TO
---------	-----------	--------------------	---------------