

PRODUCT NUMBER  
10127402-00H1000LF

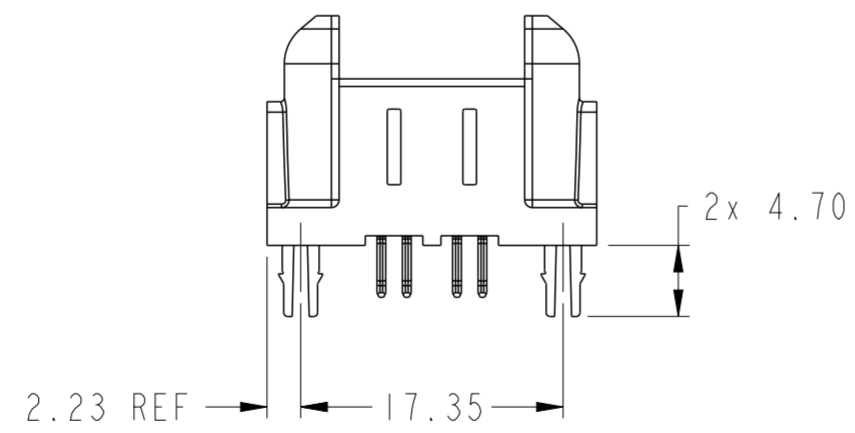
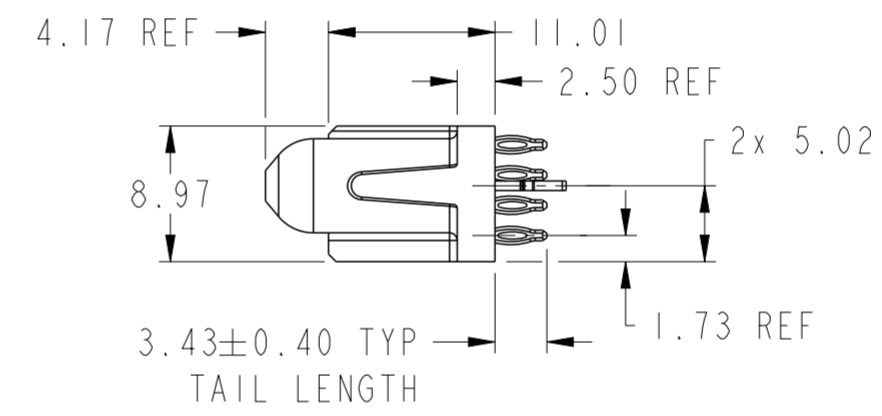
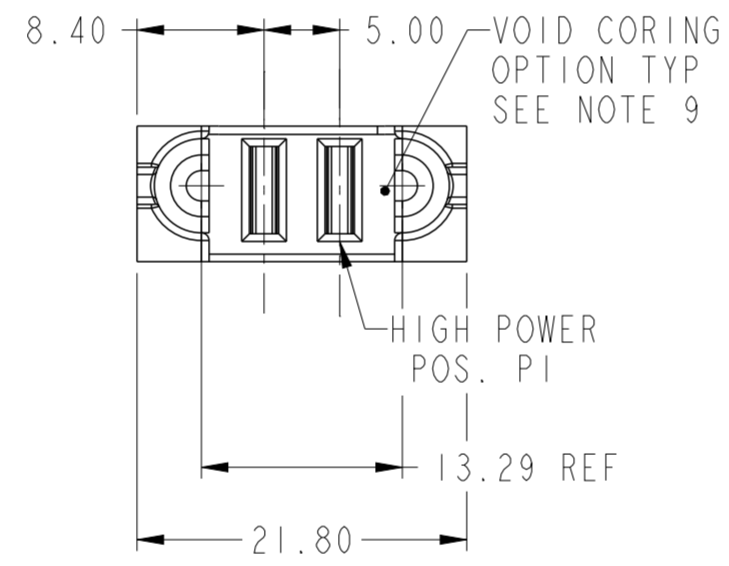
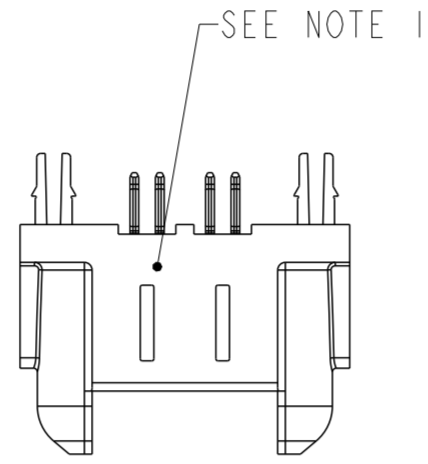

Amphenol  
FCi

© 2016 AFci

spec ref	-	dr	Daniel Xiao	2014/11/13	projection	mm	size	A2	scale	2:1
tolerance std	-	eng	Kaka Zhang	2016/03/24			ecn no	-	rel level	Released
ASME Y14.5	TOLERANCES UNLESS OTHERWISE SPECIFIED	chr	Fancy Zhang	2016/03/24						
		appr	Pei-Ming Zheng	2016/03/24						
surface	linear	0.X	±0.5	<b>Amphenol FCi</b>	title 2HP, PRESS-FIT VERT RECEPTACLE, PwrBlade ULTRA	cat. no.	Product - Customer Drw	sheet 1 of 3	rev A	
ASME Y14.5	angular	0.XX	±0.25							
		0.XXX	±0.130							
		0°	±2°	product family PwrBlade ULTRA	dwg no 10127402-00H1000					

PRODUCT NO.

ROWS

HIGH POWER

E2 P2 P1 E1

10127402-00H1000LF

C  
B  
A

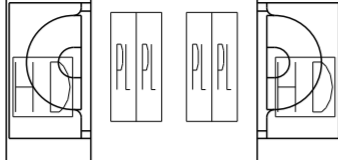

CODE	DESCRIPTION
PL	POWER CONTACT
HD	HOLD DOWN

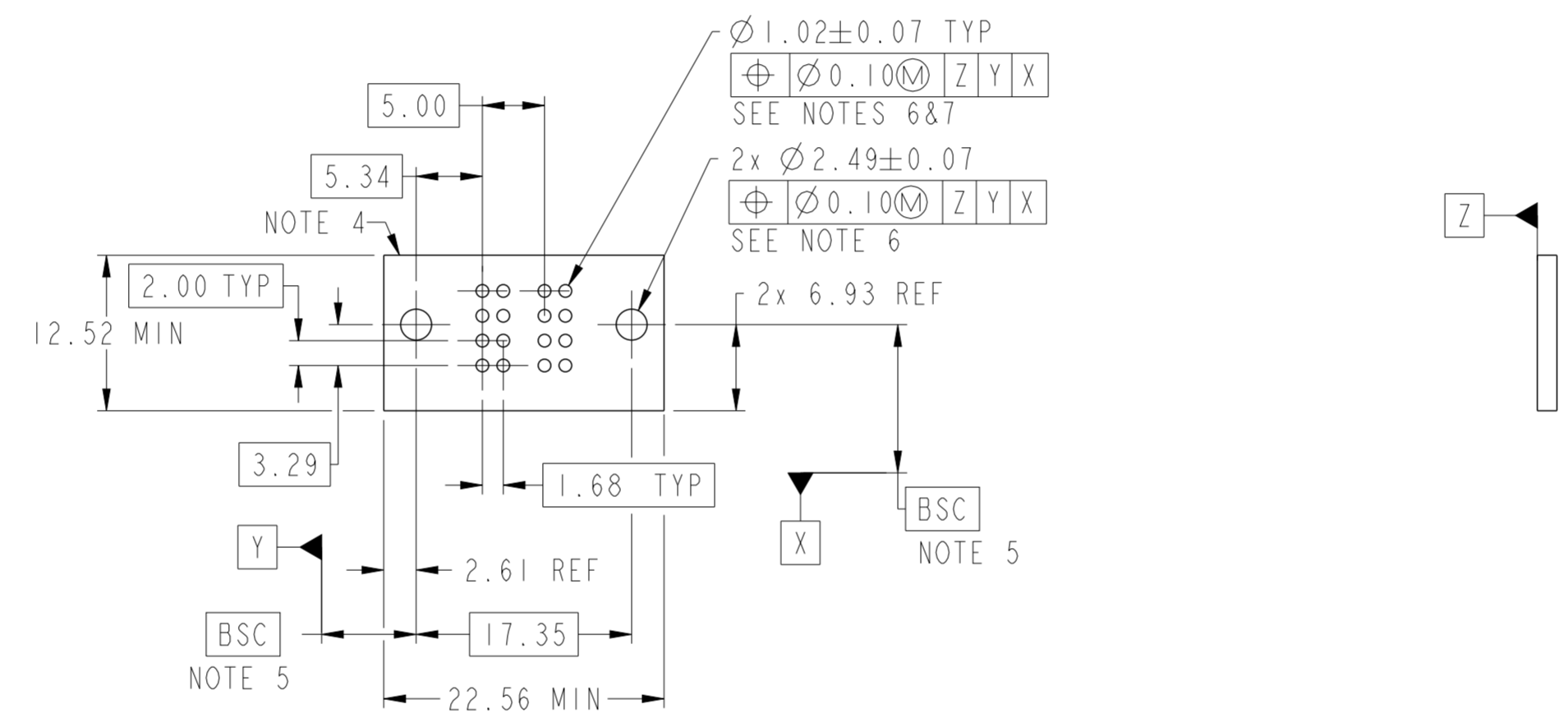

Amphenol  
FCi

© 2016 AFci

spec ref	-	dr	Daniel Xiao	2014/11/13	projection	mm	size	A2	scale	2:1	
tolerance std	ASME Y14.5	eng	Kaka Zhang	2016/03/24			ecn no	-	rel level	Released	
TOLERANCES UNLESS OTHERWISE SPECIFIED		chr	Fancy Zhang	2016/03/24							
		appr	Pei-Ming Zheng	2016/03/24							
surface	ASME Y14.5	linear	0.X	±0.5	<b>Amphenol FCI</b>		title	2HP, PRESS-FIT		divg no 10127402-00H1000	rev A
		linear	0.XX	±0.25	VERT RECEPTACLE, PwrBlade ULTRA		cat. no.	-	Product - Customer Drw		
		angular	0°	±2°							

PDS: Rev :A

STATUS:Released

Printed: Mar 24, 2016

PRODUCT NUMBER

10127402-00H1000LF

NOTES:

- ① "FCI", PART NUMBER AND DATE CODE TO BE MARKED ON THIS SURFACE. THE P/N CAN BE OMITTED IF THERE IS NOT ENOUGH SPACE ON THIS SURFACE.
- 2. MATERIALS:  
HOUSING: GLASS FILLED WITH HIGH TEMP POLYAMIDE, UL94V-0.  
POWER CONTACTS: COPPER ALLOY.  
SIGNAL CONTACTS: COPPER ALLOY.  
HOLD DOWN: COPPER ALLOY.
- 3. PLATING SPECIFICATION: FCI 10135186.
- ④ DENOTES CONNECTOR KEEP OUT ZONE.
- ⑤ DATUM AND BASIC DIMENSION ARE ESTABLISHED BY CUSTOMER.
- ⑥ ALL HOLE DIAMETERS ARE FINISHED HOLE SIZES.
- ⑦ 1.150±0.025mm DRILLED HOLE PLATED WITH 7.62µm MIN Sn OVER 25.4µm-76.2µm Cu PLATING TO ACHIEVE A 1.02±0.07mm FINISHED HOLE.
- 8. PRODUCT SPECIFICATION: FCI GS-12-1176.  
APPLICATION SPECIFICATION: FCI GS-20-0389.  
PRODUCT PACKAGE SPECIFICATION: FCI GS-14-2354.
- ⑨ THE VOID CORING BETWEEN POWER MODULES, SIGNAL MODULES AND END MODULES ARE OPTIONAL AND THE SHAPE MAY BE DIFFERENT TO OPTIMIZE THE MOLDING PROCESS. THE VOID CORING WILL NOT EFFECT THE PRODUCT FUNCTION.

Amphenol  
FCi

© 2016 AFci

spec ref	-	dr	Daniel Xiao	2014/11/13	projection	mm	size	A2	scale	2:1								
tolerance std	-	eng	Kaka Zhang	2016/03/24			ecn no	-	rel level	Released								
ASME Y14.5	TOLERANCES UNLESS OTHERWISE SPECIFIED		chr	Fancy Zhang							2016/03/24							
		appr	Pei-Ming Zheng	2016/03/24							product family	PwrBlade ULTRA						
surface	<table border="1"> <tr> <td>linear</td> <td>0.X</td> <td>±0.5</td> </tr> <tr> <td></td> <td>0.XX</td> <td>±0.25</td> </tr> <tr> <td></td> <td>0.XXX</td> <td>±0.130</td> </tr> <tr> <td>angular</td> <td>0°</td> <td>±2°</td> </tr> </table>	linear	0.X	±0.5		0.XX	±0.25		0.XXX	±0.130	angular	0°	±2°		<b>2HP, PRESS-FIT</b> VERT RECEPTACLE, PwrBlade ULTRA		title 10127402-00H1000	rev A
linear	0.X	±0.5																
	0.XX	±0.25																
	0.XXX	±0.130																
angular	0°	±2°																
ASME Y14.5	cat. no.	-	Product - Customer	Drw	sheet 3 of 3													

PDS: Rev :A

STATUS:Released

Printed: Mar 24, 2016