

THIS DRAWING IS UNPUBLISHED. RELEASED FOR PUBLICATION
 © COPYRIGHT BY TYCO ELECTRONICS CORPORATION. ALL RIGHTS RESERVED.

LOC	DIST	REVISIONS					
GP	00	P	LTR	DESCRIPTION	DATE	DWN	APVD
			A	REV PER EC 0512-0573-04	05-04-05	JA	SF

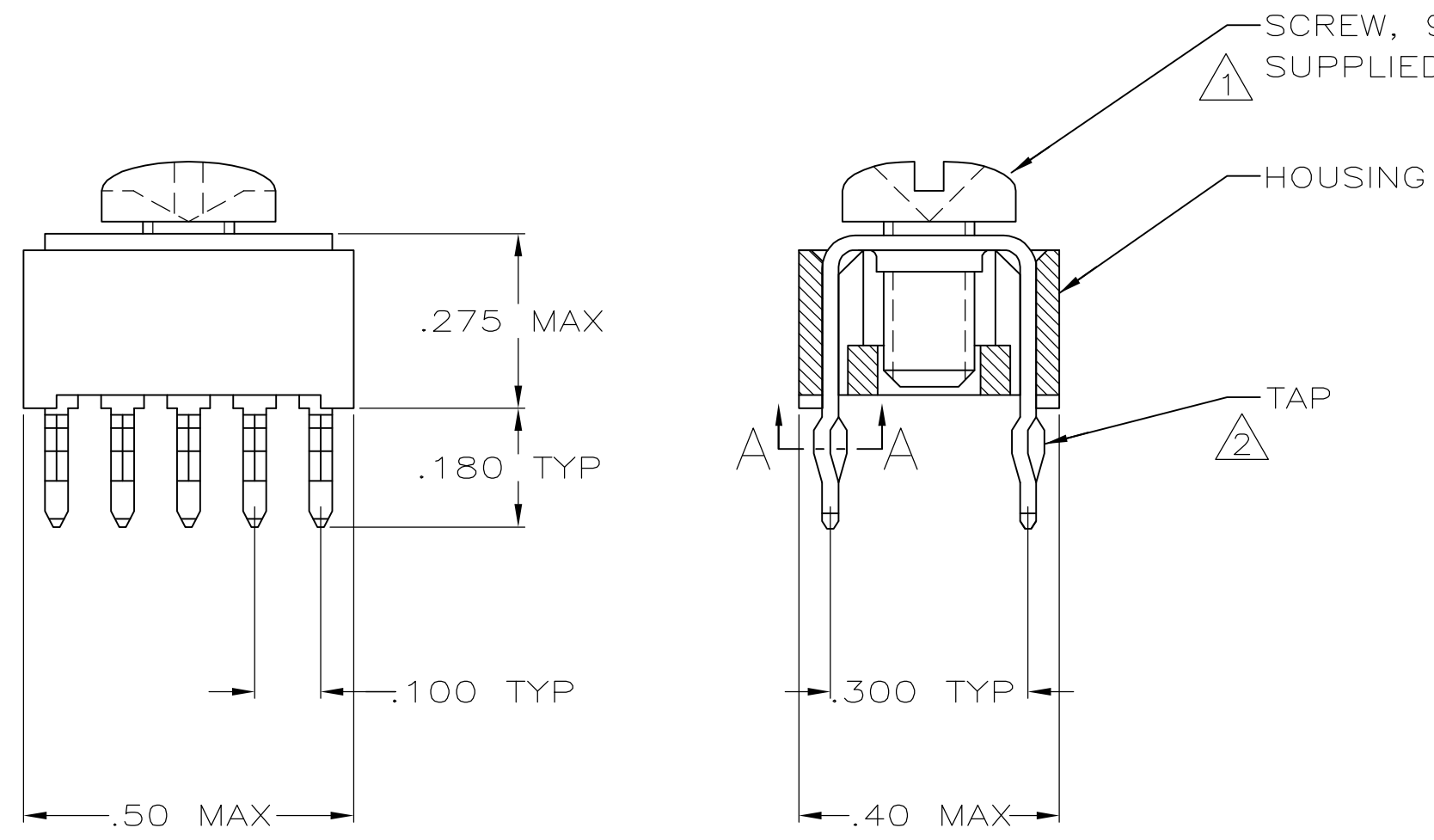

SCREW, 993879-1
 SUPPLIED UNASSEMBLED, SEE TABLE

- ① TO PREVENT THREAD STRIPPING, SCREW TORQUE SHOULD NOT EXCEED 9 IN LBS.
- ② TAP HOLE IS 6-32UNC-2B, TWO MIN THREADS.
- ③ HOUSING: NYLON.
- ④ TAP: COPPER ALLOY 725, .025 THICK.
- ⑤ TAP: .000150 MATTE TIN OVER .000050 NICKEL.
- 6. REFERENCE APPLICATION SPECIFICATION 114-11000 FOR DRILL HOLE SIZES AND FINISHES.



SECTION A-A
 SCALE 10:1
 10 PLACES

YES	5055673-2
SCREW	PART NO.

THIS DRAWING IS A CONTROLLED DOCUMENT.		DWN J. ALCORTA - DOCK5 05-04-05	Tyco Electronics Corporation Harrisburg, PA 17105-3608	
DIMENSIONS: INCHES		CHK A. FRANTUM 05-04-05		
TOLERANCES UNLESS OTHERWISE SPECIFIED:		APVD S. FLICKINGER 05-04-05	NAME TAP ASSEMBLY, POWER DISTRIBUTION	
0 PLC ± - 1 PLC ± - 2 PLC ± - 3 PLC ± .010 4 PLC ± - ANGLES ± -		PRODUCT SPEC 108-11030	RESTRICTED TO	
MATERIAL		APPLICATION SPEC 114-11000	SIZE A3	CAGE CODE 00779
FINISH		WEIGHT -	DRAWING NO C-5055673	
③ ④		CUSTOMER DRAWING		SCALE 4:1
⑤		SHEET 1 OF 1		REV A