

REV.	DATE	DESCRIPTION
NC	04/24/03	INITIAL RELEASE

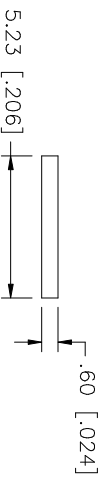
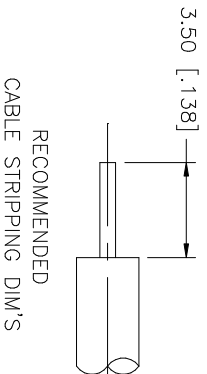
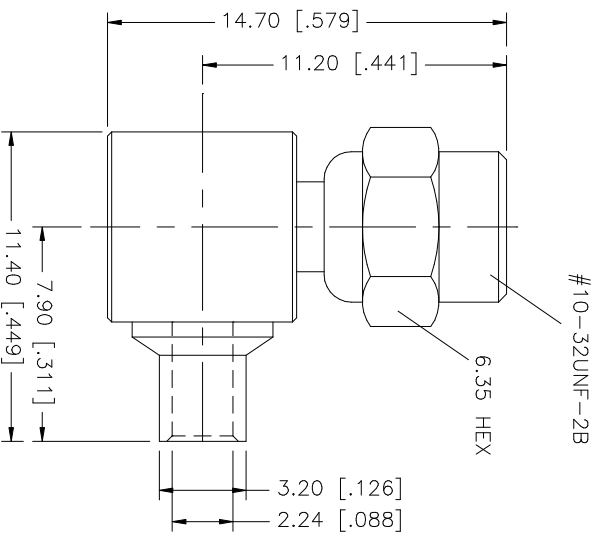

8					UNLESS OTHERWISE SPECIFIED DIMENSIONS ARE IN MILLIMETERS DIMENSIONS IN [] ARE IN INCHES AND FOR CUSTOMER REFERENCE ONLY.	APPROVALS	DATE	Amphenol Connex SMC R/A DIRECT SOLDER PLUG (FOR .085", .086" CABLE) 152138
7				UNLESS OTHERWISE SPECIFIED TOLERANCES FOR MILLIMETERS ARE:	DRAWN	G.R.S.	04/24/03	
6				0.5 - 8mm ± 0.20mm	CHECKED			
5				8 - 30mm ± 0.40mm	ISSUED			
4	COVER	BRASS		30 - 120mm ± 0.50mm	SHEET	1 OF 1		
3	CONTACT PIN	BER. COPPER		UNLESS OTHERWISE SPECIFIED TOLERANCES FOR INCHES ARE:	CAD FILE			DWG. NO. 152138.DWG REV. NC SIZE A SCALE NA
2	INSULATOR	TEFLON		.020 - .315 = ± 0.007"	C:/152/152138.DWG			
1	SHELL/BODY	BRASS		.315 - 1.180 = ± 0.015" 1.180 - 4.724 = ± 0.020"				
	DESCRIPTION	MATERIAL	FINISH	QTY	DO NOT SCALE DRAWING			