

**NOTES:**

- HOUSING MATERIAL : GLASS FILLED LIQUID CRYSTAL POLYMER (LCP);  
UL RATING: 94V-0; COLOR: WHITE  
TERMINAL MATERIAL: PHOSPHOR BRONZE  
VACUUM CAP MATERIAL: STAINLESS STEEL
- COPLANARITY OF SMT TAILS: 0.10 MAX.
- PACKAGING SPECIFICATIONS : REFER TO TABLE.
- THIS PART, WHEN MATED WITH MOLEX U.S.PART NO. 71742-0\*\*\* OR MOLEX JAPAN PART NO. 52841-0848, CONFORMS TO MOLEX PRODUCT SPECIFICATION PS-71741-9999.

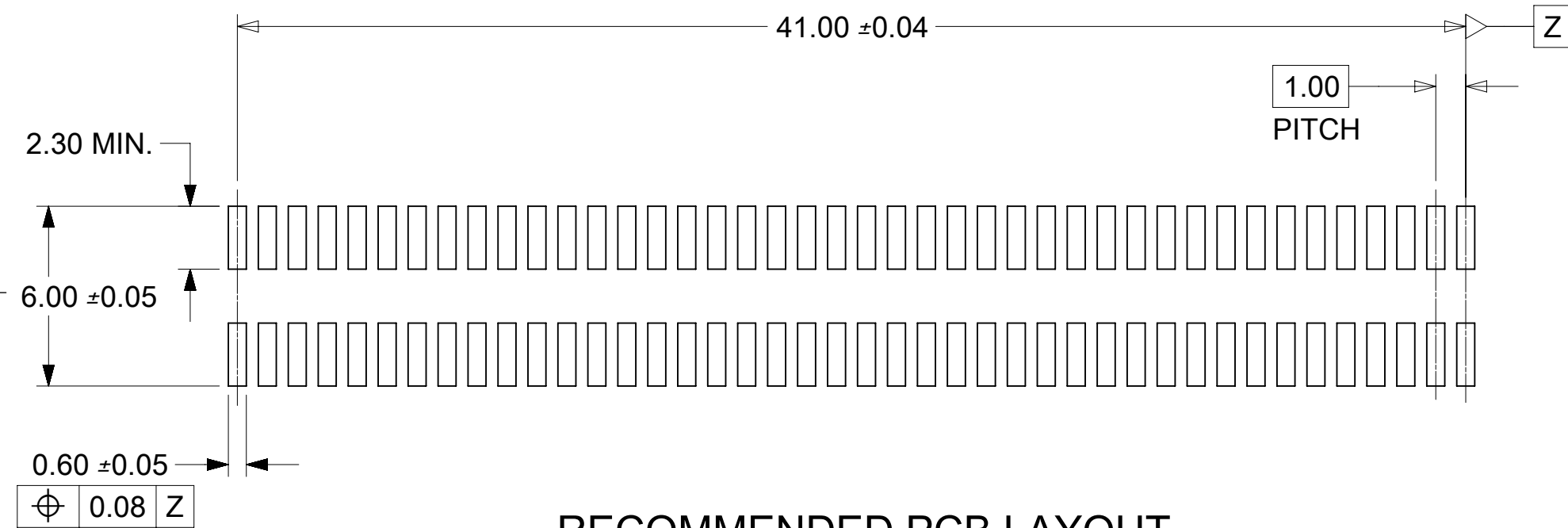
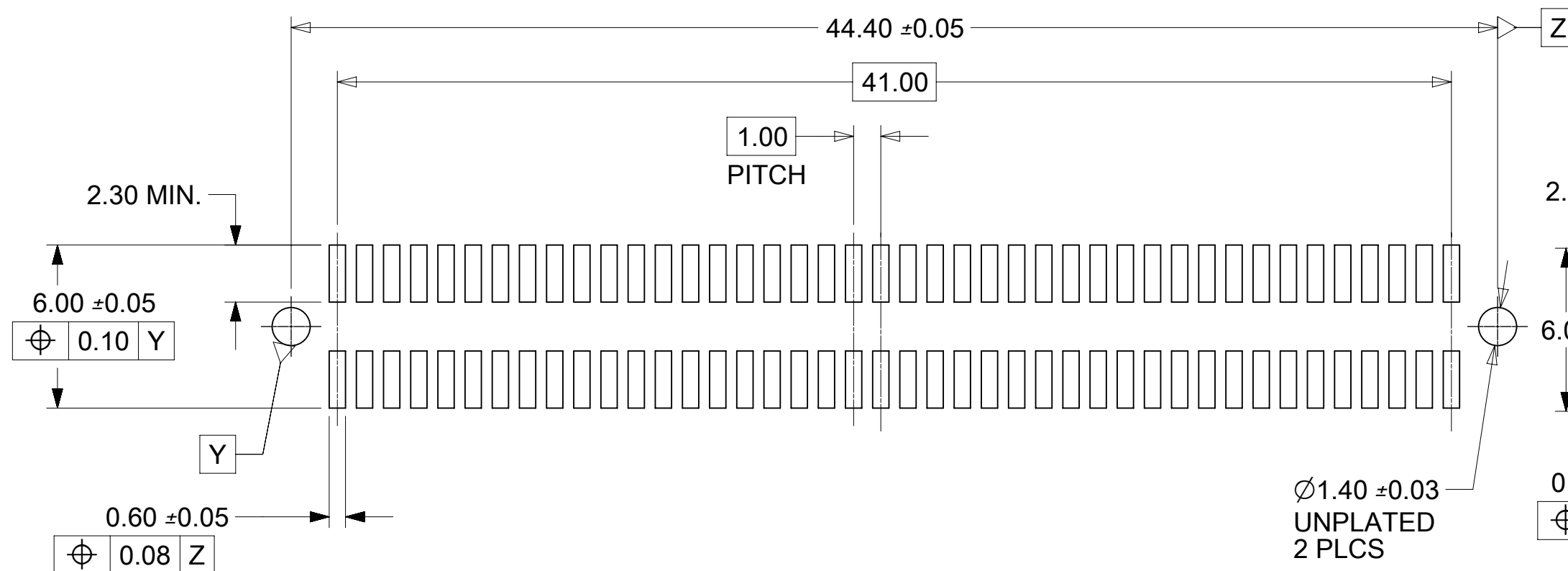
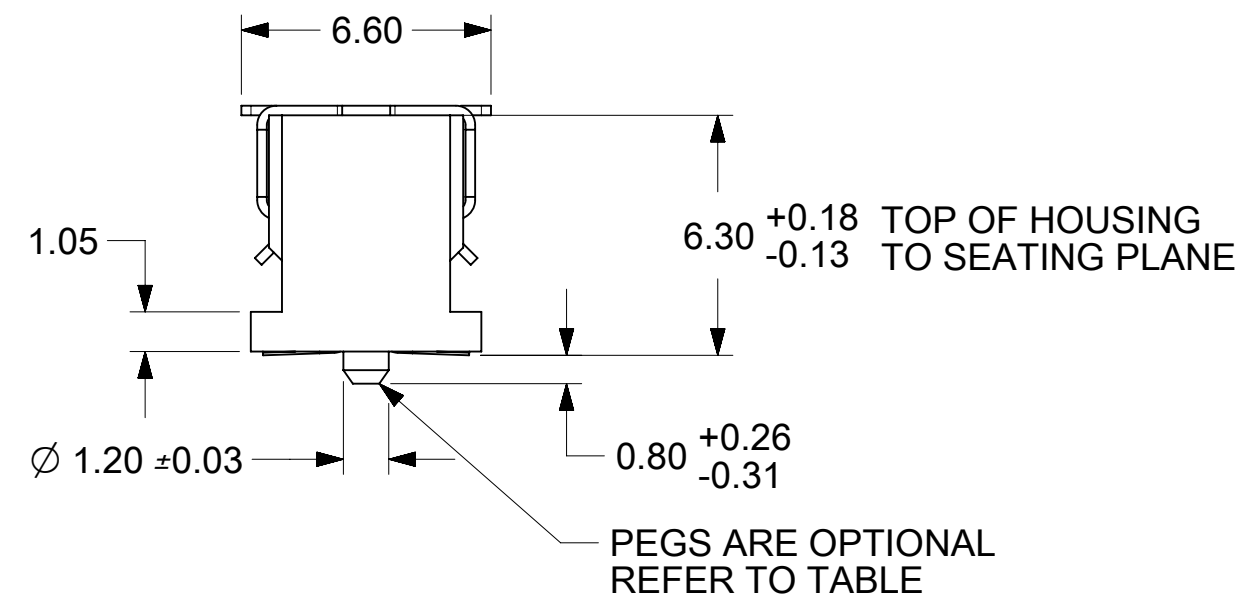
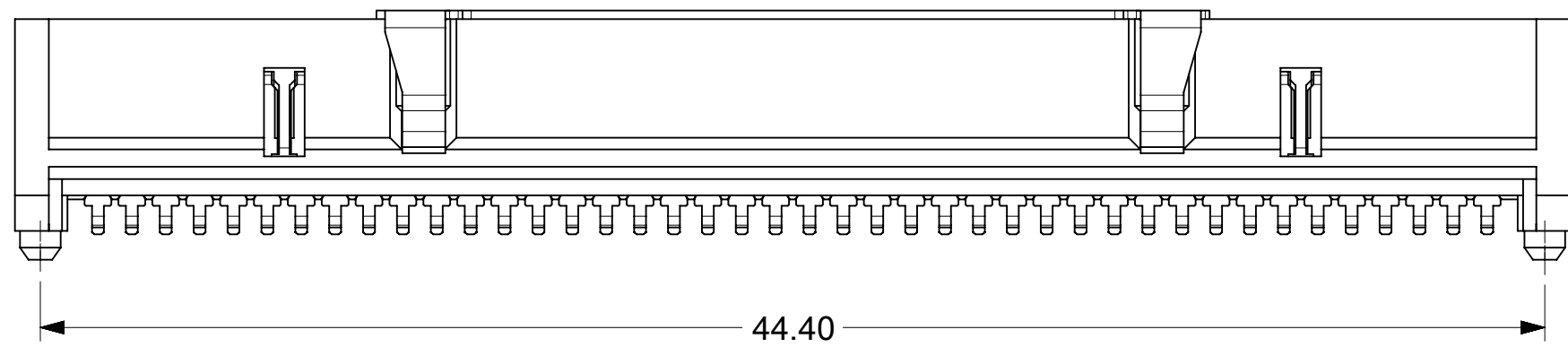

**RECOMMENDED PCB LAYOUT WITH PEGS**

RECOMMENDED PCB THICKNESS: 1.0±0.1 mm MIN.

**RECOMMENDED PCB LAYOUT**

RECOMMENDED PCB THICKNESS: 1.0±0.1 mm MIN.

**PLATINGS:**

- X21 - .76 MICROMETERS MINIMUM GOLD PLATE IN SELECT AREA, 1.91 MICROMETERS MINIMUM TIN PLATE IN SELECT AREA, OVER NICKEL UNDERPLATE.
- X71 - .25 MICROMETERS MINIMUM GOLD PLATE IN SELECT AREA, 1.02 MICROMETERS MINIMUM TIN PLATE IN SELECT AREA, OVER NICKEL UNDERPLATE.

SYMBOLS										THIS DRAWING CONTAINS INFORMATION THAT IS PROPRIETARY TO MOLEX ELECTRONIC TECHNOLOGIES, LLC AND SHOULD NOT BE USED WITHOUT WRITTEN PERMISSION																																																																					
DIMENSION UNITS					SCALE					CURRENT REV DESC: REDRAWN IN NX																																																																					
mm					5:1																																																																										
GENERAL TOLERANCES (UNLESS SPECIFIED)																																																																															
ANGULAR TOL ± 0.5°																																																																															
4 PLACES ±										EC NO: 610884																																																																					
3 PLACES ±										DRWN: TTAO03					2018/12/10																																																																
2 PLACES ± 0.18										CHK'D: JKACHLIC					2019/02/01																																																																
1 PLACE ± 0.33										APPR: JKACHLIC					2019/02/01																																																																
0 PLACES ±										INITIAL REVISION:																																																																					
DRAFT WHERE APPLICABLE MUST REMAIN WITHIN DIMENSIONS					THIRD ANGLE PROJECTION					DRAWING					SERIES																																																																
					C-SIZE					71741																																																																					
DOCUMENT STATUS										P1										RELEASE DATE										2019/02/01 01:16:47																																																	
DOCUMENT NUMBER										717412000										DOC TYPE										PSD										DOC PART										000										REVISION										A1									
MATERIAL NUMBER										SEE TABLE										CUSTOMER										GENERAL MARKET										SHEET NUMBER										1 OF 2																													

**molex**

SALES ASSY, 1.0MM 84 CKT BTB PLUG  
2.30 MM STACK HEIGHT

PRODUCT CUSTOMER DRAWING

717412000 PSD 000 A1

SEE TABLE GENERAL MARKET 1 OF 2

PART NUMBER	PEGS	PICK & PLACE CAP	PACKAGING SPEC. NUMBER	PACKAGING TYPE	TERMINAL PLATING SEE SHEET 1
71741-2001	YES	YES	PK-70873-063	TAPE & REEL	X21
71741-2002	NO	YES	PK-70873-063	TAPE & REEL	X21

RECOMMENDED PLUG/RECEPTACLE COMBINATION FOR MATED STACK HEIGHT PER EIA STANDARD 700 AAAB

MATED STACK HEIGHT	RECEPTACLE HEIGHT	RECEPTACLE SERIES NO.	PLUG HEIGHT	PLUG SERIES NO.
8.00	5.30	71742-0***	2.30	71741-2***
13.00	10.30	71742-3***		

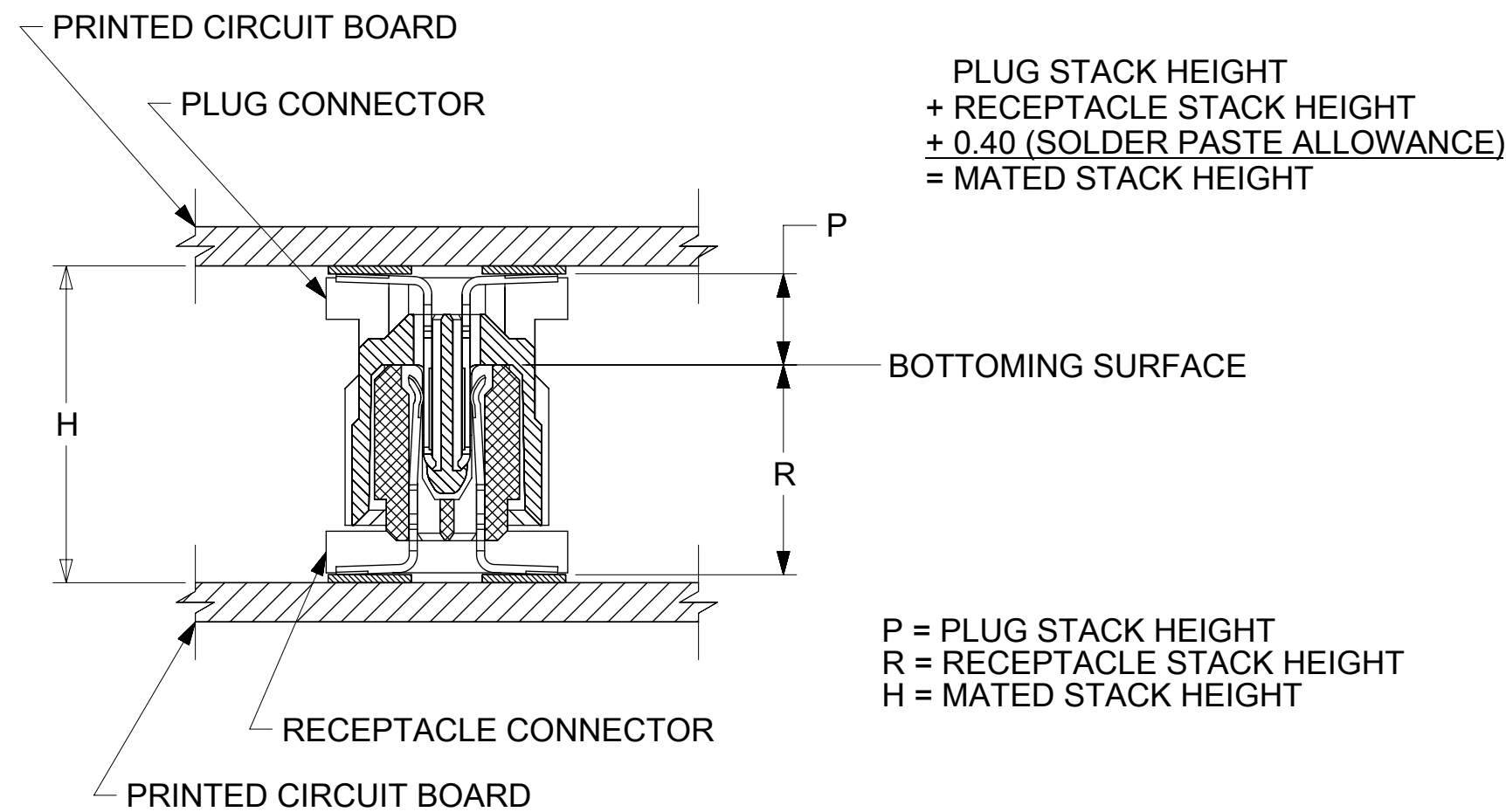

THIS DRAWING CONTAINS INFORMATION THAT IS PROPRIETARY TO MOLEX ELECTRONIC TECHNOLOGIES, LLC AND SHOULD NOT BE USED WITHOUT WRITTEN PERMISSION											
SYMBOLS		DIMENSION UNITS		SCALE		CURRENT REV		DESC: REDRAWN IN NX			
▽ = 0	mm										
▽ = 0	GENERAL TOLERANCES (UNLESS SPECIFIED)										
▽ = 0	ANGULAR TOL ± 0.5°										
▽ = 0	4 PLACES ±										
▽ = 0	3 PLACES ±										
▽ = 0	2 PLACES ± 0.18										
▽ = 0	1 PLACE ± 0.33										
▽ = 0	0 PLACES ±										
▽ = 0	DRAFT WHERE APPLICABLE MUST REMAIN WITHIN DIMENSIONS		THIRD ANGLE PROJECTION		DRAWING		SERIES		MATERIAL NUMBER		
▽ = 0			C-SIZE		71741		95/08/14		95/08/14		
DOCUMENT STATUS				P1		RELEASE DATE		2019/02/01 01:16:47			

**molex**

SALES ASSY, 1.0MM 84 CKT BTB PLUG  
2.30 MM STACK HEIGHT

PRODUCT CUSTOMER DRAWING

DOCUMENT NUMBER  
**717412000**

DOC TYPE DOC PART REVISION  
PSD 000 A1

CUSTOMER  
GENERAL MARKET

SHEET NUMBER  
2 OF 2

