

- 1
- 2
- 3
- 4
- 5
- 6
- 7
- 8
- 9
- 10
- 11
- 12
- 13
- 14
- 15
- 16
- 17
- 18

MATERIAL

Glass-fibre reinforced polyamide based (PA) technopolymer, RAL 5005 blue colour, matte finish.

Produced from FDA compliant raw material (FDA CFR.21 and EU 10/2011).

MOUNTING

Threaded blind hole.

FEATURES AND APPLICATIONS

The RAL 5005 blue colour is easily visible in case of accidental food contamination.

Particularly suitable for applications in the food and pharmaceutical industries.



ELESA Original design

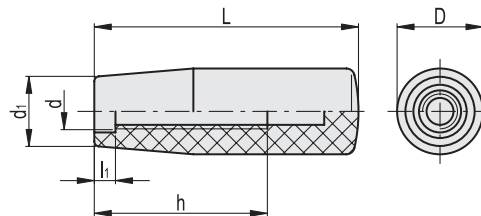

Conversion Table	
1 mm = 0.039 inch	
L	
mm	inch
80	3.15

METRIC

Code	Description	D	L	d	d1	h	l1	⚖️
194307	I.780/80-M10-VD	26.5	80	M10	21	55	7	45