

THIS DRAWING IS UNPUBLISHED. RELEASED FOR PUBLICATION  
 © COPYRIGHT - By - ALL RIGHTS RESERVED.

| LOC |     | DIST        |      | REVISIONS                 |         |    |     |
|-----|-----|-------------|------|---------------------------|---------|----|-----|
| P   | LTR | DESCRIPTION | DATE | DWN                       | APVD    |    |     |
|     |     | Z1          |      | REVISED PER ECO-11-004917 | 11MAR11 | RK | HMR |

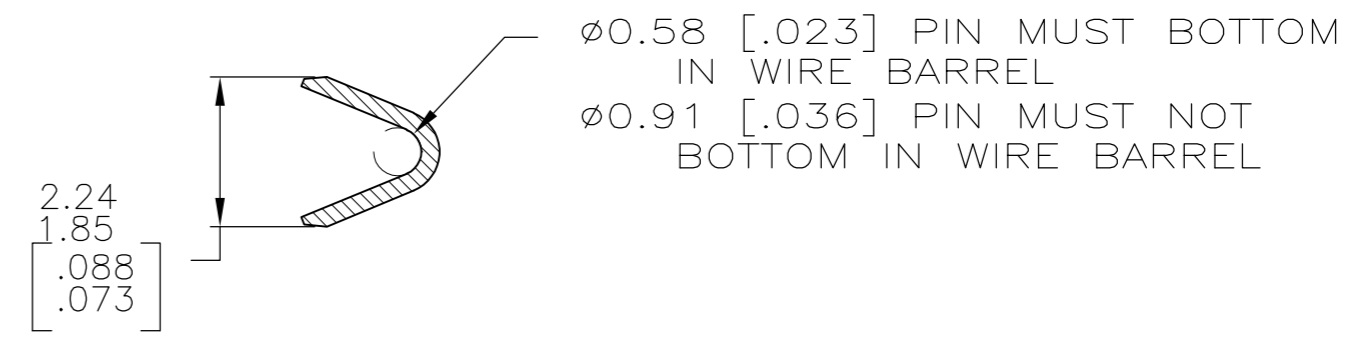
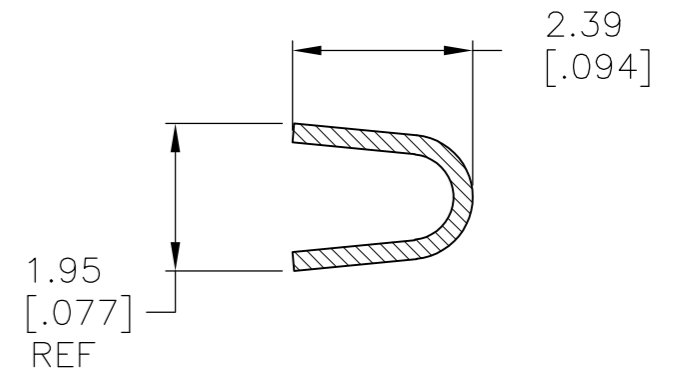
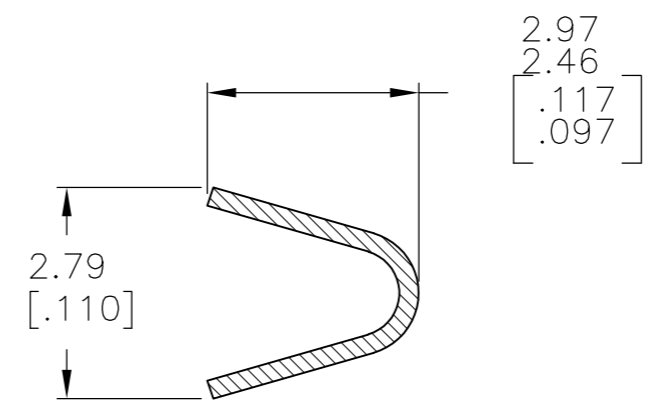
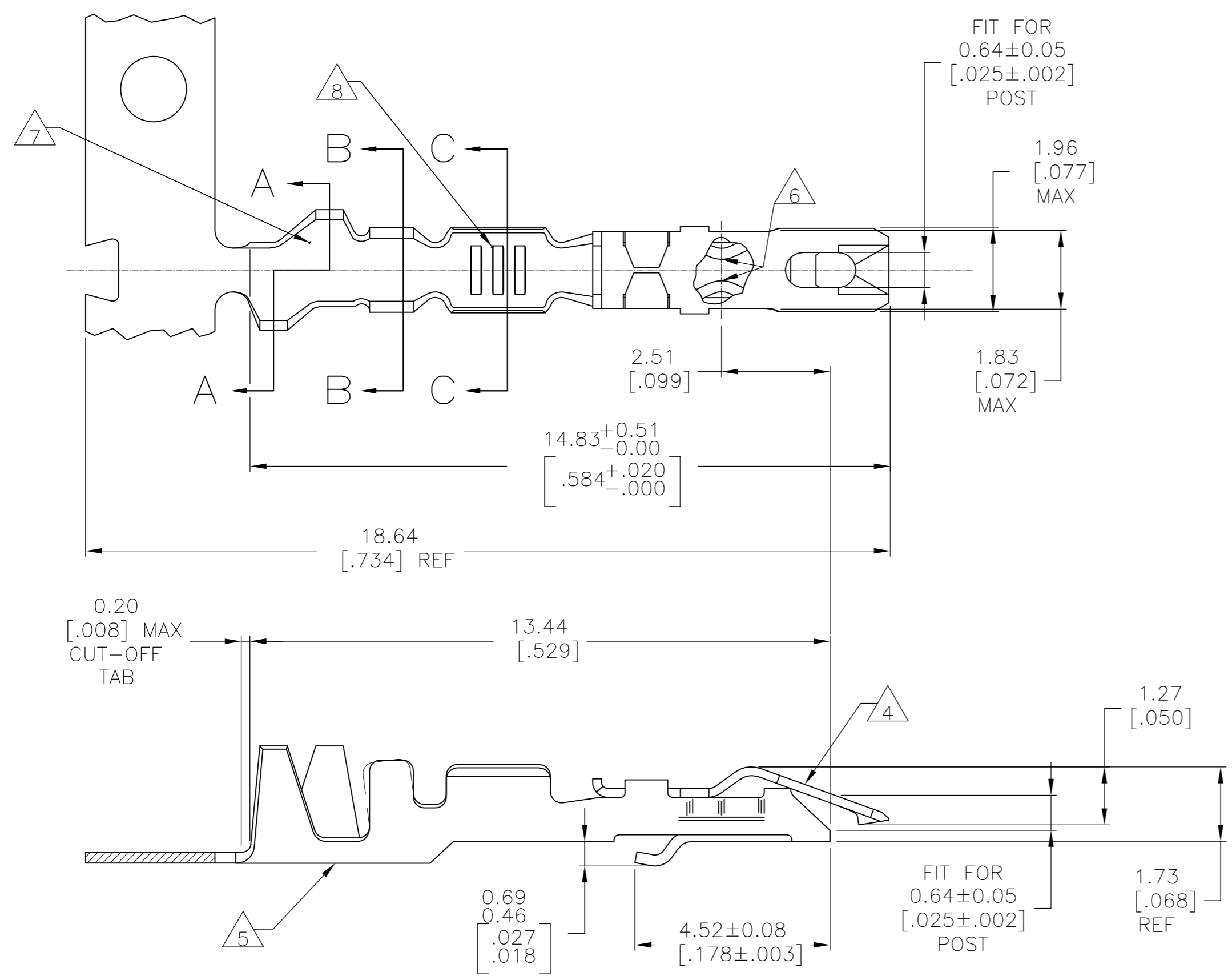

- 1. REELED FOR MINI APPLICATOR.
- 2 PLATED WITH .00254 [.000100] TIN LEAD OVER .00127 [.000050] NICKEL ENTIRE CONTACT.
- 3 PLATED WITH .00076 [.000030] GOLD IN CONTACT AREA, GOLD FLASH ON REMAINDER, OVER .00127 [.000050] NICKEL.
- 4 SPRING MATERIAL: STAINLESS STEEL.
- 5 BODY MATERIAL: PHOSPHORUS BRONZE (SEE TABLE FOR FINISH.)
- 6 POINT OF PLATING MEASUREMENT.
- 7 INSULATION BARREL RANGE ø0.71 [.038]-ø1.57 [.062].
- 8 WIRE BARREL RANGE #20
- 9 PLATED WITH .00254 (.000100) TIN OVER .00127 (.000050) NICKEL, ENTIRE CONTACT.

SUPERSEDED BY 5-867052-1

|        |             |
|--------|-------------|
| 9      | 5-867052-1  |
| 9      | 867052-3    |
| 3      | 867052-2    |
| 2      | 867052-1    |
| FINISH | PART NUMBER |

|  |  |                  |             |            |          |  |               |
|--|--|------------------|-------------|------------|----------|--|---------------|
| THIS DRAWING IS A CONTROLLED DOCUMENT. |  | DWN              | E.BRANDBERG | 17-1-93    |          | TE Connectivity                                    |               |
| DIMENSIONS: mm [INCHES]                |  | CHK              | S. SHUEY    | 26-1-93    |          | CONTACT ASS'Y, LOCKING CLIP. FOR .025 SQUARE POST. |               |
| TOLERANCES UNLESS OTHERWISE SPECIFIED: |  | APVD             | -           | -          | NAME     | -  |               |
| 0 PLC ± -                              |  | PRODUCT SPEC     | 108-36028   | -          |          |  |               |
| 1 PLC ± -                              |  | APPLICATION SPEC | 114-25006   | SIZE       | A2       | CAGE CODE  | 00779         |
| 2 PLC ± -                              |  | WEIGHT           | -           | DRAWING NO | C=867052 |  | RESTRICTED TO |
| 3 PLC ± 0.13[.005]                     |  | CUSTOMER DRAWING |             | SCALE      | 10:1     | SHEET  | 1 OF 1        |
| 4 PLC ± -                              |  | SCALE            |             | 10:1       | REV      |  | Z1            |
| ANGLES ± -                             |  | SCALE            |             | 10:1       | REV      |  | Z1            |
| FINISH AS SHOWN                        |  | SCALE            |             | 10:1       | REV      |  | Z1            |