

# High Performance Power Line Filter for Medical Applications

AMI-M11F/11G/12O/12P Series



AMI Designation	Input/output Style				Current Rating	Inductance mH	Capacitance		Resistor K $\Omega$	Leakage Current @ 120 VAC 60Hz/250 VAC 50 Hz	TIL Insertion Loss	Case Style
							Cx nF	Cy pF		$\mu$ A		
Available Part Numbers	0.250 Spade Terminals	Wire Leads	Threaded Bolts	IEC Socket Spade/Terminal								
AMI-M11F-1-3-A	1	-	-	-	3	36.8	940	0	330	2 $\mu$ A/5 $\mu$ A	001	A
AMI-M11F-1-6-A	1	-	-	-	6	18.5	940	0	330	2 $\mu$ A/5 $\mu$ A	002	A
AMI-M12O-1-10-A	1	-	-	-	10	9.5	1770	0	330	2 $\mu$ A/5 $\mu$ A	003	A
AMI-M12P-1-15-A	1	-	-	-	15	5.07	2072	0	330	2 $\mu$ A/5 $\mu$ A	004	B
AMI-M11F-3-3-A	-	3	-	-	3	36.8	940	0	330	2 $\mu$ A/5 $\mu$ A	001	C
AMI-M11F-3-6-A	-	3	-	-	6	18.5	940	0	330	2 $\mu$ A/5 $\mu$ A	002	C
AMI-M12O-3-10-A	-	3	-	-	10	9.5	1770	0	330	2 $\mu$ A/5 $\mu$ A	003	C
AMI-M11G-7-3-A	-	-	-	7	3	36.8	940	0	330	2 $\mu$ A/5 $\mu$ A	001	E
AMI-M11G-7-6-A	-	-	-	7	6	18.5	1089	0	330	2 $\mu$ A/5 $\mu$ A	002	E
AMI-M12P-6-15-A	-	-	6	-	15	5.07	2072	0	330	2 $\mu$ A/5 $\mu$ A	004	D
AMI-M11G-7M-3-A	-	-	-	7M	3	36.8	940	0	330	2 $\mu$ A/5 $\mu$ A	001	E
AMI-M11G-7M-6-A	-	-	-	7M	6	18.5	1089	0	330	2 $\mu$ A/5 $\mu$ A	002	E

## Electrical Schematic

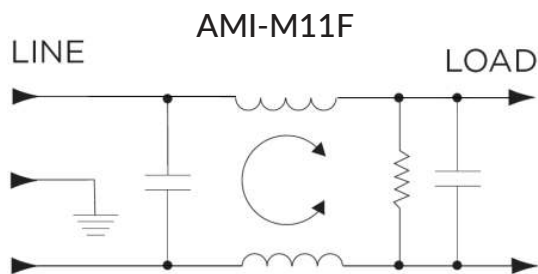

# High Performance Power Line Filter for Medical Applications

## Electrical Schematic

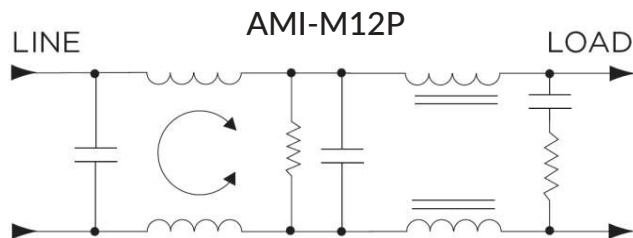
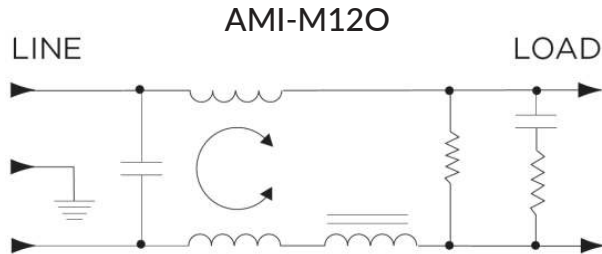
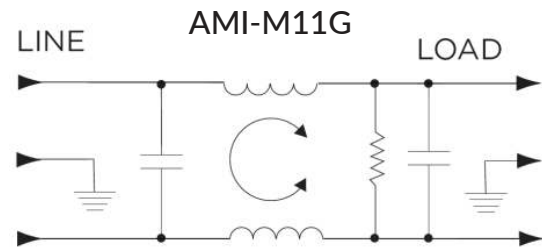

## Specifications:

- Rated Voltage (max): 250 VAC
- Operating Frequency: 50/60 Hz
- Operating Current: 3 to 15 A
- Hi-pot Rating (one minute): Line to Ground: 2250 VDC  
Line to Line: 1450 VDC
- Operating Ambient Temperature Range (at rated current  $I_r$ ): -10°C to +40°C. In an ambient temperature ( $T_a$ ) higher than +40°C the maximum operating current ( $I_o$ ) is calculated as follows:  $I_o = I_r \sqrt{[(85 - T_a) / 45]}$

# High Performance Power Line Filter for Medical Applications

## Performance Data Typical Insertion Loss

Measured in closed 50 Ohm system

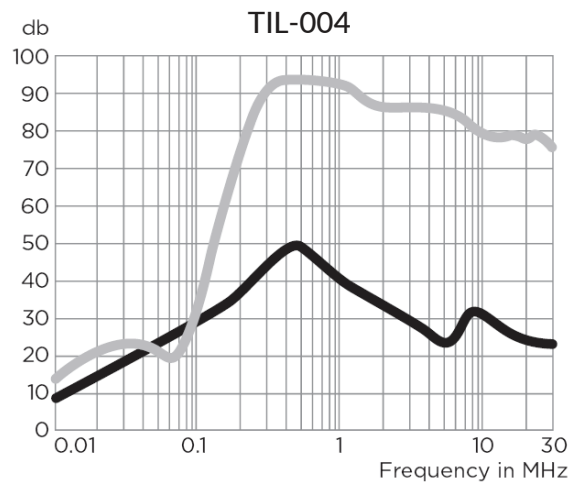
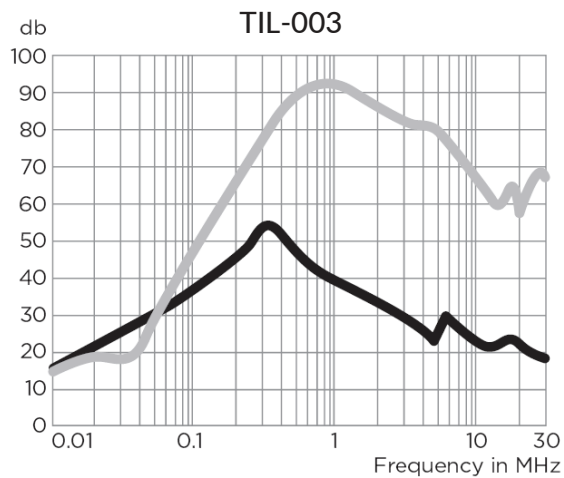
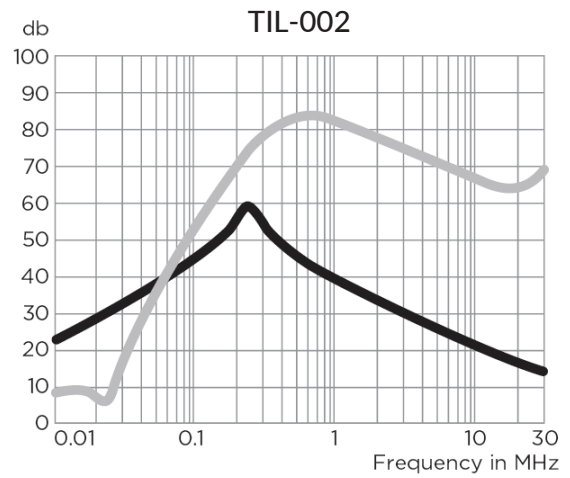
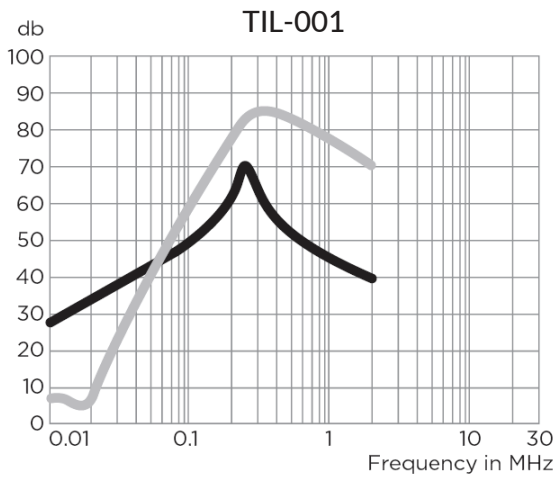

# High Performance Power Line Filter for Medical Applications

## Minimum Insertion Loss

### Common Mode/Asymmetrical (Line to Ground)

Current Rating	Frequency-MHz									
Part Number	0.02	0.05	0.15	0.5	1	2	5	10	20	30
AMI-M11F/11G-X-3-A	22	36	49	46	40	30	22	12	12	12
AMI-M11F/11G-X-6-A	16	32	46	41	33	26	15	9	6	2
AMI-M12O-X-10-A	9	24	36	42	34	22	12	12	8	8
AMI-M12P-X-15-A	4	18	27	41	34	22	22	12	5	2

### Differential Mode/Symmetrical (Line to Line)

Current Rating	Frequency-MHz									
Part Number	0.02	0.05	0.15	0.5	1	2	5	10	20	30
AMI-M11F/11G-X-3-A	3	30	61	70	65	65	48	40	32	32
AMI-M11F/11G-X-6-A	4	14	51	70	70	65	55	47	37	37
AMI-M12O-X-10-A	7	17	52	70	70	70	65	55	40	35
AMI-M12P-X-15-A	12	15	51	70	70	70	70	70	65	55

# High Performance Power Line Filter for Medical Applications

## Case Styles

### STYLE A

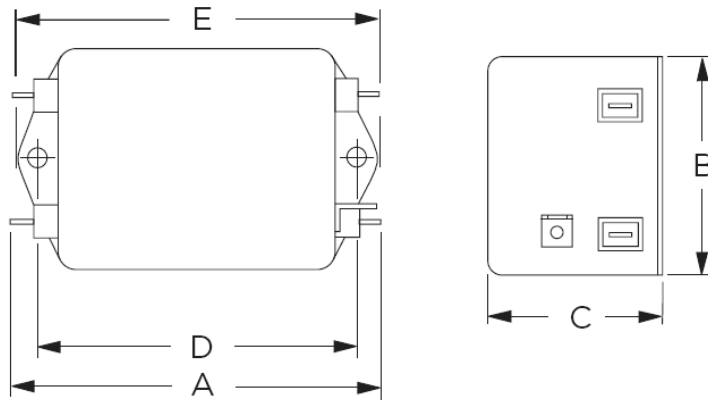

Typical Dimensions:

Line/Load Terminals (4):	.250 [6.3] with .07 [1.8] Dia. hole
Ground Terminal (1):	.250 [6.3] with .07 x .16 [1.8 x 3.8] slot
Mounting Holes (2):	.188 [4.78] Dia.

### STYLE B

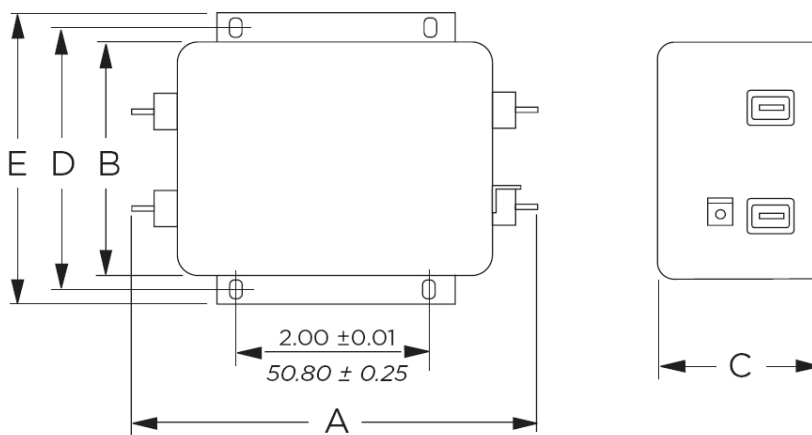

Typical Dimensions:

Line/Load Terminals (4):	.250 [6.3] with .07 [1.8] Dia. hole
Ground Terminal (1):	.250 [6.3] with .07 x .16 [1.8 x 3.8] slot
Mounting Slots (4):	.203 x .156 [5.16 x 3.96] Dia.

# High Performance Power Line Filter for Medical Applications

## Case Styles

### STYLE C

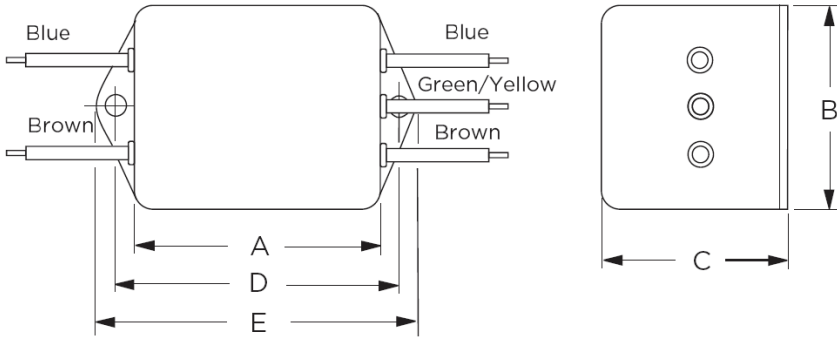

Typical Dimensions:

6A Wire Leads (5):	4.0 [101.6] Min., 18AWG
10A Wire Leads (5):	6.0 [152.4] Min., 18AWG
Mounting Holes (2):	.188 [4.78] Dia.

### STYLE D

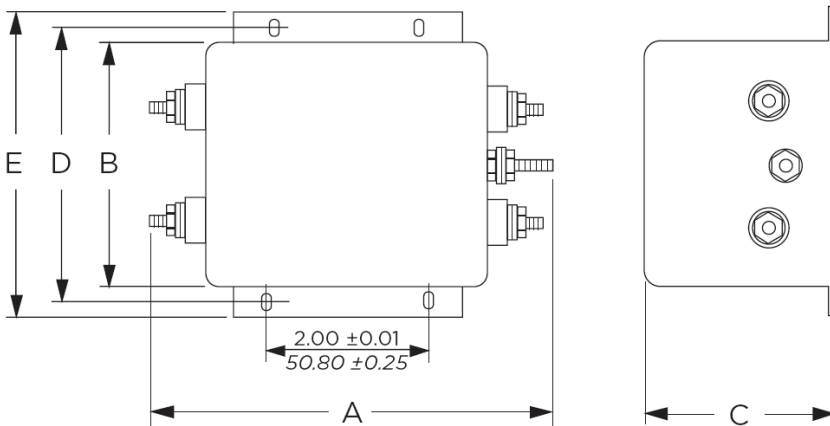

Typical Dimensions:

Terminals (5):	8-32, Torque 18 lbf-in. [2.03 N-m] max. $\pm 2$ [.22]
Mounting Slots (4):	.203 x .156 [5.16 x 3.96] Dia.

# High Performance Power Line Filter for Medical Applications

## Case Styles

### STYLE E

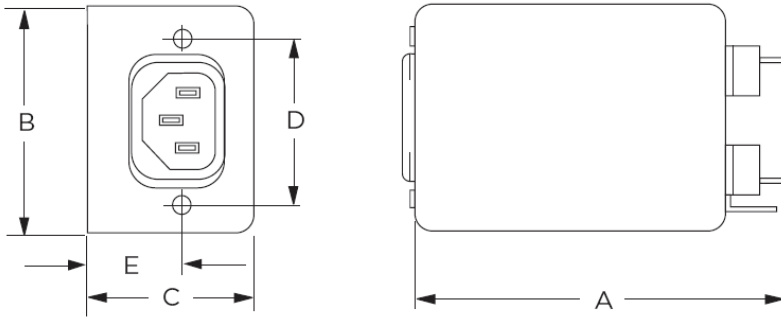

#### Typical Dimensions:

Load Terminals (2):	.250 [6.3] with .07 [1.8] Dia. hole
Ground Terminal (1):	.250 [6.3] with .07 x .16 [1.8 x 3.8] slot
Line Inlet (1):	IEC 60320-1 C14
7 Tapped Inserts (2):	6-32 x 1/4
7M Tapped Inserts (2):	M3 x .5

## Recommended Panel Cutout

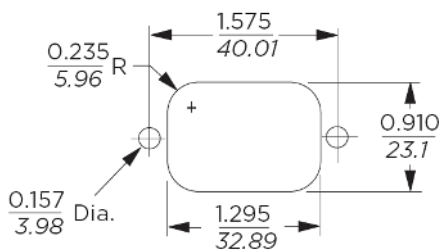

Tolerance  $\pm .005$  [0.13]

# High Performance Power Line Filter for Medical Applications

## Case Dimensions:

Model Number	A max	B max	C max	D $\begin{smallmatrix} \pm .01 \\ \pm .25 \end{smallmatrix}$	E max
AMI-M11F-1-3/6-A	3.56"/90.4mm	2.15"/54.6mm	1.81"/46.0mm	2.938"/74.63mm	3.38"/85.9mm
AMI-M11F-3-3/6-A	2.55"/64.8mm	2.15"/54.6mm	1.81"/46.0mm	2.938"/74.63mm	2.78"/70.61mm
AMI-M11G-7/7M-3/6-A	3.52"/89.4mm	2.25"/57.2mm	1.78"/45.2mm	1.575"/40.01mm	*0.63/16.0mm
AMI-M12O-1-10-A	4.69"/119.1mm	2.27"/57.7mm	1.8"/45.7mm	4.063"/103.2mm	4.47"/113.5mm
AMI-M12O-3-10-A	3.69"/93.7mm	2.27"/57.7mm	1.8"/45.7mm	4.063"/103.2mm	4.47"/113.5mm
AMI-M12P-1-15-A	5.45"/138.4mm	3.12"/79.2mm	2.18"/55.4mm	3.5"/88.9mm	3.96/100.6mm
AMI-M12P-6-15-A	5.95"/151.1mm	3.12"/79.2mm	2.18"/55.4mm	3.5"/88.9mm	3.96/100.6mm

\*±0.02/0.5