

## 228604-1 Product Details

**Live Product Chat** US Only  
8:30am - 5pm ET, Mon - Fri

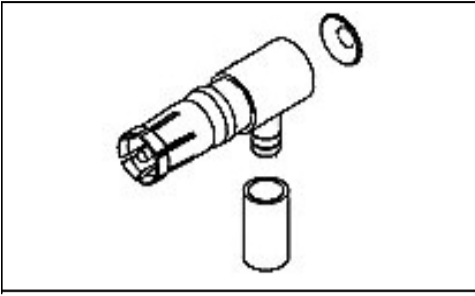

**228604-1**

**STOP** [Obsolete](#)  
[Contact Product Information Center](#)

### Multiple Coaxial Contacts (COAXICON)

[Not EU RoHS or ELV Compliant](#)

#### Product Highlights:

- Contact
- Socket
- Terminate To Coaxial Cable
- Cable Type = Belden 9221, RG 161, RG 174, RG 179, RG 179A, RG 179B, RG 188, RG 188A, RG 316
- Connector Impedance = Non-Matched ?

[View all Features](#) | [Find Similar Products](#)

### Quick Links

- [Check Pricing & Availability](#)
- [Search for Tooling](#)
- [Product Feature Selector](#)
- [Contact Us About This Product](#)

### Documentation & Additional Information

#### Product Drawings:

- None Available

#### Catalog Pages/Data Sheets:

- None Available

#### Product Specifications:

- [PRODUCT SPECIFICATION, CONTACT, COAXIAL, 50 OHM AND ...](#) (PDF, English)

#### Application Specifications:

- None Available

#### Instruction Sheets:

- [Size 8 Coaxial RF 50-Ohm and Non-Impedance Mached Pi...](#) (PDF, English)
- [Extraction Tool](#) (PDF, English)

#### CAD Files:

- None Available

#### Additional Information:

- [Product Line Information](#)

#### Related Products:

- [Tooling](#)

[List all Documents](#)

### Product Features (Please use the Product Drawing for all design activity)

#### Product Type Features:

- [Product Type](#) = Contact
- [Pin/Socket](#) = Socket
- [Body Style](#) = Right Angle
- Mating Contact Retention = Without
- [Connector Family](#) = AMP-HDI, Subminiature D Series 109
- Outer Shell Material = Beryllium Copper per QQ-C-530

#### Electrical Characteristics:

- [Connector Impedance \(?\)](#) = Non-Matched

#### Body Related Features:

- Outer Shell Plating = Bright Tin-Lead per ASTM-B-571
- Ferrule Material = Brass
- Ferrule Plating = Tin-lead

#### Contact Related Features:

- [Contact Type](#) = Coax
- [Contact Size](#) = 8
- Contact Mating Area Plating = Gold (30)
- Center Contact Material = Brass per QQ-B-626 and MIL-C-50

#### Configuration Related Features:

- [Cable Type](#) = Belden 9221, RG 161, RG 174, RG 179, RG 179A, RG 179B, RG 188, RG 188A, RG 316

#### Industry Standards:

- [RoHS/ELV Compliance](#) = Not ELV/RoHS compliant
- [Lead Free Solder Processes](#) = Wave solder capable to 240°C, Wave solder capable to 260°C, Wave solder capable to 265°C, Reflow solder capable to 245°C, Reflow solder capable to 260°C, Pin-in-Paste capable to 245°C, Pin-in-Paste capable to 260°C

#### Conditions for Usage:

- [Terminate To](#) = Coaxial Cable

#### Other:

- Brand = AMP