

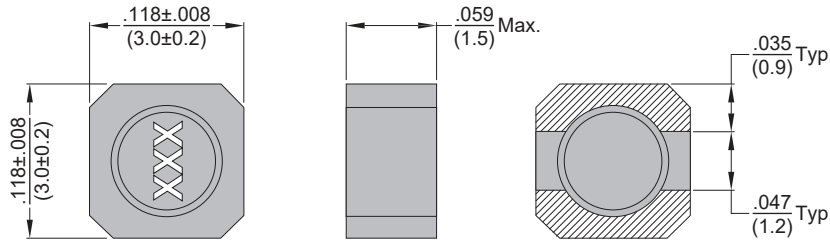

Shielded Power Inductor

PCS3X15

Dimensions: $\frac{\text{Inches}}{\text{(mm)}}$



Allied Part Number	Inductance (μH)	Tolerance (±%)	Test Freq. (KHz)	DCR (Ω) Max	Isat (A) Max	Irms (A) Typ	Marking
PCS3X15-1R0M	1.0	20	100, 0.1V	.075	2.0	2.0	1R0
PCS3X15-1R5M	1.5	20	100, 0.1V	.100	1.8	1.7	1R5
PCS3X15-1R8M	1.8	20	100, 0.1V	.100	1.5	1.4	1R8
PCS3X15-2R1M	2.1	20	100, 0.1V	.110	1.5	1.4	2R1
PCS3X15-2R2M	2.2	20	100, 0.1V	.110	1.5	1.4	2R2
PCS3X15-3R3M	3.3	20	100, 0.1V	.130	1.3	1.4	3R3
PCS3X15-4R7M	4.7	20	100, 0.1V	.200	1.1	1.2	4R7
PCS3X15-6R8M	6.8	20	100, 0.1V	.300	.91	.90	6R8
PCS3X15-100M	10	20	100, 0.1V	.440	.65	.75	100
PCS3X15-150M	15	20	100, 0.1V	.700	.55	.59	150
PCS3X15-180M	18	20	100, 0.1V	.750	.53	.58	180
PCS3X15-220M	22	20	100, 0.1V	.825	.49	.57	220
PCS3X15-330M	33	20	100, 0.1V	1.30	.42	.48	330
PCS3X15-470M	47	20	100, 0.1V	1.55	.32	.40	470
PCS3X15-680M	68	20	100, 0.1V	2.25	.28	.33	680
PCS3X15-101M	100	20	100, 0.1V	3.40	.23	.26	101
PCS3X15-471M	470	20	100, 0.1V	15.0	.11	.11	471

All specifications subject to change without notice.

Features

- SMD Power Inductor
- Magnetically shielded
- Low DC resistance
- MSL Level 1

Electrical

Inductance Range: 1.0μH to 470μH

Tolerance: ±20% throughout series

Operating Temp: -40°C to +125°C

Isat: Current at which Inductance drops by no more than 30% of initial value

Irms: Current that causes the temperature to rise (ΔT=40°C) from 25°C ambient.

Schematic

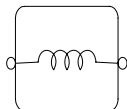

Recommended Pad Layout

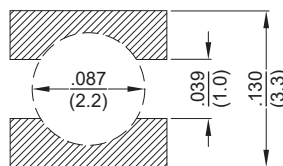

Physical

Packaging: 1000 pieces per 7 inch reel

Marking: EIA Code