

THIS IS A C.A.D. GENERATED DRAWING
DO NOT MAKE MANUAL REVISIONS TO MASTER.

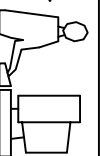

ISSUE NUMBER
ORIGINAL

①

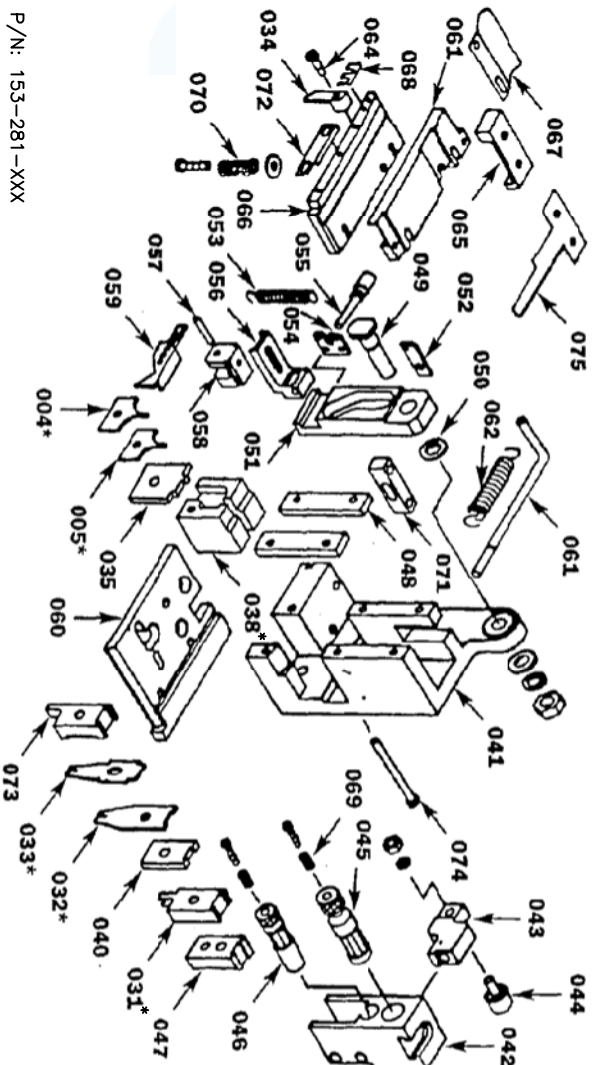
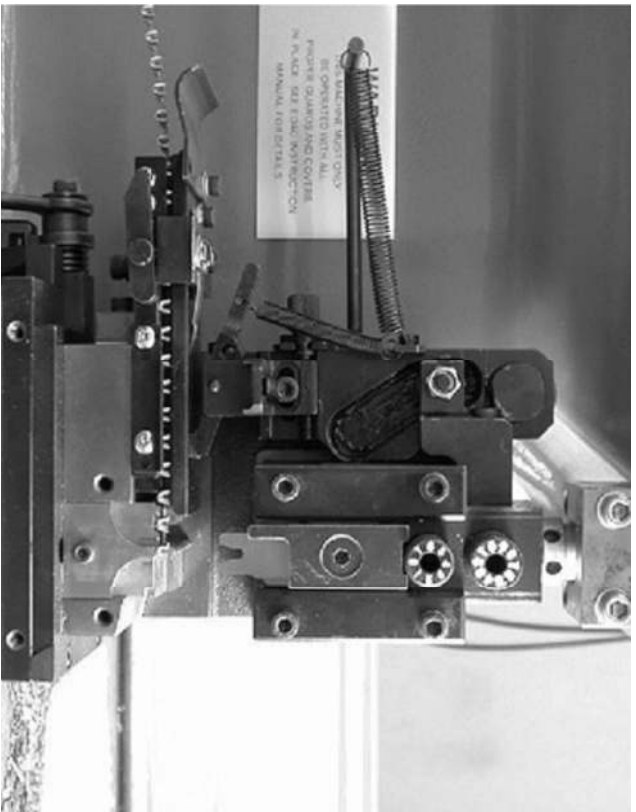

P/N: 153-281-XXX

PRESS TYPE	EDAC PRESS
STROKE LENGTH	30.00 MM
SHUT HEIGHT	119.55 MM
AWG	22-26

REPLACEMENT PUNCH & DIE PARTS					
INSULATOR ANVIL	WIRE ANVIL	WIRE CRIMPER	INSULATOR CRIMPER	CUT OFF PUNCH	ANVIL HOLDER
153-281-004	153-281-005	153-281-032	153-281-033	153-281-031	153-281-038

NOTES:

- 1- THIS APPLICATOR IS DESIGNED TO BE USED ON EDAC CRIMPING MACHINE 516-280-700.
- 2- THIS APPLICATOR IS DESIGNED FOR CRIMPING EDAC CONTACT P/N 153-290-291.
- 3- FOR THE DEFINITION OF STROKE LENGTH AND SHUT HEIGHT, APPLICATOR SETUP AND OPERATING INSTRUCTION, PLEASE REFER TO DOCUMENT "APPLICATOR INSTRUCTION MANUAL EDAC PRESS".

153 SERIES APPLICATOR FOR EDAC PRESS

ACAD REFERENCE NO. 153-280-750

DRAWN: K.L. DATE: OCT.28/2020

CHECKED: R.S.M. DATE: OCT.28/2020

SCALE: N.T.S. SHEET 1 OF 1

DRAWING NUMBER

153-280-750

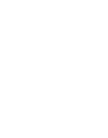

EDAC INC
TORONTO, ONTARIO
CANADA

YOUR CONNECTION TO QUALITY & SERVICE

THESE DRAWINGS AND SPECIFICATIONS ARE THE PROPERTY OF EDAC INC. AND SHALL NOT BE REPRODUCED, OR COPIED OR USED AS THE BASIS FOR THE MANUFACTURE OR SALE OF APPARATUS WITHOUT WRITTEN PERMISSION.

ISSUE

1