

LOC	DIST	REVISIONS			
P	LTN	DESCRIPTION	DATE	DWN	APVD
A		INITIAL RELEASE	31JAN2013	JY	AC

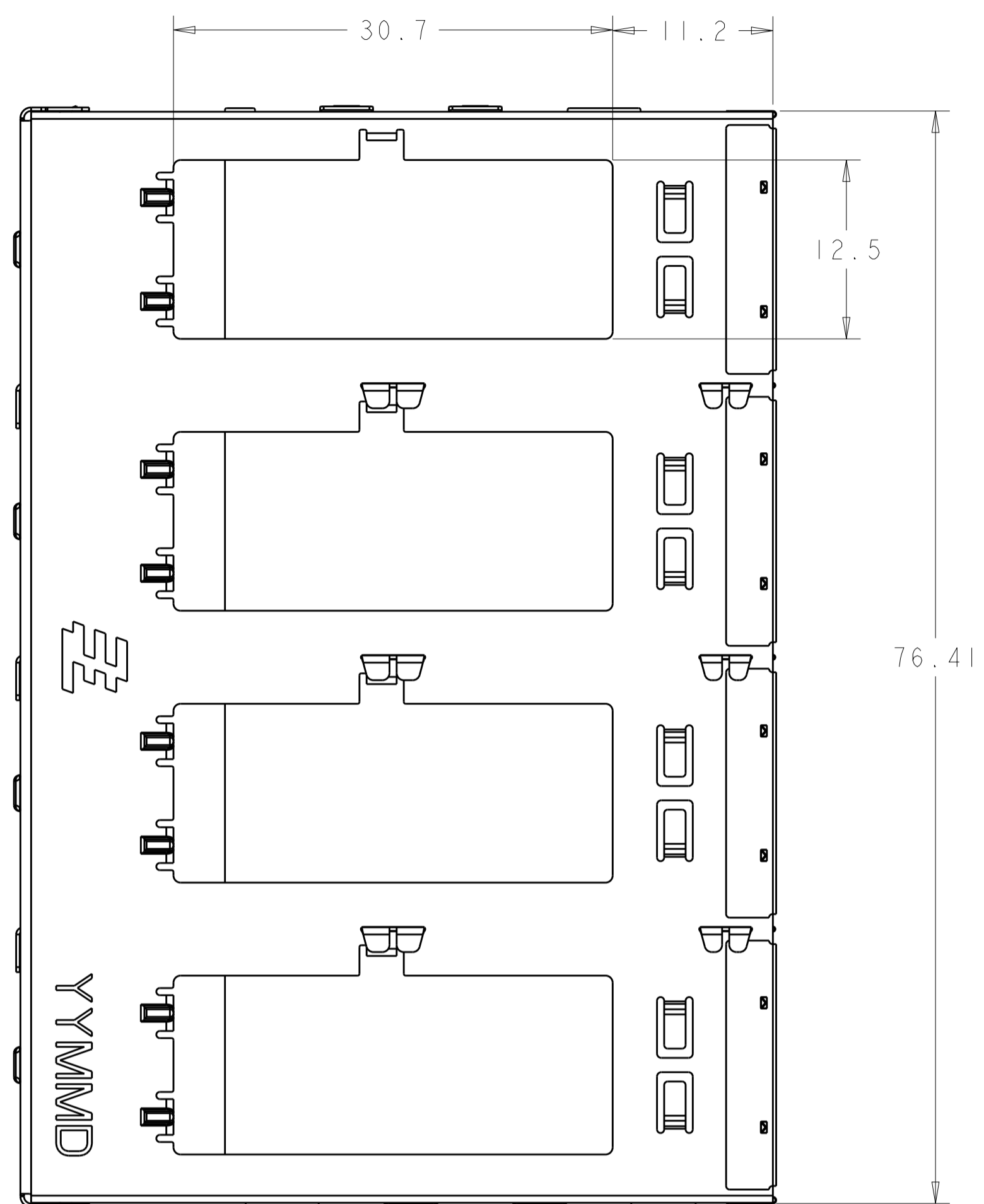

SCALE 3:1

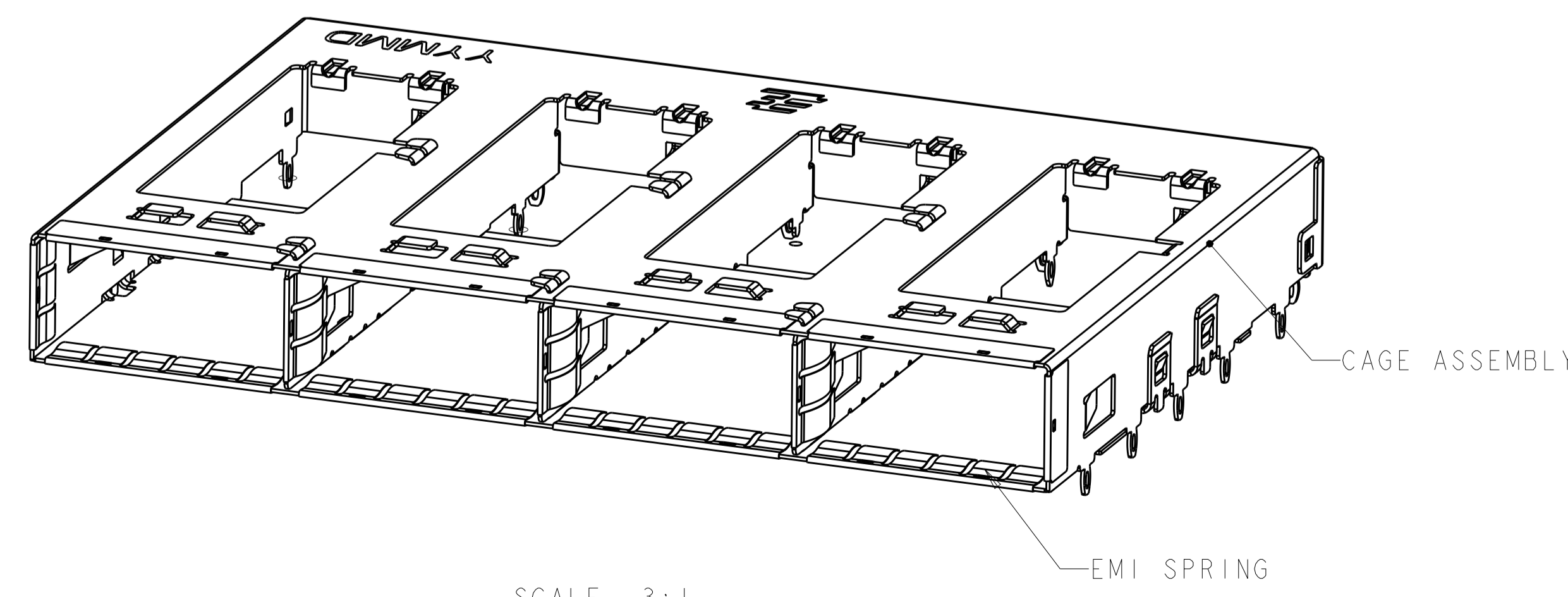
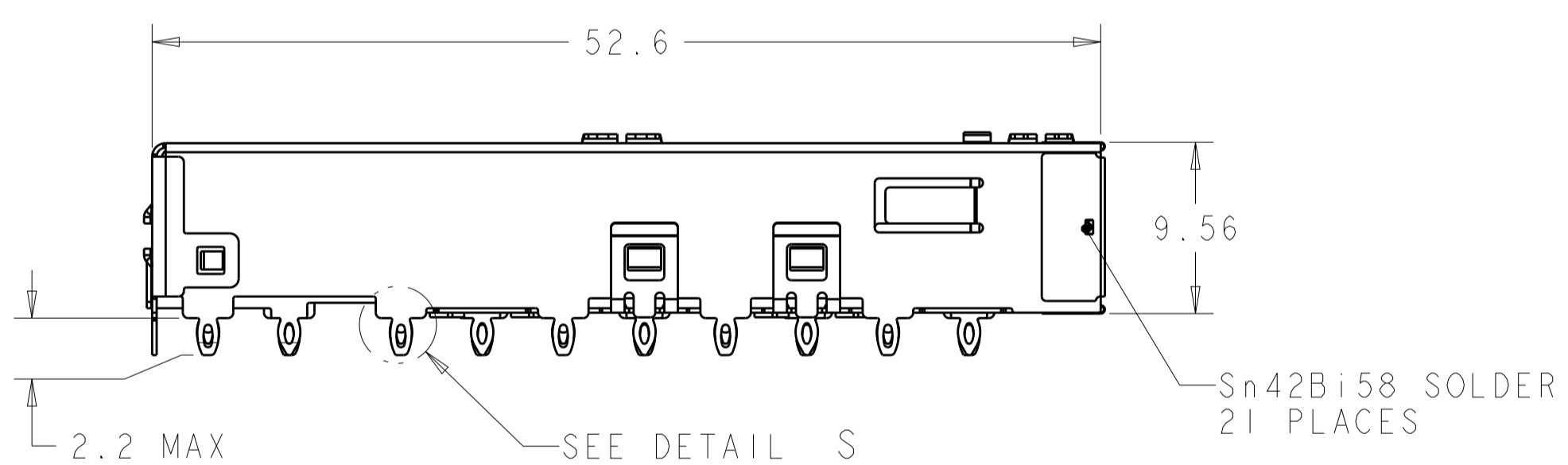

SCALE 3:1

- △ CAGE ASSEMBLY MATERIAL: NICKEL SILVER, 0.25 THICK
EMI SPRING MATERIAL: COPPER ALLOY
- △ PITCH BETWEEN PORTS OF ONE 1X4 CAGE ASSEMBLY.
- △ SPACING BETWEEN CAGES ON THE SAME PC BOARD, TO BE SPECIFIED BY CUSTOMER, MUST COMPLY WITH MINIMUM DIMENSIONS SHOWN.
- △ REFERENCE APPLICATION SPEC 114-13218 FOR RECOMMENDED DRILL HOLE DIAMETER AND PLATING THICKNESS.
- △ DATUMS AND BASIC DIMENSIONS ESTABLISHED BY CUSTOMER.
- △ DIMENSION C IS THE NOMINAL THICKNESS OF CUSTOMER SUPPLIED PC BOARD,
SINGLE SIDED PC BOARD MINIMUM THICKNESS = 1.45mm
DOUBLE SIDED PC BOARD MINIMUM THICKNESS = 2.2mm PER QSFP.
- △ DATUM -A- IS TOP SURFACE OF PC BOARD.
- △ UNPLATED THRU HOLE.
- 9. MATES WITH QSFP MSA COMPATIBLE TRANSCEIVER.
- △10 SURFACE TRACES PERMITTED WITHIN THIS AREA EXCEPT WHERE CAGE STANDOFFS, SHOWN IN DETAIL S, CONTACT PC BOARD.
- △11 BASELINE FOR THESE DIMENSIONS IS THE CENTER OF COMPLIANT PIN HOLE.
- △12 DATE CODE (YYWW) MARKED ON TOP OF CAGE.
- △13 EMI SPRING FINISH: 2µm MINIMUM TIN

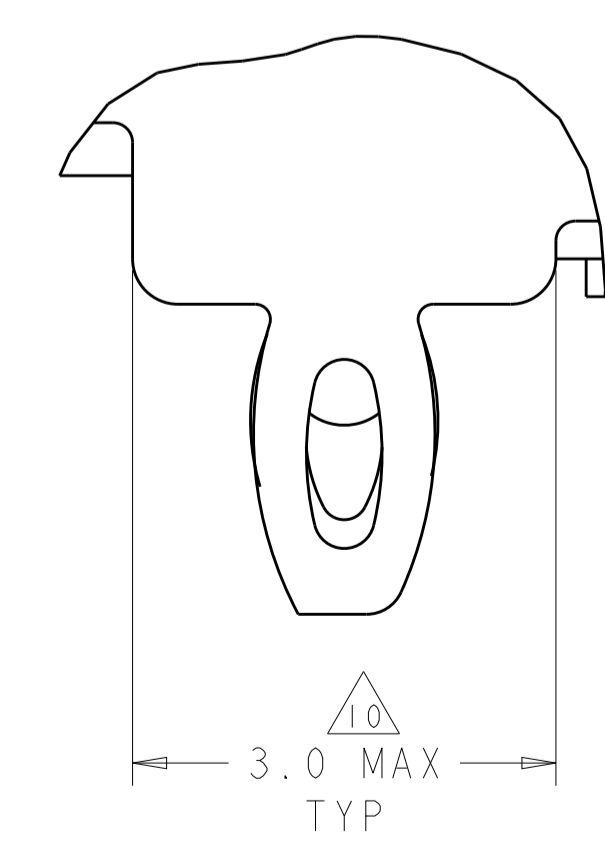
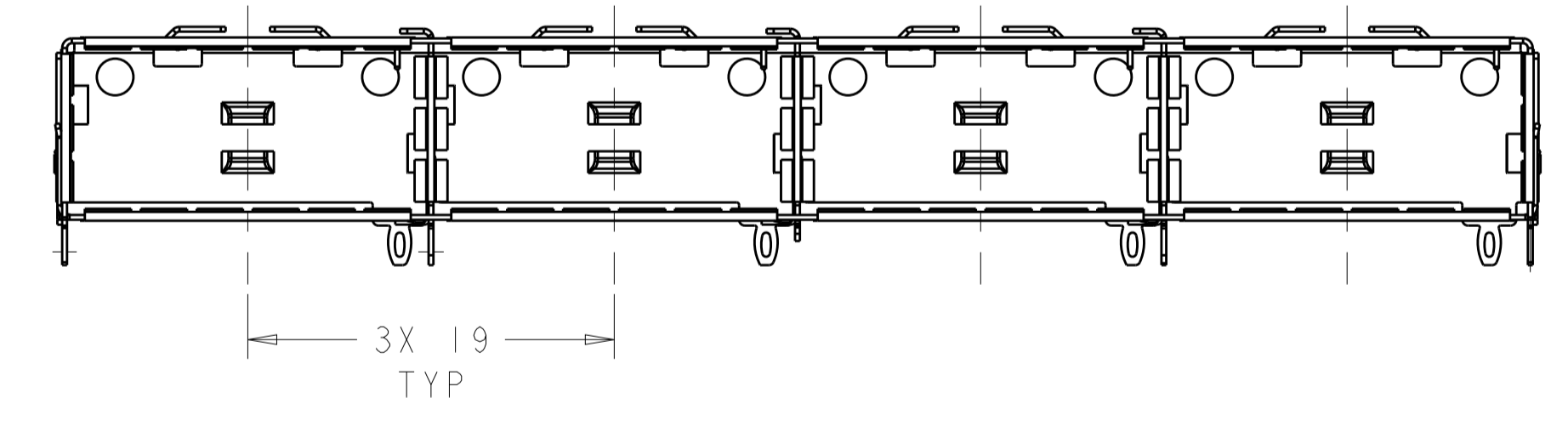

DETAIL S
SCALE 20:1

2170402-1
PART NUMBER

THIS DRAWING IS A CONTROLLED DOCUMENT.		DWN: JASON YANG 22AUG2012	TE Connectivity
DIMENSIONS:		CHK: ALEX CAI 22AUG2012	
TOLERANCES UNLESS OTHERWISE SPECIFIED:		APVD: ALEX CAI 22AUG2012	
mm		NAME: 1X4 QSFP, CAGE ASSEMBLY, W/O FLANGE	
0 PLC	±	PRODUCT SPEC	SIZE: CAGE CODE DRAWING NO
1 PLC	±0.25	108-2286	RESTRICTED TO
2 PLC	±0.15	APPLICATION SPEC	A100779C=2170402
3 PLC	±	114-13218	SCALE: 1:1 SHEET 1 OF 4 REV A
4 PLC	±	WEIGHT	
ANGLES	±	Customer Drawing	
MATERIAL	FINISH		

LOC	DIST	REVISIONS					
GP	00	P.	LTN	DESCRIPTION	DATE	DWN	APVD
-	-	-	-	SEE SHEET 1	-	-	-

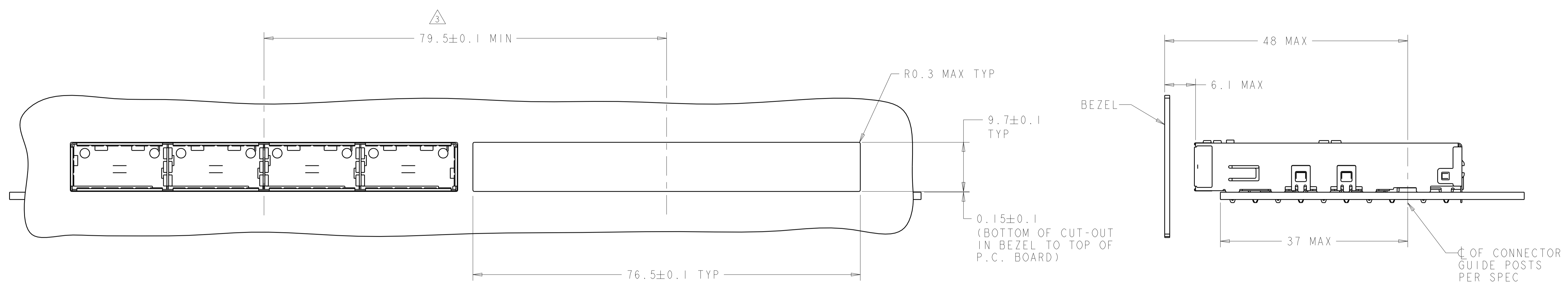

ONE SIDED CONFIGURATION
SCALE 5:2

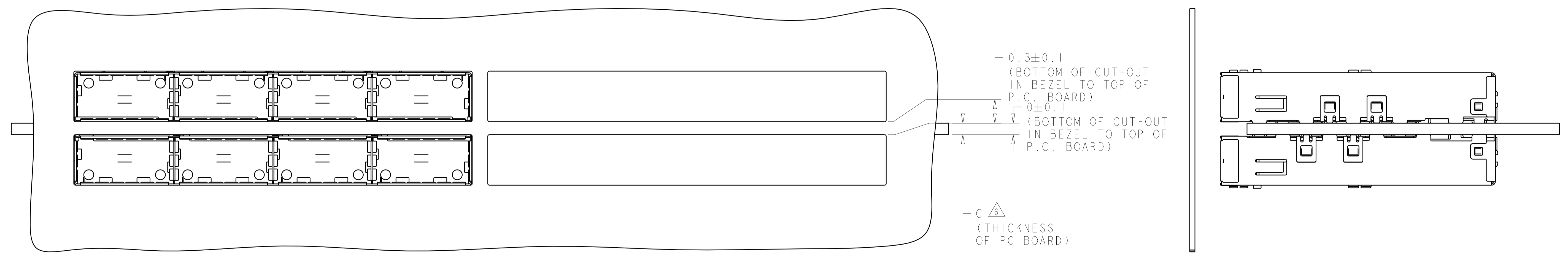

BELLY TO BELLY CONFIGURATION SIMILAR
TO ONE SIDED EXCEPT WHERE NOTED
SCALE 5:2

THIS DRAWING IS A CONTROLLED DOCUMENT.		DWN: JASON YANG 22AUG2012	TE Connectivity
DIMENSIONS: mm		CHK: ALEX CAI 22AUG2012	
TOLERANCES UNLESS OTHERWISE SPECIFIED: 0 PLC ± 1 PLC ±0.25 2 PLC ±0.15 3 PLC ± 4 PLC ± ANGLES ± FINISH		APVD: ALEX CAI 22AUG2012 PRODUCT SPEC 108-2286 APPLICATION SPEC 114-13218 WEIGHT Customer Drawing	NAME: 1X4 QSFP, CAGE ASSEMBLY, W/O FLANGE SIZE: CAGE CODE DRAWING NO A100779C=2170402 RESTRICTED TO:
MATERIAL: -		SCALE: 1:1	SHEET: 2 OF 4
4805 (3/11)		REV: A	

LOC	DIST	REV	DATE	BY	APPV
GP	00				

REVISIONS			
NO.	DESCRIPTION	DATE	BY
-	SEE SHEET 1	-	-

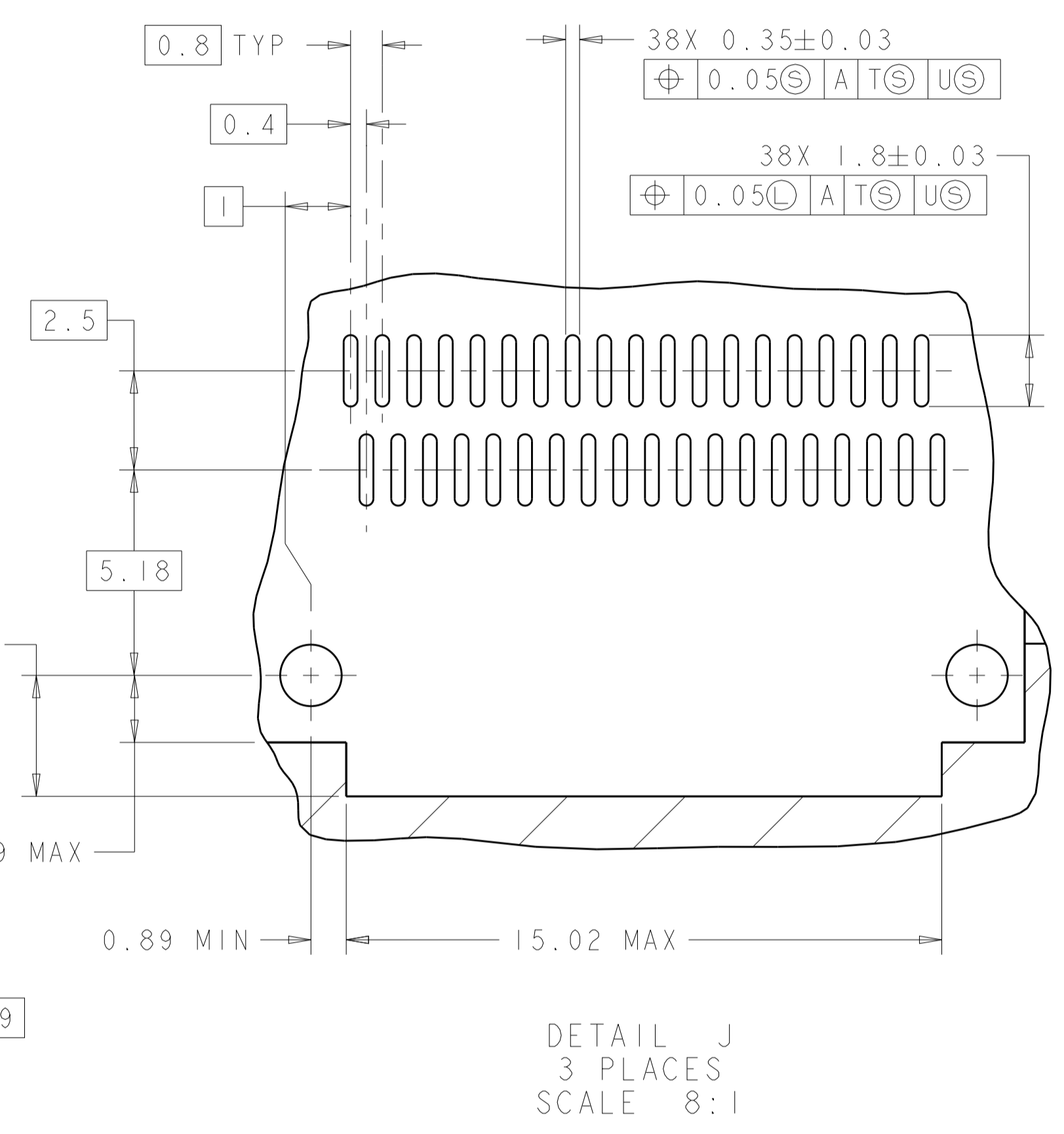
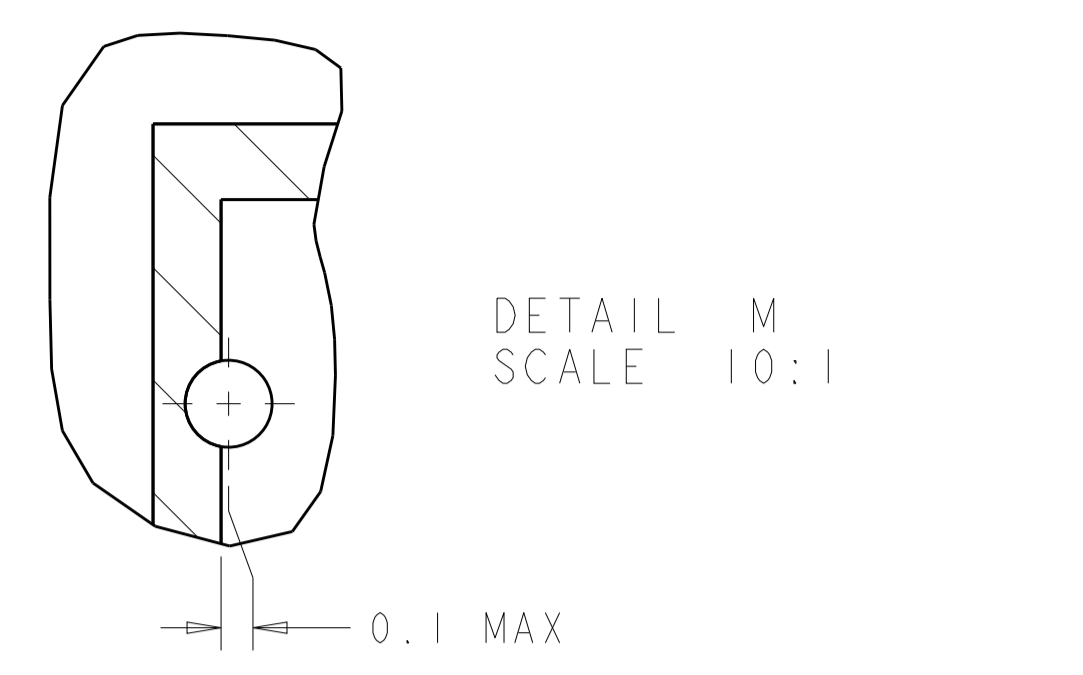
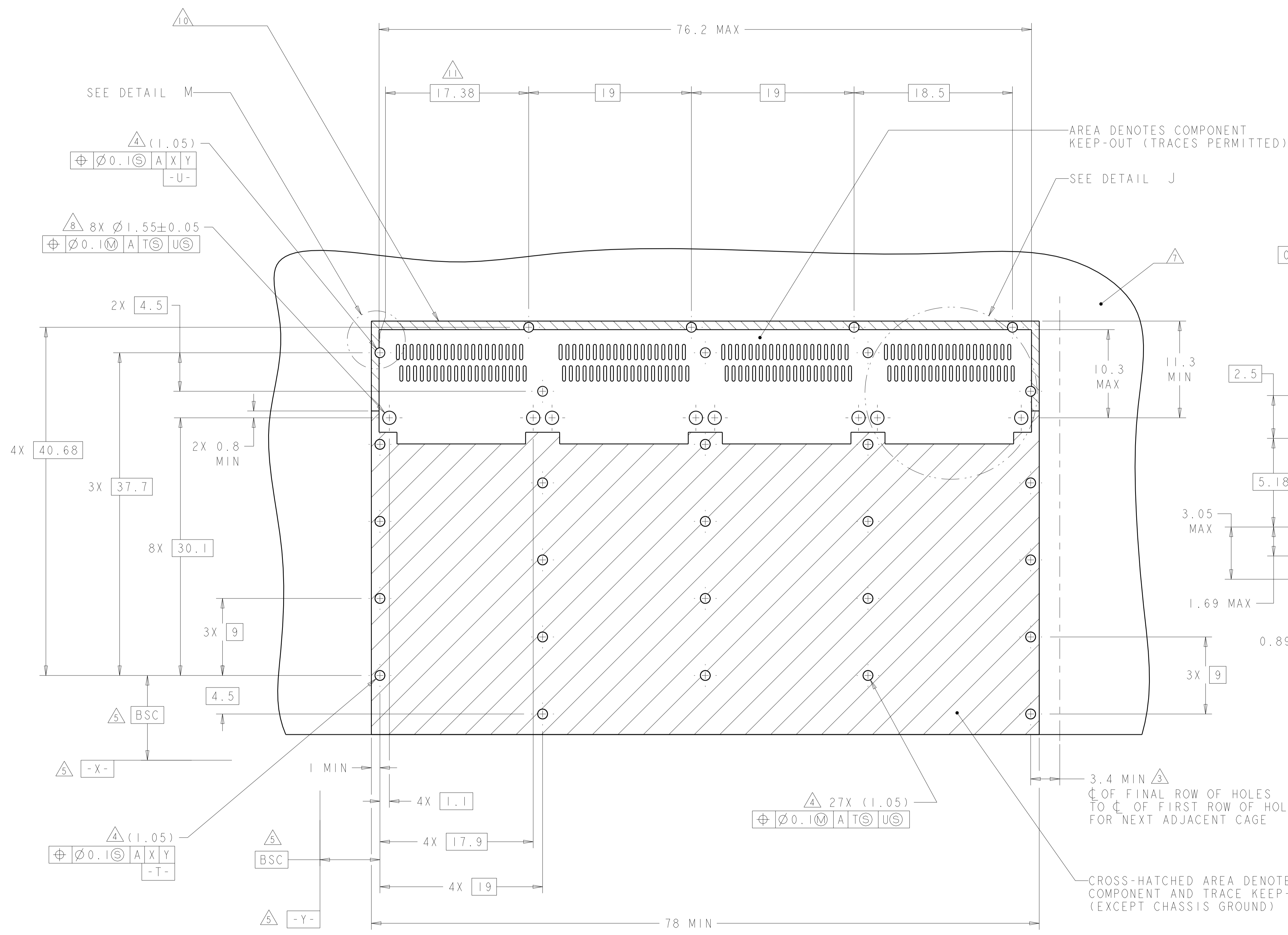

RECOMMENDED PC BOARD LAYOUT
 SINGLE SIDE MOUNT CONFIGURATION
 TOLERANCE: ±0.05
 SCALE 4:1

THIS PRODUCT HAS NOT COMPLETED VALIDATION/QUALIFICATION TESTING

THIS DRAWING IS A CONTROLLED DOCUMENT.		DWN: JASON YANG 22AUG2012 CHK: ALEX CAI 22AUG2012 APPV: ALEY CAI 22AUG2012	TE Connectivity
DIMENSIONS: mm TOLERANCES UNLESS OTHERWISE SPECIFIED: 0 PLC ±0.25 1 PLC ±0.15 2 PLC ±0.15 3 PLC ±0.15 4 PLC ±0.15 ANGLES ±0.15	NAME: 1X4 QSFP, CAGE ASSEMBLY, W/O FLANGE PRODUCT SPEC: 108-2286 APPLICATION SPEC: 114-13218 WEIGHT: -	SIZE: A1 CAGE CODE: 00779 DRAWING NO: C=2170402	

LOC	DIST	REVISIONS					
GP	00	P	LTN	DESCRIPTION	DATE	DMN	APVD
		-		SEE SHEET 1	-	-	-

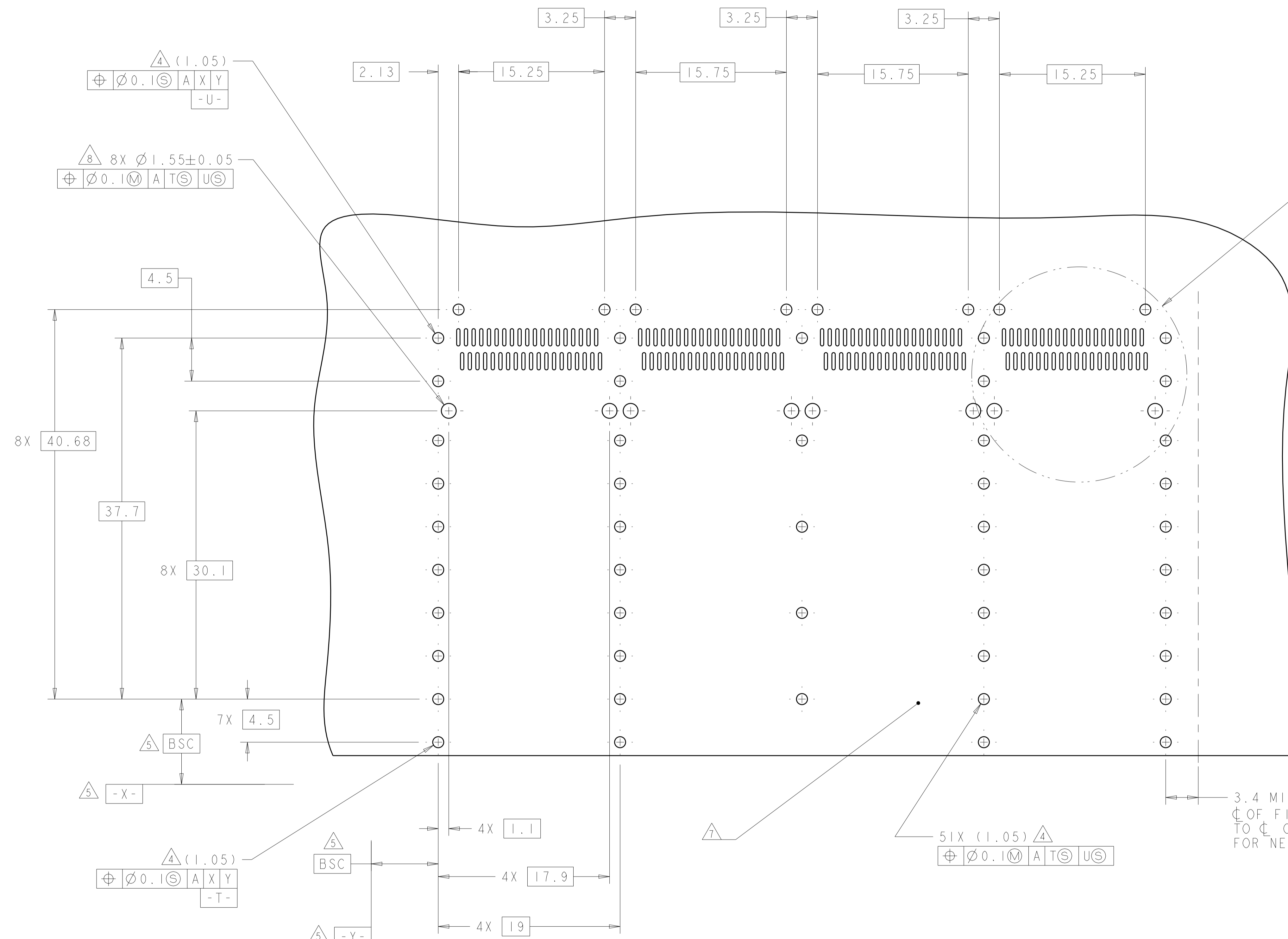

SEE DETAIL K

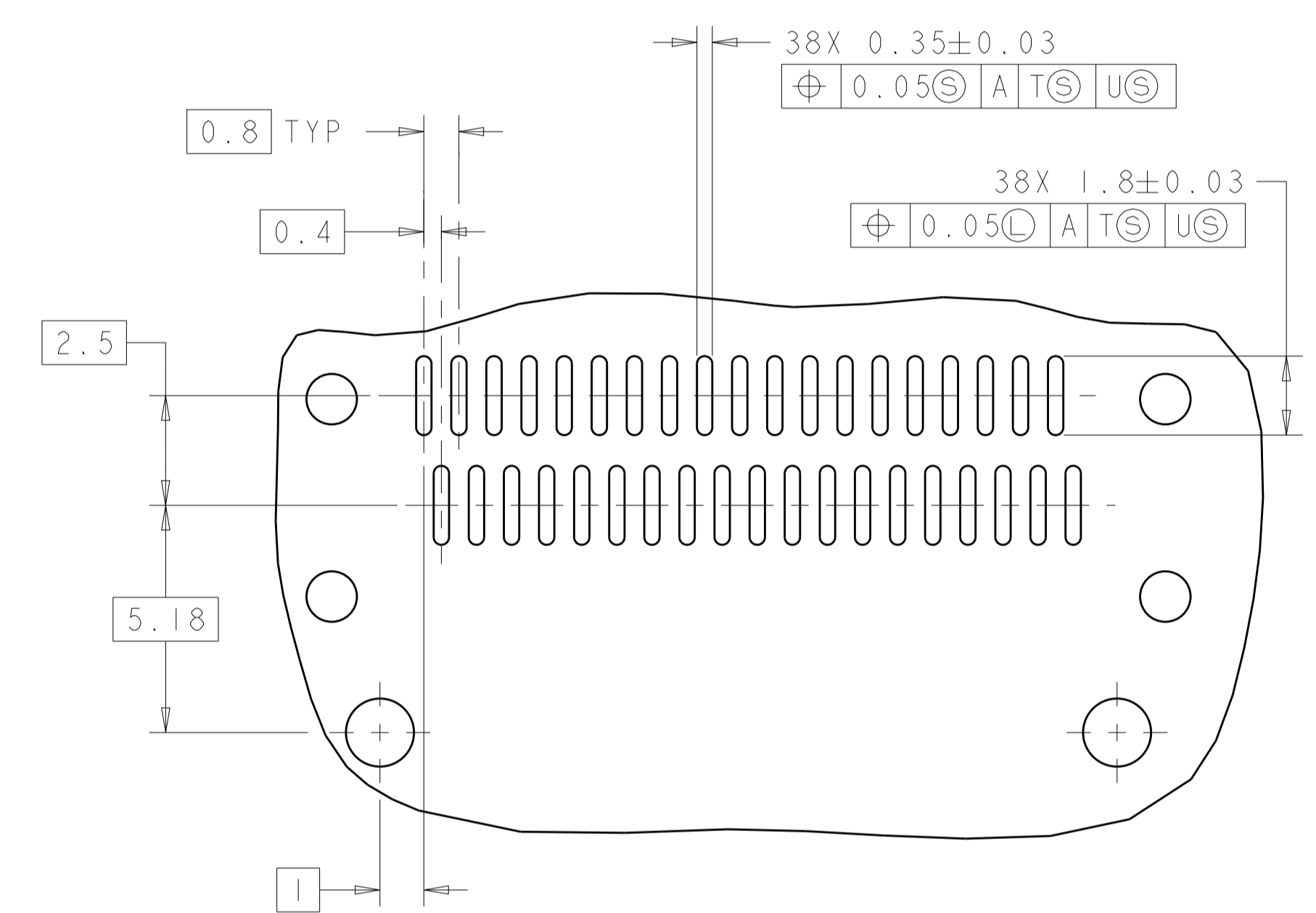

DETAIL K
SCALE 8:1

RECOMMENDED PC BOARD LAYOUT
 BELLY TO BELLY CONFIGURATION
 SEE SHEET 4 FOR COMPONENT
 AND TRACE KEEP-OUTS
 TOLERANCE: ±0.05
 SCALE 4:1

THIS PRODUCT HAS NOT COMPLETED VALIDATION/QUALIFICATION TESTING

THIS DRAWING IS A CONTROLLED DOCUMENT.		DMN: JASON YANG 22AUG2012	TE Connectivity
DIMENSIONS: mm		CHK: ALEX CAI 22AUG2012	
TOLERANCES UNLESS OTHERWISE SPECIFIED:		APVD: ALEY CAI 22AUG2012	NAME: 1X4 QSFP, CAGE ASSEMBLY, W/O FLANGE
0 PLC ±0.25	1 PLC ±0.15	PRODUCT SPEC: 108-2286	SIZE: CAGE CODE DRAWING NO: A100779C=2170402
2 PLC ±0.15	3 PLC ±0.15	APPLICATION SPEC: 114-13218	RESTRICTED TO: -
4 PLC ±0.15	ANGLES ±0.15	WEIGHT: -	SCALE: 1:1 SHEET 4 OF 4 REV A
MATERIAL: -	FINISH: -	Customer Drawing	