

REVISIONS					
REV	ECO	DESCRIPTION	DATE	BY	APPR
A1	-	RELEASE NUMBER	21/JUN/22	RONALD	TOMMY

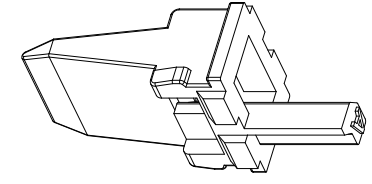
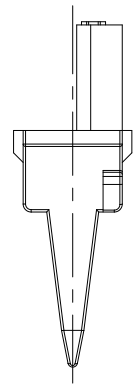
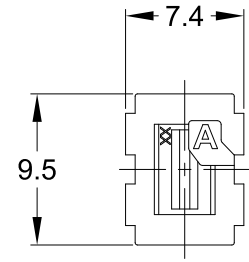
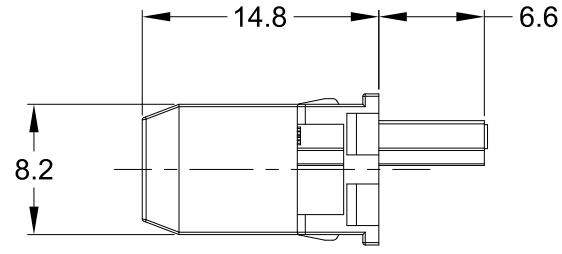

NOTES: UNLESS OTHERWISE SPECIFIED

1. MATERIAL: THERMOPLASTIC; COLOR: SEE SHEET 2
2. RoHS COMPLIANT
3. CAVITIES: 4
4. KEYED: SEE SHEET 2
5. USE WITH CONNECTORS AT04-4P\*  
(\* = MODIFICATIONS AND/OR COLORS)
6. ALL DIMENSIONS ARE FOR REFERENCE USE ONLY.

TITLE: P-WEDGELOCK, 4 POS, KEYED, AT SERIES  
 DWG NO.: AW4P-x  
 REV: A1  
 SH: 1  
 OF: 2

AW4P-x		REF: W4PA, W4PB, W4PC, W4PD	
PART NUMBER		DESCRIPTION	
ITEM		ITEM	
QUANTITY		MATERIALS LIST	
UNLESS OTHERWISE SPECIFIED 1) All dimensions are in metric(mm). 2) Tolerances are as follows: 1 PL DEC ±0.30   Fractions ±1/64 2 PL DEC ±0.15   Angles ±1° 3 PL DEC ±0.08 3) Note reference =		SIGNATURES DATE DRAWN: RONALD 20/JUN/22 CHECKED: ORION 21/JUN/22 APPROVAL: TOMMY 22/JUN/22	
MATERIAL SPECIFICATIONS: WEIGHT: 0.415g		CUSTOMER: THIS DRAWING IS SUPPLIED FOR INFORMATION ONLY. DESIGN FEATURES, SPECIFICATIONS AND PERFORMANCE DATA SHOWN HEREON ARE THE PROPERTY OF THE AMPHENOL CORPORATION. NO RIGHTS OF REPRODUCTION ARE IMPLIED. ALL DIMENSIONS ARE SUBJECT TO NORMAL MANUFACTURING VARIATIONS.	
PROCESS SPECIFICATIONS:		SIZE TYPE DWG NO. REVISION B C- AW4P-x A1	
NEXT ASSY:		SCALE: NONE SHEET 1 OF 2	

**Amphenol**  
 Sine Systems - www.amphenol-sine.com  
 44724 Morley Drive  
 Clinton Township, MI 48036

REVISIONS					
REV	ECO	DESCRIPTION	DATE	BY	APPR
A1	-	RELEASE NUMBER	21/JUN/22	RONALD	TOMMY

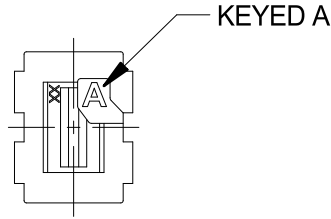

KEYED A

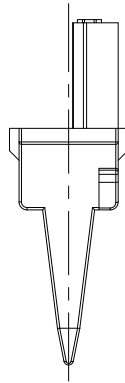

AW4P-A  
GRAY

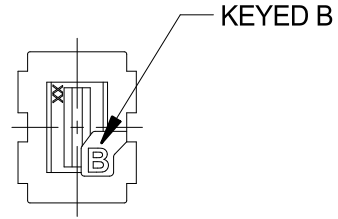

KEYED B

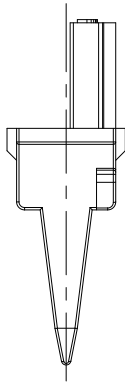

AW4P-B  
BLACK

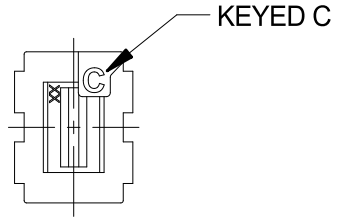

KEYED C

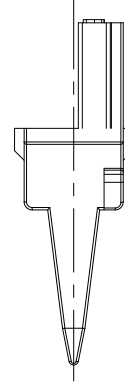

AW4P-C  
GREEN

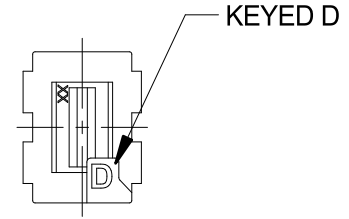

KEYED D

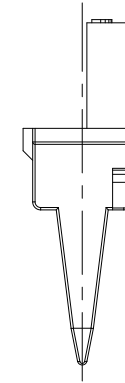

AW4P-D  
BROWN

TITLE: P-WEDGELOCK, 4 POS, KEYED, AT SERIES  
DWG NO.: AW4P-x  
REV: A1  
SH: 2  
OF: 2

AW4P-x		REF: W4PA, W4PB, W4PC, W4PD	
PART NUMBER			ITEM
QUANTITY			DESCRIPTION
<b>MATERIALS LIST</b>			
UNLESS OTHERWISE SPECIFIED 1) All dimensions are in metric(mm). 2) Tolerances are as follows: 1 PL DEC ±0.30   Fractions ±1/64 2 PL DEC ±0.15   Angles ±1° 3 PL DEC ±0.08		SIGNATURES    DATE	
3) Note reference =		DRAWN: RONALD	20/JUN/22
MATERIAL SPECIFICATIONS:		CHECKED: ORION	21/JUN/22
WEIGHT: 0.415g		ENGINEER:	
PROCESS SPECIFICATIONS:		APPROVAL: TOMMY	22/JUN/22
NEXT ASSY:		CUSTOMER:	
		THIS DRAWING IS SUPPLIED FOR INFORMATION ONLY. DESIGN FEATURES, SPECIFICATIONS AND PERFORMANCE DATA SHOWN HEREON ARE THE PROPERTY OF THE AMPHENOL CORPORATION. NO RIGHTS OF REPRODUCTION ARE IMPLIED. ALL DIMENSIONS ARE SUBJECT TO NORMAL MANUFACTURING VARIATIONS.	
		<b>Amphenol</b>	
		Sine Systems - www.amphenol-sine.com 44724 Morley Drive Clinton Township, MI 48036	
		P-WEDGELOCK, 4 POS, KEYED, AT SERIES	
SIZE	TYPE	DWG NO:	REVISION
B	C-	AW4P-x	A1
SCALE:	NONE	SHEET 2 OF 2	