

LOC	DIST	REVISIONS					
GP	00	P	LTR	DESCRIPTION	DATE	OWN	APVD
		0		RELEASED PER EC OS13-0288-05	29SEP05	GP	JG

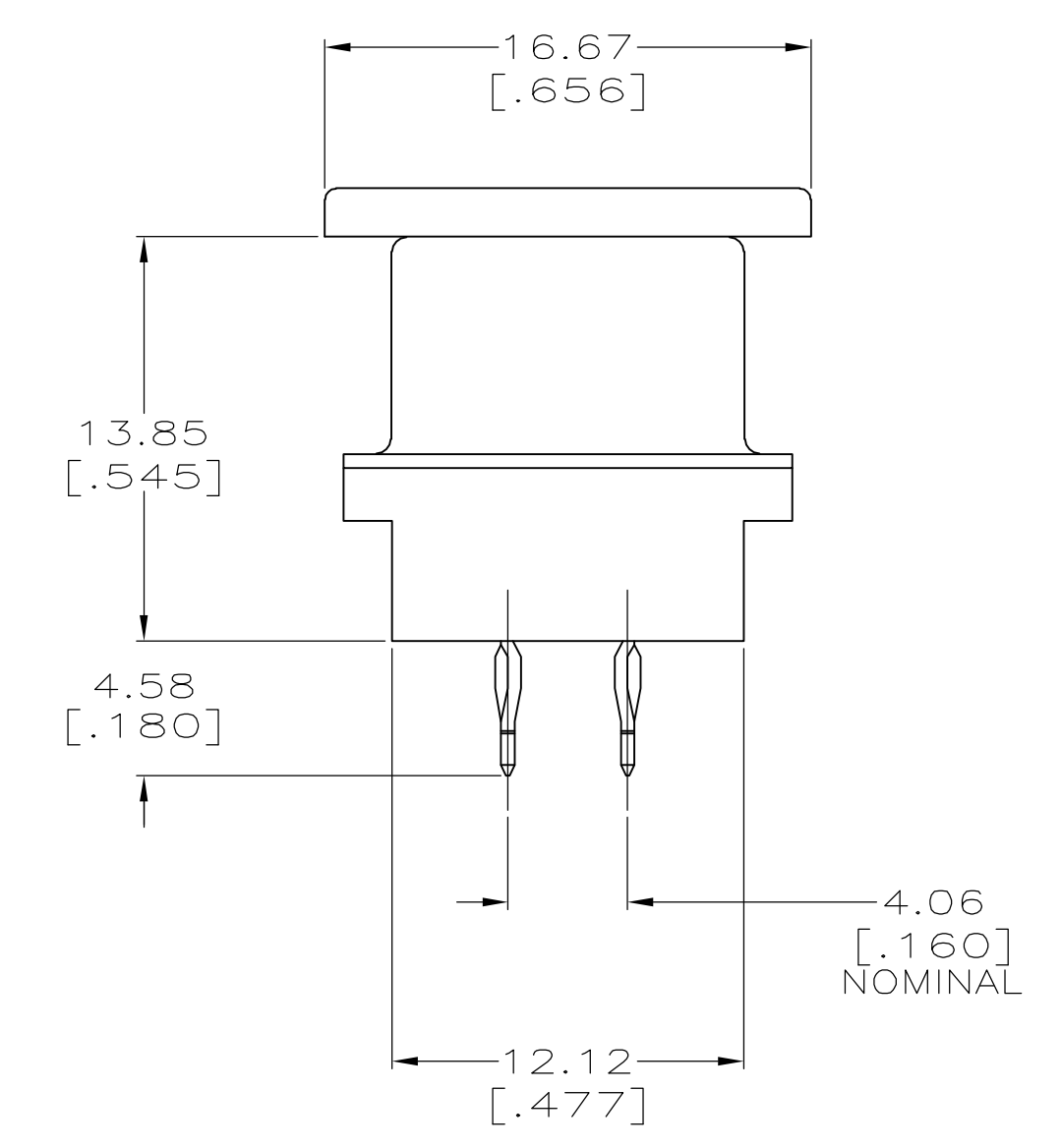

- △ DIMENSIONS ARE MAXIMUM UNLESS OTHERWISE SPECIFIED.
- △ MATERIAL: HOUSING - POLYESTER, BLACK. TERMINALS - COPPER ALLOY PLATED WITH 0.76 μm [.000030] MINIMUM GOLD ON MATING SURFACE AND 0.13 μm [.000005] MINIMUM GOLD FLASH ON ACTION PIN AREA OVER 1.27 μm [.000050] MINIMUM NICKEL UNDERPLATE OVER ENTIRE TERMINAL. RETAINER - POLYETHYLENE, NATURAL. SHIELD - CARBON STEEL, PLATED BRIGHT NICKEL 5.08 μm [.000200] MINIMUM. INSERTS - ZINC PLATED BRASS.
- 3. THE CONTACT SURFACES OF THE TERMINALS ARE COATED WITH LUBRICANT.
- △ OPTIONAL MOUNTING HOLE FOR SELF-TAPPING SCREW.
- △ "1" ON HOUSING INDICATES LOCATION OF TERMINAL 1.
- △ ALL PLATED-THRU HOLES SHALL BE PER AMP SPEC 115-6072.
- △ 50 LBS MINIMUM FORCE REQUIRED TO UNSEAT CONNECTOR FROM PRINTED CIRCUIT BOARD WITHOUT USE OF HARDWARE.
- 8. CENTER-TO-CENTER SPACING OF TERMINALS IS 2.16 [.085] NOMINAL.
- △ INSERTS SHALL WITHSTAND A 222 N [50 LB] PULL FORCE IN DIRECTION Y.
- △ RETAINER MUST REMAIN INSTALLED UNTIL AFTER CONNECTOR HAS BEEN INSERTED INTO PCB HOLES.

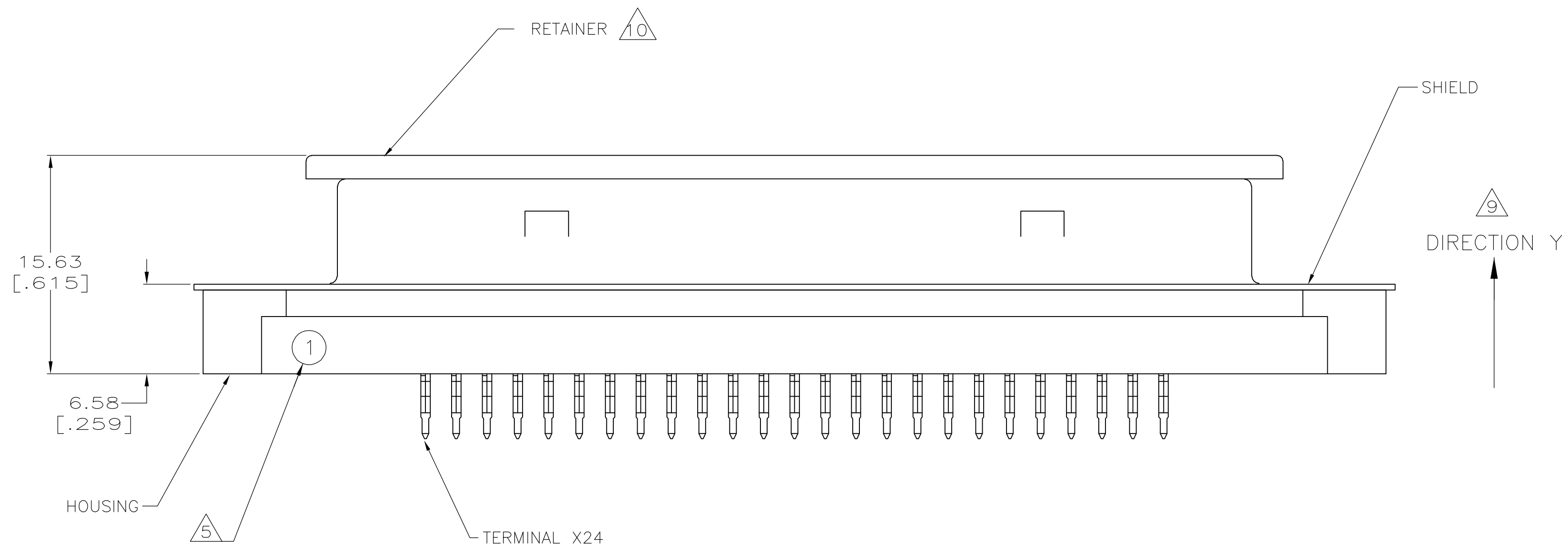
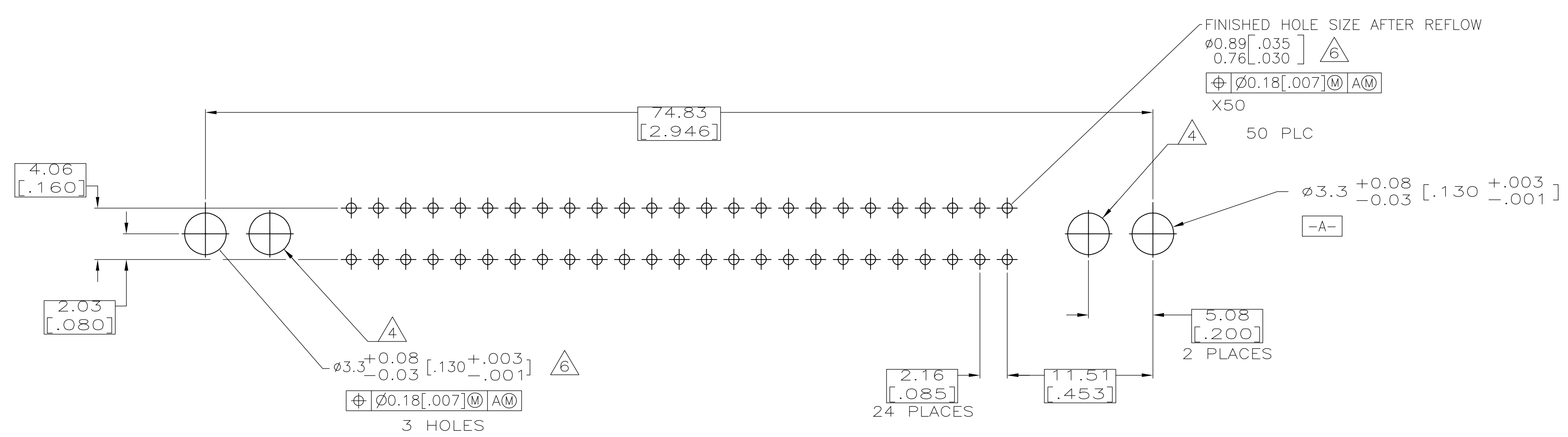
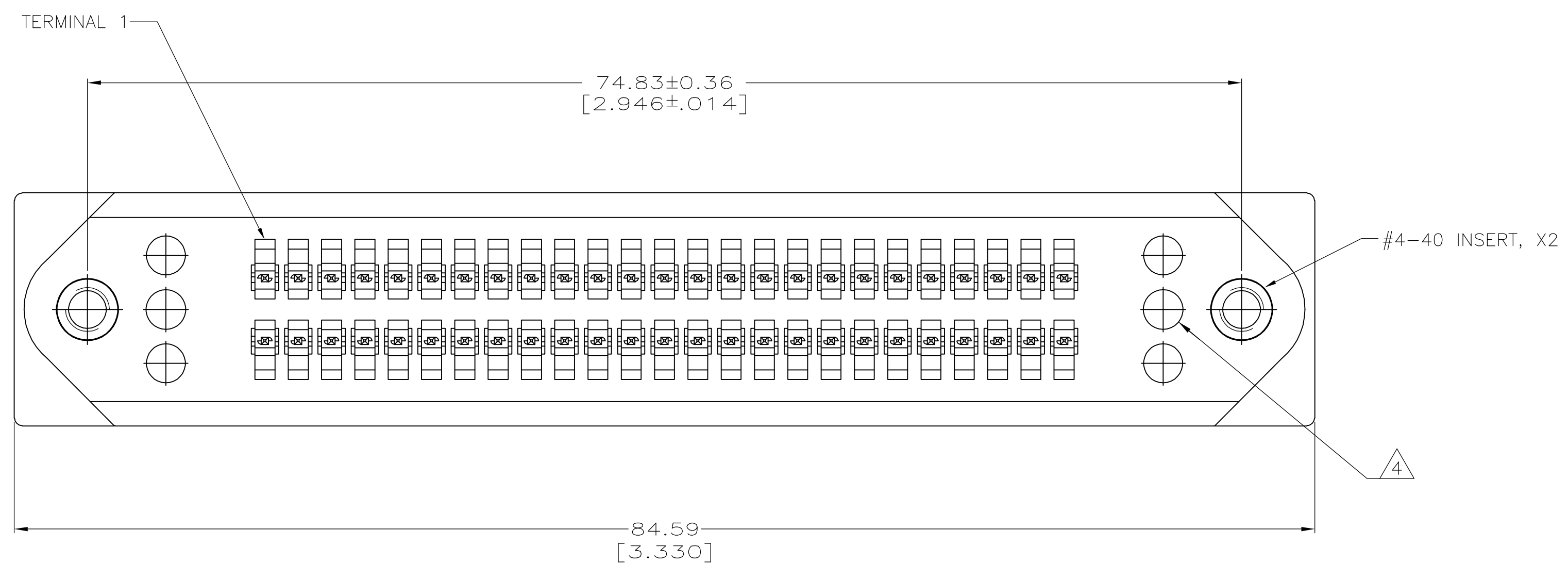

PRINTED CIRCUIT BOARD MOUNTING DIMENSIONS △△

5569286-1
PART NUMBER

THIS DRAWING IS A CONTROLLED DOCUMENT.		OWN: G.PETERS 29SEP05		Tyco Electronics Corporation Harrisburg, Pa 17105-3608			
DIMENSIONS: mm		CHK: W.MILLHIMES 29SEP05		NAME: M.WALMSLEY 29SEP05	RECEPTACLE ASSEMBLY, 50 POSITION, WITH INSERT, SHIELDED, ACTION PIN, CHAMP		
TOLERANCES UNLESS OTHERWISE SPECIFIED:		PROD: PRODUCT SPEC	APPL: APPLICATION SPEC	SIZE: A1	CAGE CODE: 00779	DRAWING NO: 5569286	RESTRICTED TO: -
MATERIAL: △2		FINISH: △2	WEIGHT: -	CUSTOMER DRAWING		SCALE: 4:1	SHEET 1 OF 1 REV 0