

SECTION A-A

DETAIL "A"

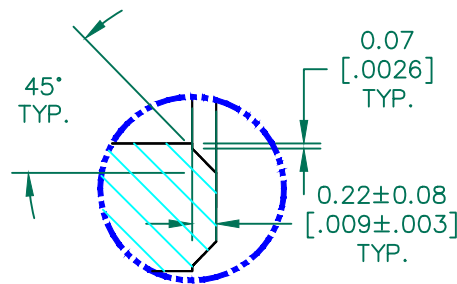

DETAIL "A"  
(TYP.)

SCALE DRAWING 1:1

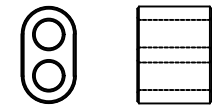

33N0525-500

ELECTRICAL TESTING

TEST:	NET Z	NET Z
# TURNS	1	1
AWG	-	-
FREQUENCY	1 MHz	5 MHz
NOMINAL	27 Ω	39 Ω
MINIMUM	-	31 Ω
WEIGHT/K	7.24 KGS	

NOTES: UNLESS OTHERWISE SPECIFIED

1. COSMETIC SPECIFICATION REFER TO WI-QA-038.



CORE DIMENSIONS:

A	13.34 [.525]	±	0.38 [.015]
B	7.49 [.295]	±	0.38 [.015]
C	10.30 [.406]	±	0.30 [.012]
D	3.81 [.150]	±	0.13 [.005]
E	5.72 [.225]	±	0.25 [.010]

DIMENSIONS ARE IN mm [INCHES].				This print is the property of Laird Tech. and is loaned in confidence subject to return upon request and with the understanding that no copies shall be made without the written consent of Laird Tech. All rights to design or invention are reserved.							
REV	DESCRIPTION	DATE	INT								
				PROJECT/PART NUMBER:	33N0525-500	REV	A	PART TYPE:	BALUN	DRAWN BY:	WS
				DATE:	04/13/2020	SCALE:	2 : 1	MATERIAL:	Ferrite		
A	NEW RELEASE	04/13/2020	WS	GAD #	33N0525-500-A	TOOL #	N0525A				