

NOTES:

1. INSULATORS: PBTP GF UL 94 V-0, GREY
2. CONTACTS: COPPER ALLOY
PLATING: GOLD OVER NICKEL
50 MATING CYCLES
3. PCB-CLIP: COPPER ALLOY
PCB HOLE $\phi 2.8 \pm 0.1$ / PCB THICKNESS $t = 1.6 \text{mm}$
4. CONNECTOR IS PART MARKED: 121A20849X CONEC ABC

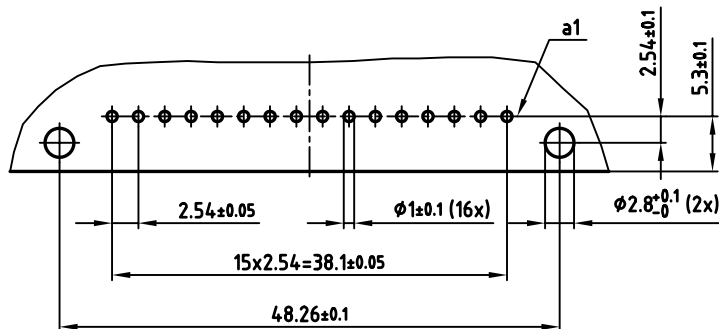

P.C.B. HOLE DRILLINGS



APPROVAL # FREIGABE # DEBLOCAGE # AUTORIZACION # APPROVAL	
CUSTOMER APPROVAL DATE:	
NAME:	TITLE:
COMPANY NAME:	
APPROVAL # FREIGABE # DEBLOCAGE # AUTORIZACION # APPROVAL	

THIS DRAWING MAY NOT BE COPIED OR REPRODUCED IN ANY WAY, AND MAY NOT BE PASSED ON TO A THIRD PARTY, WITHOUT WRITTEN PERMISSION.
OWNERSHIP AND COPYRIGHT OF CONEC GMBH
DO NOT ALTER CAD DRAWING BY HAND

rev.	description	date	name

tolerance		dim. in mm
2005	date	
drawn	19.12.	Lehmenkühler
appd.	19.12.	Mickenbecker
norm	DIN EN 60603	
d-old		

scale:	2:1	
material:	SEE NOTES	
title:	MALE CONNECTOR TYPE "B 1/2" 16pos. ANGLED with clip	
dwg no:	AutoCAD 2004	DIN-A
	12K1A412	3
part no:	121A20849X	sh: 1/1