

CAB469RF: MMCX R/A PLUG + SMA STRAIGHT BULKHEAD JACK WITH O-RING RATED TO IP67/68 + MULTIPLE CABLE SIZES, 6GHz

SPECIFICATIONS :

- MMCX RIGHT ANGLE PLUG, P/N:
FOR $\phi 1.37\text{MM}$, RG178 CABLE: RFCT-MMCX003-M78.
FOR $\phi 1.13\text{MM}$ LOW LOSS CABLE: RFCT-MMCX002-M13.
- COAXIAL CABLE, SEE P/N OPTIONS.
- SMA STRAIGHT BULKHEAD JACK WITH O-RING RATED TO IP67/68,
P/N: RFCT-SMA069-F78.

USAGE PRECAUTIONS: CABLES USING 'MICRO' COAX ARE DELICATE:

- HANDLE WITH CARE.
- DO NOT TWIST; APPLY EXCESSIVE FORCES OR SHARP BENDS TO THE CABLE. DO NOT FORCEFULLY DEFORM WIRES.
- CONSULT CONNECTOR MANUFACTURER'S DATASHEETS FOR DETAILED NOTES ON HANDLING INSTRUCTIONS.

ENVIRONMENTAL:

- BULKHEAD MOUNTED CONNECTOR (RFCT-SMA069-F78) RATED TO THE FOLLOWING SPECIFICATION:
 - IP6X - DUST TIGHT - NO PARTICLE INGRESS.
 - IPX7 WATERPROOF FOR 30 MINUTES UP TO 1 METER UNDERWATER.
 - IPX8 WATERPROOF FOR 48 HOURS AT 1 METER UNDERWATER.

NOTES:

- THE ORIENTATION OF CONNECTORS ON DRAWING IS FOR REFERENCE ONLY, IF THE ORDER IS LEFT BLANK THE CONNECTOR WILL NOT HAVE FIXED ORIENTATION.
- FIXED ORIENTATION IS SUGGESTED FOR CABLE LENGTH 50MM TO 100MM. PLEASE SPECIFY THE FIXED ORIENTATIONS FROM THE ORDER CODE (F1, F2, ETC)
- CONTACT GRADCONN IF THE ORIENTATION YOU REQUIRE IS NOT SHOWN.
- WORKING FREQUENCY RANGE: DC-6GHz.
- OPERATING TEMPERATURE: -40°C TO $+125^{\circ}\text{C}$.
- IMPEDANCE: 50 Ohm.

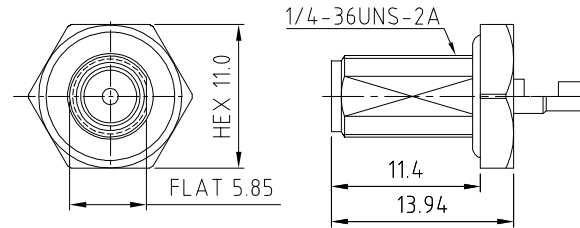
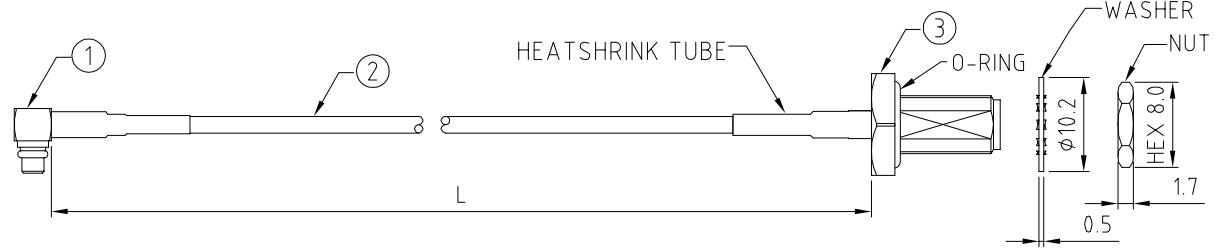

HOW TO ORDER
CAB469RF - X X X X - X X - X - X

"L" LENGTH IN MM:
eg: 100MM = 0100
(MIN. 0050-MAX.0400)
STANDARD = 0100, 0150, 0200
TOLERANCE: 50-200mm: $\pm 5\text{mm}$.
201-400mm: $\pm 7\text{mm}$.

CABLE SIZE OPTIONS:
1 = RG178 CABLE, COLOR: BROWN
2 = $\phi 1.37\text{MM}$ CABLE, COLOR: BLACK
3 = $\phi 1.13\text{MM}$ LOW LOSS CABLE, COLOR: GRAY

WASHER AND NUT OPTIONS:
BLANK = SEPARATELY PACKED (STANDARD)
A = ASSEMBLED WITH CONNECTOR

ORIENTATION OPTIONS:
BLANK = DOES NOT HAVE A FIXED ORIENTATION
F1 = MMCX CONNECTION DOWN (L=50-200MM)
F2 = MMCX CONNECTION UP (L=50-200MM)
F3 = MMCX CONNECTION & SMA FLAT SAME ORIENTATION (L=50-200MM)
F4 = MMCX CONNECTION & SMA FLAT OPPOSITE ORIENTATION (L=50-200MM)
(SEE NOTES 1, 2, 3 AND DIAGRAMS FOR MORE INFORMATION)

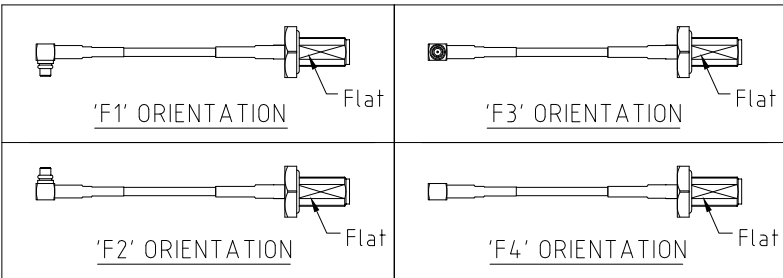
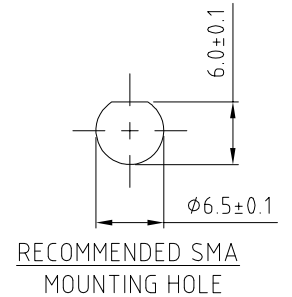

REV. DATE & DRN	11. 15/04/22 - NYW RELEASE
	10. 15/04/22 - NYW ADD 131. CABLE OPTION.
	17. 08/17/22 - GLETONS ADD 134&135. OPTIONS
	13. 03/07/23 - NYW CORRECT RG178 CABLE COLOR
	14. 12/01/23 - NYW ADD 131 LL CABLE OPTION.

Scale: NTS	THIRD ANGLE	Unstated X XX XXX ANGLES	Tolerances: N/A N/A N/A N/A
Drawn: NYW			
App'd: XXX	Title CABLE ASSEMBLY		
Date: 12 JAN. '23	Revision: 14	Unit: mm	

		Drawing Number: CAB469RF
IP67/68 Rated Cables	www.gradconn.com	Sheet 1 of 1
© THIS DRAWING IS CONFIDENTIAL AND MUST NOT BE COPIED OR DISCLOSED WITHOUT WRITTEN CONSENT		Drawing © E and OE