

Ratings

Voltage: 600 V
 Temperature: -40~105 °C
 Flammability: VW-1

Conductor

Conductor count: 1
 Gauge: 24 AWG 0.21 mm²
 Material: tinned copper
 Strand size: \varnothing 0.51 mm (solid)
 Resistance at 20 °C: 89.3 Ω /km max

Insulator

Material: Polyphenylene Ether, Modified (mPPE)
 Color: orange
 Diameter: \varnothing 1.1 \pm 0.10 mm
 Nominal thickness: 0.28 mm
 Resistance at 20 °C: 100 M Ω /km min

Wire marking: E339579 UL AWM STYLE 11028 24 AWG 105°C
 600V VW-1 --- cUL AWM I A/B 105°C 600V FT1 TENSILITY

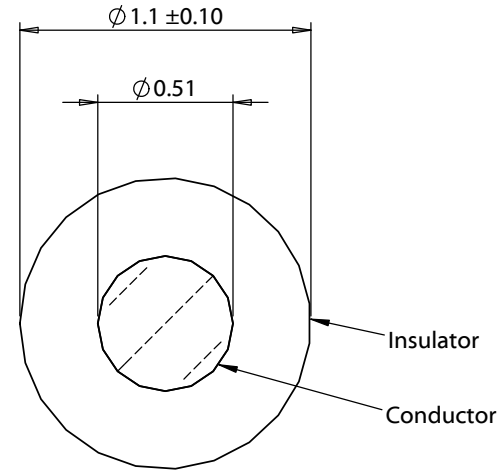
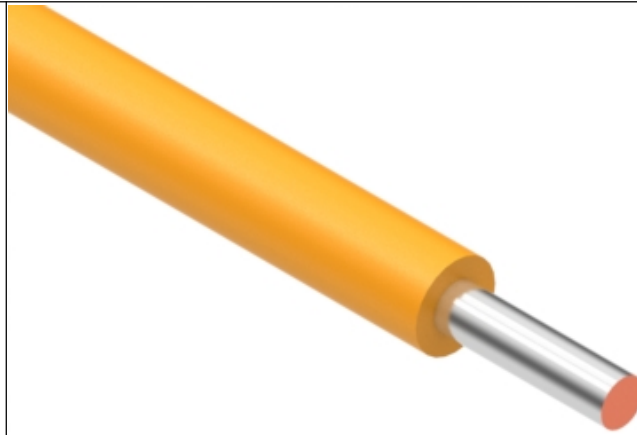

| | | | | | |
|-----------|----------|-----------------|--|--|---|
| Revision: | Date: | Description: | Prepared: | Notes: | TENSILITY tel 1.541.323.3228 800 877.670.7118 fax 1.541.323.4202 web tensility.com |
| A | 6/3/2021 | Initial release | AW <small>Digitally signed by AW Date: 2021.06.03 12:07:43 -07'00'</small> | RoHS compliant | |
| | | | Verified: | Phthalate and halogen free | Size: Part number: A 30-02098 |
| | | | JC <small>Digitally signed by JC Date: 2021.06.07 08:55:04 -07'00'</small> | Description: | |
| | | | Dimensions are in millimeters. Tolerances: X: \pm 0.5 mm X.X: \pm 0.3 mm X.XX: \pm 0.05 mm | Wire, hook-up, tinned solid core, 24 AWG, UL 11028, 600V, 105C, 1.1 mm, mPPE, orange | Scale: 35:1 |
| | | | | | Sheet 1 of 1 |

5

4

3

2

1