

The Bulgin **Rectangular** Connector range offers a reliable, **rugged solution** for cable to cable applications in harsh environments with its **environmentally sealed** range of products.

The series has a male and female option, as well as modifications such as enhanced seal retention, protective end caps, shrink boot adapters, welded flange, terminating resistors and a Y-Type connector for the automotive industry.

Key Features:

- ⊕ 2, 3, 4, 6, 8 & 12 Contact Count
- ⊕ IP68
- ⊕ Choice of Enhanced Seal Retention (ESR), Protective End Caps (PEC), Shrink Boot Adapters (SBA), Terminating Resistors (TER) and a Y-Type Connector (YTY)
- ⊕ Wedge-locks available for contact retention and alignment
- ⊕ Accepts 14 - 20 AWG

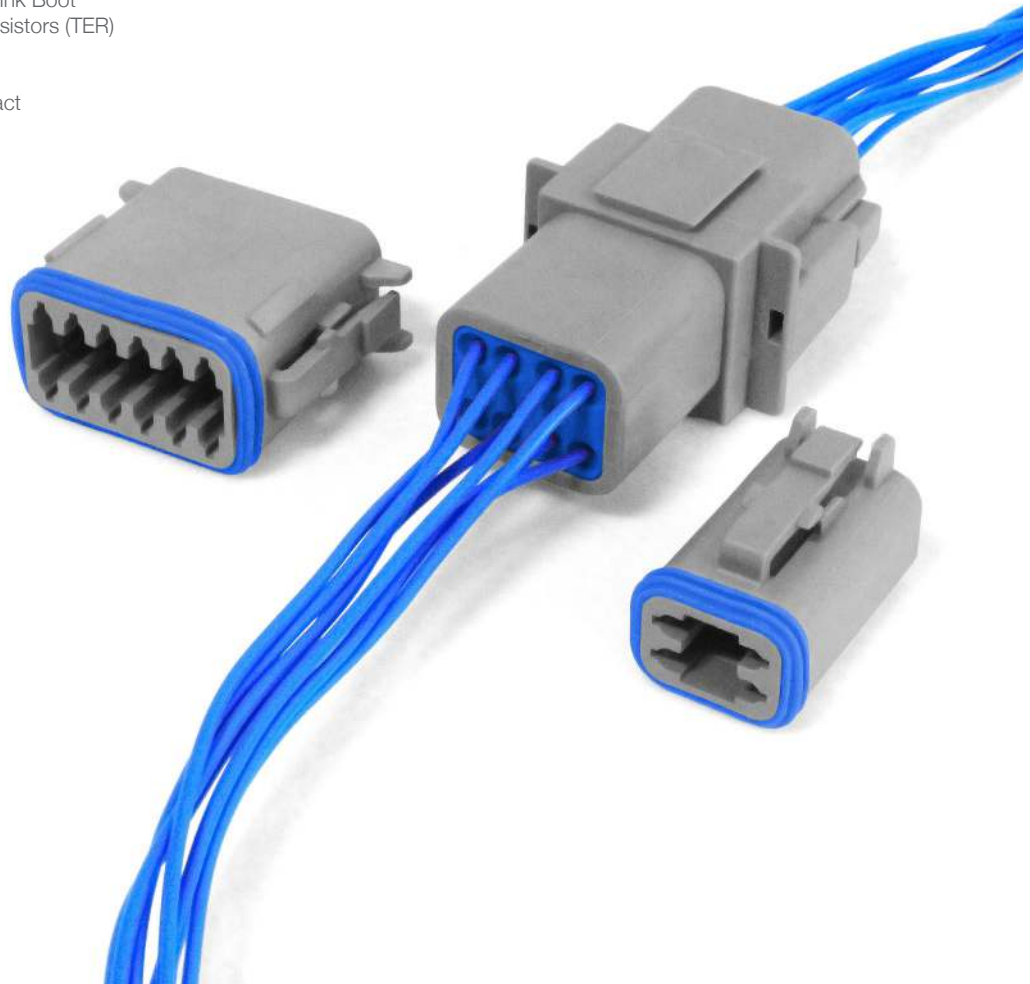

RECTANGULAR Standard Rectangular Connectors



Standard Rectangular Connectors
Male



PX0100

- 2, 3, 4, 6, 8 & 12 Contacts
- Male housing
- Socket contacts
- Available in grey and black
- Additional options available

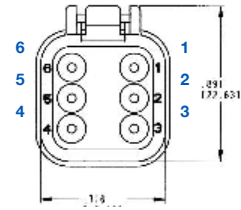

Part Number	Contacts	Key	Termination	Colour	Additional
PX0100S02BK	2	-	Crimp	Black	-
PX0100S02GY	2	-	Crimp	Grey	-
PX0100S03BK	3	-	Crimp	Black	-
PX0100S03GY	3	-	Crimp	Grey	-
PX0100S04BK	4	-	Crimp	Black	-
PX0100S04GY	4	-	Crimp	Grey	-
PX0100S06BK	6	-	Crimp	Black	-
PX0100S06GY	6	-	Crimp	Grey	-
PX0100S08AGY	8	A	Crimp	Grey	-
PX0100S08ABK	8	A	Crimp	Black	-
PX0100S12AGY	12	A	Crimp	Grey	-
PX0100S12ABK	12	A	Crimp	Black	-

Standard Rectangular Connectors
Male - ESR



PX0102

- 2 Contacts
- Male housing
- Enhanced seal retention
- Socket contacts
- Available in black
- Additional options available

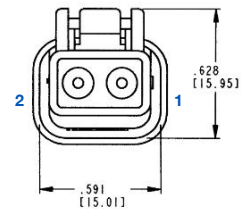

Part Number	Contacts	Key	Termination	Colour	Additional
PX0102S02BK	2	-	Crimp	Black	ESR

Standard Rectangular Connectors
Male - ESR & PEC



PX0103

- 2 Contacts
- Male housing
- Enhanced seal retention & protective end cap
- Socket contacts
- Available in grey
- Additional options available

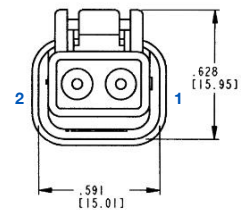

Part Number	Contacts	Key	Termination	Colour	Additional
PX0103S02GY	2	-	Crimp	Grey	ESR & PEC

RECTANGULAR Standard Rectangular Connectors



Standard Rectangular Connectors
Male - PEC



PX0105

- 2, 3, 4, 6, 8 & 12 Contacts
- Male housing
- Protective end cap
- Socket contacts
- Available in grey and black
- Additional options available

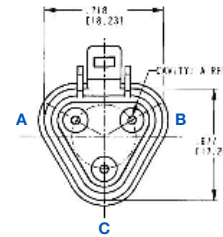

Part Number	Contacts	Key	Termination	Colour	Additional
PX0105S02BK	2	-	Crimp	Black	PEC
PX0105S02GY	2	-	Crimp	Grey	PEC
PX0105S03BK	3	-	Crimp	Black	PEC
PX0105S03GY	3	-	Crimp	Grey	PEC
PX0105S04BK	4	-	Crimp	Black	PEC
PX0105S04GY	4	-	Crimp	Grey	PEC
PX0105S06BK	6	-	Crimp	Black	PEC
PX0105S06GY	6	-	Crimp	Grey	PEC
PX0105S08ABK	8	A	Crimp	Black	PEC
PX0105S08AGY	8	A	Crimp	Grey	PEC
PX0105S12AGY	12	A	Crimp	Grey	PEC
PX0105S12ABK	12	A	Crimp	Black	PEC

Standard Rectangular Connectors
Male - SBA



PX0108

- 2, 3 & 4, 6 & 12 Contacts
- Male housing
- Shrink boot adapter
- Socket contacts
- Available in grey
- Additional options available

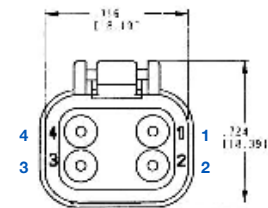

Part Number	Contacts	Key	Termination	Colour	Additional
PX0108S02GY	2	-	Crimp	Grey	SBA
PX0108S03GY	3	-	Crimp	Grey	SBA
PX0108S04GY	4	-	Crimp	Grey	SBA
PX0108S06GY	6	-	Crimp	Grey	SBA
PX0108S12AGY	12	-	Crimp	Grey	SBA

Standard Rectangular Connectors
Male - TER



PX0110

- 3 Contacts
- Male housing
- Terminating resistor
- Socket contacts
- Available in grey
- Additional options available

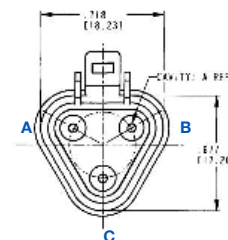

Part Number	Contacts	Key	Termination	Colour	Additional
PX0110S03GY	3	-	Crimp	Grey	TER

RECTANGULAR Standard Rectangular Connectors



Standard Rectangular Connectors
Female



PX0101

- 2, 3, 4, 6, 8 & 12 Contacts
- Female housing
- Plug contacts
- Available in grey and black
- Additional options available

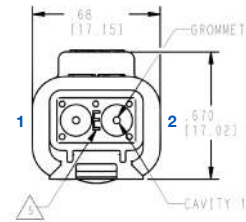

Part Number	Contacts	Key	Termination	Colour	Additional
PX0101P02BK	2	-	Crimp	Black	-
PX0101P02GY	2	-	Crimp	Grey	-
PX0101P03BK	3	-	Crimp	Black	-
PX0101P03GY	3	-	Crimp	Grey	-
PX0101P04BK	4	-	Crimp	Black	-
PX0101P04GY	4	-	Crimp	Grey	-
PX0101P06BK	6	-	Crimp	Black	-
PX0101P06GY	6	-	Crimp	Grey	-
PX0101P08ABK	8	A	Crimp	Black	-
PX0101P08AGY	8	A	Crimp	Grey	-
PX0101P12ABK	12	A	Crimp	Black	-
PX0101P12AGY	12	A	Crimp	Grey	-

Standard Rectangular Connectors
Female - PEC



PX0106

- 2, 3, 4, 6, 8 & 12 Contacts
- Female housing
- Protective end cap
- Plug contacts
- Available in grey and black
- Additional options available

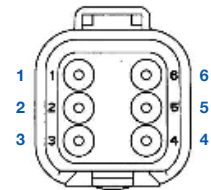

Part Number	Contacts	Key	Termination	Colour	Additional
PX0106P02BK	2	-	Crimp	Black	PEC
PX0106P02GY	2	-	Crimp	Grey	PEC
PX0106P03BK	3	-	Crimp	Black	PEC
PX0106P03GY	3	-	Crimp	Grey	PEC
PX0106P04BK	4	-	Crimp	Black	PEC
PX0106P04GY	4	-	Crimp	Grey	PEC
PX0106P06BK	6	-	Crimp	Black	PEC
PX0106P06GY	6	-	Crimp	Grey	PEC
PX0106P08ABK	8	A	Crimp	Black	PEC
PX0106P08AGY	8	A	Crimp	Grey	PEC
PX0106P12ABK	12	A	Crimp	Black	PEC
PX0106P12AGY	12	A	Crimp	Grey	PEC

Standard Rectangular Connectors
Female - SBA



PX0109

- 2, 3, 4, 6, 8 & 12 Contacts
- Female housing
- Shrink boot adapter
- Plug contacts
- Available in grey and black
- Additional options available

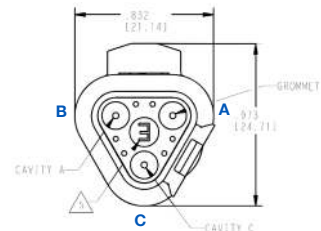

Part Number	Contacts	Key	Termination	Colour	Additional
PX0109P02BK	2	-	Crimp	Black	SBA
PX0109P02GY	2	-	Crimp	Grey	SBA
PX0109P03BK	3	-	Crimp	Black	SBA
PX0109P03GY	3	-	Crimp	Grey	SBA
PX0109P04GY	4	-	Crimp	Grey	SBA
PX0109P06GY	6	-	Crimp	Grey	SBA
PX0109P08GY	8	-	Crimp	Grey	SBA
PX0109P12AGY	12	-	Crimp	Grey	SBA

RECTANGULAR
Standard Rectangular Connectors



Standard Rectangular Connectors
Female - TER



PX0111

- 3 Contacts
- Female housing
- Terminating resistor
- Plug contacts
- Available in grey
- Additional options available

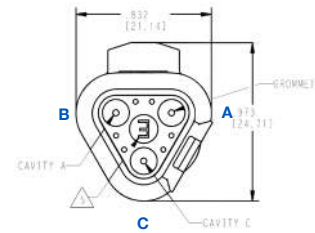

Part Number	Contacts	Key	Termination	Colour	Additional
PX0111P03GY	3	-	Crimp	Grey	TER

Standard Rectangular Connectors
Female - YTY



PX0113

- 3 Contacts
- Female housing
- Y-type connector
- Plug contacts
- Available in grey
- Additional options available

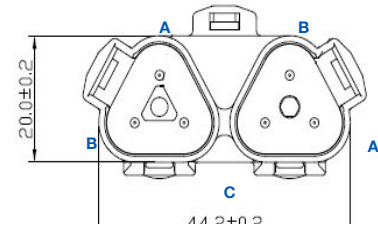

Part Number	Contacts	Key	Termination	Colour	Additional
PX0113P03GY	3	-	Crimp	Grey	YTY

Contacts



SA1000

- Crimp plug & sockets
- Choice of gold and nickel Plated
- Green stripe available

Part Number	Plating	AWG	Type	Plug / Socket	Additional
SA1000/G	Nickel Plating	14	Solid	Plug	Green Stripe
SA1001/G	Nickel Plating	14	Solid	Socket	Green Stripe
SA1002/G	Nickel Plating	16 - 20	Solid	Plug	Green Stripe
SA1003/G	Nickel Plating	16 - 20	Solid	Socket	Green Stripe
SA1000	Nickel Plating	14	Solid	Plug	-
SA1001	Nickel Plating	14	Solid	Socket	-
SA1002	Nickel Plating	16 - 20	Solid	Plug	-
SA1003	Nickel Plating	16 - 20	Solid	Socket	-
SA1004	Nickel Plating	16 - 20	Stamped	Plug	Bandolier
SA1005	Nickel Plating	16 - 20	Stamped	Socket	Bandolier
SA1006	Nickel Plating	14 - 18	Stamped	Plug	Bandolier
SA1007	Nickel Plating	14 - 18	Stamped	Socket	Bandolier
SA1008	Gold Plating	14 - 18	Stamped	Plug	Bandolier
SA1009	Gold Plating	14 - 18	Stamped	Socket	Bandolier
SA1010/G	Gold Plating	14	Solid	Socket	Green Stripe
SA1011/G	Gold Plating	14	Solid	Socket	Green Stripe
SA1012	Gold Plating	16-20	Solid	Plug	-
SA1013	Gold Plating	16-20	Solid	Socket	-

Wedgelocks



WLP12

- Plug & sockets available
- 2, 3, 4, 6, 8 & 12 Contact

* Wedgelocks are sold separately and are required for confirmation of alignment of contact. Please refer to the chart above to determine part required: e.g. WLP02 is required for 2 Contact female housings

Part Number	Contacts	Plug / Socket	Additional
WLP02	02	Plug	-
WLS02	02	Socket	-
WLP03	03	Plug	-
WLS03	03	Socket	-
WLP04	04	Plug	-
WLS04	04	Socket	-
WLP06	06	Plug	-
WLS06	06	Socket	-
WLP08	08	Plug	-
WLS08	08	Socket	-
WLP12	12	Plug	-
WLS12	12	Socket	-

Tooling



- Crimp tooling available
- Probe extraction tool

Part Number	Additional
10000	Crimping tool for heavy duty Rectangular Connectors (series coming soon)
10001	Probe extraction tool
10002	Crimping tool for Rectangular Connectors

STANDARD SERIES DIMENSIONS

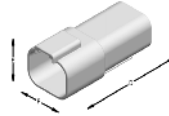

Cavity	Male			Female		
	Overall Length A	Overall Height B	Overall Width C	Overall Length D	Overall Height E	Overall Width F
2	1.118 (28.4)	.628 (15.95)	.591 (15.01)	1.708 (43.38)	.670 (17.02)	.675 (17.15)
3	1.118 (28.4)	.934 (23.72)	.718 (18.23)	1.698 (43.13)	.973 (24.71)	.832 (21.13)
4	1.218 (30.94)	.724 (18.39)	.716 (18.19)	1.808 (45.92)	.776 (19.71)	.820 (20.83)
6	1.218 (30.94)	.891 (22.63)	.716 (18.19)	1.808 (45.92)	.951 (24.16)	.820 (20.83)
8	1.217 (30.91)	.776 (19.71)	1.465 (37.21)	1.798 (45.67)	1.000 (25.40)	1.435 (36.45)
12	1.218 (30.94)	.716 (18.19)	1.597 (40.56)	1.808 (46.92)	.876 (22.25)	1.597 (40.56)

* Dimensions are for reference only.

Electrical:

No Contacts: 2, 3, 4, 6, 8 & 12
 Insulation Resistance: >1000MΩ
 Dielectric Strength: No damage when exposed
 Dielectric Withstanding Voltage: 1500 VAC
 Operating Temperature Range: -55°C to +125°C

Mechanical:

Sealing: IP68
 Contact Accommodation: 14-20AWG (2.0-0.5mm²)
 Termination: Crimp terminals
 Cycles: >100

Material

Grommet: Silicone rubber
 Insert Retainer: Thermoplastic
 Receptacle Interfacial Seal: Silicone Rubber
 Shell: Thermoplastic
 Wedgelocks: Thermoplastic
 RoHS: Compliant

Contact Layout (Rear View)

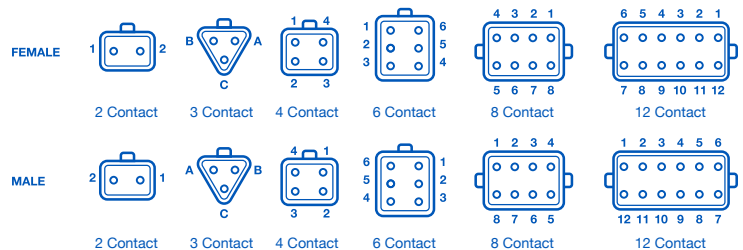

Contact Insertion Instructions

Step One:



Use a previously crimped contact and wire and hold just behind the contact barrel.

Step Two:



Line the contact up with the grommet.

Step Three:



Push the contact until a click is felt. Check the contact is in place by gently tugging and confirming alignment. Repeat for number of contacts desired

Step Four:



When contacts are in place, insert the appropriate wedgelock until a click is heard. Once male and female housings are prepared the parts can be mated



PX0	XXX	X	XX	X	XX
Range	Body Type	Contact Type	Contacts	Key	Colour
PX0	100 = Male 101 = Female 102 = Male Enhanced Seal Retention 103 = Male Enhanced Seal Retention & Protective End Cap 105 = Male Protective End Cap 106 = Female Protective End Cap 108 = Male Shrink Boot Adapter 109 = Female Shrink Boot Adapter 110 = Male Terminating Resistor 111 = Terminating Resistor 113 = Female Y Type	S = Socket P = Plug	02 03 04 06 08 12	A = A Key	GY = Grey BK = Black