

NOTES:

1. SPECIFICATIONS:

ELECTRICAL:  
 WITHSTANDING VOLTAGE: MINIMUM 1250 V RMS @ SEA LEVEL  
 INSULATION RESISTANCE: INITIAL 5000 MEGOHMS MAXIMUM,  
 1000 MEGOHMS MIN. AFTER ENVIRONMENTAL TESTING.  
 CONTACT RATING: 5 AMPS  
 CONTACT RESISTANCE: 2.7 MILLIOHMS MAX.

MATERIALS:  
 INSULATOR: WHITE UL94V-0 RATED GLASS FILLED POLYESTER  
 CONTACT: COPPER ALLOY  
 CONTACT AREA PLATING: GOLD OVER NICKEL,  
 CONNECTOR SHELL: STEEL, PLATING ZINC WITH CLEAR CHROMATE.

ENVIRONMENTAL:  
 OPERATING TEMPERATURE: -65°C TO +125°C

TERMINATION:  
 2. TERMINALS ARE INTENDED (BECAUSE OF THE FLOAT) TO BE HAND HAND WIRE WRAPPED ONLY. WIRE WRAP # 28 & 30 AWG WIRE.

3. DIMENSIONS IN [ ] ARE IN MILLIMETERS.

DRAWING REVISIONS			
REV	DOCUMENT	APP	DATE
A	DO 05-1094	AKB	01/07/06
B	ECN 06E425		

NUMBER OF POSITIONS	SELECTIVE GOLD FLASH PLATING (.120" [3.05] MTG. HOLES)		WIRE WRAP TAIL LENGTH	DIMENSION								FRONT MOUNTING HOLE DIMENSIONS		REAR MOUNTING HOLE DIMENSIONS	
	PART NO.	FACTORY NO.		"A"	"B"	"C"	"D"	"E"	"F"	"G"	"H"	"J"	"X"	"Y"	"X"
9	DEH-9P-F179	702 01 09 030	.375 [9.52]	1.213 [30.81]	.984 [24.99]	.697 [17.70]	.360 [9.14]	.759 [19.28]	.422 [10.72]	.045 [1.14]	.030 [.76]	.874 [22.20]	.513 [13.03]	.806 [20.47]	.449 [11.40]
	DEH-9P-F179C	702 01 09 050	585 [.14.86]	1.541 [39.14]	1.312 [33.32]	1.025 [26.03]									
15	DAH-15P-F179	702 01 15 030	.375 [9.52]	2.088 [53.04]	1.852 [47.04]	1.583 [40.21]	.378 [9.60]	1.629 [41.38]	.060 [1.52]	.039 [.99]	1.743 [44.27]	.623 [15.82]	1.674 [42.52]	2.218 [56.34]	.555 [14.10]
	DAH-15P-F179C	702 01 15 050	585 [.14.86]	2.729 [69.32]	2.500 [64.50]	2.231 [56.67]									
25	DBH-25P-F179	702 01 25 030	.375 [9.52]	2.635 [66.93]	2.406 [61.11]	2.127 [54.02]	.484 [12.29]	.605 [15.37]	2.178 [55.32]	.534 [13.56]	2.297 [58.34]	.623 [15.82]	2.218 [56.34]	.555 [14.10]	
	DBH-25P-F179C	702 01 25 050	585 [.14.86]	2.729 [69.32]	2.500 [64.50]	2.231 [56.67]									
37	DCH-37P-F179	702 01 37 030	.375 [9.52]	2.635 [66.93]	2.406 [61.11]	2.127 [54.02]	.484 [12.29]	.605 [15.37]	2.178 [55.32]	.534 [13.56]	2.297 [58.34]	.623 [15.82]	2.218 [56.34]	.555 [14.10]	
	DCH-37P-F179C	702 01 37 050	585 [.14.86]	2.729 [69.32]	2.500 [64.50]	2.231 [56.67]									
50	DDH-50P-F179	702 01 50 030	.375 [9.52]	2.635 [66.93]	2.406 [61.11]	2.127 [54.02]	.484 [12.29]	.605 [15.37]	2.178 [55.32]	.534 [13.56]	2.297 [58.34]	.623 [15.82]	2.218 [56.34]	.555 [14.10]	
	DDH-50P-F179C	702 01 50 050	585 [.14.86]	2.729 [69.32]	2.500 [64.50]	2.231 [56.67]									

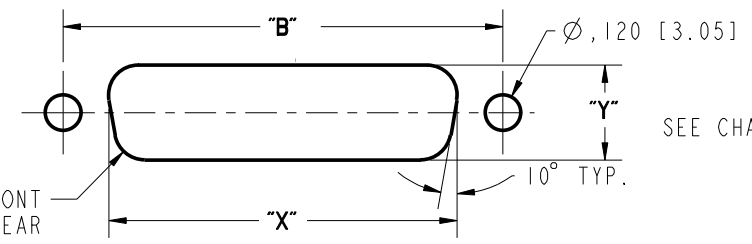

RECOMENDED MTG. HOLE LAYOUT  
 SEE CHART FOR FRONT AND REAR MTG. DIMENSIONS

**ROHS COMPLIANT**

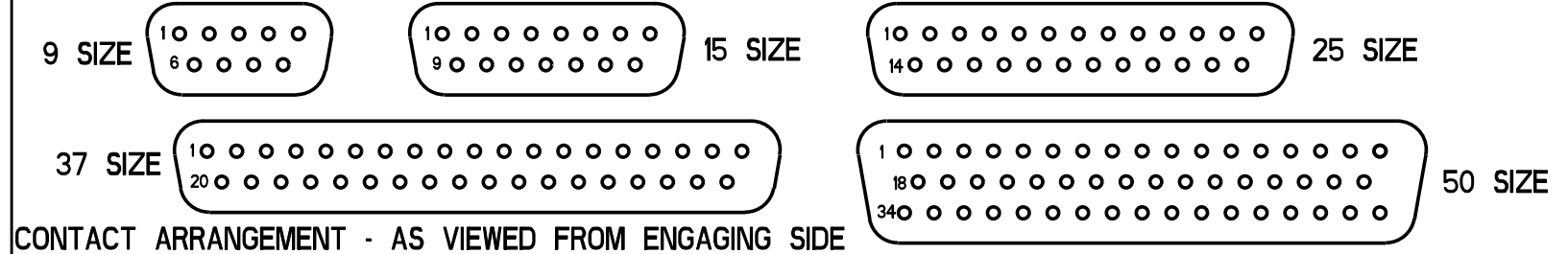

CONTACT ARRANGEMENT - AS VIEWED FROM ENGAGING SIDE

UNITS	ENGLISH	PRO/E	MODELED BY: V. SKUZA
DO NOT SCALE DRAWING	DRAWN BY V. SKUZA	DATE 06/14/05	TITLE D-SUB WIRE WRAP .375/.585 LG. CONNECTOR PLUG ASS'Y (.120" HOLES)
	DESIGN ENGINEER A. BALI	06/14/05	MATERIAL
	DESIGN ENGINEERING MGR. A. SHAH	07/09/05	MATERIAL SPEC NUMBER
	MFG. ENGINEERING J. OCEGUERA	07/07/05	CAD FILE NUMBER DXHXXPF179
	QUALITY ASSURANCE A. VAZQUEZ	07/06/05	DRAWING NUMBER D*H-XXP-F179
			CAGE IDENT NO.   SCALE 71785   B   1:1
			PROJECT NUMBER C14716
			SHEET 1 OF 1

1700 FINLEY RD  
 LOMBARD, IL. 60148

THIS DOCUMENT IS THE PROPERTY OF CINCH. NEITHER THIS DOCUMENT NOR ANY OF THE INFORMATION CONTAINED IN IT MAY BE DUPLICATED OR DISCLOSED WITHOUT PRIOR WRITTEN CONSENT OF CINCH.