

PRODUCT NO.
10164940-148X00XMF

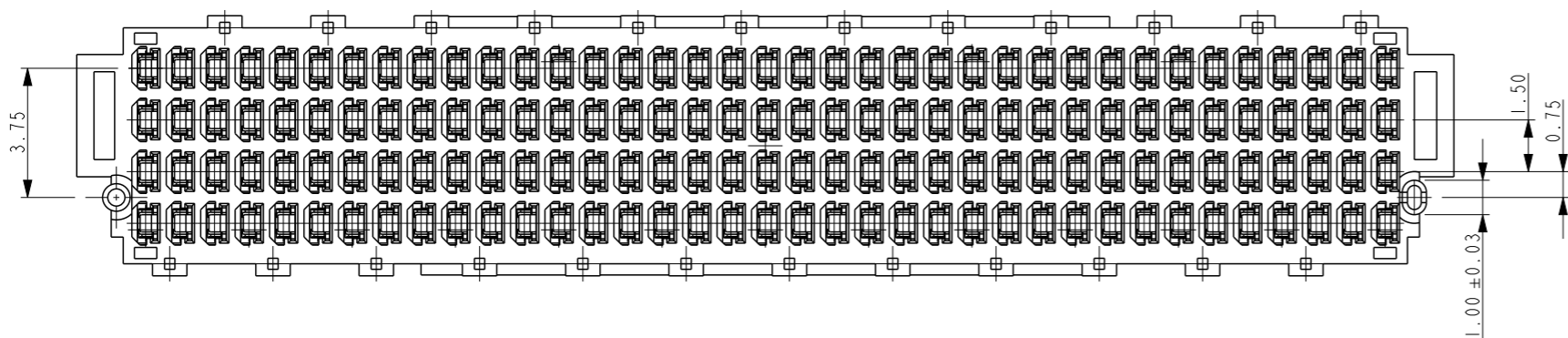
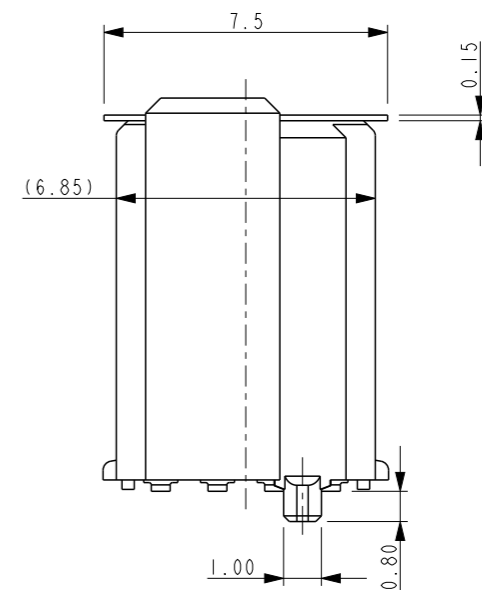
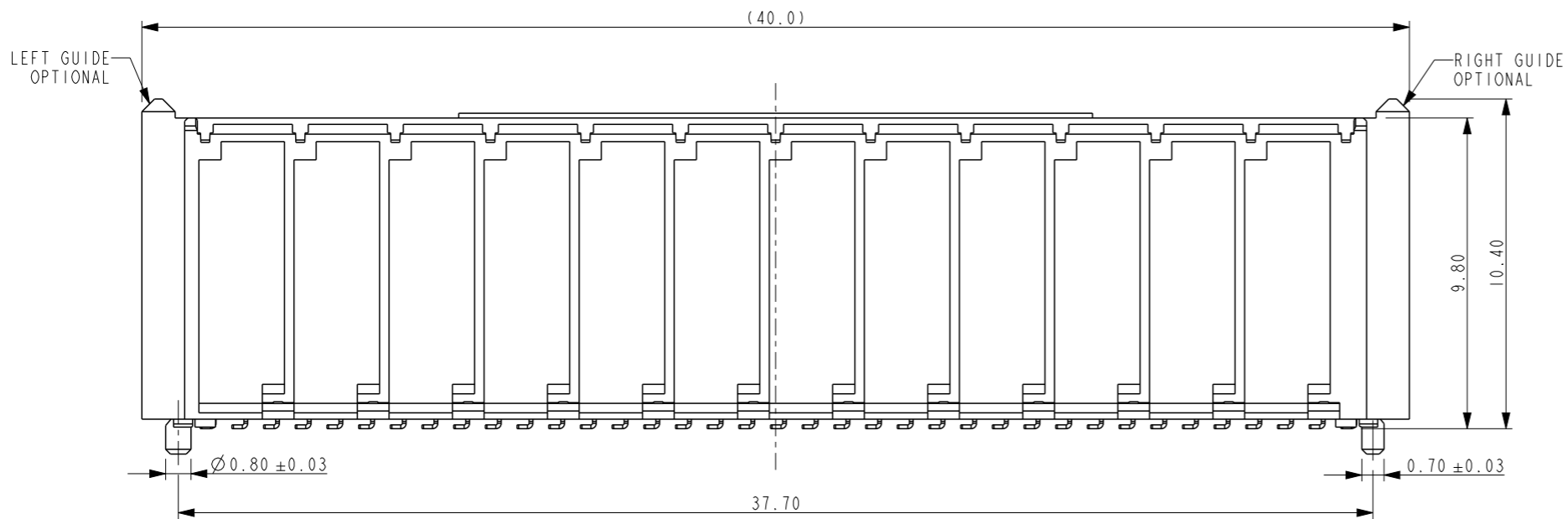
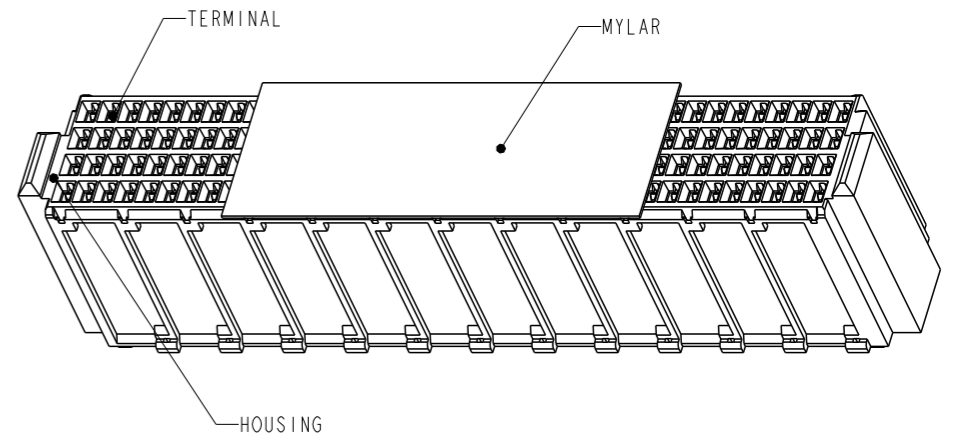
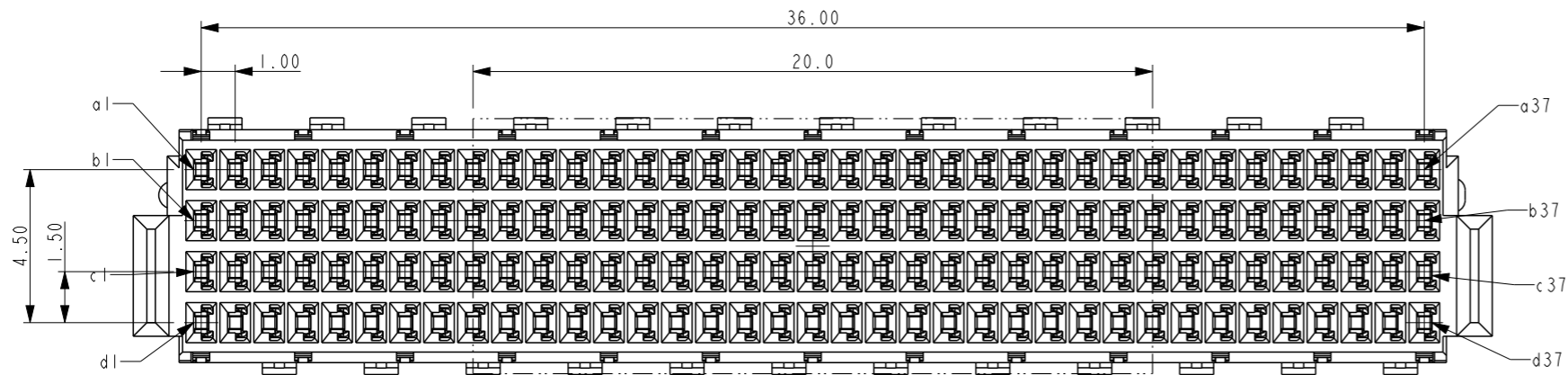

- NOTES:
- MATERIAL:
 - HOUSING: THERMOPLASTIC
 - TERMINAL: COPPER ALLOY
 - PLATING: 1-3μm NI UNDER PLATING;
 - CONTACT AREA: ACCORDING TO PART NUMBER;
 - SOLDER TAIL: ACCORDING TO PART NUMBER.
 - COPLANARITY AREA OF TERMINATION 0.10MM MAX
 - THIS HOUSING WILL WITHSTAND EXPOSURE TO 260°C PEAK TEMPERATURE FOR 20 SECONDS IN A IR REFLOW SOLDERING APPLICATION

Amphenol
FCi

© 2020 Amphenol Corporation

spec ref	*	dr	Li-Qing Lei	2022/03/08	projection	mm	size	A3	scale	5:1		
tolerance std	TOLERANCES UNLESS OTHERWISE SPECIFIED	eng	Tian-Yu Tang	2022/04/19			ecn no	-	rel level	Released		
surface	linear	chr	-	app							Tim Yao	2022/04/19
ASME Y14.5	angular	0°	±2°	Amphenol FCi		title	Receptacle 4 ROWS, VT 10H		dwg no	10164940	rev	A
				cat. no.		Product - Customer Drw			sheet 1 of 2			

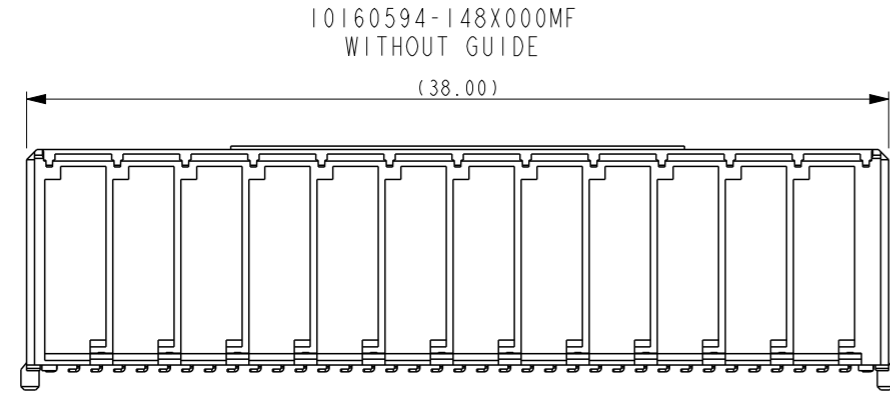
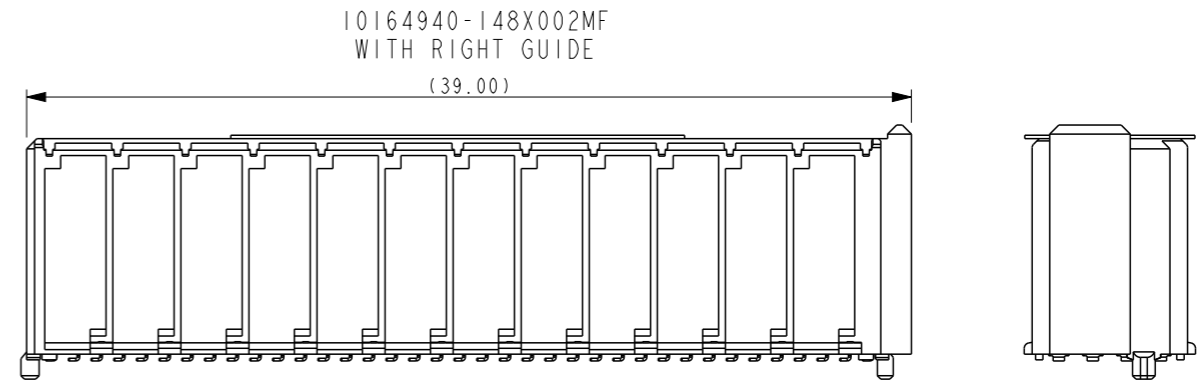
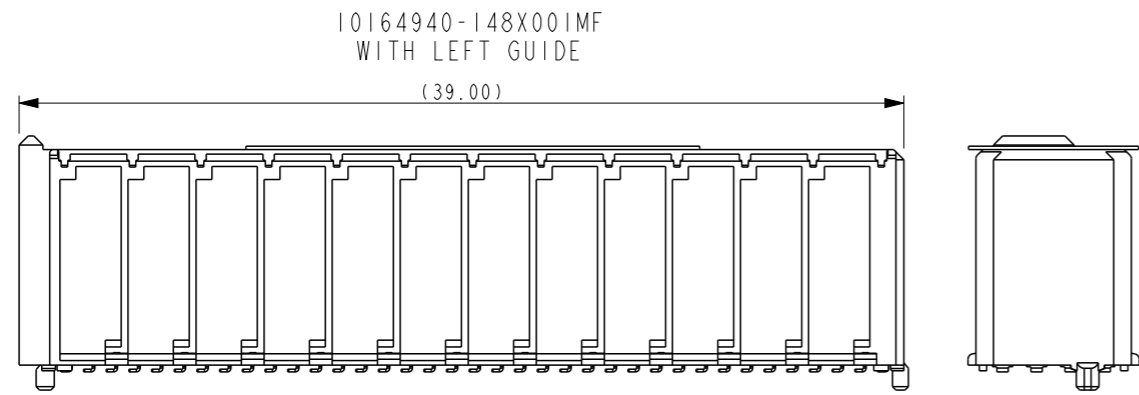

PCB LAYOUT PROPOSAL
TOLERANCE RECOMMENDED ±0.05

PART NUMBER DESCRIPTION
10164940-148X00XXF

PIN NUMBER _____

PLATING OPTION: _____
CONTACT AREA AND SOLDER TAIL;
1. 8u" GXT OR GOLD ON CONTACT AREA;
80-160u" TIN OR GOLD FLASH ON
SOLDER TAIL;

LEAD FREE _____

PICK UP FEATURE
L: WITHOUT MYLAR
M: WITH MYLAR _____

GUIDE OPTION
0: WITHOUT GUIDE;
1: WITH LEFT GUIDE;
2: WITH RIGHT GUIDE;
3: WITH BOTH GUIDES.

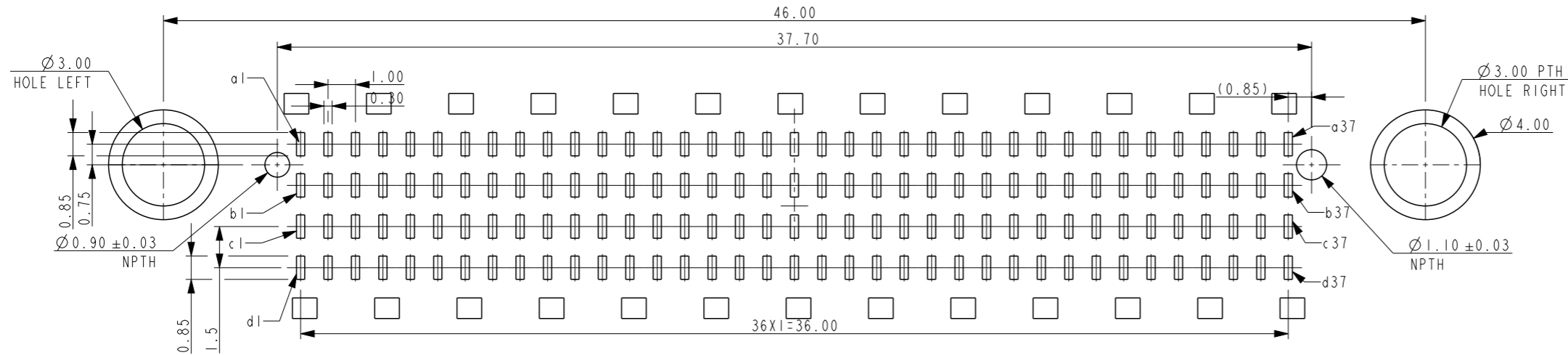

HOLE LEFT & HOLE RIGHT ARE PERFORMED HOLE FOR SCREW WHEN NEEDED.

spec ref	*	dr	Li-Qing Lei	2022/03/08	projection	mm	size	A3	scale	5:1
tolerance std	TOLERANCES UNLESS OTHERWISE SPECIFIED	eng	Tian-Yu Tang	2022/04/19			ecn no	-	rel level	Released
surface	linear	chr	-	-			product family	Receptacle 4 ROWS, VT 10H	10164940	rev
ASME Y14.5	angular	appr	Tim Yao	2022/04/19	BTB Secure Connector	cat. no.	Product - Customer Drw	sheet 2 of 2		