

THIS DRAWING IS A CONTROLLED DOCUMENT FOR THE USE OF THE DESIGN AND THE CONTROLLING ENGINEERING ORGANIZATION. IT SHALL BE CONTACTED FOR THE LATEST REVISION.

THIS INFORMATION IS CONFIDENTIAL AND IS DISCLOSED TO YOU ON THE CONDITION THAT YOU WILL NOT REPRODUCE OR DISSEMINATE IT TO ANY OTHER PERSON OR ORGANIZATION WITHOUT THE WRITTEN AUTHORIZATION OF AMP INCORPORATED, HARRISBURG, PA.

DIST 66

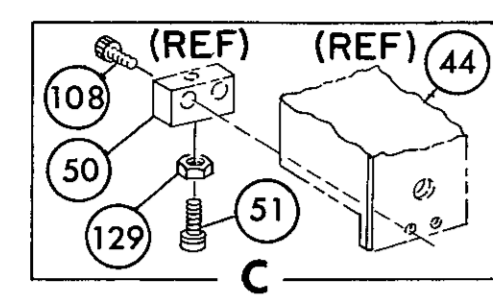
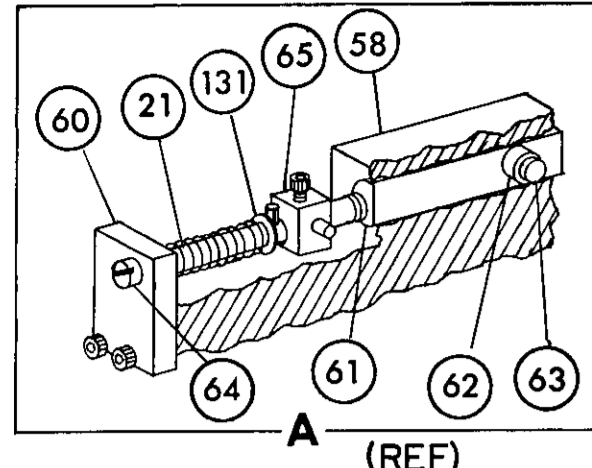

PRE-FEED 1/8" STROKE
POST-FEED 5/8" STROKE

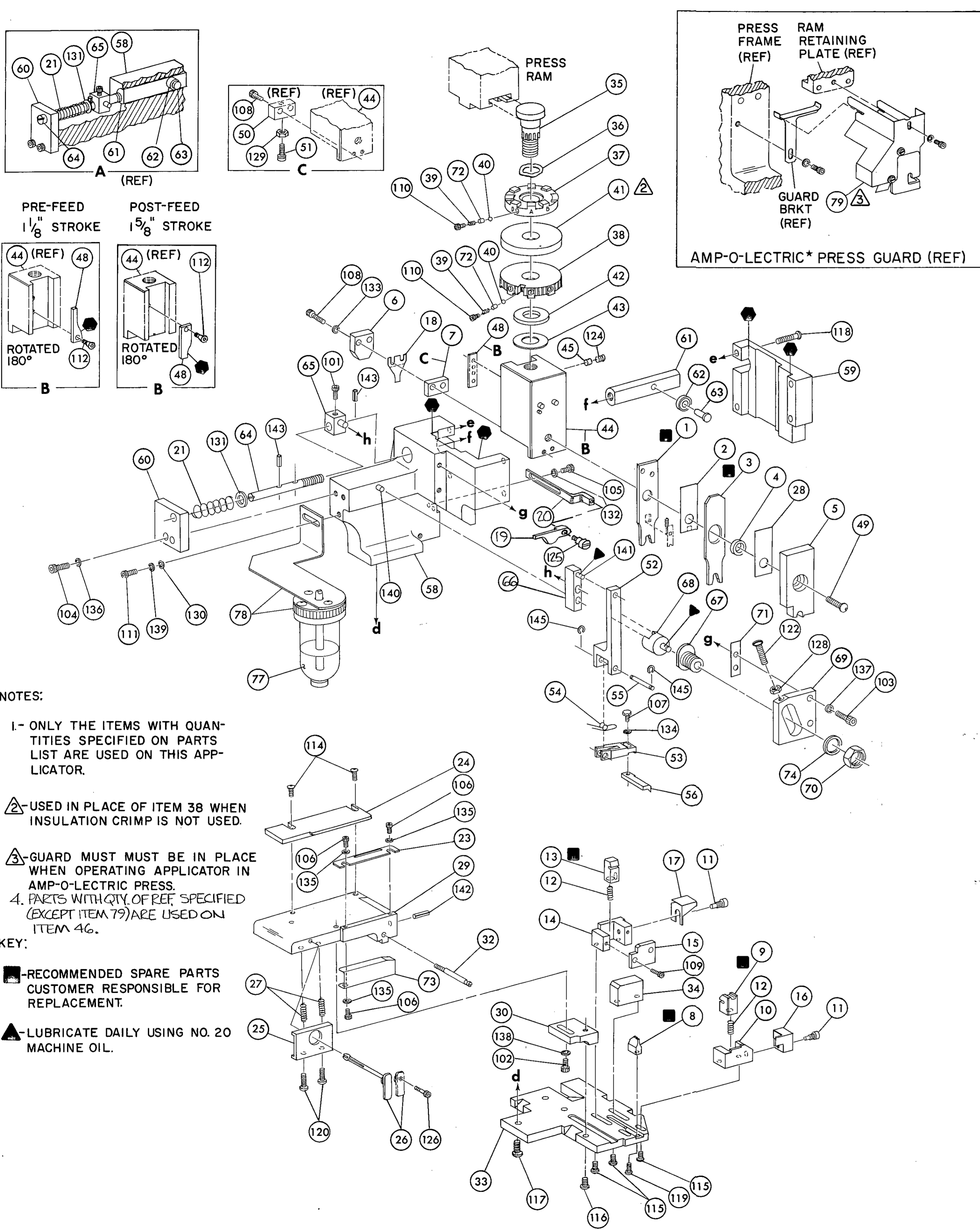
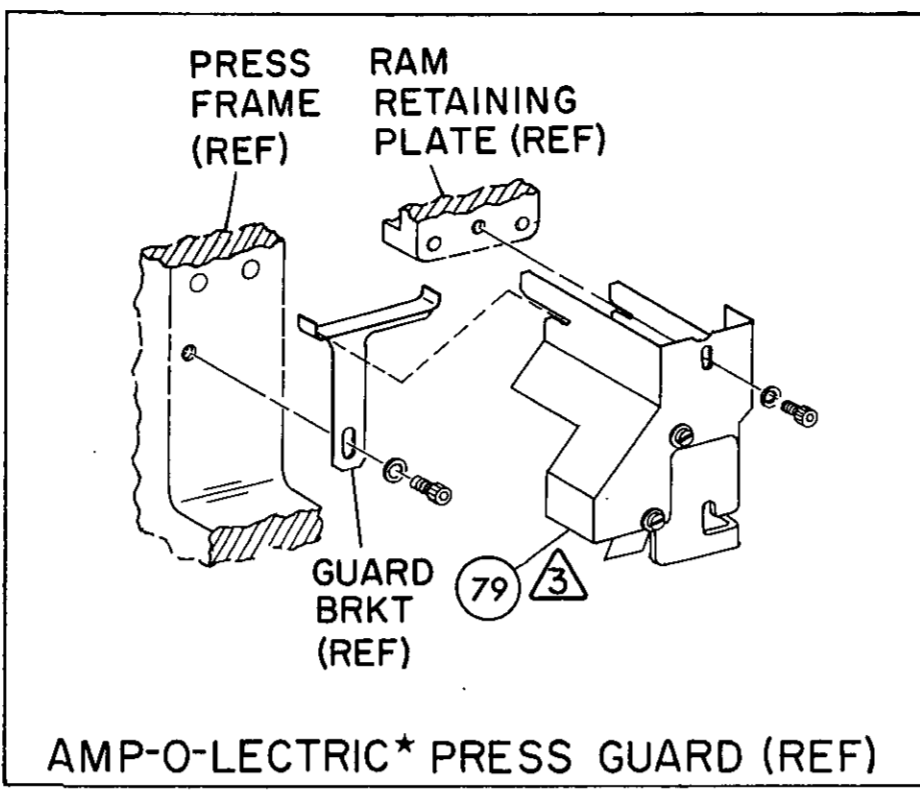
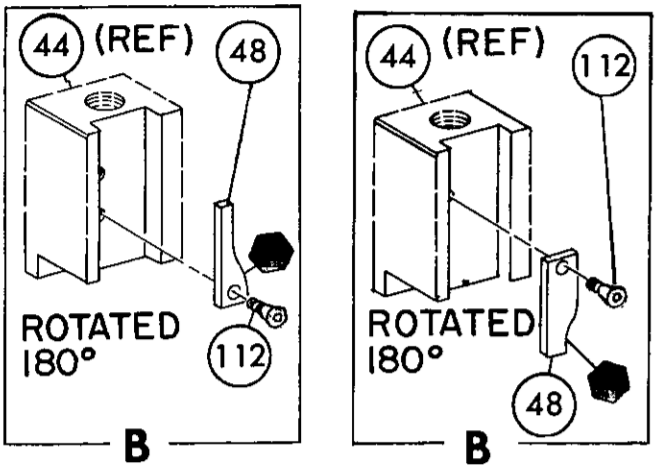

- NOTES:
- I- ONLY THE ITEMS WITH QUANTITIES SPECIFIED ON PARTS LIST ARE USED ON THIS APPLICATOR.
 - △- USED IN PLACE OF ITEM 38 WHEN INSULATION CRIMP IS NOT USED.
 - ▲- GUARD MUST BE IN PLACE WHEN OPERATING APPLICATOR IN AMP-O-LECTRIC PRESS.
 - 4. PARTS WITH QTY OF REF. SPECIFIED (EXCEPT ITEM 79) ARE USED ON ITEM 46.
- KEY:
- - RECOMMENDED SPARE PARTS CUSTOMER RESPONSIBLE FOR REPLACEMENT.
 - ▲ - LUBRICATE DAILY USING NO. 20 MACHINE OIL.

REF	PART NO	DESCRIPTION	QTY	PART NO	DESCRIPTION	ITEM NO
REF	21045-3	RING, RETAINING 'C' (.187 DIA) FEED FINGER PIN	145	REF	454220-1	CAP, HOUSING
REF	5-21028-1	PIN, SLOT SPR (.125 DIA X .50) ADJ ROD	144	REF	454485-1	HOUSING
1	4-21028-0	PIN, SLOT SPR (.093 DIA X .75) STR G PLATE	143			
REF	1-21030-1	PIN, DOWEL (.187 DIA X .50) LEVER	142	1	690542-2	PAWL, FEED
REF	1-21030-6	PIN, DOWEL (.187 DIA X 1.25) HOUSING	141	REF	240624-1	PIN, FEED FINGER
—	21024-5	WASHER, LOCK (NO 10) LUB ASSY	140	REF	691499-1	SPRING, FEED FINGER
1	21024-5	WASHER, LOCK (NO 10) STRIP GUIDE ADJ BLOCK	139	REF	690541-1	FINGER, FEED
REF	21024-5	WASHER, LOCK (NO 10) ADJ PLATE	138	REF	455679-1	LEVER, TERMINAL FEED ARM
REF	21024-5	WASHER, LOCK (NO 10) FEED GUIDE ROD	137	1	811242-2	BUMPER, HOLDDOWN
3	21057-2	WASHER, LOCK (NO 4) FRONT STRIP GUIDE	136	1	690753-1	SPACER, TONKER
1	21024-4	WASHER, LOCK (NO 8) FEED FINGER	135	1	7-21002-9	BOLT, CRIMPER
2	21024-4	WASHER, LOCK (NO 8) DEPRESSOR	134	1	690602-6	CAM PRE-FEED 1/8 STROKE
1	21024-4	WASHER, LOCK (NO 8) STRIPPER	133			
REF	21899-4	WASHER, FLAT (5/16 DIA) SCREW ADJ	132	1	459456-1	APPLICATOR, BASIC (SUB ASSY)
—	21899-2	WASHER, FLAT (NO 10) LUB ASSY	131	1	690191-1	PLUG, NYLON
1	21068-5	NUT, HEX MACH (6-32) HOLDDOWN	130	1	455673-1	RAM
REF	21068-5	NUT, HEX MACH (6-32) FEED ADJ	129	1	690125-1	WASHER, LAMINATED
—	22353-8	SCR, SHLD. (.187 DIA X .250 LG) DRAG LEVER	128	1	690124-1	WASHER, RAM
1	456567-1	SCR, SHLD. (.188 DIA X .125 LG) STRIPPER	127			DISC, SPACER
1	21009-2	SCR, SKT SET (1/4-20 X .25) (LOC-WEL) RAM	126	2	23241-6	BALL, STEEL
REF	3-21064-2	SCR, RD HD MACH (6-32 X 1.50) FEED ADJ	125	2	690170-1	SPRING, COMPRESSION
2	2-21002-9	SCR, BUT HD SKT CAP (10-32 X .75) DRAG	124	1	690142-1	DISC, INSULATION
1	22733-8	SCR, BUT HD SKT CAP (8-32 X .38) (LOC-WEL) ANVIL	123	1	9-692155-9	DISC, WIRE
REF	2-21002-9	SCR, BUT HD SKT CAP (10-32 X .75) CAP	122	1	22480-5	WASHER, SPRING
REF	1-24073-9	SCR, BUT SKT CAP (1/4-20 X .75) HOUSING	121	1	690212-1	POST, RAM
REF	2-21002-7	SCR, BUT HD SKT CAP (10-32 X .50) SG ADJ BLOCK	120			SUPPORT, TERMINAL
2	2-21002-2	SCR, BUT HD SKT CAP (8-32 X .50) SHEAR	119	REF	455675-1	PLATE, BASE
2	2-21002-2	SCR, BUT HD SKT CAP (8-32 X .50) R STRIP GUIDE	118	1	690432-3	SCREW, ADJUSTMENT
1	2-21003-0	SCR, FLAT HD SKT CAP (6-32 X .50) CAM	117			
—	3-21000-4	SCR, SKT HD CAP (10-32 X .38) LUBRICATOR ASSY	116	REF	455689-1	BLOCK, STRIP GUIDE ADJ
2	230300-1	SCR, SKT HD CAP (6-32 X .25) (LOC-WEL) CP DISC	115	1	455671-1	PLATE, STRIP GUIDE
2	221000-7	SCR, SKT HD CAP (6-32 X .50) REAR SHEAR PLATE	114	1	455888-0	SPACER, FRONT SHEAR DEPRESSOR
1	2-22603-0	SCR, HEX HD MACH (8-32 X .31) FEED FINGER	113	2	1-22284-0	SPRING, DRAG
3	1-21000-3	SCR, SKT HD CAP (4-40 X .25) F STRIP GUIDE	112	1	690546-1	LEVER, DRAG RELEASE
1	2-21000-7	SCR, SKT HD CAP (8-32 X .50) STRIPPER	111	1	240792-1	DRAG, STOCK
REF	3-21000-7	SCR, SKT HD CAP (10-32 X .75) FEED ROD GUIDE	110	1	690504-8	GUIDE STRIP (REAR)
REF	3-21000-6	SCR, SKT HD CAP (10-32 X .62) FEED ADJ BLOCK	109	1	690438-1	GUIDE, STRIP (FRONT)
1	3-21000-4	SCR, SKT HD CAP (10-32 X .38) SG ADJ BLOCK	108			
REF	3-21000-4	SCR, SKT HD CAP (10-32 X .38) PIVOT BLOCK	107	REF	4-22284-9	SPRING, FEED RETURN
REF	455749-1	GUARD, WINDOW	106	1	458950-1	ARM, STRIPPER
—	1-465184-0	LUBRICATOR ASSY	105	1	458949-1	STRIPPER
		OIL, LUBRICATING	104			HOLDER, TERMINAL
			103			GUARD, CHIP (REAR)
			102	1	691667-1	GUARD, CHIP (FRONT)
			101			PLATE, SHEAR (REAR)
			79			HOLDER, SHEAR (REAR)
			78			SHEAR, FLOAT (REAR)
			77	1	5-22280-0	SPRING, SHEAR
			76	1	690461-1	STOP, SHEAR
			75	1	690459-1	HOLDER, SHEAR (FRONT)
			74	1	454276-1	SHEAR, FLOAT (FRONT)
			73	1	690471-5	ANVIL
REF	458109-1	WASHER, SPECIAL	72			SPACER, DEPRESSOR (REAR)
1	454877-3	PLATE, STRIP GUIDE COVER	71			DEPRESSOR, SHEAR (REAR)
2	690603-1	SPRING, ASSIST	70	1	455889-9	DEPRESSOR, SHEAR (FRONT)
REF	690517-1	SPACER	69	1	238011-6	SPACER, TUBULAR, INS CRIMPER
	22594-8	NUT, HEX	68	1	4-456135-7	CRIMPER, INSULATION
	240628-1	PLATE, ADJUSTMENT	67	1	455888-5	SPACER, CRIMPER
	240626-1	SHAFT, PIVOT	66	1	1-456404-6	CRIMPER, WIRE
	240633-1	BUSHING	65			
	455680-1	LEVER, INTERMEDIATE	64			
	240629-1	BLOCK, PIVOT	63			
	240632-2	SCREW, ADJUSTMENT FEED ROD	62			
	240659-3	PIN, CAM ROLLER	61			
	240658-1	ROLLER, CAM	60			
	454398-2	ROD, FEED	60			
REF	454178-1	GUIDE, FEED ROD	60			

CRIMPING DATA		APPLICATOR WILL APPLY	
PAD LTR	CRIMP HEIGHT	WIRE SIZE	STRIP LENGTH
A	NOT	USED	
B	.035	20	
C	NOT	USED	
D	.032	22	

CRIMP	SIZE	TYPE	FEED	APPL INST
WIRE	.070	F	.350	A1 8040
INSUL	.100	O		

WIRE RANGE	INSULATION RANGE	PRESS NO
22-20	.100 MAX.	565435-5

REMARKS: AMP-O-LECTRIC PRE-FEED

APPL USED ON MACHINE PART NO	MACH SERIAL NO	DISTRIBUTION
		ORIGINAL
		CUSTOMER COPY
		FIELD ENG COPY

REVISION RECORD	REVISION RECORD	REVISION RECORD	REVISION RECORD
DATE	DATE	DATE	DATE

SET UP GAGE 10-1
458637-1
DR 1-22-75 APP-2377
EANOLFE
CHK 2-25-75 REL 1/2
LOG A D NO 466385-2
NAME MINIATURE QUICK CHANGE APPLICATOR
SIDE FEED (AMP-IN)