

LOC	DIST	REVISIONS					
GP	00	P	LTN	DESCRIPTION	DATE	DWN	APVD
		A		PRODUCTION RELEASE	29FEB2016	JW	SH

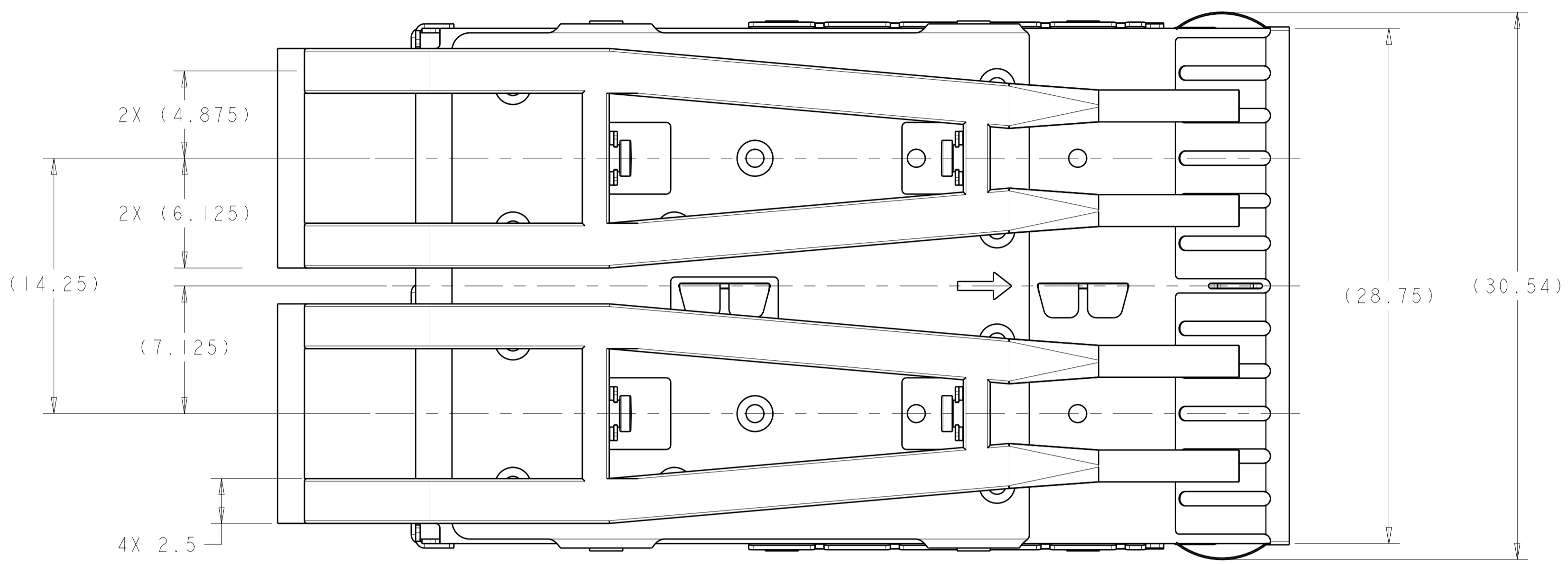

- △ MATERIAL:
CAGE ASSEMBLY: NICKEL SILVER ALLOY
EMI SPRING: PHOSPHOR BRONZE
LIGHT PIPE BRACKET: STAINLESS STEEL
LIGHT PIPE: POLYCARBONATE, CLEAR.
- △ DATUM AND BASIC DIMENSION ESTABLISHED BY CUSTOMER.
- 3. MATES WITH SFP MSA COMPLIANT TRANSCEIVERS.
- △ PADS AND VIAS CHASSIS GROUND.
- 5. INTERPRETATION OF DATUM REFERENCE FRAME IN ACCORDANCE WITH SECT 4.4.1.1 OF ASME Y14.5M-1994.
- △ MINIMUM PC BOARD THICKNESS:
SINGLE SIDED: 1.45mm.
- △ HOLE PATTERN REPEATS FOR EACH PORT, SPACING BETWEEN PORTS IS 14.25mm.
- △ REFERENCE APPLICATION SPEC 114-13120, HOLE A, FOR RECOMMENDED DRILL HOLE DIAMETER AND PLATING THICKNESS.
- △ REFERENCE APPLICATION SPEC 114-13120, HOLE B, FOR RECOMMENDED DRILL HOLE DIAMETER AND PLATING THICKNESS.
- △ LIGHT PIPE ASSEMBLY SHIPPED UNASSEMBLED TO CAGE ASSEMBLY, CAGE ASSEMBLY TO BE PRESSED INTO THE PC BOARD PRIOR TO ATTACHING THE LIGHT PIPE ASSEMBLY TO THE CAGE ASSEMBLY.

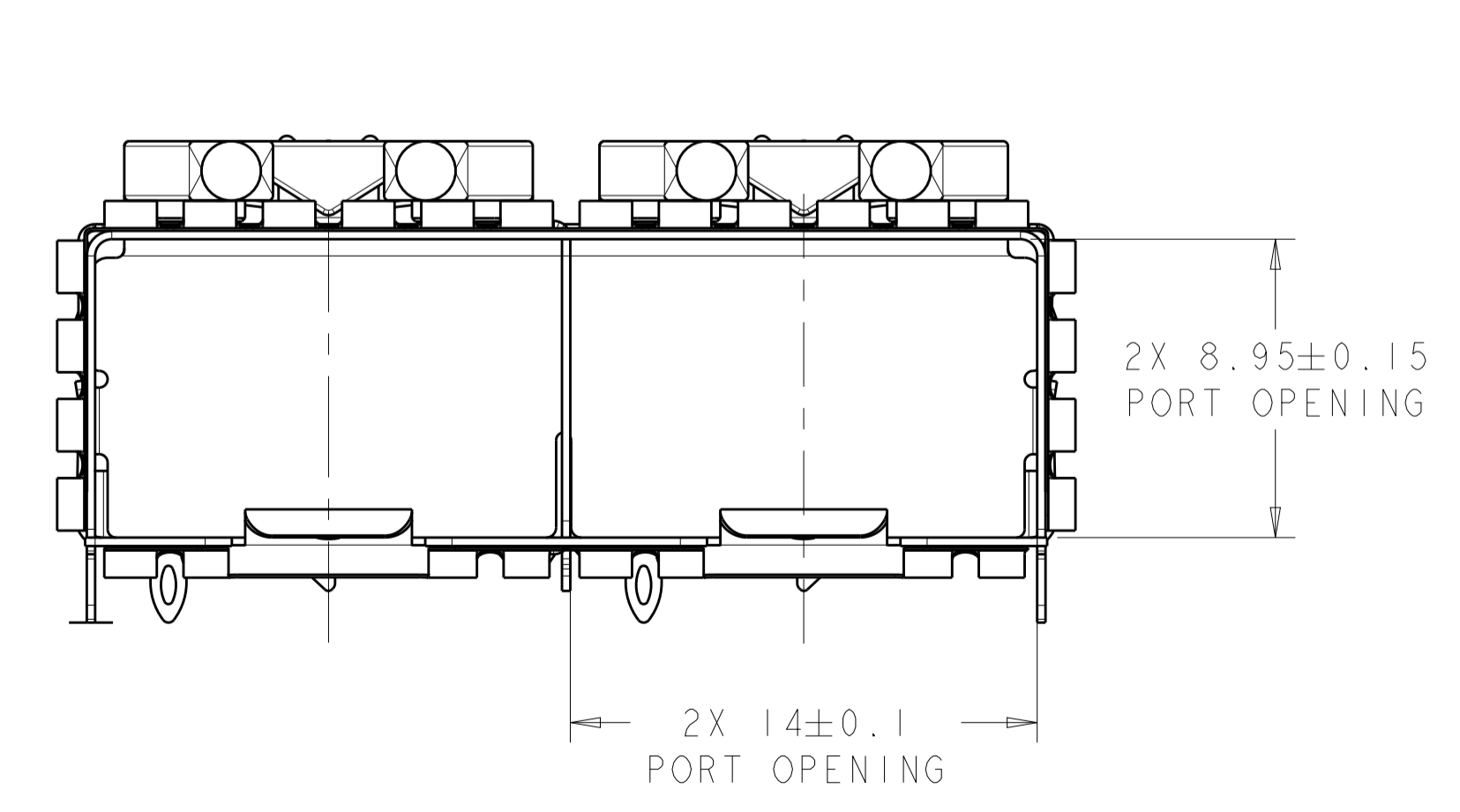
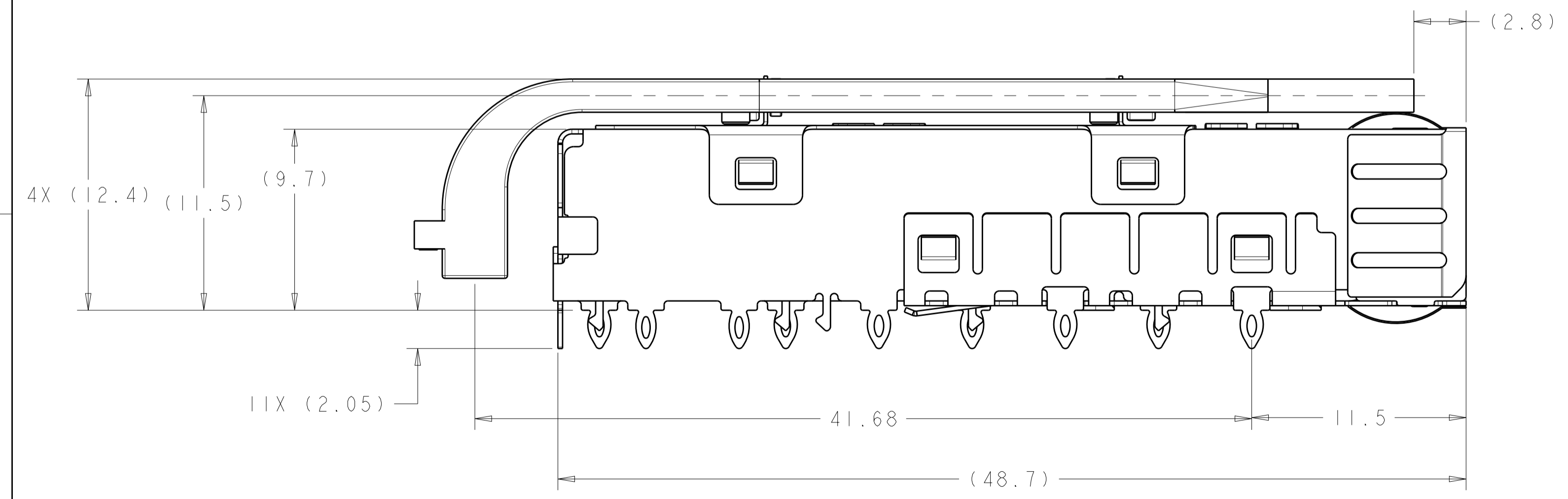
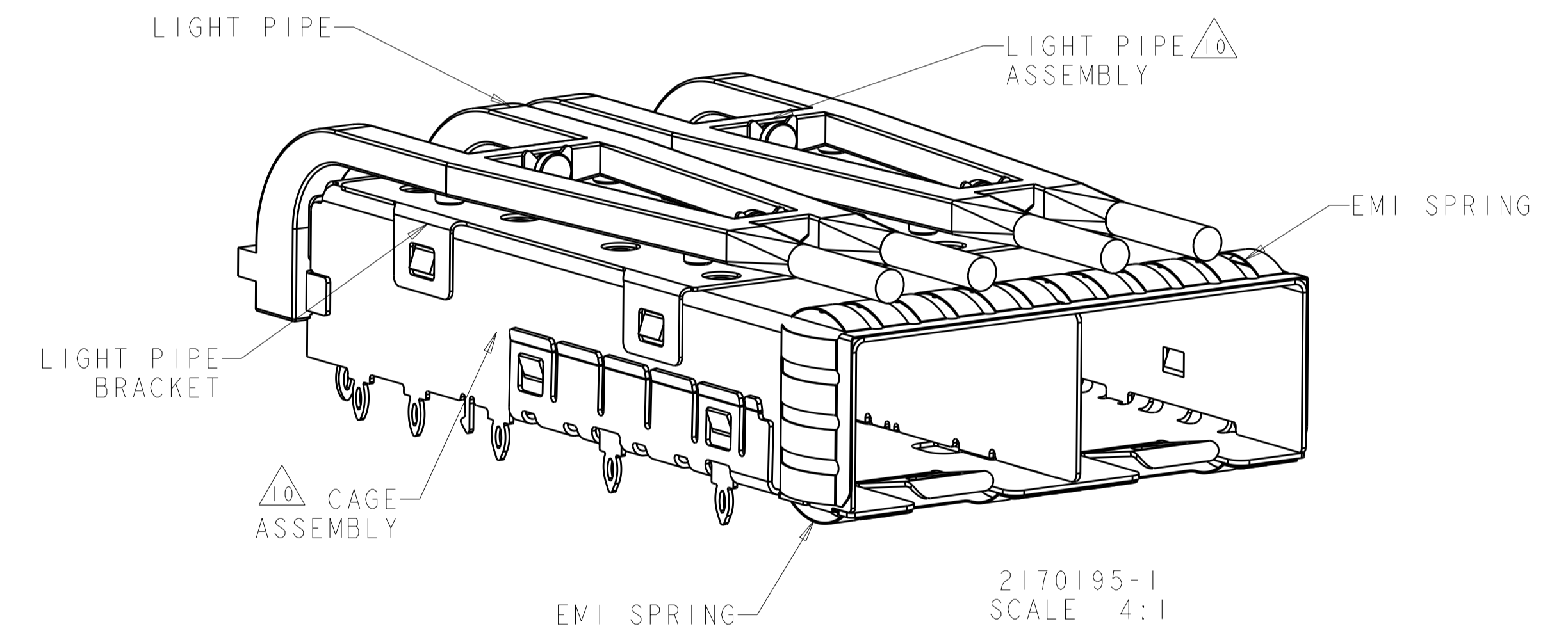

2170195-1
PART NUMBER

THIS DRAWING IS A CONTROLLED DOCUMENT.		DWN: JASON YANG 23NOV2011	TE Connectivity	
DIMENSIONS: mm		CHK: ALEX CAI 23NOV2011		
TOLERANCES UNLESS OTHERWISE SPECIFIED:		APVD: ALEX CAI 23NOV2011	NAME: SFP+ 1X2 CAGE ASSEMBLY WITH LIGHT PIPES, PRESS FIT, EMI SPRING	
0 PLC	±0.2	PRODUCT SPEC	SIZE: CAGE CODE DRAWING NO. RESTRICTED TO	
1 PLC	±0.2	108-2364	A100779C=2170195	
2 PLC	±0.20	APPLICATION SPEC	SCALE: 5:1 SHEET 1 OF 3 REV A	
3 PLC	±	114-13120		
4 PLC	±	WEIGHT		
ANGLES	±	CUSTOMER DRAWING		
MATERIAL	FINISH			

LOC	DIST	REVISIONS			
P	LTN	DESCRIPTION	DATE	DWN	APVD
GP	00	SEE SHEET 1	-	-	-

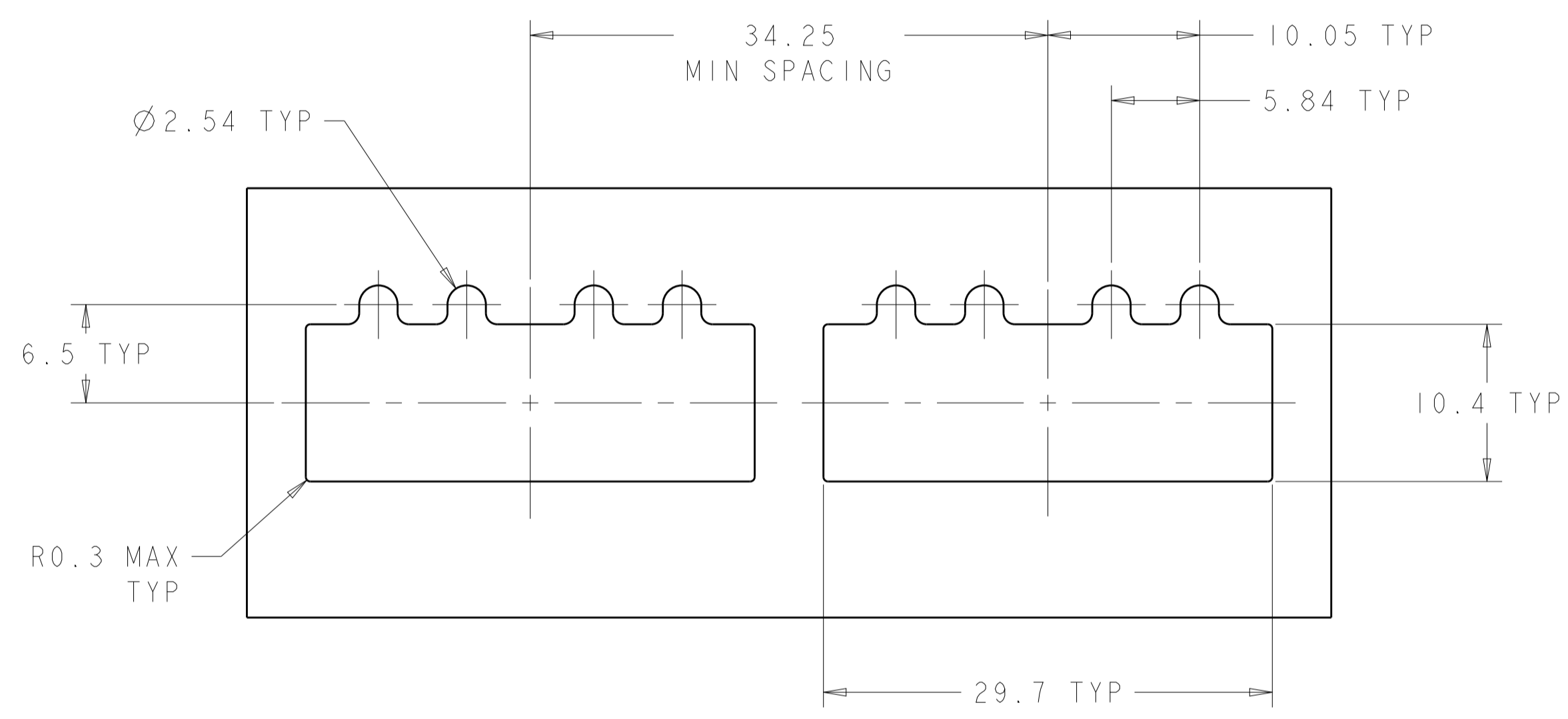

RECOMMENDED BEZEL CUT-OUT
 PANEL TOLERANCE: ±0.1
 SCALE 3:1

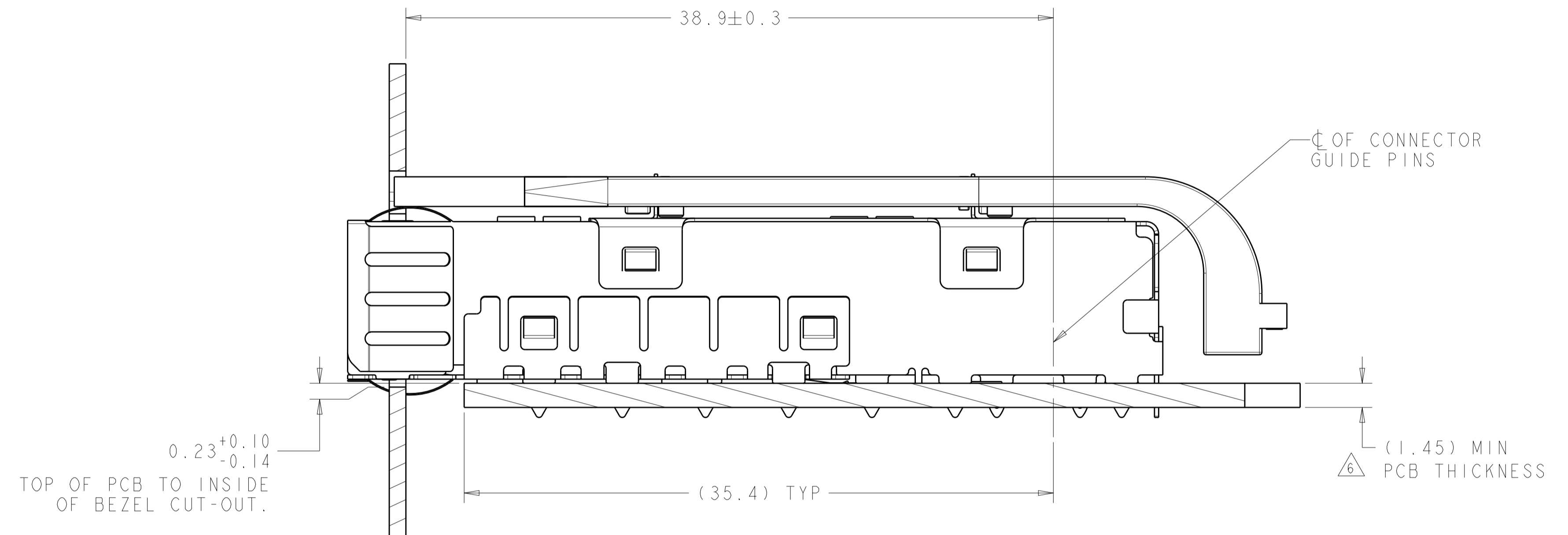

SECTION J-J
 MOUNTED ON PCB
 SHOWN THRU RECOMMENDED BEZEL

THIS DRAWING IS A CONTROLLED DOCUMENT.		DWN: JASON YANG 23NOV2011	
DIMENSIONS: mm		CHK: ALEX CAI 23NOV2011	
TOLERANCES UNLESS OTHERWISE SPECIFIED:		APVD: ALEX CAI 23NOV2011	NAME: SFP+ 1X2 CAGE ASSEMBLY WITH LIGHT PIPES, PRESS FIT, EMI SPRING
0 PLC	±0.2	PRODUCT SPEC	108-2364
1 PLC	±0.2	APPLICATION SPEC	114-13120
2 PLC	±0.20	SIZE	A100779
3 PLC	±	CAGE CODE	C=2170195
4 PLC	±	DRAWING NO	2170195
ANGLES	±	RESTRICTED TO	-
FINISH	±	SCALE	5:1
MATERIAL	-	SHEET	2 OF 3
		REV	A
CUSTOMER DRAWING			

LOC	DIST	REV	DATE	APPD	REV	DATE	APPD
GP	00						

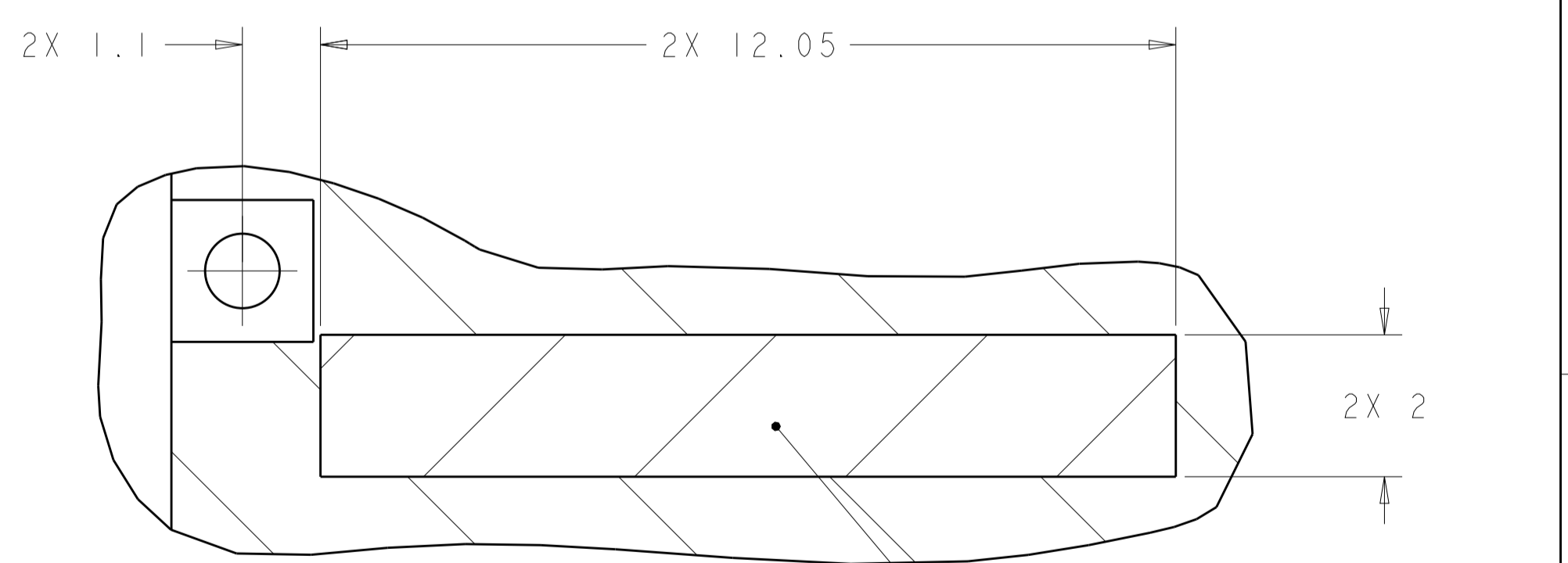
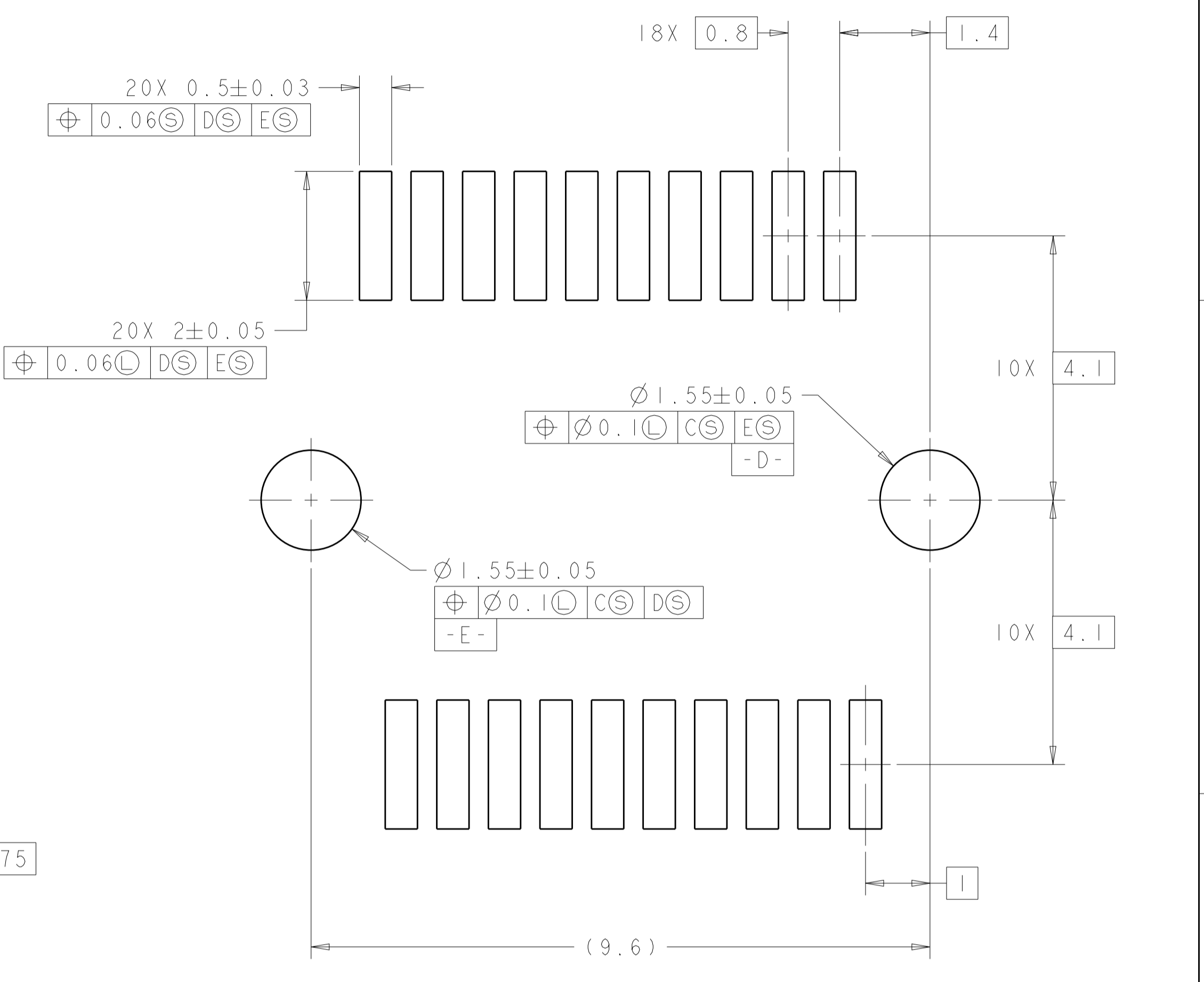
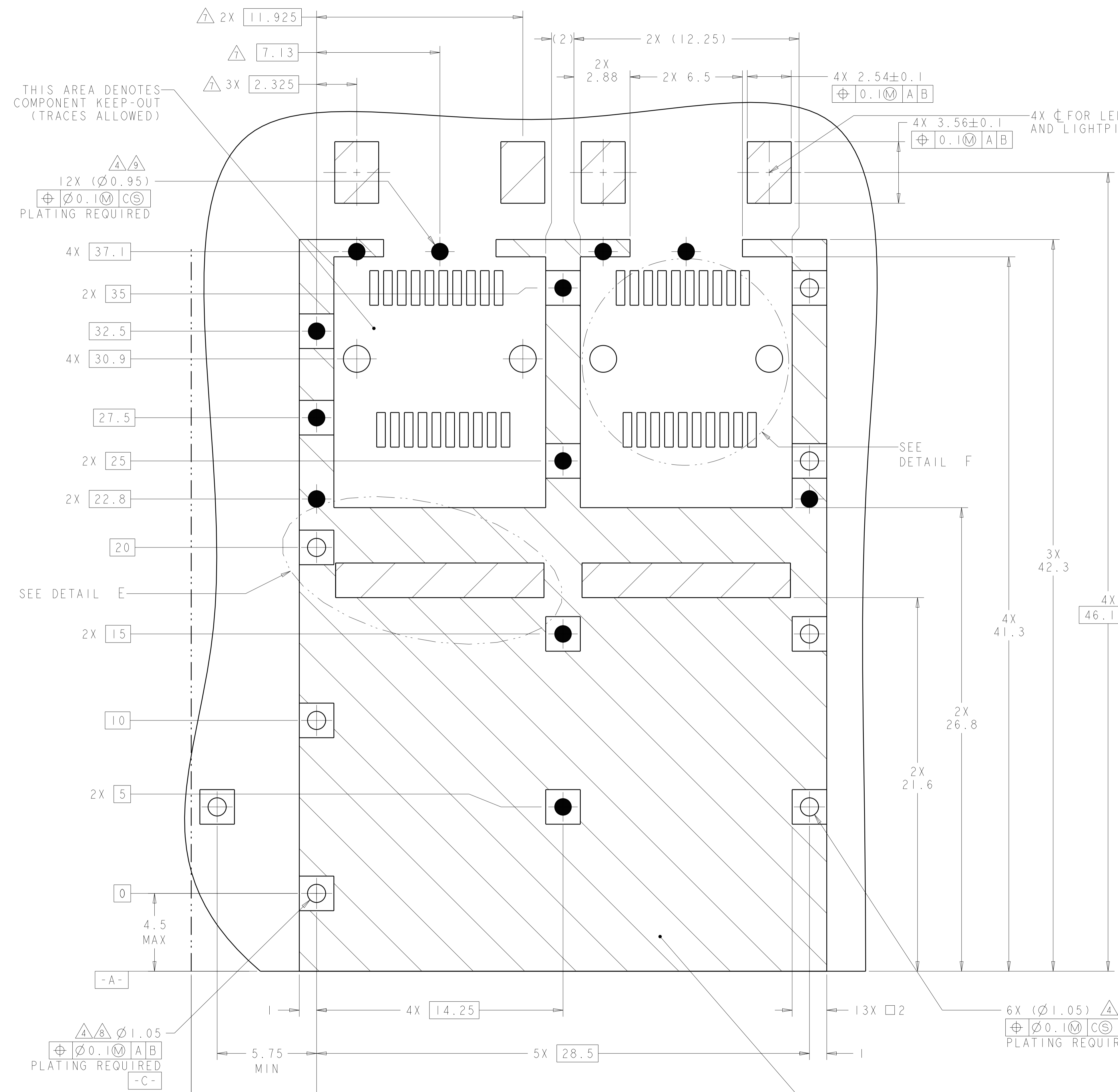

THIS AREA DENOTES COMPONENT KEEP-OUT (TRACES ALLOWED)

12X (∅0.95) PLATING REQUIRED

4X FOR LED PLACEMENT AND LIGHTPIPE COVERAGE AREA

SEE DETAIL F

SEE DETAIL E

DETAIL F SCALE 16:1

DETAIL E SCALE 12:1

CROSS-HATCHED AREA DENOTES EXPOSED CHASSIS GROUND

CROSS-HATCHED AREA DENOTES COMPONENT AND TRACE KEEP-OUT (EXCEPT CHASSIS GROUND)

RECOMMENDED PCB CONFIGURATION WITH KEEP-OUT AREAS SINGLE SIDED APPLICATIONS PCB TOLERANCE: ±0.05 SCALE 8:1

THIS DRAWING IS A CONTROLLED DOCUMENT.		DWN: JASON YANG 23NOV2011 CHN: ALEX CAI 23NOV2011 APPD: ALEX CAI 23NOV2011	STE TE Connectivity	
DIMENSIONS:	TOLERANCES UNLESS OTHERWISE SPECIFIED:	NAME	SFP+ 1X2 ASSEMBLY WITH LIGHT PIPES, PRESS FIT, EMI SPRING	
mm	0 PLC ±0.2 1 PLC ±0.2 2 PLC ±0.20 3 PLC ±0.2 4 PLC ±0.2 ANGLES ±0.3	PRODUCT SPEC	108-2364	
		APPLICATION SPEC	114-13120	
MATERIAL	FINISH	WEIGHT	SIZE	CAGE CODE DRAWING NO
			A100779	C=2170195
		CUSTOMER DRAWING	SCALE	5:1 SHEET 3 OF 3 REV A