

VSE153

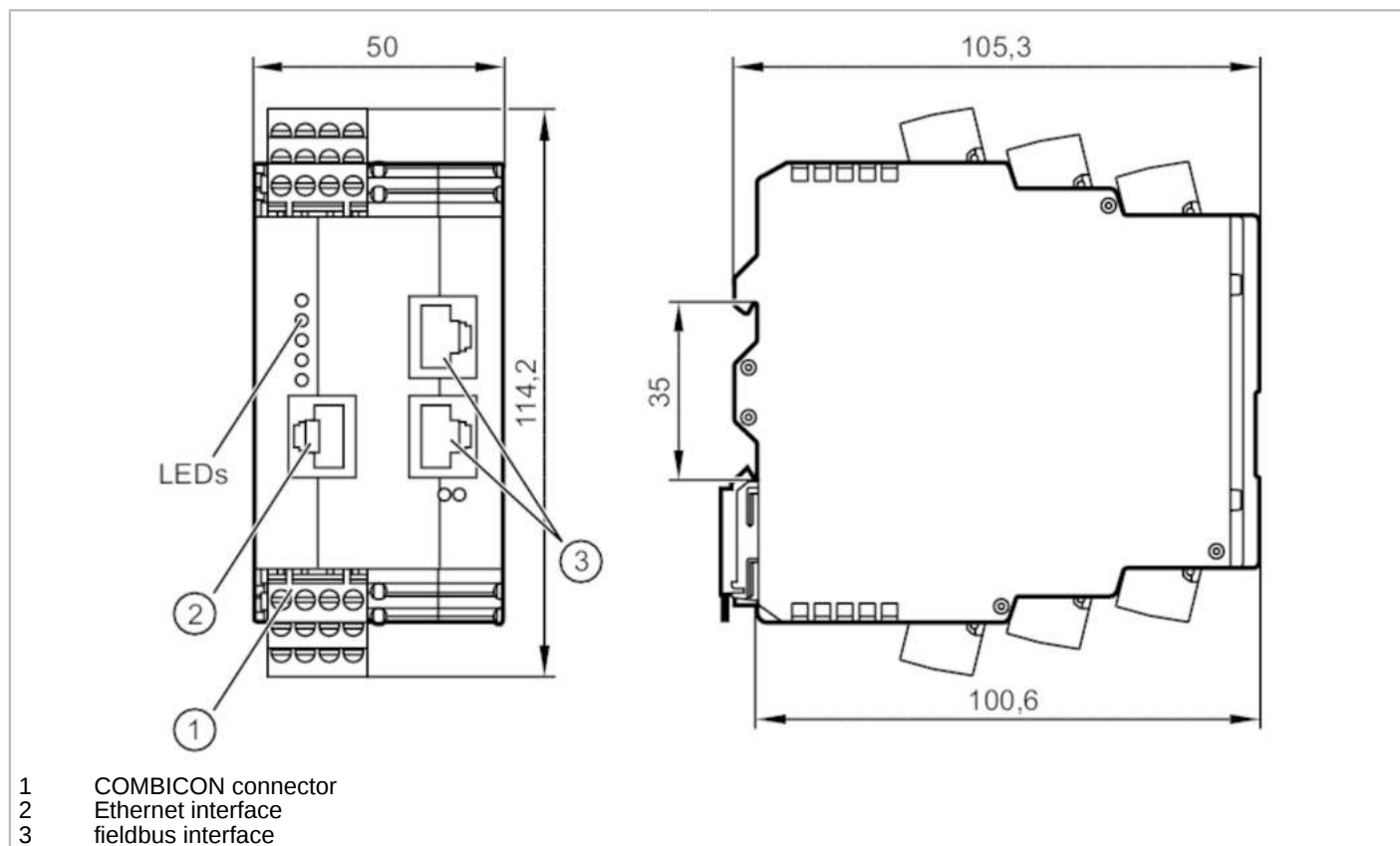

Diagnostic electronics for vibration sensors

DIAGNOSTIC ELECTRONICS



Product characteristics	
Frequency range [Hz]	0.1...12000
Communication interface	Ethernet
Application	
Design	parameter setting via PC software VES004
Application	continuous vibration monitoring
Electrical data	
Operating voltage tolerance [%]	20
Operating voltage [V]	24 DC; (when using the IEPE input: 24 V + 20%; IEPE = Integrated Electronics Piezo Electric)
Current consumption [mA]	200; ((24 V DC))
Protection class	III
Inputs / outputs	
Total number of inputs and outputs	8; (configurable)
Number of inputs and outputs	Number of analogue inputs: 2; number of dynamic inputs: 4; Number of digital outputs: 2; Number of analogue outputs: 1
Inputs	
Total number of inputs	6
Number of analogue inputs	2
Analogue input (current) [mA]	4...20



Diagnostic electronics for vibration sensors

DIAGNOSTIC ELECTRONICS

Resolution of analogue input	12
Number of dynamic inputs	4
Dynamic input - signal	0...10 mA / IEPE / 4...20 mA
Dynamic input - resolution [bit]	16
Dynamic input - frequency range [Hz]	0,1...12000
Dynamic input - sampling rate [kSamples]	100

Outputs

Total number of outputs	2
Output signal	switching signal; analogue signal
Electrical design	PNP
Number of digital outputs	2; (configurable)
Output function	normally open / normally closed; (parameterisable)
Max. voltage drop switching output DC [V]	2
Permanent current rating of switching output DC [mA]	100
Number of analogue outputs	1; (configurable)
Analogue current output [mA]	4...20
Max. load [Ω]	500
Short-circuit protection	yes
Type of short-circuit protection	pulsed
Overload protection	yes

Measuring/setting range

Frequency range [Hz]	0.1...12000
----------------------	-------------

Interfaces

Communication interface	Ethernet
Transmission rate	10 MBaud; 100 MBaud
Protocol	Modbus TCP

Operating conditions

Ambient temperature [°C]	0...60
Storage temperature [°C]	0...60
Protection	IP 20

Tests / approvals

EMC	EN 61000-4-2 ESD	4 kV contact discharge / 15 kV air discharge
	EN 61000-4-3	10 V/m (80...2700 MHz)
	EN 61000-4-4 Burst	4 kV capacitive coupling probe, earthed
	EN 61000-4-6	10 V 0,15...80 MHz
	EN 61000-6-4	industrial environments
MTTF [years]		91
UL approval	Ta	0...60 °C
	Enclosure type	open Type
	power supply	Limited Voltage/Current
	UL Approval no.	L001



Diagnostic electronics for vibration sensors

DIAGNOSTIC ELECTRONICS

Mechanical data	
Weight [g]	414.6
Housing	plastic housing
Type of mounting	rail; (TH35/EN60715)
Dimensions [mm]	114.2 x 50 x 105.3
Materials	PA
Data memories	
Real-time clock	yes;
Accessories	
Accessories (optional)	cross-over Ethernet patch cable for the direct connection to the PC
Remarks	
Pack quantity	1 pcs.
Electrical connection	
COMBICON:	
Connection	

