

NOTE: GROMMET CAP LOCK SHOULD PROPERLY ENGAGE WITH HOUSING SLOT

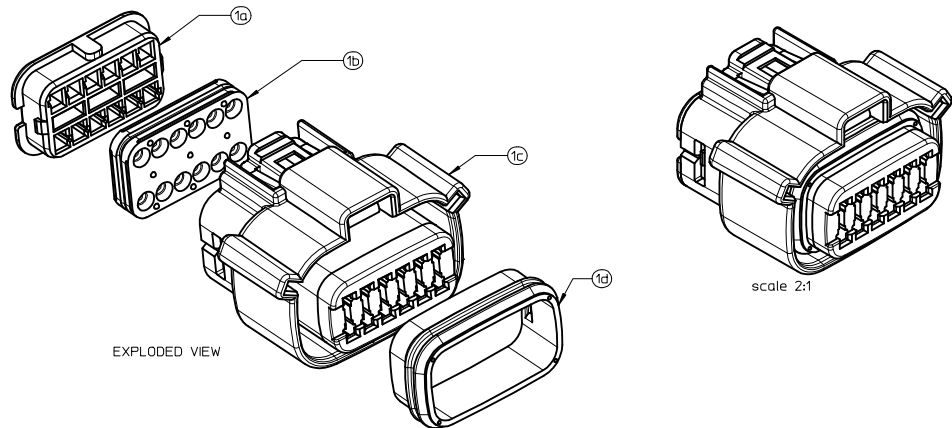

scale 2:1

TABLE-A

RECEPTACLE ASSEMBLY						
SL #	ASSEMBLY PART #	PART #	PART DESCRIPTION	QTY	MATERIAL	COLOR
1	367830002	1a	GROMMET CAP	1	NYLON-GF	---
		1b	GROMMET SEAL	1	SILICON RUBBER	LIGHT BLUE
		1c	RECEPTACLE HOUSING	1	NYLON-GF	---
		1d	RING SEAL	1	SILICON RUBBER	RUST RED

NOTES:

- MATES WITH HEADER ASSEMBLY PART #36783-0001.
- USE WITH RECEPTACLE TERMINAL PART #S 36783-0003 AND 36783-0004.
- PACKAGE SPECIFICATION AS PER FK-36783-002.
- SHALL CONFORM TO PRODUCT SPECIFICATION PS-36783-001.
- MAUFACTURING DATE CODE WILL BE IDENTIFIED ON BAR CODE LABEL SHIPPED AGAINST EACH ORDER. PARTS WILL BE TRACED AGAINST THIS.
- FEMALE TERMINAL TO BE CRIMPED AND INSERTED INTO RECEPTACLE HOUSING.
- ALL DIMENSIONS SHOWN ARE APPLICABLE AS RECEIVED INTO CUSTOMER PLACE.
- MOLEX OWNS RESPONSIBILITY AS SHIPPED FROM MOLEX. ASSEMBLY OF RECEPTACLE ON TO CONTROL UNIT ALONG WITH IT'S FUNCTIONALITY COMES UNDER CUSTOMER SCOPE.

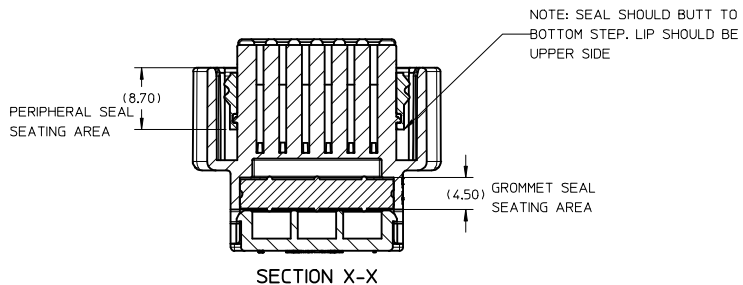

NOTE: SEAL SHOULD BUTT TO BOTTOM STEP. LIP SHOULD BE UPPER SIDE

<b>ENTER DESCRIPTION</b> EC NO: 12013-0193 DRW: HRVAKRISHNA 2013/06/10 CHK: CHIKO APPR: KPRASAD 2013/06/11 REV: B	<b>QUALITY SYMBOLS</b> $\nabla=0$ $\nabla=0$ $\nabla=0$	<b>GENERAL TOLERANCES (UNLESS SPECIFIED)</b> <table border="1"> <tr> <th></th> <th>mm</th> <th>INCH</th> </tr> <tr> <td>4 PLACES</td> <td>± ---</td> <td>± ---</td> </tr> <tr> <td>3 PLACES</td> <td>± ---</td> <td>± ---</td> </tr> <tr> <td>2 PLACES</td> <td>± ---</td> <td>± ---</td> </tr> <tr> <td>1 PLACE</td> <td>± ---</td> <td>± ---</td> </tr> <tr> <td colspan="3">ANGULAR ± ---°</td> </tr> </table>		mm	INCH	4 PLACES	± ---	± ---	3 PLACES	± ---	± ---	2 PLACES	± ---	± ---	1 PLACE	± ---	± ---	ANGULAR ± ---°			<b>DIMENSION STYLE</b> <b>MM ONLY</b> DRAWN BY: VUTTARKAR DATE: 2011/07/29 CHECKED BY: _____ DATE: _____ APPROVED BY: KPRASAD DATE: 2011/08/01 MATERIAL NO. _____	<b>SCALE</b> <b>2:1</b> <b>DESIGN UNITS</b> <b>METRIC</b> <b>THIRD ANGLE PROJECTION</b>	<b>TITLE</b> <b>12 CKT RECEPTACLE ASSY</b> <b>1.2 MM SEALED CONNECTOR SYSTEM</b>	<b>DOCUMENT NO.</b> <b>SD-36783-002</b>	<b>SHEET NO.</b> <b>1 OF 1</b>
		mm	INCH																						
	4 PLACES	± ---	± ---																						
	3 PLACES	± ---	± ---																						
2 PLACES	± ---	± ---																							
1 PLACE	± ---	± ---																							
ANGULAR ± ---°																									
<b>DRAFT WHERE APPLICABLE MUST REMAIN WITHIN DIMENSIONS</b>	<b>SEE TABLE-A</b>	<b>MOLEX INCORPORATED</b>	<b>INCORPORATED AND SHOULD NOT BE USED WITHOUT WRITTEN PERMISSION</b>																						