

PART NUMBERS	CKT SIZE	VOID POSITION	DIMENSION		PACKAGING TYPE
			A	B	
87759-0028	20	----	19.90	18.00	WITHOUT CAP IN TUBE
87759-0029	20	----	19.90	18.00	WITH CAP IN TUBE
87759-0030	20	----	19.90	18.00	WITH CAP IN TAPE & REEL

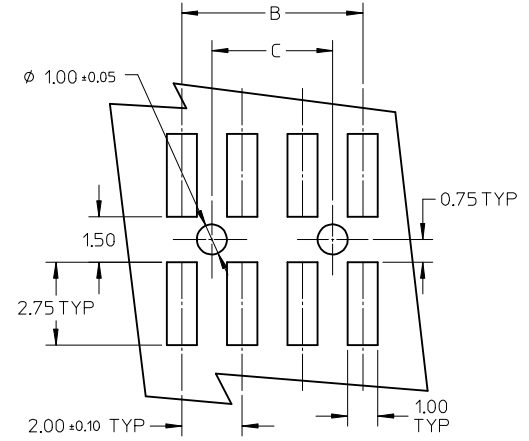

RECOMMENDED PCB PATTERN

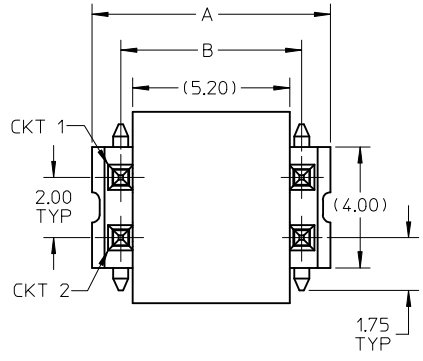
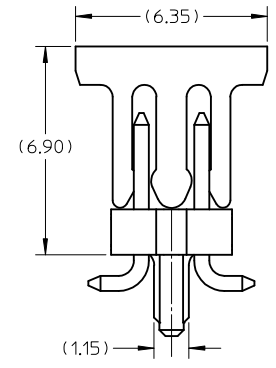
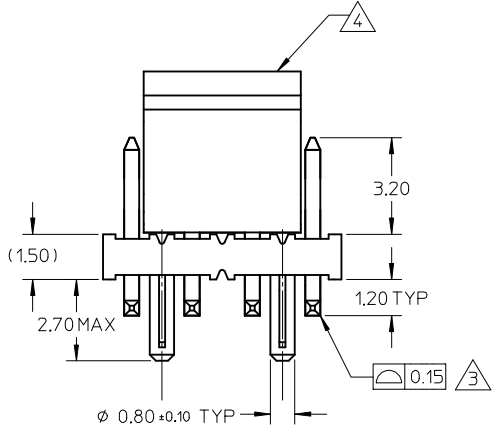

NOTES:

- MATERIAL: HOUSING: NYLON (4/6), 30% G.F., UL94V-0, COLOR: BLACK
PIN: COPPER ALLOY, SQ, 0.5mm
- PLATING FINISH: 154n MIN GOLD PLATE IN SELECTED AREA AND 754n MIN TIN ON SOLDER TAIL OVER 504n MIN NICKEL UNDERPLATE OVERALL.
- COPLANARITY IS TO BE MEASURED BY RESTING THE SOLDER TAIL ON A FLAT SURFACE
- CAP TO BE LOCATED AS CENTRAL OF PART AS POSSIBLE
- TUBE LENGTH : 560mm REF.
- THE ABOVE 8CKTS SHOWN IS FOR ILLUSTRATION ONLY.
- PRODUCT SPECIFICATION: PS-87761-100

REVISED EC NO: S2007-0829 DRW:SKL IM01 CHKD: CWLAM APPR: KWLEE	REV DESCRIPTION	QUALITY SYMBOLS	GENERAL TOLERANCES (UNLESS SPECIFIED)	DIMENSION STYLE		SCALE	DESIGN UNITS	THIRD ANGLE PROJECTION
		▼=0 ◻=0		MM ONLY	NTS	METRIC		
				mm	INCH			
				4 PLACES ± --- ± --- 3 PLACES ± --- ± --- 2 PLACES ± 0.20 ± --- 1 PLACE ± --- ± ---	DRAWN BY DATE KCHO 2004/08/23		TITLE CUSTOM HEADER MGRID, 2.00MM PITCH, HDR DUAL ROW S/W W/PEG, SMT	
	ANGULAR ± 3 °	CHECKED BY DATE PTLIM 2004/08/24		APPROVED BY DATE SLOW 2004/08/25		MOLEX INCORPORATED		
	DRAFT WHERE APPLICABLE MUST REMAIN WITHIN DIMENSIONS	MATERIAL NO.		DOCUMENT NO.		SHEET NO.		
		SEE TABLE		SD-87759-226		1 OF 2		
		THIS DRAWING CONTAINS INFORMATION THAT IS PROPRIETARY TO MOLEX INCORPORATED AND SHOULD NOT BE USED WITHOUT WRITTEN PERMISSION						

PART NUMBERS WITH CAP IN TAPE & REEL	CKT SIZE	F	Bo	So	W
87759-0030	20	20.20	20.50	40.40	44.00

WITH CAP IN TAPE & REEL PACKAGING

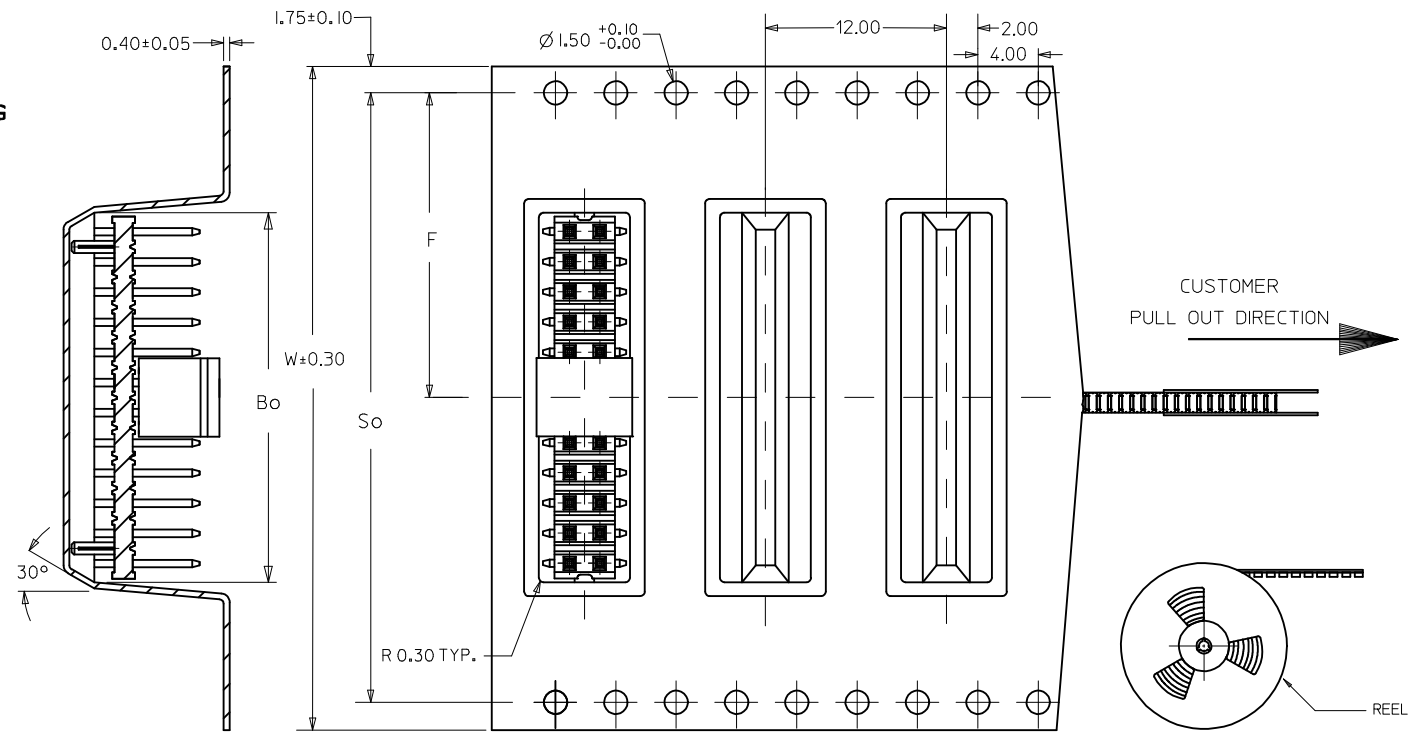

NOTES:

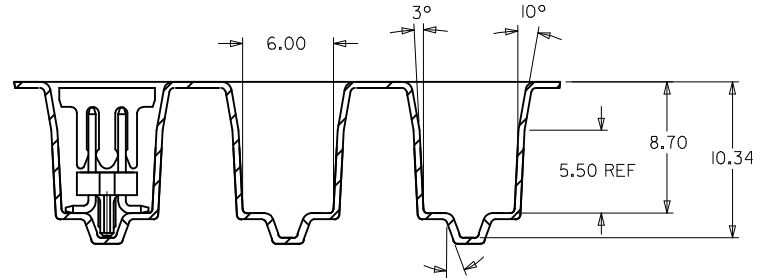
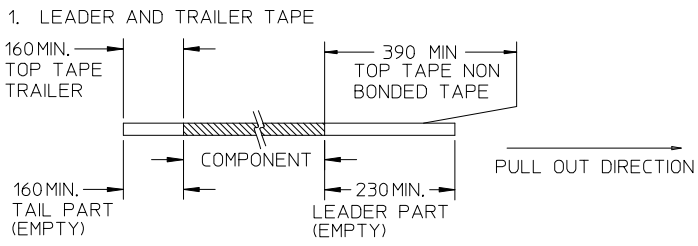

2. PEELING OFF FORCE OF THE TOP TAPE: 20-80gf.
(PEELING DIRECTION AS SHOWN IN FOLLOWING FIGURE)

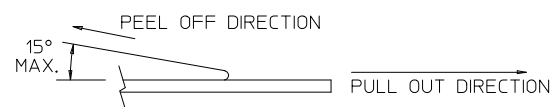

3. TAPE AND REEL SPECIFICATION IS AS PER EIA-481.
4. TAPE AND REEL QUANTITY : 500PCS/ REEL.
5. THE TAPE IS TREATED FOR ANTI-STATIC.

REVISED EC NO: S2007-0829 DRWN:SKL IM01 CHKD:CWLAM APPR:KNLEE	REV B	DESCRIPTION 2007/04/10 2007/04/12 2007/04/17	QUALITY SYMBOLS	GENERAL TOLERANCES (UNLESS SPECIFIED)	DIMENSION STYLE	SCALE	DESIGN UNITS	THIRD ANGLE PROJECTION															
			$\nabla=0$ $\nabla=0$	<table border="1"> <thead> <tr> <th></th> <th>mm</th> <th>INCH</th> </tr> </thead> <tbody> <tr> <td>4 PLACES</td> <td>± ---</td> <td>± ---</td> </tr> <tr> <td>3 PLACES</td> <td>± ---</td> <td>± ---</td> </tr> <tr> <td>2 PLACES</td> <td>± 0.20</td> <td>± ---</td> </tr> <tr> <td>1 PLACE</td> <td>± ---</td> <td>± ---</td> </tr> </tbody> </table>		mm	INCH	4 PLACES	± ---	± ---	3 PLACES	± ---	± ---	2 PLACES	± 0.20	± ---	1 PLACE	± ---	± ---	MM ONLY	NTS	METRIC	
				mm	INCH																		
			4 PLACES	± ---	± ---																		
3 PLACES	± ---	± ---																					
2 PLACES	± 0.20	± ---																					
1 PLACE	± ---	± ---																					
<table border="1"> <thead> <tr> <th>DRAWN BY</th> <th>DATE</th> <th>TITLE</th> </tr> </thead> <tbody> <tr> <td>KCHO</td> <td>2004/08/23</td> <td rowspan="2">CUSTOM HEADER MGRID, 2.00MM PITCH, HDR DUAL ROW S/W W/PEG, SMT</td> </tr> <tr> <td>CHECKED BY</td> <td>DATE</td> </tr> <tr> <td>PTLIM</td> <td>2004/08/24</td> <td rowspan="2">MOLEX INCORPORATED</td> </tr> <tr> <td>APPROVED BY</td> <td>DATE</td> </tr> <tr> <td>SCLOW</td> <td>2004/08/25</td> <td>SD-87759-226</td> </tr> </tbody> </table>	DRAWN BY	DATE	TITLE	KCHO	2004/08/23	CUSTOM HEADER MGRID, 2.00MM PITCH, HDR DUAL ROW S/W W/PEG, SMT	CHECKED BY	DATE	PTLIM	2004/08/24	MOLEX INCORPORATED	APPROVED BY	DATE	SCLOW	2004/08/25	SD-87759-226	<table border="1"> <thead> <tr> <th>MATERIAL NO.</th> <th>DOCUMENT NO.</th> <th>SHEET NO.</th> </tr> </thead> <tbody> <tr> <td>SEE TABLE</td> <td></td> <td>2 OF 2</td> </tr> </tbody> </table>	MATERIAL NO.	DOCUMENT NO.	SHEET NO.	SEE TABLE		2 OF 2
DRAWN BY	DATE	TITLE																					
KCHO	2004/08/23	CUSTOM HEADER MGRID, 2.00MM PITCH, HDR DUAL ROW S/W W/PEG, SMT																					
CHECKED BY	DATE																						
PTLIM	2004/08/24	MOLEX INCORPORATED																					
APPROVED BY	DATE																						
SCLOW	2004/08/25	SD-87759-226																					
MATERIAL NO.	DOCUMENT NO.	SHEET NO.																					
SEE TABLE		2 OF 2																					
DRAFT WHERE APPLICABLE MUST REMAIN WITHIN DIMENSIONS			SIZE	THIS DRAWING CONTAINS INFORMATION THAT IS PROPRIETARY TO MOLEX INCORPORATED AND SHOULD NOT BE USED WITHOUT WRITTEN PERMISSION																			