

SPECIFICATIONS

| PARAMETERS | VALUES | UNITS |
|-------------------------|---------------------------------|-------------|
| RATED VOLTAGE | 12 | Vdc |
| OPERATING VOLTAGE RANGE | 3 ~ 28 | Vdc |
| RATED CURRENT (MAX) | 18 | mA |
| MINIMUM SPL @ 10 CM | 87 | dBA |
| RESONANT FREQUENCY | 1,800 ± 500 | Hz |
| TONE OR PULSE RATE | CONTINUOUS | 0 pulse/sec |
| OPERATING TEMPERATURE | -30 ~ +80 | °C |
| STORAGE TEMPERATURE | -40 ~ +80 | °C |
| HOUSING MATERIAL | ABS | - |
| TERMINAL MATERIAL | Sn PLATED PHOSPHER BRONZE | - |
| WEIGHT | 5.8 | grams |

THIS DOCUMENT CONTAINS DATA PROPRIETARY TO PROJECTS UNLIMITED, INC. ANY USE OR REPRODUCTION, IN ANY FORM, WITHOUT PRIOR WRITTEN PERMISSION OF PROJECTS UNLIMITED, INC. IS PROHIBITED.
©2003, Projects Unlimited Inc.

REVISION HISTORY

| LTR | DESCRIPTION | DATE | APPROVED |
|-----|--|-----------|----------|
| - | RELEASED FROM ENGINEERING | 9/23/2005 | |
| A | REVISED MAX. CURRENT | 5/6/2009 | B.R. |
| B | ADDED NOTE NUMBER 4 | 11/9/2009 | B.R. |
| C | REVISED TO INVENTOR 3-D DRAWING TEMPLATE | 2/8/2010 | B.R. |
| D | ADDED DATE CODE | 9/7/2016 | B.R. |
| E | REVISED WEIGHT | 2/24/2020 | M.V. |

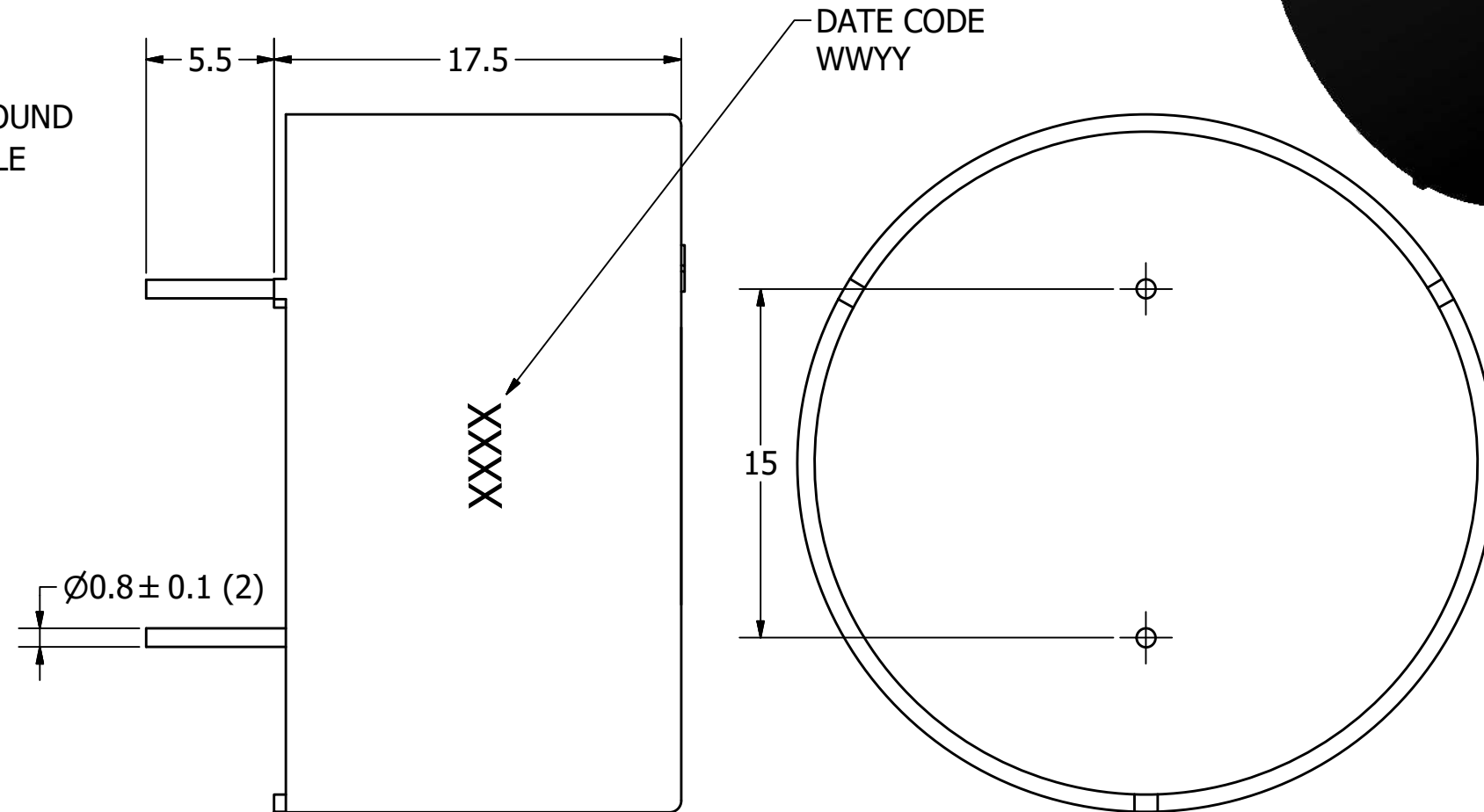
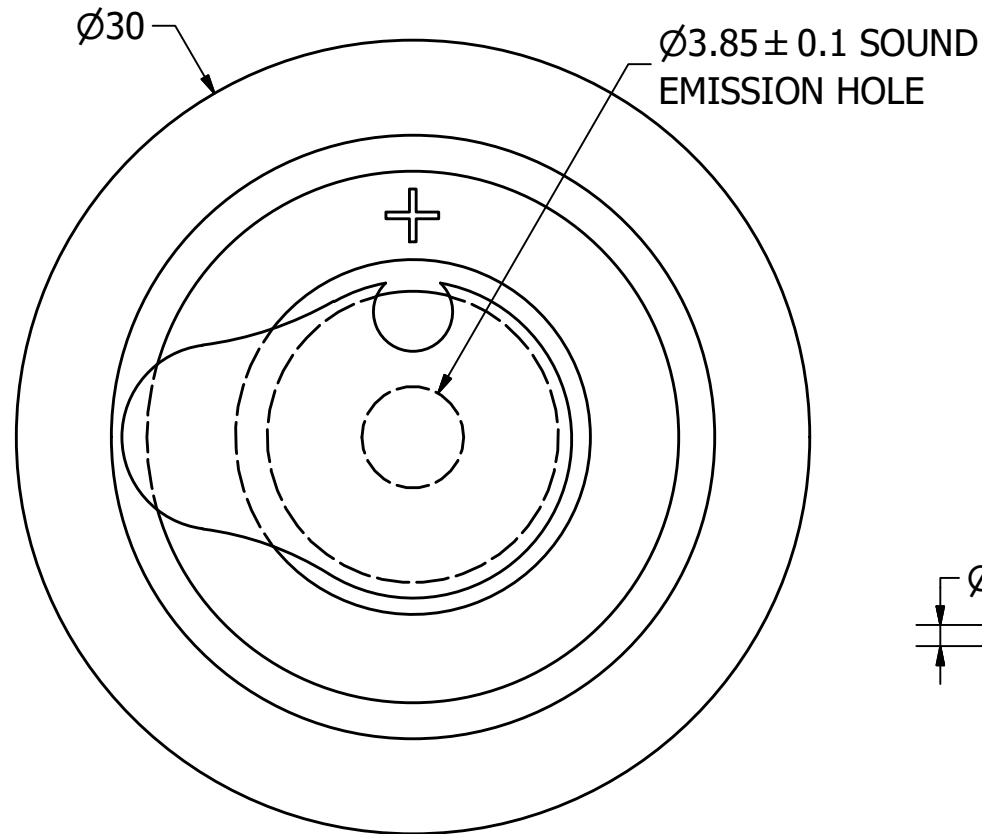

NOTES:

1. ALL DIMENSIONS ARE IN MILLIMETERS.
2. SPECIFICATIONS SUBJECT TO CHANGE OR WITHDRAWL WITHOUT NOTICE.
3. THIS PART IS RoHS 2011/65/EU COMPLIANT.
4. HAND SOLDER ONLY; IRON TEMP 350c AND SOLDER TIME 3 SECONDS OR LESS. WAVE SOLDERING NOT ALLOWED. MINIMUM INSULATION RESISTANCE BETWEEN FEEDBACK CIRCUIT AND GROUND IS 20M OHMS.

| | | | | | | | | |
|--|-------------------|-------------|-----------|-----------------------------------|-----------|-------------|-----------|------------|
| UNLESS OTHERWISE SPECIFIED: DIMENSIONS ARE IN MILLIMETERS, TOLERANCES ARE ±0.5 AND ANGLES ARE ±3°. | SIZE A3 | Designed by | Date | Checked by | Date | Approved by | Date | Drawn Date |
| | | J.A.F. | 9/23/2005 | E.P. | 9/23/2005 | B.R. | 9/23/2005 | 2/8/2010 |
| AI-3018-TWT-R.idw | | | | AI-3018-TWT-R Indicator | | | | |
| | | | | Edition | | Sheet | | |
| | | | | - | | 1 / 1 | | |