

REVISIONS			
REV	DESCRIPTION, ECN, EAR NO.	DATE	APP'D
A	PRODUCT DRAWING (EAR 15028)	DEC03/21	K.L.

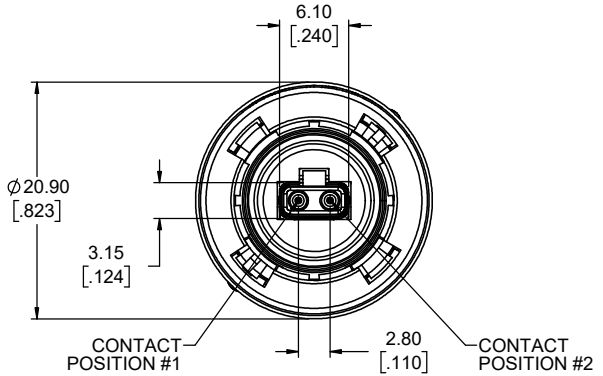

ASSEMBLED PLUG VIEWS
SEE FOLLOWING SHEET FOR COMPONENTS

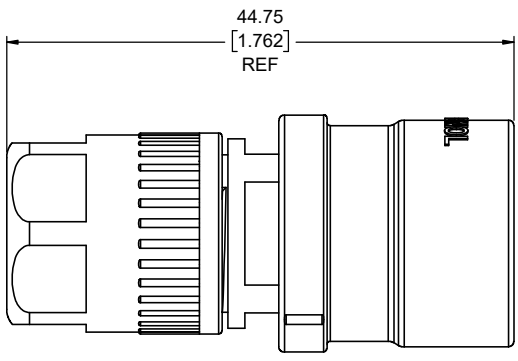

CONTACT POSITION	SIGNAL PER IEC 63171-6
1	BI_DA+
2	BI_DA-

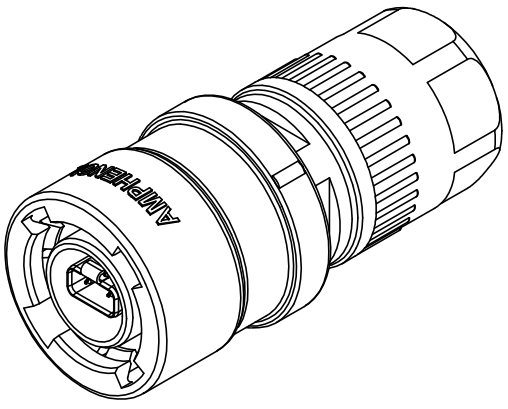

NOTES:

- MATERIALS:** ALL MATERIALS ARE RoHS COMPLIANT PER EU DIRECTIVE 2011/65/EU AND AMENDMENTS.
 - HOUSING, CAP, GLAND, & INSERTS: ENGINEERING THERMOPLASTIC, UL94V-0 FLAMMABILITY RATING, COLOUR: BLACK
 - IDC WIRE GUIDE: POLYCARBONATE, UL94V-0 FLAMMABILITY RATING, COLOUR: YELLOW FOR 24-25 AWG SIZE OR CLEAR FOR 26-28 AWG SIZE IDC
 - EMI SHIELD: STAINLESS STEEL PLATED WITH NICKEL
 - CONTACTS: COPPER ALLOY PLATED WITH NICKEL OVERALL, 0.76µm (30µ") GOLD ON THE MATING AREA AND GOLD FLASH ON THE TAILS
 - O-RING & GROMMET: SILICONE RUBBER, COLOUR: BLACK
 - RETAINING RING & WAVE SPRING: STAINLESS STEEL, PASSIVATED
- DESIGNED IN ACCORDANCE WITH IEC STANDARDS 63171-6 & 61076-2-010. COMPATIBLE WITH:**
 - IEEE 802.3cg, 10BASE-T1L & -T1S
 - IEEE 802.3bw, 100BASE-T1
 - IEEE 802.3bp, 1000BASE-T1
 - IEEE 802.3bu, POWER OVER DATA LINES (PoDL)
- ENVIRONMENTAL CHARACTERISTICS:**
 - OPERATING TEMPERATURE: -40°C TO +85°C
 - IP67 RATED PERFORMANCE PER IEC 60529, IN MATED CONDITION.
- ELECTRICAL CHARACTERISTICS:**
 - CURRENT RATING: 4A
 - VOLTAGE RATING: 60VDC
 - CONTACT RESISTANCE: 20mΩ MAX
 - DIELECTRIC WITHSTANDING VOLTAGE:
 - 1000VDC CONTACT TO CONTACT
 - 2250VDC CONTACT TO SHIELD

ORDERING CODE: M S P E - P 6 P 2 - X X 0

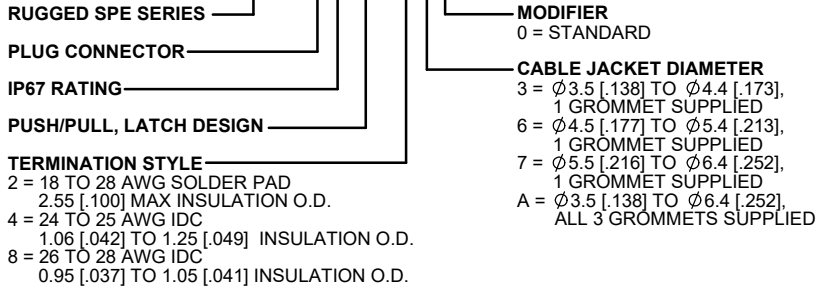

THIS DOCUMENT CONTAINS PROPRIETARY INFORMATION AND SUCH INFORMATION MAY NOT BE DISCLOSED TO OTHERS FOR ANY PURPOSE OR USED FOR MANUFACTURING PURPOSES WITHOUT WRITTEN PERMISSION FROM AMPHENOL CANADA CORP.

UNLESS SPECIFIED OTHERWISE	DRAWN	R.DAMICO	SEPT1/21
PRIMARY UNITS MILLIMETRES	CHECKED	K.LAMBIE	DEC03/21
SECONDARY UNITS INCHES	M.E. APP'D		
REFERENCE IN PARENTHESES	Q.A. APP'D		
GENERAL TOLERANCES	DWG APPR.		
1 DECIMAL PLACE	ENG. REL. NO.	EAR 15028	
2 DECIMAL PLACES	REF.		
3 DECIMAL PLACES	THIRD ANGLE PROJECTION		
ANGULAR DEGREES	DO NOT SCALE DRAWING		

Amphenol Canada Corp.
Commercial Products

MSPE SERIES, SINGLE PAIR ETHERNET, IP67 PLUG, PUSH/PULL, TERMINATION OPTIONS, RoHS COMPLIANT

DWG. NO. **P-MSPE-P6P2-XX0** REV **A**

CODE ID NO. 03554 DWG SIZE: X SCALE: 3:1 SHEET 1 OF 3

IDC TERMINATION

PLUG COMPONENTS SUPPLIED FOR PART NUMBERS MSPE-P6P2-4X0 & MSPE-P6P2-8X0, TRAY & BULK PACKED COMPONENTS SUPPLIED IN EACH CARTON.

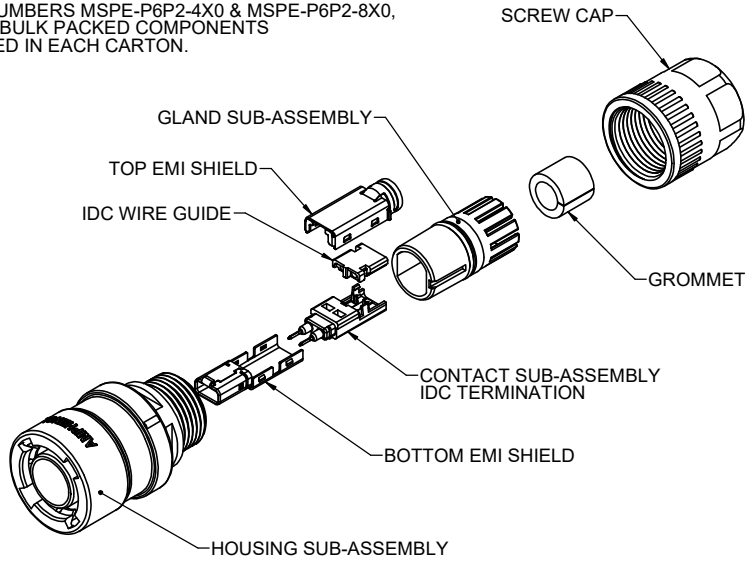

SOLDER PAD TERMINATION

PLUG COMPONENTS SUPPLIED FOR PART NUMBER MSPE-P6P2-2X0, TRAY & BULK PACKED COMPONENTS SUPPLIED IN EACH CARTON.

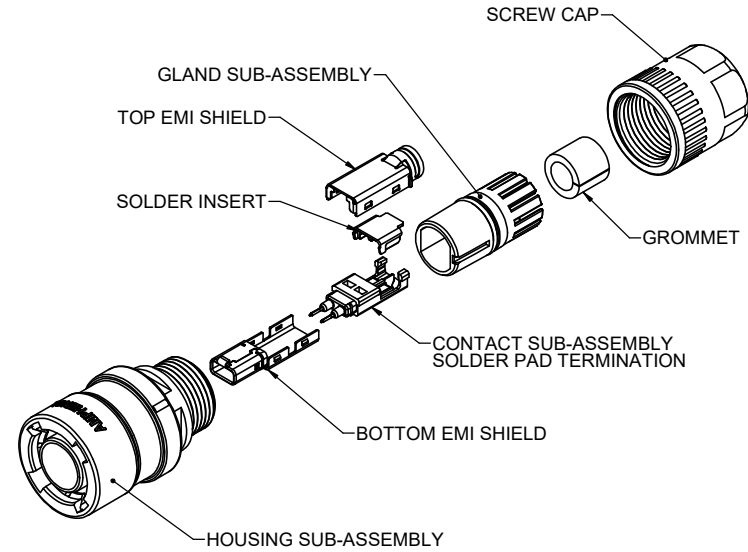

PUSH / PULL FUNCTION

MATING

- ALIGN MATING AREA
- PUSH PLUG TO ENGAGE LATCH TO JACK

UN-MATING

- PULL FRONT PLUG COLLAR BACK APPROXIMATELY 1.2mm (.05") TO DIS-ENGAGE LATCH
- PULL PLUG TO UN-MATE FROM JACK

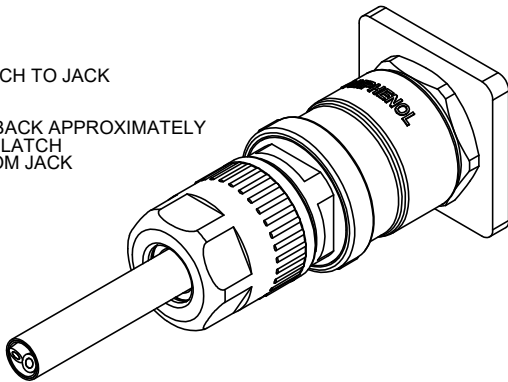

RECOMMENDED CABLE SPECIFICATIONS				
ITEMS		IDC 26 -28 AWG	IDC 24 - 25 AWG	SOLDER PAD
CONDUCTORS	SIZE	26 - 28 AWG	24 - 25 AWG	18 - 28 AWG
	STRANDS	7 STRANDS PER WIRE		
	MATERIAL	ANNEALED COPPER WIRE		
INSULATION OUTSIDE DIAMETER		Ø 0.95 - 1.05mm (Ø .037 - .041")	Ø 1.06 - 1.25mm (Ø .042 - .049")	Ø 2.55mm MAX (Ø .100" MAX)
BRAIDED SHIELD		TINNED COPPER		
JACKET OUTSIDE DIAMETER		Ø 3.50 - 6.40mm (Ø .138 - .252")		

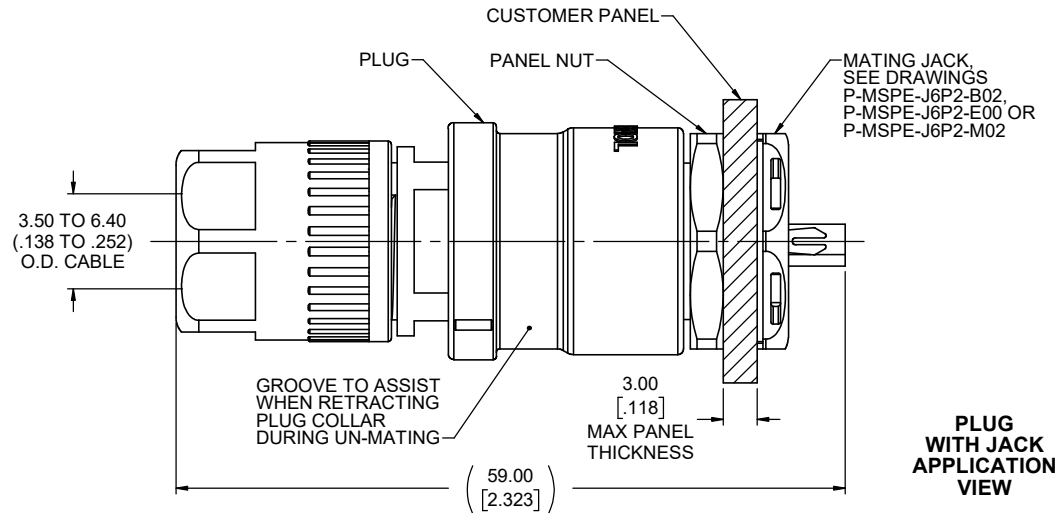

PLUG WITH JACK APPLICATION VIEW

REVISIONS			
REV	DESCRIPTION, ECN, EAR NO.	DATE	APP'D
A	PRODUCT DRAWING (EAR 15028)	DEC03/21	K.L.

THIS DOCUMENT CONTAINS PROPRIETARY INFORMATION AND SUCH INFORMATION MAY NOT BE DISCLOSED TO OTHERS FOR ANY PURPOSE OR USED FOR MANUFACTURING PURPOSES WITHOUT WRITTEN PERMISSION FROM AMPHENOL CANADA CORP.

UNLESS SPECIFIED OTHERWISE	DRAWN	R.DAMICO	SEPT1/21
PRIMARY UNITS MILLIMETRES	CHECKED	K.LAMBIE	DEC03/21
SECONDARY UNITS INCHES	M.E. APP'D		
REFERENCE IN PARENTHESES	Q.A. APP'D		
GENERAL TOLERANCES	DWG APPR.		
1 DECIMAL PLACE	ENG. REL. NO.	EAR 15028	
2 DECIMAL PLACES	REF.		
3 DECIMAL PLACES	THIRD ANGLE PROJECTION		
ANGULAR DEGREES	DO NOT SCALE DRAWING		

Amphenol Canada Corp.
Commercial Products

MSPE SERIES, SINGLE PAIR ETHERNET, IP67 PLUG, PUSH/PULL, TERMINATION OPTIONS, RoHS COMPLIANT

DWG. NO. **P-MSPE-P6P2-XX0** REV **A**

CODE ID NO. 03554 DWG SIZE: X SCALE: NTS SHEET 2 OF 3

REVISIONS			
REV	DESCRIPTION, ECN, EAR NO.	DATE	APP'D
A	PRODUCT DRAWING (EAR 15028)	DEC03/21	K.L.

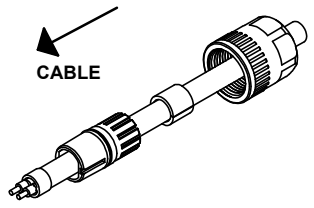

STEP 1
SLIDE THE GLAND SUB-ASSY, GROMMET
AND SCREW CAP ONTO THE BARE CABLE
PRIOR TO PLUG INSTALLATION

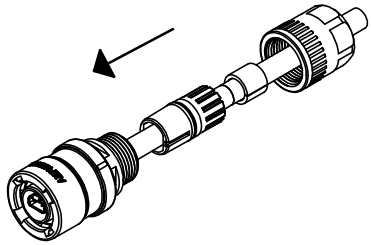

STEP 4
SLIDE THE GLAND SUB-ASSY
INTO THE HOUSING SUB-ASSY

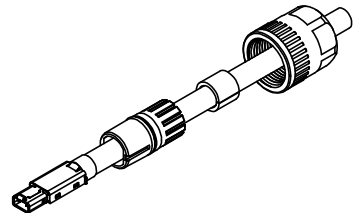

STEP 2
ASSEMBLE PLUG CONNECTOR
TO CABLE

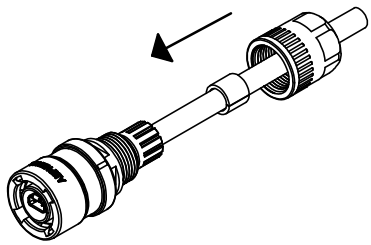

STEP 5
SLIDE THE GROMMET
INTO THE GLAND SUB-ASSY

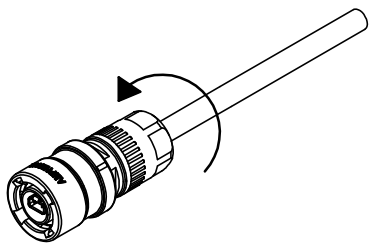

STEP 7
SCREW THE END CAP
UNTIL HAND TIGHT

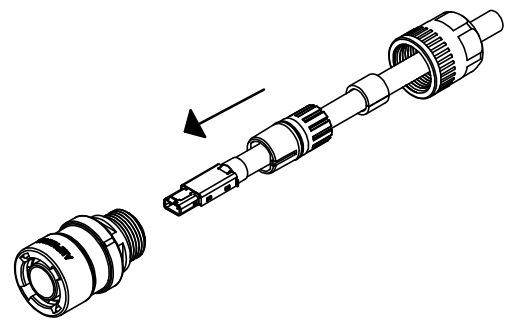

STEP 3
SLIDE THE ASSEMBLED CABLE
INTO THE HOUSING SUB-ASSY

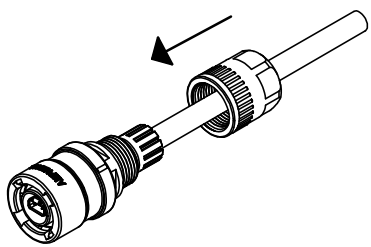

STEP 6
SLIDE THE END CAP
ONTO TO THE HOUSING SUB-ASSY

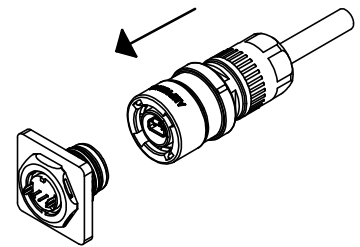

STEP 8
INSERT THE MSPE PUSH PULL
PLUG ASSEMBLY INTO THE JACK HOUSING
(AMPHENOL ENGRAVING INDICATES TOP SIDE)



FIELD ASSEMBLY PROCEDURE

THIS DOCUMENT CONTAINS PROPRIETARY INFORMATION AND SUCH INFORMATION MAY NOT BE DISCLOSED TO OTHERS FOR ANY PURPOSE OR USED FOR MANUFACTURING PURPOSES WITHOUT WRITTEN PERMISSION FROM AMPHENOL CANADA CORP.

UNLESS SPECIFIED OTHERWISE	DRAWN	R.DAMICO	SEPT1/21
PRIMARY UNITS MILLIMETRES	CHECKED	K. LAMBIE	DEC03/21
SECONDARY UNITS INCHES	M.E. APP'D		
REFERENCE IN PARENTHESES	Q.A. APP'D		
GENERAL TOLERANCES	DWG APPR.		
1 DECIMAL PLACE	ENG. REL. NO.	EAR 15028	
2 DECIMAL PLACES	REF.		
3 DECIMAL PLACES	THIRD ANGLE PROJECTION		
ANGULAR DEGREES	DO NOT SCALE DRAWING		

Amphenol Canada Corp. Commercial Products			
MSPE SERIES, SINGLE PAIR ETHERNET, IP67 PLUG, PUSH/PULL, TERMINATION OPTIONS, RoHS COMPLIANT			
DWG. NO.		REV	A
CODE ID NO. 03554	DWG SIZE: X	SCALE: 1:1	SHEET 3 OF 3