

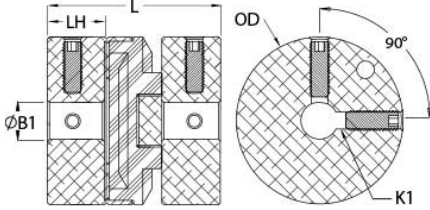

OSC16-6-A

Ruland OSC16-6-A, 3/8" Oldham Coupling Hub, Aluminum, Set Screw Style
With Keyway, 1.000" OD, 0.467" Length



Description

Ruland OSC16-6-A is a set screw oldham coupling hub with a 0.3750" bore, 3/32" keyway, 1.000" OD, and 0.390" length. It is a component of a three-piece design consisting of two anodized aluminum hubs press fit onto a center disk. This three-piece design allows for a highly customizable coupling that easily combines clamp or set screw hubs with inch, metric, keyed, and keyless bores. Disks are available in three materials allowing the user to tailor coupling performance to their application. OSC16-6-A can accommodate all forms of misalignment and is especially useful in applications with high parallel misalignment (up to 10% of the OD). It operates with low bearing loads protecting sensitive system components such as bearings and has a balanced design for reduced vibration at speeds up to 6,000 RPM. Hardware is metric and tests beyond DIN 912 12.9 standards for maximum torque capabilities. OSC16-6-A is machined from bar stock that is sourced exclusively from North American mills and is RoHS3 and REACH compliant. It is manufactured in our Marlborough, MA factory under strict controls using proprietary processes.

Product Specifications

Bore (B1)	0.3750 in	Keyway (K)	3/32 in
Outer Diameter (OD)	1.000 in (25.4 mm)	B1 Max Shaft Penetration	9.9 mm
Bore Tolerance	+0.001 in / -0.000 in	Hub Width (LH)	9.91 mm
Length (L)	1.250 in (31.8 mm)	Recommended Shaft Tolerance	+0.0000 in / -0.0005 in
Forged Set Screw	M4	Number of Screws	2 ea 90° apart
Screw Material	Alloy Steel	Screw Finish	Black Oxide
Seating Torque	2.2 Nm	Hex Wrench Size	2.0 mm
Torque Specifications	Torque ratings vary with insert selection	Angular Misalignment	0.5°
Parallel Misalignment	0.008 in (0.20 mm)	Max Parallel Misalignment	0.100 in (2.54 mm)
Axial Motion	0.004 in (0.10 mm)	Moment of Inertia	0.0041 lb-in ²
Maximum Speed	4,500 RPM	Recommended Inserts	OD16/25-AT , OD16/25-NL , OD16/25-PEK
Full Bearing Support Required?	Yes	Zero-Backlash?	Yes
Balanced Design	Yes	Mechanical Fuse?	Yes
UPC	634529118733	Country of Origin	USA
Material Specification	2024-T351 Aluminum Bar	Finish	Black Anodized
Finish Specification	Sulfuric Anodized MIL-A-8625 Type II, Class 2 and ASTM B580 Type B Black Anodize	Manufacturer	Ruland Manufacturing
Temperature	Acetal Disk -10°F to 150°F (-23°C to 65°) Nylon Disk -10°F to 130°F (-23°C to 54°C) PEEK Disk -10°F to 300°F (-23°C to 148°C)	Weight (lbs)	0.028700
Tariff Code	8483.60.8000	UNSPC	31163015
Note 1	"Now available in stainless steel!"		
Note 2	"Performance ratings are for guidance only. The user must determine suitability for a particular application."		
Note 3	"Torque ratings for the couplings are based on the physical limitations/failure point of the torque disks. Under normal/typical conditions the hubs are capable of holding up to the rated torque of the disks. Please consult technical support for more assistance."		

Installation Instructions

1. Align the bores of the OSC16-6-A oldham coupling hubs on the shafts that are to be joined and determine if the misalignment parameters are within the limits of the coupling. (*Angular Misalignment: 0.5° Parallel Misalignment: 0.008 in (0.20 mm), Axial Motion: 0.004 in (0.10 mm)*)
 2. Rotate the hubs on the shaft so the drive tenons are located 90° from each other.
 3. Place a torque disk so one groove fits over the drive tenons of a hub and center the disk by hand.
 4. Insert a shim with the thickness of the coupling's axial motion rating into the groove of the torque disk.
 5. Slide the tenons of the second hub into the mating groove in the disk until it touches the shim stock.
 6. Fully tighten the M4 screw(s) on each hub to the recommended seating torque of 2.2 Nm using a 2.0 mm hex torque wrench.
 7. Remove the shim stock to leave a small gap between the top of the drive tenons and the torque disk to allow for axial movement.
-