

1	2	3	4	5	6	7	8
PRODUCT NUMBER	TAIL PLATING OPTION, SEE NOTE 2	IXI EXTERNAL ASSEMBLY WITH WINDOW	IXI HEAT SINK MOUNTING CLIP	HEAT SINK			
10112629-101	OPTION 1	10112626-103	10112656-003LF	10112655-001LF			
10112629-101LF	OPTION 2	10112626-103LF					

NOTES:

- MATERIALS:
CONNECTOR HOUSING: HIGH TEMPERATURE THERMOPLASTIC
GLASS FILLED, UL 94V-0
EMI CAGE: NICKEL SILVER ALLOY
EMI FINGERS: COPPER ALLOY
TERMINALS: COPPER ALLOY
HEAT SINK CLIP: STAINLESS STEEL
HEAT SINK: ALUMINIUM ALLOY
- FINISHES:
EMI FINGERS: 0.50um MIN NICKEL
CONTACT AREA: 0.76um MIN GOLD OVER 2.54um MIN NICKEL TAIL AREA:
OPTION 1: 0.76um - 1.52um TIN/LEAD (90/10) OVER 2.54um MIN NICKEL
OPTION 2: 0.76um - 1.52um TIN (LEAD FREE) OVER 2.54um MIN NICKEL
- PRODUCT SPECIFICATION: GS-12-651.
- PRODUCT PACKING SPECIFICATION: GS-14-1490.
EXTERNAL ASSEMBLY WITH WINDOWS WILL BE IN ONE BOX.
HEAT SINK AND HEAT SINK MOUNTING CLIP WILL BE IN EACH ONE BOX.
TOTAL THREE BOXES WILL BE IN A MASTER CARTON.
- APPLICATION SPECIFICATION: GS-20-0327.
- MOUNTING HARDWARE: M2X0.4 BUTTON HEAD SCREW
MOUNTING SCREW LENGTH: BOARD THICKNESS + 1.4mm MAX (0.9mm MIN).
1 REQUIRED PER ASSEMBLY.
MOUNTING HARDWARE NOT SUPPLIED.
- THIS CONNECTOR IS DESIGNED TO MEET THE REQUIREMENTS OF INDUSTRY SPECIFICATION SFF-8644.
- HEAT SINK AND HEAT SINK MOUNTING CLIP FINAL ASSEMBLY AFTER EXTERNAL ASSEMBLY WITH WINDOW APPLIED TO PCB.

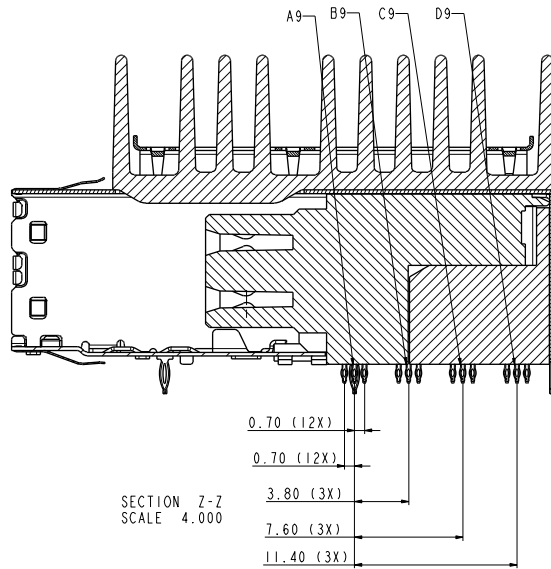
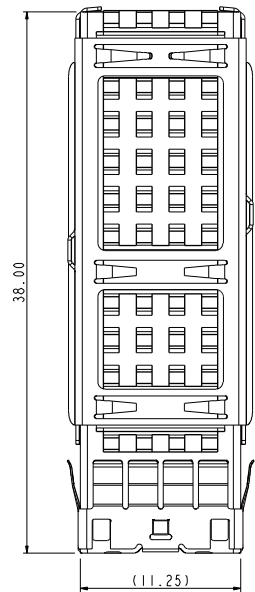

MATES WITH MINI-SAS HD ENDS IN:
10112041 SERIES (4X)
10117771 SERIES (4X)
10117946 SERIES (4X)
10117949 SERIES (4X)

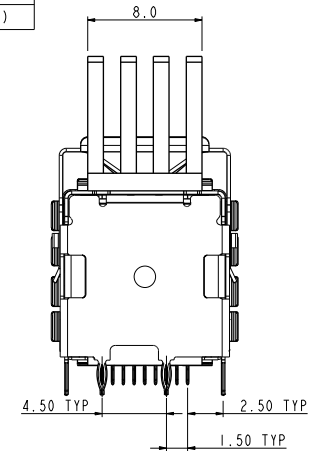
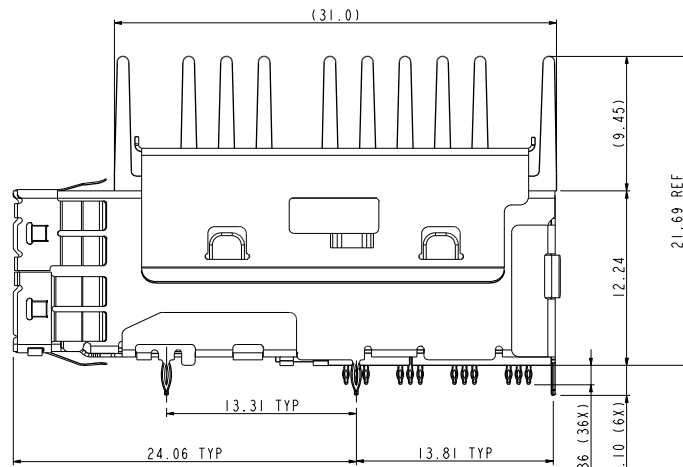
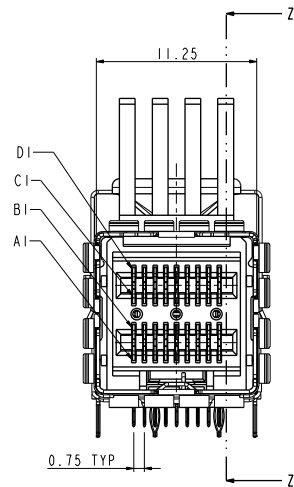

Copyright FCI

spec ref	-	dr	Benny Chen	2012-05-07	projection	MM	size	A2	scale	4.000
tolerance std	ISO 406 ISO 1101	eng	De-Feng Qin	2013-03-01			ecn no	rel level		
TOLERANCES UNLESS OTHERWISE SPECIFIED		chr	Jon Qin	2013-03-01					product family	MINI-SAS HD
surface	linear	0.X	±0.50		title Ixi EXTERNAL ASSEMBLY WITH HEAT SINK MINI-SAS HD	dwg no 10112629	rev A			
		0.XX	±0.30							
	angular	0°	±3°							
ISO 1302				www.fcicom	cat. no.	-	Product - Customer Drw	sheet 1 of 6		

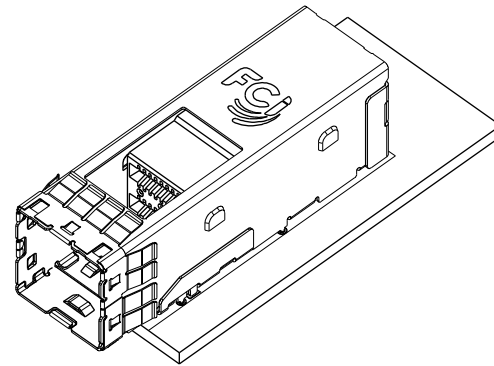

EXTERNAL ASSEMBLY WITH WINDOW APPLIED TO PCB
10112626-103 & 103LF

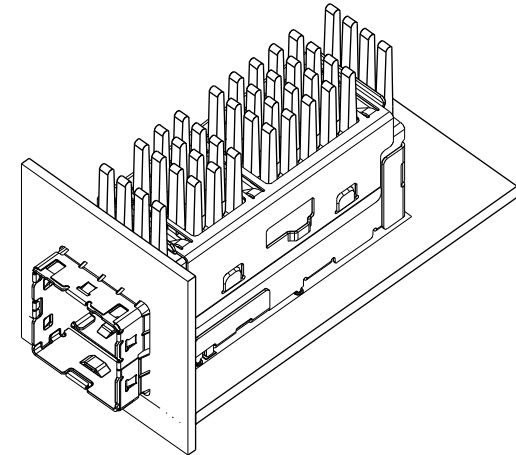

10112629-101 & 101LF
WITH HEAT SINK
(HEAT SINK AND HEAT SINK MOUNTING CLIP FINAL ASSEMBLY BY CUSTOMER)

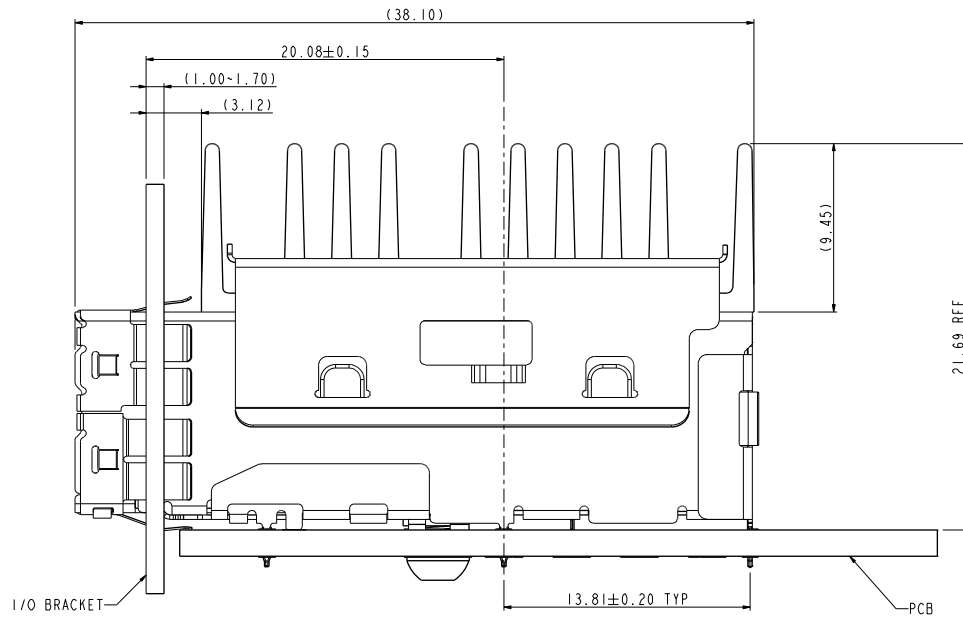

SCALE 5.000

ASSEMBLED VIEW WITH HEAT SINK

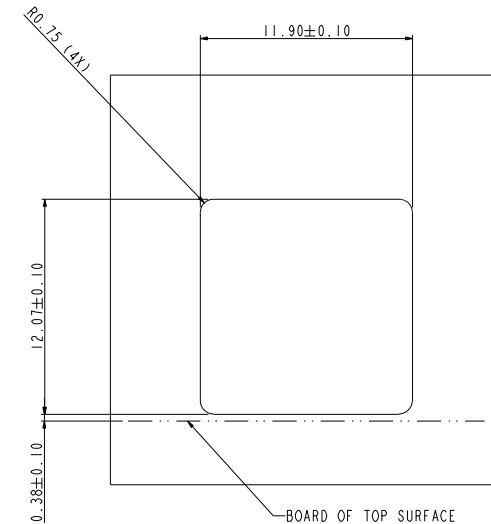

SCALE 5.000

I/O BRACKET CUT OUT (BRACKET NOT SUPPLIED)



Copyright FCI.

spec ref	-	dr	Benny Chen	2012-05-07	projection	MM	size	A2	scale	1.000
tolerance std	ISO 406 ISO 1101	TOLERANCES UNLESS OTHERWISE SPECIFIED		eng	De-Feng Qin	2013-03-01	ecn no			
surface	✓	linear	0.X ±0.50 0.XX ±0.30 0.XXX ±-	chr	Jon Qin	2013-03-01	product family	MINI-SAS HD	rel level	
ISO 1302		angular	0° ±3°	appr	Pei-Ming Zheng	2013-03-01	title	10112629	rev	A
							www.fci.com	cat. no.	Product - Customer Drw	sheet 2 of 6

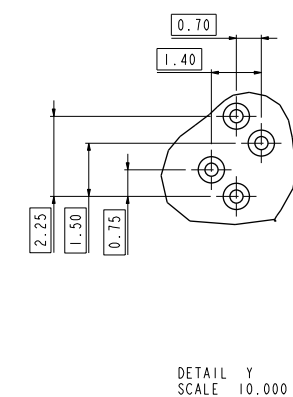
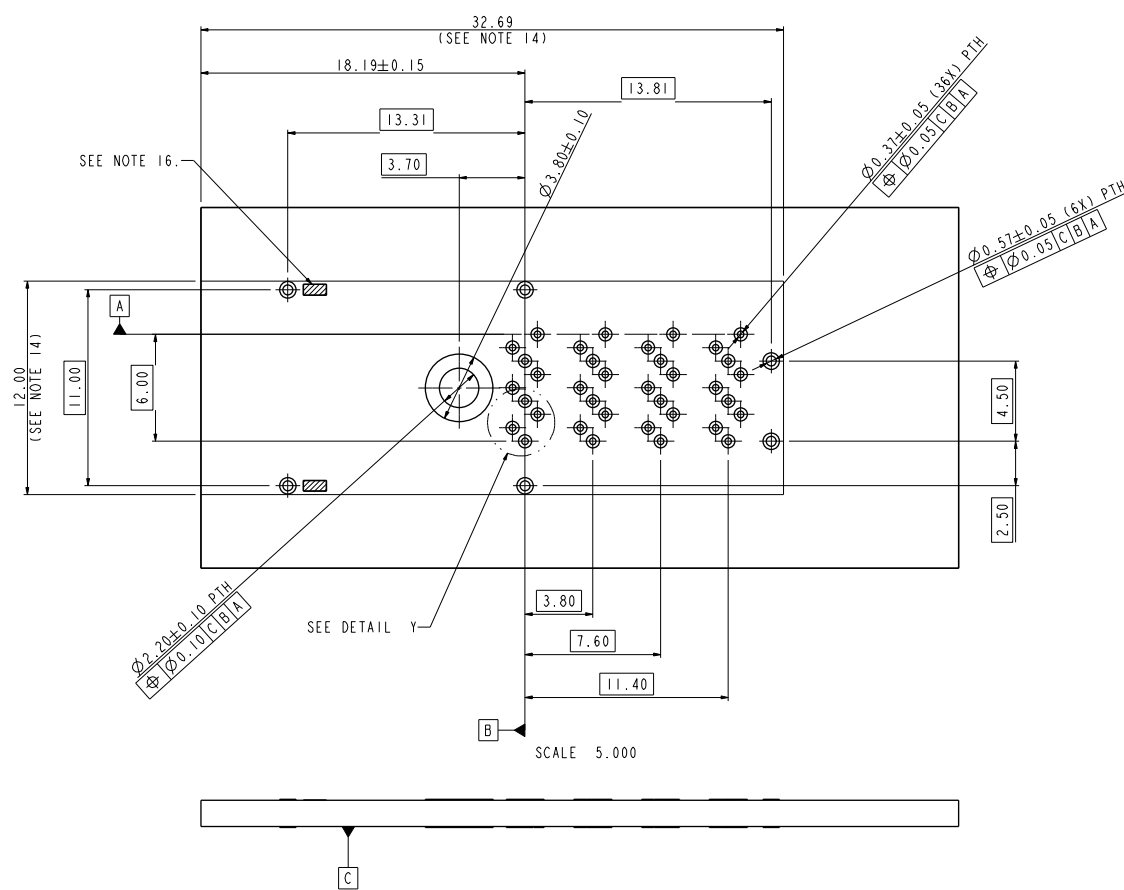

RECOMMENDED BOARD LAYOUT
SEE SFF-8644 FOR DETAIL

NOTES:

- 9. RECOMMENDED DRILL SIZE FOR Ø0.37 FINISHED PTH IS Ø0.457.
- 10. RECOMMENDED ANNULAR RING AROUND Ø0.37 FINISHED PTH IS Ø0.73.
- 11. RECOMMENDED DRILL SIZE FOR Ø0.57 FINISHED PTH IS Ø0.68.
- 12. RECOMMENDED ANNULAR RING AROUND Ø0.57 FINISHED PTH IS Ø0.93.
- 13. MINIMUM RECOMMENDED CENTER TO CENTER SPACING BETWEEN ADJACENT CONNECTORS: 14.00mm.
- 14. CONNECTOR KEEP OUT AREA.
- 15. MINIMUM PCB THICKNESS: 1.57mm.
- 16. CAGE STAND OFF AREA, NO TRACES ON SURFACE OF PCB IN THE AREAS.

spec ref	-	dr	Benny Chen	2012-05-07	projection	MM	size	A2	scale	1.000
tolerance std	ISO 406 ISO 1101	eng	De-Feng Qin	2013-03-01			ecn no	-	rel level	-
TOLERANCES UNLESS OTHERWISE SPECIFIED		chr	Jon Qin	2013-03-01						
surface	linear	0.X	±0.50		title Ix1 EXTERNAL ASSEMBLY WITH HEAT SINK MINI-SAS HD	cat. no. -	Product - Customer Drw	sheet 3 of 6	rev A	
	0.XX	±0.30								
	0.XXX	±-								
	angular	0°	±3°							

Copyright FCI

RECOMMENDED KEEP OUT AREAS

RECOMMENDED INSERTION TOOL
KEEP OUT AREA
NO COMPONENTS IN THIS AREA
MORE THAN 7.50mm TALL

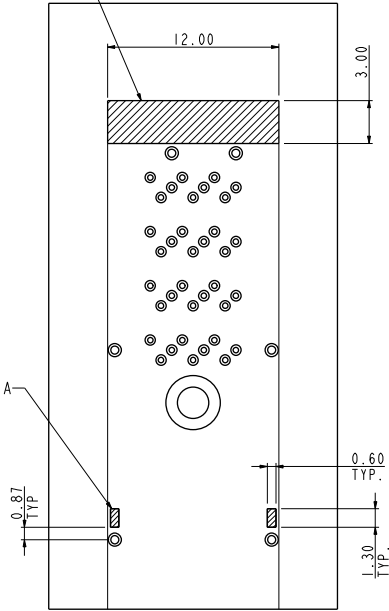

SCALE 4.000

CAGE STAND OFF KEEP OUT AREA

RECOMMENDED EXTRACTION TOOL
KEEP OUT AREA
NO COMPONENTS IN THESE AREAS

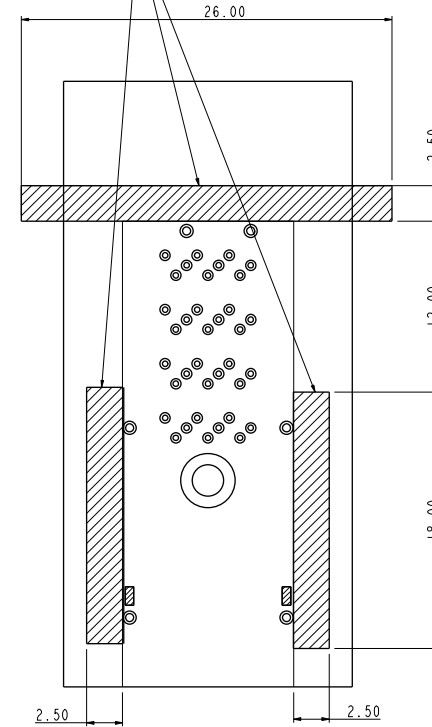

SCALE 4.000

Copyright FCI.
FCI

spec ref	-	dr	Benny Chen	2012-05-07	projection	MM	size	A2	scale	1.000	
tolerance std	ISO 406 ISO 1101	eng	De-Feng Qin	2013-03-01			ecn no	rel level	TOLERANCES UNLESS OTHERWISE SPECIFIED		
surface	linear 0.X ±0.50 0.XX ±0.30 0.XXX ±- ISO 1302 angular 0° ±3°	chr Jon Qin 2013-03-01 appr Pei-Ming Zheng 2013-03-01	product family MINI-SAS HD	cat. no. www.fci.com					title Ix1 EXTERNAL ASSEMBLY WITH HEAT SINK MINI-SAS HD	rev A	
Product - Customer Drw							10112629	sheet 4 of 6			

PIN OUT DESIGNATIONS

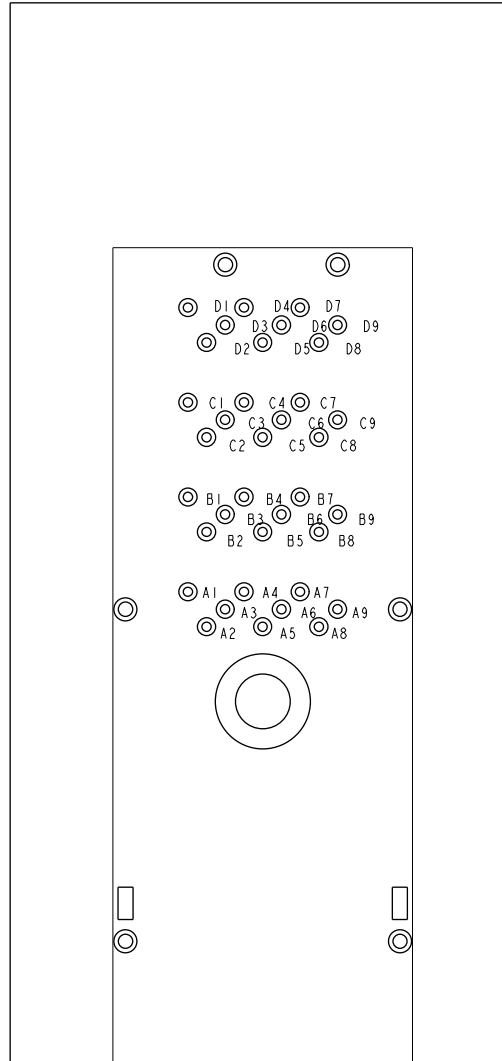

SCALE 7.000



Copyright FCI.

spec ref	-	dr	Benny Chen	2012-05-07	projection	MM	size	A2	scale	1.000
tolerance std	ISO 406 ISO 1101	eng	De-Feng Qin	2013-03-01	chr	Jon Qin	2013-03-01	ecm no	-	
	TOLERANCES UNLESS OTHERWISE SPECIFIED	appr	Pei-Ming Zheng	2013-03-01	product family	MINI-SAS HD	rel level	-		
surface	linear	0.X	±0.50		1x1 EXTERNAL ASSEMBLY WITH HEAT SINK		10112629	A	rev	A
		0.XX	±0.30		MINI-SAS HD					
		0.XXX	±-							
ISO 1302	angular	0°	±3°	www.fcj.com	cat. no.	-	Product - Customer Drw	sheet 5 of 6		

A

B

C

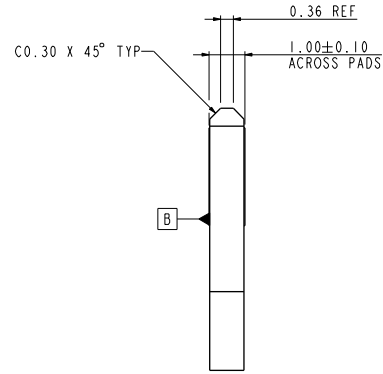
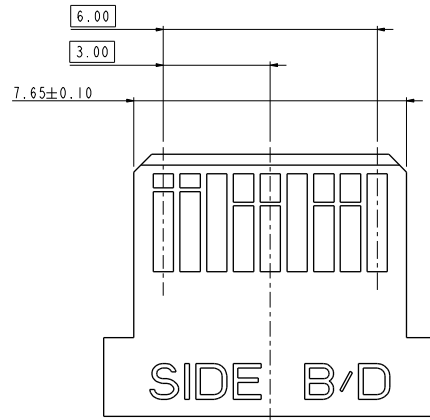

D

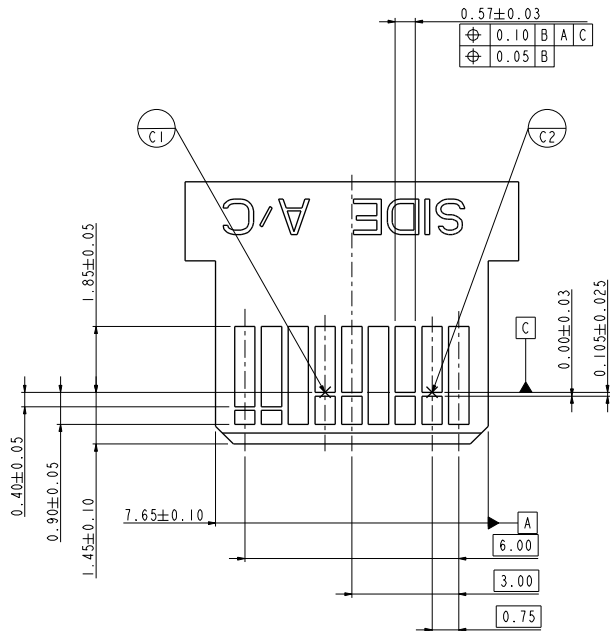

RECOMMENDED PLUG PADDLE CARD
SEE SFF-8644 FOR DETAIL



Copyright FCI.

NOTES:

- 17. 0.05 MINIMUM KEEP OUT FOR SOLDER MASK AROUND ALL PADS.
- 18. DATUM C TARGETS ARE DEFINED BY THE RESPECTIVE PAD CENTER LINES AND THE LEADING EDGE OF THE TARGET PADS.

spec ref	-	dr	Benny Chen	2012-05-07	projection	MM	size	A2	scale	1.000		
tolerance std	ISO 406 ISO 1101	eng	De-Feng Qin	2013-03-01			ecn no	-				
TOLERANCES UNLESS OTHERWISE SPECIFIED		chr	Jon Qin	2013-03-01			product family	MINI-SAS HD	rel level	-		
surface	linear	0.X	±0.50		title Ixl EXTERNAL ASSEMBLY WITH HEAT SINK		cat. no. 10112629	rev A				
		0.XX	±0.30		MINI-SAS HD							
	angular	0°	±3°		www.fci.com							
ISO 1302									Product - Customer Drw	sheet 6 of 6		

F