

DO NOT SCALE
DIMENSIONS IN mm

METRIC

THIRD ANGLE
PROJECTION

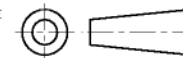

LTR.	REVISION RECORD	DR.	CHK.	DATE
C3	REVISED PER ECR-21-100855	AA	BH	14APR2021

TRADEMARK

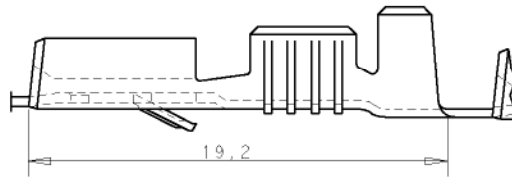
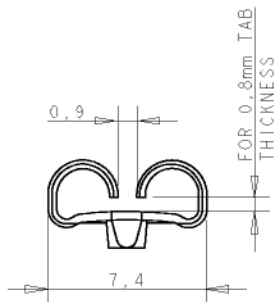
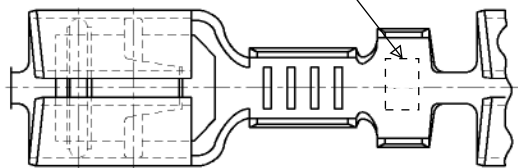

- 1 FOR USE ON MINIATURE APPLICATORS (LEFT-RIGHT FEED) AND STANDARD APPLICATORS (RIGHT-LEFT FEED).
- 2. REELED WITH PAPER AND PAPER COVER.
- 3 **OBsolete PARTS: OBSOLETE CIS STREAMLINING PER D.RENAUD/D.SINISI**

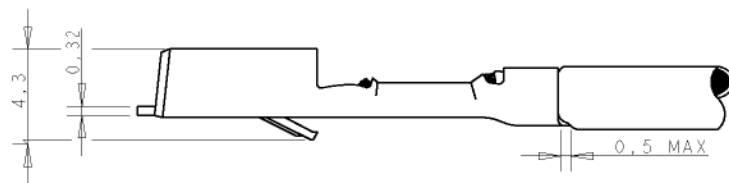
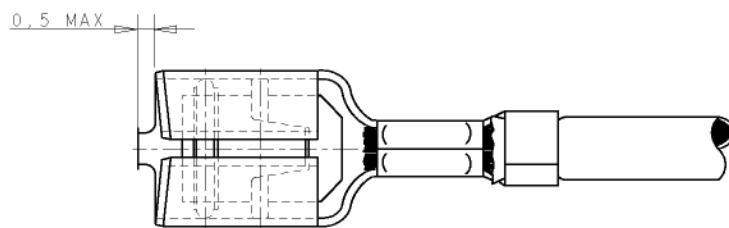

GENERAL TOLERANCES ± 0.3

3	OBsolete	NOTES	FINISH	MATERIAL	PARTNUMBER
			PRE-TINPLATED	PH.BRONZE	6 160927-6
			PRE-TINPLATED	BRASS	6 160927-7
			TINPLATED	PH.BRONZE	160927-4
			UNPLATED	PH.BRONZE	160927-3
			TINPLATED	BRASS	160927-2
			UNPLATED	BRASS	160927-1

CUSTOMER DRAWING

FOR REFERENCE ONLY
WILL NOT BE UPDATED

STE TE Connectivity

THIS DRAWING IS UNPUBLISHED RELEASED FOR PUBLICATION Jan .1988

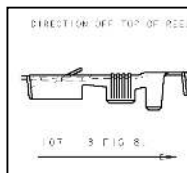

DR.	DATE	WIRE RANGE	NAME	REV. DATE	
R.v.Lokven	26.01.88	>1,0-2,5 mm ²	.250 SRS FASTIN-ON RECEPTACLE.	D M Y	
CHK. A.B.	02.02.88	INSUL. RANGE 2,1-3,1 DIA		14 4 21	
APP. L.v.Soest	03.02.88	SIZE A3	SHEET 1 OF 1	DWG. No. 160927	REV. LTR. C3

8 | 7 | 6 | 5 | 4 | 3 | 2 | 1