

# Customer Information Sheet

DRAWING No.: S447-XX

SHEET 3 OF 3

IF IN DOUBT - ASK

©

NOT TO SCALE

THIRD ANGLE PROJECTION

ALL DIMENSIONS IN mm

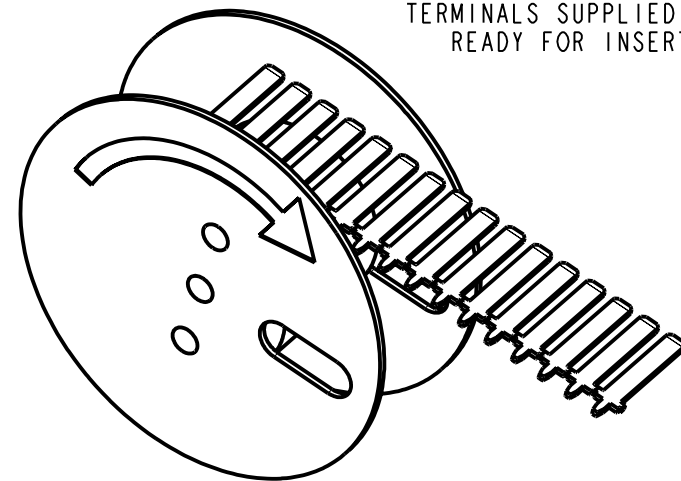
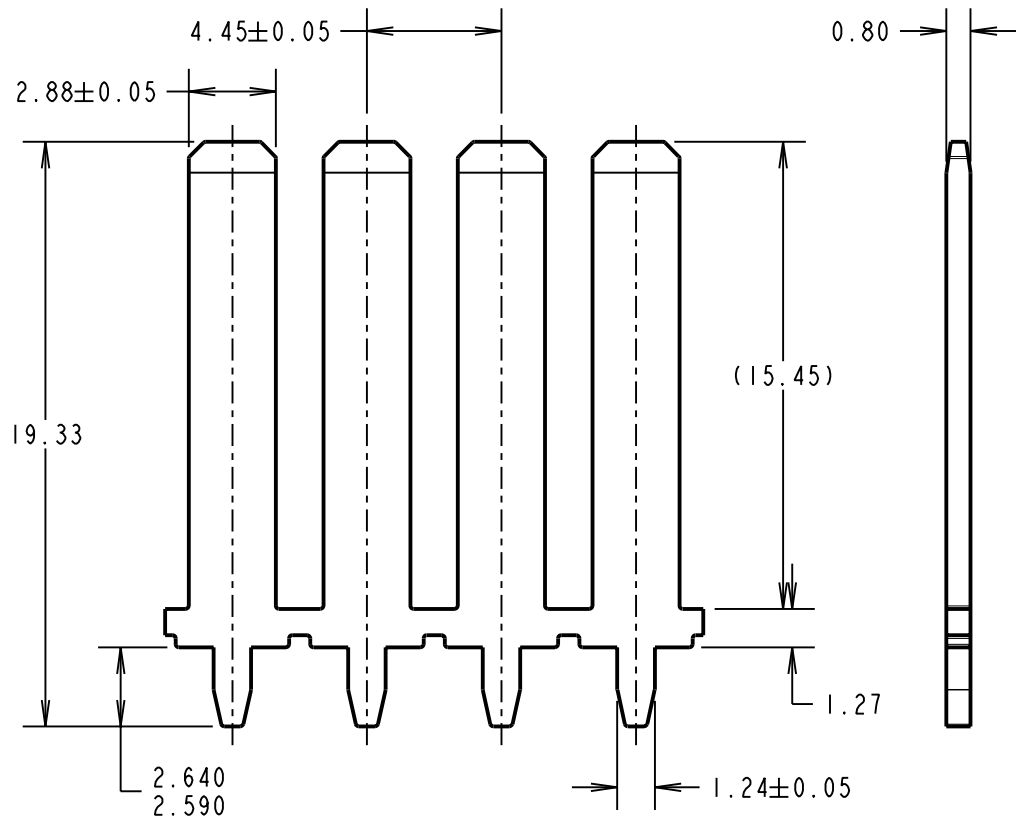

- NOTES:
1. QUANTITY PER REEL = 15,000.  
REEL WEIGHT = 5.25kg.
  2. RECOMMENDED PCB THICKNESS = 1.2mm.
  3. RECOMMENDED PCB HOLE SIZE =  $\varnothing 1.27 \pm 0.05$ mm.

ORDER CODE:  
**S447-XX**

FINISH \_\_\_\_\_

~~06 - 4 $\mu$  90/10 TIN/LEAD~~  
46 - 4 $\mu$  100% TIN

SB	3	23.03.11	10770
NAME	ISS.	DATE	C/NOTE
APPROVED:		S.BENNETT	
CHECKED:		MARK G PLESTED	
DRAWN:		W. J. BOURNE	
CUSTOMER REF.:			
ASSEMBLY DRG:			

**HARWIN**

THIS DRAWING AND ANY INFORMATION OR DESCRIPTIVE MATTER SET OUT HEREON ARE CONFIDENTIAL AND COPYRIGHT PROPERTY OF THE HARWIN GROUP AND MUST NOT BE DISCLOSED, LOANED, COPIED OR USED FOR MANUFACTURING, TENDERING OR FOR ANY OTHER PURPOSE WITHOUT THEIR WRITTEN PERMISSION.

TOLERANCES

X. =  $\pm 1$ mm  
X.X =  $\pm 0.25$ mm  
X.XX =  $\pm 0.10$ mm  
X.XXX =  $\pm 0.01$ mm

ANGLES =  $\pm 5^\circ$

UNLESS STATED

MATERIAL:

BRASS CW505L H095 TO  
BS EN 1652  
(CuZn30 1/2 HARD)

FINISH: SEE ORDER CODE

S/AREA: mm<sup>2</sup>

TITLE:

2.88mm BLADE VERTICAL  
TERMINAL (REELED)

DRAWING NUMBER:

**S447-XX**

SHT  
3  
OF 3

HARWIN USA  
TEL: 603 893 5376  
FAX: 603 893 5396  
mis@harwin.com

HARWIN Europe (UK)  
TEL: 023 9231 4545  
FAX: 023 9231 4590  
mis@harwin.co.uk

HARWIN Asia  
TEL: +65 6 779 4909  
FAX: +65 6 779 3868  
mis@harwin.com.sg