

PRODUCT NO
10046971-040LF

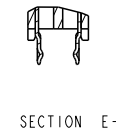

NOTE:
 1. Material:
 HOUSING: HIGH TEMPERATURE THERMOPLASTIC,
 UL 94 V-0 FLAME RETARDANT.
 TERMINAL: HIGH CONDUCTIVITY COPPER ALLOY.
 PLATING SPEC AS BELOW:
 Ni 50u" UNDER PLATED.
 Au 30u" OVER CONTACT AREA.(ONE SIDE)
 Matte Tin 120u" OVER SOLDERING AREA.
 2. PACKING SPEC: GS-14-937
 3. PRODUCT SPEC: GS-12-338.

spec ref	*	dr	Wei-Long Zhang	2012/03/01	projection	MM	size	A4	scale	1.000
tolerance std	TOLERANCES UNLESS OTHERWISE SPECIFIED	eng	Peter Hu	2012/03/19			ecn no	-		
		chr	-	-				rel level	Released	
surface	✓	appr	-	-	product family	rev	A			
linear	0.X	±0.50		title	VERT 35X2	dwg no	10046971-040			
	0.XX	±0.25								
	0.XXX	±0.13								
angular	0°	± 2°	www.fci.com	cat. no.	*	Product - Customer Drw	sheet 1 of 2			

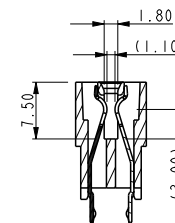
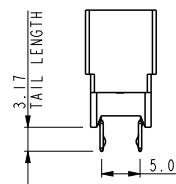
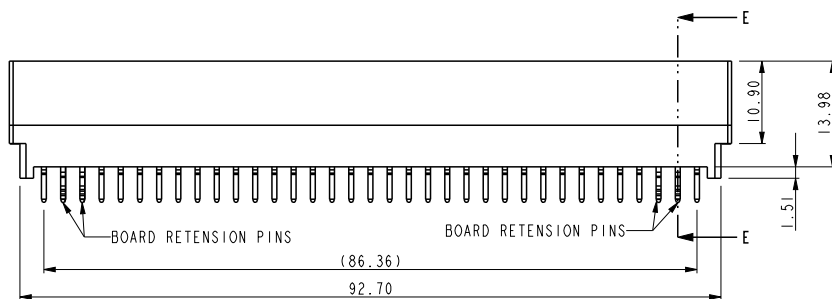
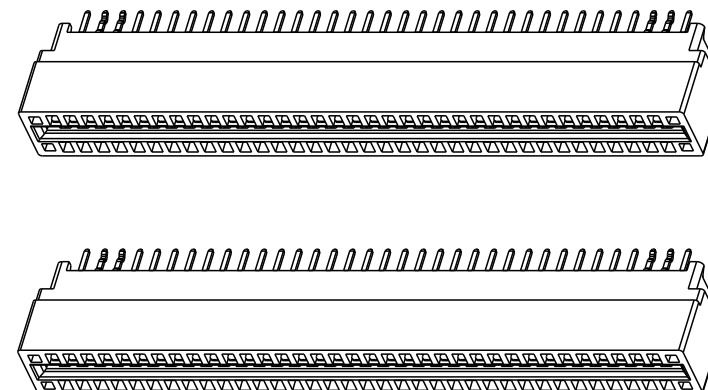
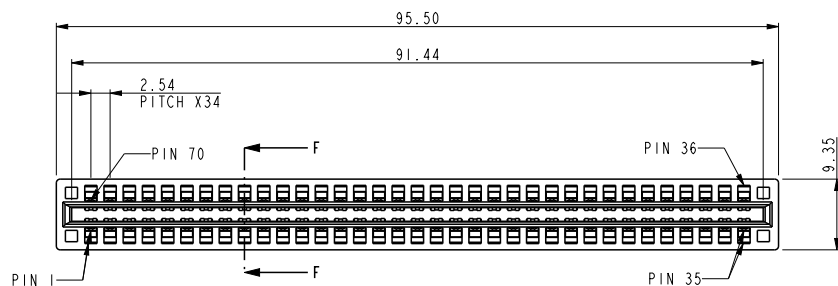

Copyright FCI.



Copyright FCI.

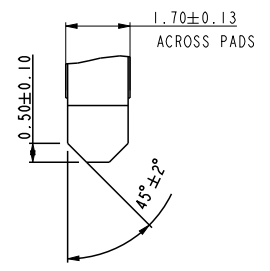
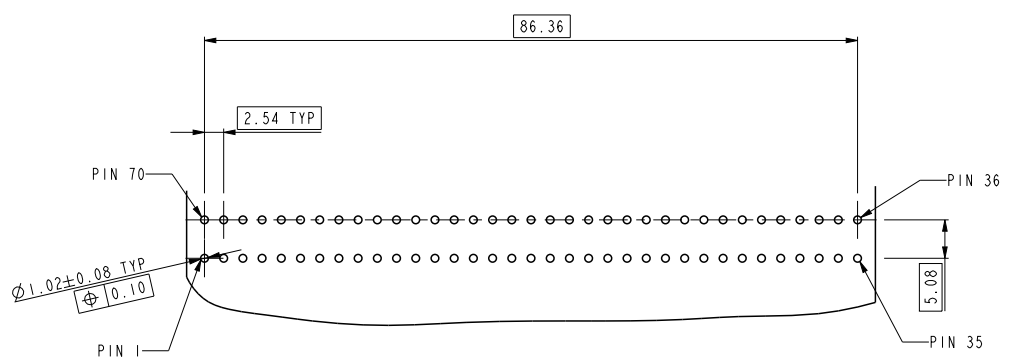
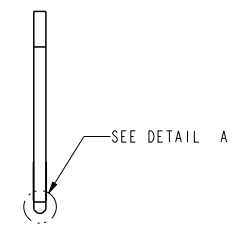
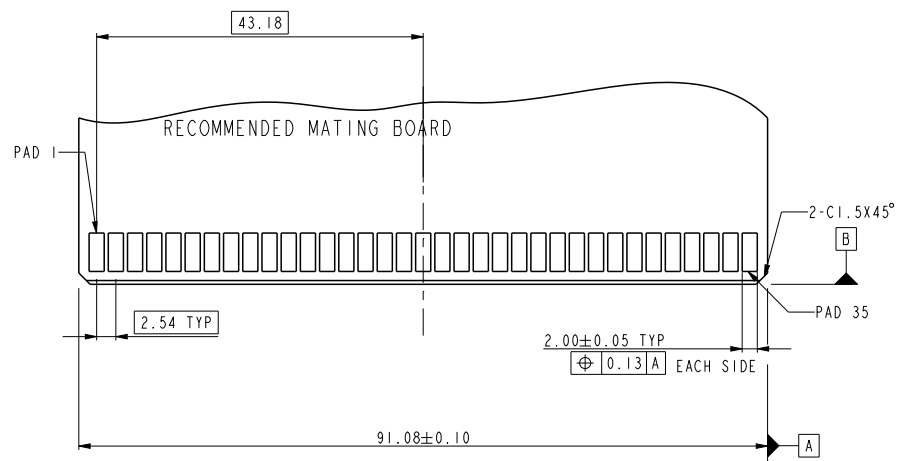

DETAIL A
SCALE 5.000

RECOMMENDED PC BOARD LAYOUT
AND THE THICKNESS IS 2.36mm

spec ref	*	dr	Wei-Long Zhang	2012/03/01	projection	MM	size	A4	scale	1.000											
tolerance std	TOLERANCES UNLESS OTHERWISE SPECIFIED	eng	Peter Hu	2012/03/19			ecn no	-	rel level Released												
		chr	-	-			product family														
surface	<table border="1"> <tr> <td>linear</td> <td>0.X</td> <td>±0.50</td> </tr> <tr> <td></td> <td>0.XX</td> <td>±0.25</td> </tr> <tr> <td></td> <td>0.XXX</td> <td>±0.13</td> </tr> <tr> <td>angular</td> <td>0°</td> <td>± 2°</td> </tr> </table>	linear	0.X	±0.50		0.XX	±0.25		0.XXX	±0.13	angular	0°	± 2°	appr	-	-	product family		rev	A	
linear	0.X	±0.50																			
	0.XX	±0.25																			
	0.XXX	±0.13																			
angular	0°	± 2°																			
				title VERT 35X2 POWER EDGE CARD	www.fci.com	cat. no.	*	Product - Customer Drw	sheet 2 of 2	dwg no 10046971-040											

ProjE File - REV C - 2009-06-09