

DIMENSIONS mm (inches)

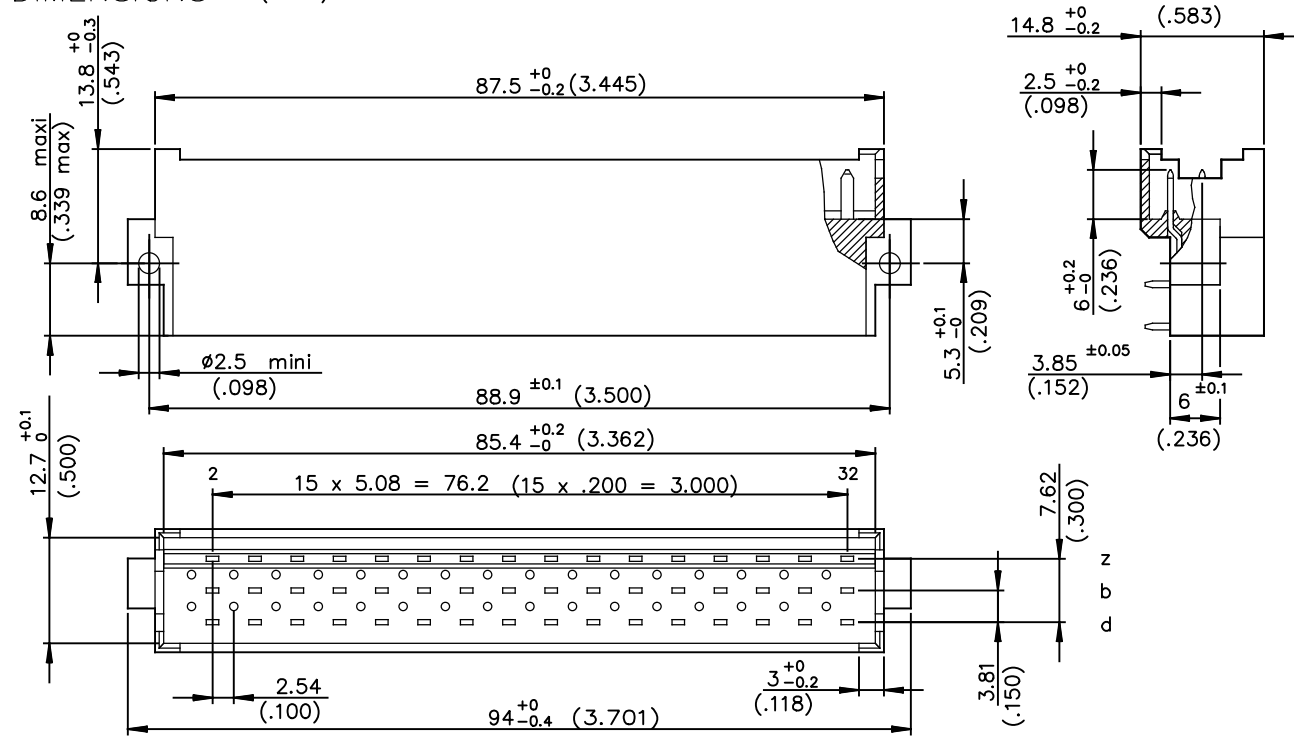

ELECTRICAL DATA

-Current at AMB.	5.5 A at 20° / 4 A at 70°
-Contact resistance	≤15mΩ according to DIN 41640 Teil 4 test 2a
-Insulation resistance	≥10 MΩ according to DIN 41640 teil 7 test 3a
-TEST VOLTAGE	according to DIN 41640 teil 21
contact/contact	1550V eff
contact/ground	2500V eff

MECHANICAL DATA

-Insertion force	≤75N
-Mechanical endurance	-class 1 500 matings unmatings according to DIN41640 teil 21
	-class 2 400 matings unmatings according to DIN41640 teil 21

-Material insulator	Polyester UL94V0
-Material contacts	Copper alloy
-Finishing contact surface	Gold over nickel Lead Free
-Finishing termination	Lead-Free
-Shock	≤30mΩ according to DIN 41640 Teil 14 test 6c
-Vibration	-class 1 10-2000Hz/20g according to DIN 41640 Teil 15
	-class 2 10-500Hz/5g according to DIN 41640 Teil 15

ENVIRONMENTAL DATA

-Climatic category	According to DIN 41612
-Corrosion	According to DIN 41612

P.C. CARD DRILLING (scale 1.2)

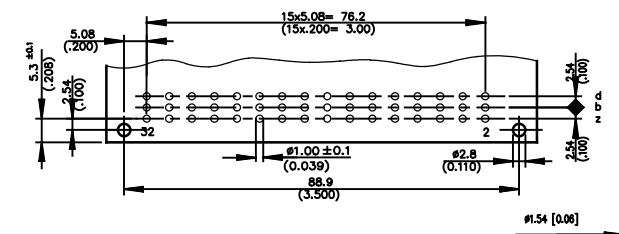

TERMINATION

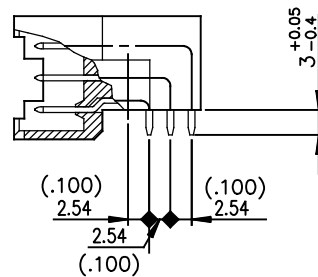

NOTE RoHS INFORMATION

- The "LF" products meet European Union Directives and other country regulations as described in GS-22-008.
 - The housing will withstand exposure to 260°C peak temperature for 3.5 seconds in a wave solder application with a 1.6mm minimum thick circuit board.
 - For the right angled versions, like the current leaded versions, it's recommended to use high temperature adhesive or metallic device, to protect the nearest plastic part in contact with of the solder wave, to avoid any visual plastic deterioration.

PART NUMBER	5159009	6	4	LF
NUMBER OF CONTACTS	32 or 48			
TERMINATION	Angled spills			
	Right angled press-fit			
PERFORMANCE CLASS	DIN 41612 class 2			
	DIN 41612 class 1			
CONTACT ARRANGEMENT	Row z,b and d with contacts (48)			111
	Row z and d with contacts (32)			101
	Row z and b with contacts (32)			110
LEAD-FREE				

mat'l. code	surface	tolerance	projection	product family
	ISO 1302	ISO 406 ISO 1101		DIN POWER 5159
ltr	ecn no	dr	date	title
C	LS05-0119	ETI	2005/12/13	PLUGS MEDIUM POWER 3 ROW STYLE F
D	LS06-0022	LGO	2006/02/21	
E	LS06-0095	LGO	2006/06/26	
F	LS07-0288	LGO	2007/11/19	
G	F10-0214	APA	2010/10/01	
H	F12-0053	APA	2012/05/07	
J	ELX-I-45969	MJA	2022/09/19	
sheet	revision	J		dwg no
index	sheet	1		sheet 1 of 1
				size
				A3
				type
				Product Customer Drawing