

| | | | | |
|---|-------------|---------------------------------|----------------------|-----------------------|
|  | Date | 10-OCT-2019 | SPECIFICATION | OLE WOLFF |
| | Page | 1 / 7 | | www.owolff.com |
| | CN | P/N: OWMB-404020SA-40-17 | | Revision: 00 |



SPECIFICATION FOR APPROVAL

SMD Electro-Magnetic Transducer

| | |
|---------------------|--|
| Part Number | OWMB-404020SA-40-17 |
| Note | This item was compliance with the following requirements: 1. RoHS directive |
| Customer P/N | |

| | | | | |
|-----------|---------------------|---------------------|---------|----------|
| Ole Wolff | Signature / Date | Prepared | Checked | Approved |
| | | ZhuYu 2019.10.10 | | |

| | | | | |
|----------|---------------------|--------------|--|--|
| Customer | Signature / Date | Confirmation | | |
| | | | | |

REVISION NOTES:

| Date | Rev. | Description of Revision |
|------------|------|-------------------------|
| 2019.10.10 | 00 | Initial Release |
| | | |
| | | |
| | | |

| | | | | | | |
|---|---|--|--|--|--|---|
| OLE WOLFF ELEKTRONIK A/S Roedengvej 25 4180 Soroe Denmark TEL: +45 57833830 FAX: +45 57820019 | OLE WOLFF ELECTRONICS INC. 1525 McCarthy Blvd, Suite 1093 Milpitas, Ca 95035 USA TEL: +1 408 888 8413 | OLEWOLFF ELEKTRONIK GmbH Schulstrasse 15A. DE-25451 Quickborn. Germany TEL: +49 (0) 4106 765900 FAX: +49 (0) 4106 627297 | OLEWOLFF ELECTRONICS 3 Bedford Street, Woburn, Bedfordshire MK17 9QB, ENGLAND TEL: +44 (0) 1525 290755 FAX: +44 (0) 1525 290855 | OLE WOLFF ELEKTRONIK Yliopistonkatu 26 (P.O.BOX 257) FI-40101 Jyväskylä Finland TEL: +358 14 338 3050 FAX: +358 14 338 3059 | OLE WOLFF (ASIA) LTD. Unit B, 19/F., Bold Win Ind. Bldg., No. 16-18 Wah Sing St., Kwai Chung, N.T., H.K. TEL: +852 2424 3274 FAX: +852 2424 2219 | OLE WOLFF LTD. 5 Floor, Block G, WenTao Industrial Park, YingRenShi, Bao'an District, Shenzhen, PRC TEL: +86 755 82612542 TEL: +86 755 26406156 |
|---|---|--|--|--|--|---|

| | | | | |
|---|-------------|---------------------------------|----------------------|-----------------------|
|  | Date | 10-OCT-2019 | SPECIFICATION | OLE WOLFF |
| | Page | 2 / 7 | | www.owolff.com |
| | CN | P/N: OWMB-404020SA-40-17 | | Revision: 00 |

1. SCOPE

THIS SPECIFICATION IS APPLIED TO OLE WOLFF SMD ELECTRO-MAGNETIC TRANSDUCER UNIT OF MODEL: OWMB-404020SA-40-17

2. GENERAL REQUIREMENTS

OPERATING TEMPERATURE RANGE: -40°C ~ +85°C

STORAGE TEMPERATUR RANGE: -40°C ~ +85°C

3. MECHANICAL LAYOUT & DIMENSIONS

DIMENSIONS: SHOWN IN FIGURE 3.

WEIGHT: 0.1g

4. ELECTRICAL CHARACTERISTICS

| NO. | ITEM | SPECIFICATION |
|-----|-------------------------|---------------|
| 1 | RATED VOLTAGE | 3.0V |
| 2 | OPERATING VOLTAGE | 2-4V |
| 3 | RESONANT FREQUENCY | 4000Hz |
| 4 | ☆COIL RESISTANCE | 17 ± 3 Ω |
| 5 | ☆*RATED CURRENT | ≤90mA |
| 6 | ☆* SOUND OUTPUT AT 10cm | ≥70dB |
| 7 | HOUSING MATERIAL | LCP(Black) |

*Applying rated voltage (Resonant frequency, 1/2 duty, Square wave)

☆Tset Basic State: Temp(20 ± 2°C), Humidity(40~70%RH), Air pressure(860~1060hPa).

| | | | | | | |
|---|---|--|--|--|--|---|
| OLE WOLFF ELEKTRONIK A/S Roedengvej 25 4180 Soroe Denmark TEL: +45 57833830 FAX: +45 57820019 | OLE WOLFF ELECTRONICS INC. 1525 McCarthy Blvd, Suite 1093 Milpitas, Ca 95035 USA TEL: +1 408 888 8413 | OLEWOLFF ELEKTRONIK GmbH Schulstrasse 15A. DE-25451 Quickborn. Germany TEL: +49 (0) 4106 765900 FAX: +49 (0) 4106 627297 | OLEWOLFF ELECTRONICS 3 Bedford Street, Woburn, Bedfordshire MK17 9QB, ENGLAND TEL: +44 (0) 1525 290755 FAX: +44 (0) 1525 290855 | OLE WOLFF ELEKTRONIK Yliopistonkatu 26 (P.O.BOX 257) FI-40101 Jyväskylä Finland TEL: +358 14 338 3050 FAX: +358 14 338 3059 | OLE WOLFF (ASIA) LTD. Unit B, 19/F., Bold Win Ind. Bldg., No. 16-18 Wah Sing St., Kwai Chung, N.T., H.K. TEL: +852 2424 3274 FAX: +852 2424 2219 | OLE WOLFF LTD. 5 Floor, Block G, WenTao Industrial Park, YingRenShi, Bao'an District, Shenzhen, PRC TEL: +86 755 82612542 TEL: +86 755 26406156 |
|---|---|--|--|--|--|---|

| | | | | |
|---|-------------|---------------------------------|----------------------|-----------------------|
|  | Date | 10-OCT-2019 | SPECIFICATION | OLE WOLFF |
| | Page | 3 / 7 | | www.owolff.com |
| | CN | P/N: OWMB-404020SA-40-17 | | Revision: 00 |

5. RELIABILITY TEST

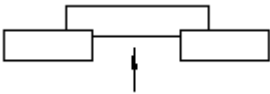
| | | | | |
|--|--|--|--|--|
| <p>- After Test All specifications must be satisfied after the test.</p> | | | | |
| <p>5.1 High temperature Test Temperature: +85±2°C Duration: 120HRS</p> | | | | |
| <p>5.2 Low temperature Test Temperature: -40±2°C Duration: 120HRS</p> | | | | |
| <p>5.3 Humidity Test Temperature: +40±2°C Humidity: 90~95%RH Duration: 120HRS</p> | | | | |
| <p>5.4 Temperature cycling Test Temperature: -40±2°C room temp. +85±2°C room temp. Duration: 30min 15min 30min 15min Cycle: 5 cycles</p> | | | | |
| <p>5.5 Vibration Test Input power: 10Hz(a period is 1 minute) Amplitude: 1.52mm(9.3g) Duration: 2 hours per plane in each three mutually perpendicular planes for a total time of 6 hours.</p> | | | | |
| <p>5.6 Shock Test Sounder shall be measured after being applied shock (980m/s²) for each three mutually perpendicular directions to each of 3 times by half sine wave.</p> | | | | |
| <p>5.7 Drop Test Dropped naturally from 700mm height onto the surface of 10mm thick wooden board. 2 directions-upper and side of the part are to be applied.</p> | | | | |
| <p>5.8 Lead pull The part shall be pulled with a force of 9.8N for 10±1 seconds behind the part.</p> <div style="text-align: center;">  </div> <p>After the test part shall meet specifications without any degradation in appearance and performance.</p> | | | | |
| <p>5.9 Recommended temp. Profile for Reflow Oven Shown in Figure 4</p> | | | | |

| | | | | | | |
|---|---|--|--|--|--|---|
| OLE WOLFF ELEKTRONIK A/S Roedengvej 25 4180 Soroe Denmark TEL: +45 57833830 FAX: +45 57820019 | OLE WOLFF ELECTRONICS INC. 1525 McCarthy Blvd, Suite 1093 Milpitas, Ca 95035 USA TEL: +1 408 888 8413 | OLEWOLFF ELEKTRONIK GmbH Schulstrasse 15A. DE-25451 Quickborn. Germany TEL: +49 (0) 4106 765900 FAX: +49 (0) 4106 627297 | OLEWOLFF ELECTRONICS 3 Bedford Street, Woburn, Bedfordshire MK17 9QB, ENGLAND TEL: +44 (0) 1525 290755 FAX: +44 (0) 1525 290855 | OLE WOLFF ELEKTRONIK Yliopistonkatu 26 (P.O.BOX 257) FI-40101 Jyväskylä Finland TEL: +358 14 338 3050 FAX: +358 14 338 3059 | OLE WOLFF (ASIA) LTD. Unit B, 19/F., Bold Win Ind. Bldg., No. 16-18 Wah Sing St., Kwai Chung, N.T., H.K. TEL: +852 2424 3274 FAX: +852 2424 2219 | OLE WOLFF LTD. 5 Floor, Block G, WenTao Industrial Park, YingRenShi, Bao'an District, Shenzhen, PRC TEL: +86 755 82612542 TEL: +86 755 26406156 |
|---|---|--|--|--|--|---|

| | | | | |
|---|-------------|---------------------------------|----------------------|-----------------------|
|  | Date | 10-OCT-2019 | SPECIFICATION | OLE WOLFF |
| | Page | 4 / 7 | | www.owolff.com |
| | CN | P/N: OWMB-404020SA-40-17 | | Revision: 00 |

6. TEST METHOD (Figure 1)

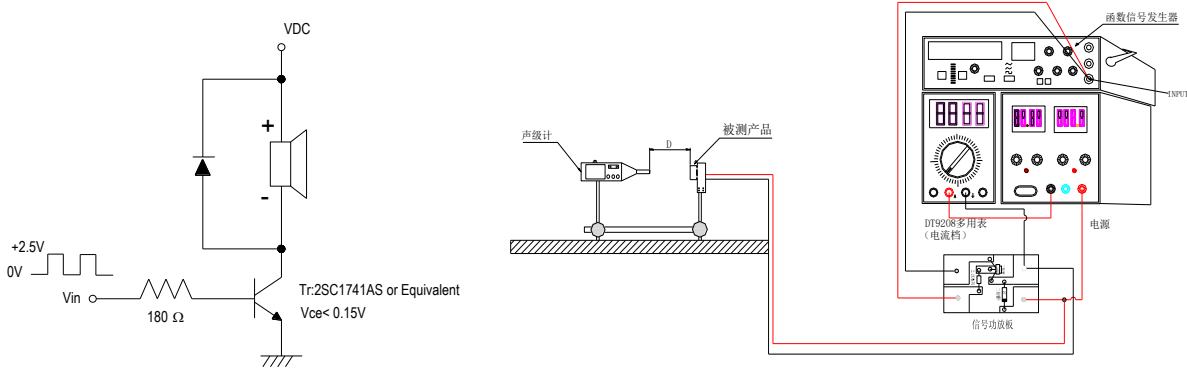

7. FREQUENCY RESPONSE (Figure 2)

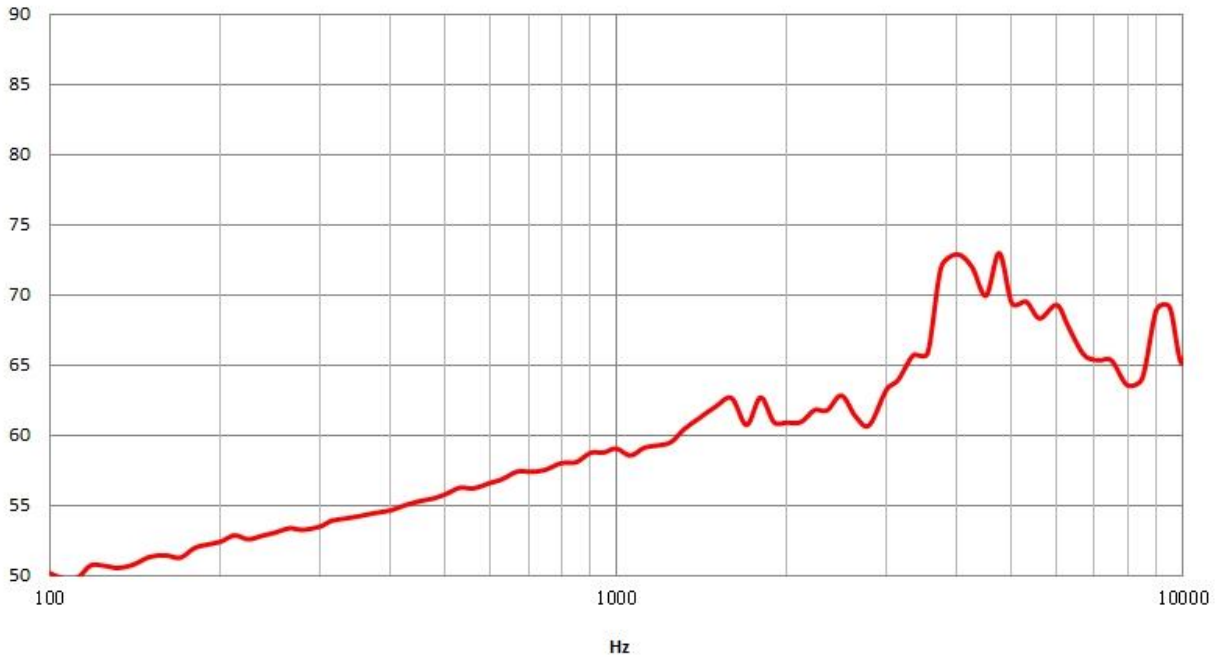

| | | | | | | |
|---|---|--|--|--|--|---|
| OLE WOLFF ELEKTRONIK A/S Roedengvej 25 4180 Soroe Denmark TEL: +45 57833830 FAX: +45 57820019 | OLE WOLFF ELECTRONICS INC. 1525 McCarthy Blvd, Suite 1093 Milpitas, Ca 95035 USA TEL: +1 408 888 8413 | OLEWOLFF ELEKTRONIK GmbH Schulstrasse 15A. DE-25451 Quickborn. Germany TEL: +49 (0) 4106 765900 FAX: +49 (0) 4106 627297 | OLEWOLFF ELECTRONICS 3 Bedford Street, Woburn, Bedfordshire MK17 9QB, ENGLAND TEL: +44 (0) 1525 290755 FAX: +44 (0) 1525 290855 | OLE WOLFF ELEKTRONIK Yliopistonkatu 26 (P.O.BOX 257) FI-40101 Jyväskylä Finland TEL: +358 14 338 3050 FAX: +358 14 338 3059 | OLE WOLFF (ASIA) LTD. Unit B, 19/F., Bold Win Ind. Bldg., No. 16-18 Wah Sing St., Kwai Chung, N.T., H.K. TEL: +852 2424 3274 FAX: +852 2424 2219 | OLE WOLFF LTD. 5 Floor, Block G, WenTao Industrial Park, YingRenShi, Bao'an District, Shenzhen, PRC TEL: +86 755 82612542 TEL: +86 755 26406156 |
|---|---|--|--|--|--|---|

| | | | | |
|---|-------------|---------------------------------|----------------------|-----------------------|
|  | Date | 10-OCT-2019 | SPECIFICATION | OLE WOLFF |
| | Page | 5 / 7 | | www.owolff.com |
| | CN | P/N: OWMB-404020SA-40-17 | | Revision: 00 |

8. DIMENSIONS (Figure 3)

Unit: mm Tolerance: ± 0.5 mm Except Specified

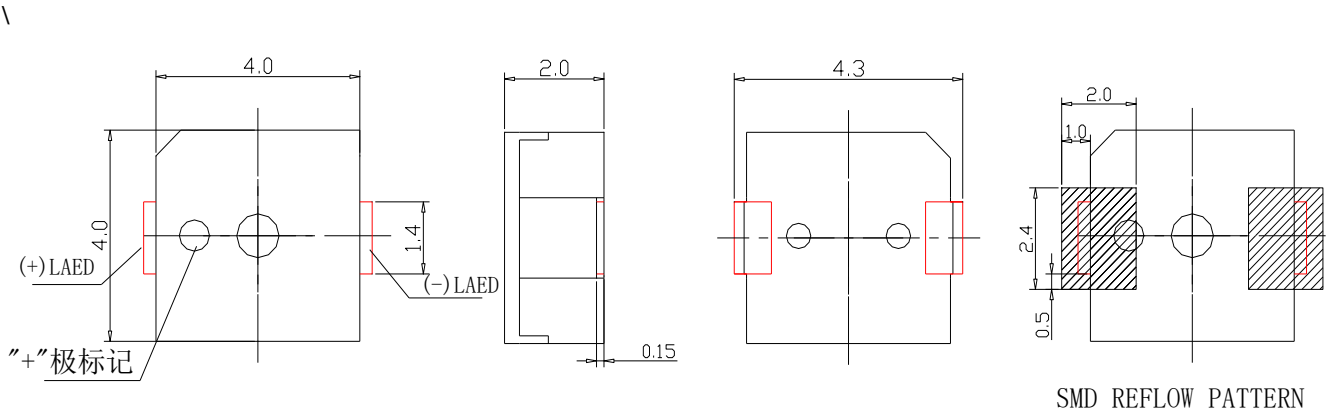

| | | | | | | |
|---|---|--|--|--|--|---|
| OLE WOLFF ELEKTRONIK A/S Roedengvej 25 4180 Soroe Denmark TEL: +45 57833830 FAX: +45 57820019 | OLE WOLFF ELECTRONICS INC. 1525 McCarthy Blvd, Suite 1093 Milpitas, Ca 95035 USA TEL: +1 408 888 8413 | OLEWOLFF ELEKTRONIK GmbH Schulstrasse 15A. DE-25451 Quickborn. Germany TEL: +49 (0) 4106 765900 FAX: +49 (0) 4106 627297 | OLEWOLFF ELECTRONICS 3 Bedford Street, Woburn, Bedfordshire MK17 9QB, ENGLAND TEL: +44 (0) 1525 290755 FAX: +44 (0) 1525 290855 | OLE WOLFF ELEKTRONIK Yliopistonkatu 26 (P.O.BOX 257) FI-40101 Jyväskylä Finland TEL: +358 14 338 3050 FAX: +358 14 338 3059 | OLE WOLFF (ASIA) LTD. Unit B, 19/F., Bold Win Ind. Bldg., No. 16-18 Wah Sing St., Kwai Chung, N.T., H.K. TEL: +852 2424 3274 FAX: +852 2424 2219 | OLE WOLFF LTD. 5 Floor, Block G, WenTao Industrial Park, YingRenShi, Bao'an District, Shenzhen, PRC TEL: +86 755 82612542 TEL: +86 755 26406156 |
|---|---|--|--|--|--|---|

| | | | | |
|---|-------------|---------------------------------|----------------------|-----------------------|
|  | Date | 10-OCT-2019 | SPECIFICATION | OLE WOLFF |
| | Page | 6 / 7 | | www.owolff.com |
| | CN | P/N: OWMB-404020SA-40-17 | | Revision: 00 |

9. Recommended Temp. Profile for Reflow Oven (Figure 4)

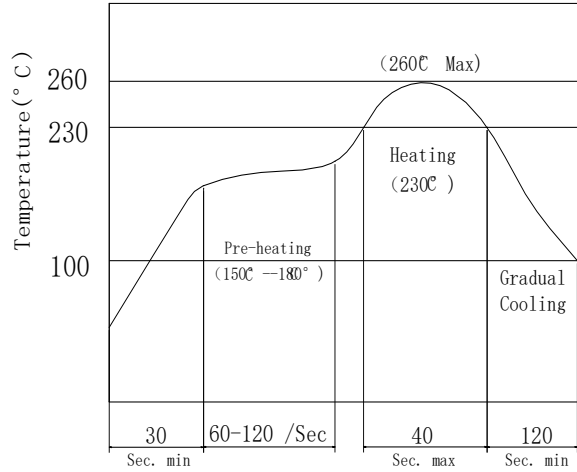

10. PACKAGE INFORMATION (Figure 5)

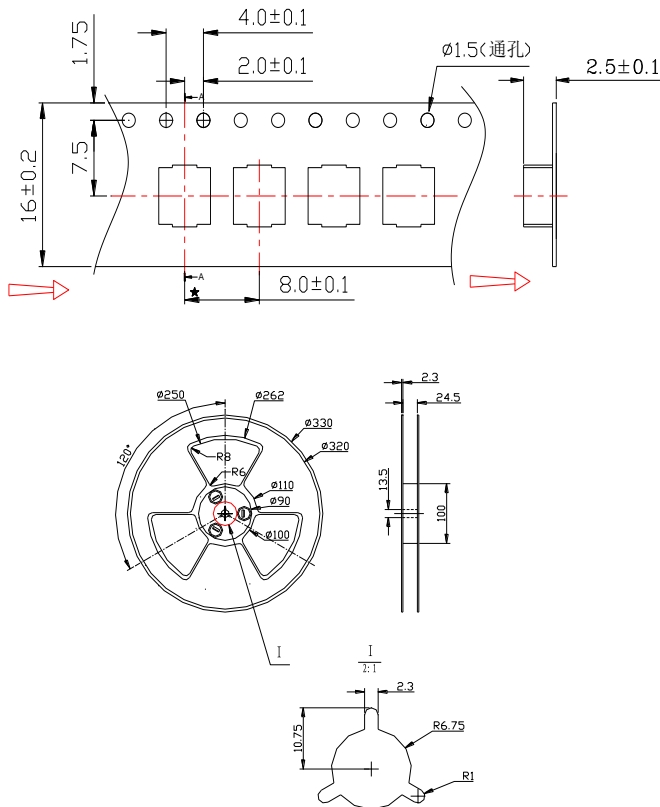

| | | | | | | |
|---|---|--|--|--|--|---|
| OLE WOLFF ELEKTRONIK A/S Roedengvej 25 4180 Soroe Denmark TEL: +45 57833830 FAX: +45 57820019 | OLE WOLFF ELECTRONICS INC. 1525 McCarthy Blvd, Suite 1093 Milpitas, Ca 95035 USA TEL: +1 408 888 8413 | OLEWOLFF ELEKTRONIK GmbH Schulstrasse 15A. DE-25451 Quickborn. Germany TEL: +49 (0) 4106 765900 FAX: +49 (0) 4106 627297 | OLEWOLFF ELECTRONICS 3 Bedford Street, Woburn, Bedfordshire MK17 9QB, ENGLAND TEL: +44 (0) 1525 290755 FAX: +44 (0) 1525 290855 | OLE WOLFF ELEKTRONIK Yliopistonkatu 26 (P.O.BOX 257) FI-40101 Jyväskylä Finland TEL: +358 14 338 3050 FAX: +358 14 338 3059 | OLE WOLFF (ASIA) LTD. Unit B, 19/F., Bold Win Ind. Bldg., No. 16-18 Wah Sing St., Kwai Chung, N.T., H.K. TEL: +852 2424 3274 FAX: +852 2424 2219 | OLE WOLFF LTD. 5 Floor, Block G, WenTao Industrial Park, YingRenShi, Bao'an District, Shenzhen, PRC TEL: +86 755 82612542 TEL: +86 755 26406156 |
|---|---|--|--|--|--|---|

| | | | | |
|---|------|--------------------------|----------------------|----------------|
|  | Date | 10-OCT-2019 | SPECIFICATION | OLE WOLFF |
| | Page | 7 / 7 | | www.owolff.com |
| | CN | P/N: OWMB-404020SA-40-17 | | Revision: 00 |

11. PACKAGE INFORMATION (Figure 6)

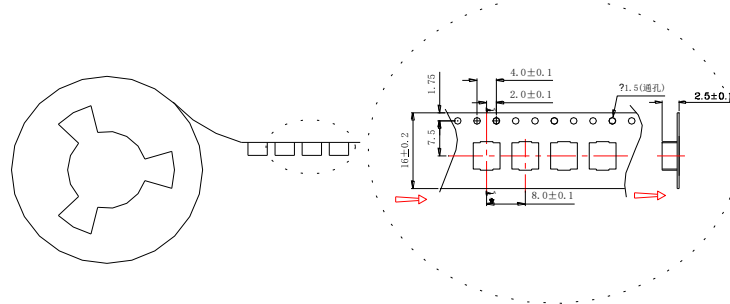

3000PCS/CARRUER REEK; 每卷装3000只

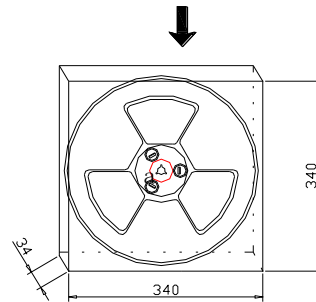

1ROLL CARRIER REEL/INNER BOX; 1卷放入一内盒

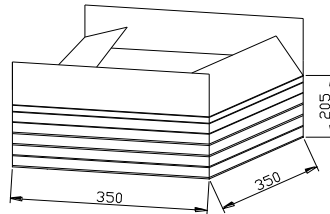

15000PCS/CTN 每箱放15000只(5只内盒)

NOTES:

- 1.3000 PCS per box
- 2.Total 5 boxes per carton
- 3.Total 15000 PCS carton

| | | | | | | |
|---|---|--|--|--|--|---|
| OLE WOLFF ELEKTRONIK A/S Roedengvej 25 4180 Soroe Denmark TEL: +45 57833830 FAX: +45 57820019 | OLE WOLFF ELECTRONICS INC. 1525 McCarthy Blvd, Suite 1093 Milpitas, Ca 95035 USA TEL: +1 408 888 8413 | OLEWOLFF ELEKTRONIK GmbH Schulstrasse 15A. DE-25451 Quickborn. Germany TEL: +49 (0) 4106 765900 FAX: +49 (0) 4106 627297 | OLEWOLFF ELECTRONICS 3 Bedford Street, Woburn, Bedfordshire MK17 9QB, ENGLAND TEL: +44 (0) 1525 290755 FAX: +44 (0) 1525 290855 | OLE WOLFF ELEKTRONIK Yliopistonkatu 26 (P.O.BOX 257) FI-40101 Jyväskylä Finland TEL: +358 14 338 3050 FAX: +358 14 338 3059 | OLE WOLFF (ASIA) LTD. Unit B, 19/F., Bold Win Ind. Bldg., No. 16-18 Wah Sing St., Kwai Chung, N.T., H.K. TEL: +852 2424 3274 FAX: +852 2424 2219 | OLE WOLFF LTD. 5 Floor, Block G, WenTao Industrial Park, YingRenShi, Bao'an District, Shenzhen, PRC TEL: +86 755 82612542 TEL: +86 755 26406156 |
|---|---|--|--|--|--|---|