

HEADERS CODINGS

(CODING 2 SHOWN)

HEADER'S CODINGS FOR MODULE T2 (32W)					
COLOR	CODING	DIM. A	DIM. B	DIM. C	DIM. D
BLACK	1	9.1	4.3	5.9	4.3
GREY	2	7.5	5.9	9.1	5.9
BROWN	3	5.9	7.5	9.1	9.1
GREEN	4	7.5	9.1	4.3	4.3
BLUE	5	4.3	7.5	5.9	5.9
YELLOW	6	9.1	7.5	4.3	7.5

(CODING 3 SHOWN)

HEADER'S CODINGS FOR MODULE T3 (48W)					
COLOR	CODING	DIM. A	DIM. B	DIM. C	DIM. D
BLACK	1	12.9	6.3	8.5	6.3
GREY	2	10.7	8.5	12.9	8.5
BROWN	3	8.5	10.7	12.9	12.9
GREEN	4	10.7	12.9	6.3	6.3
BLUE	5	6.3	10.7	8.5	8.5
YELLOW	6	12.9	10.7	6.3	10.7

NOTE:

- 1- INTERFACE DEFINITION BASED ON NFR13-462 STANDARD.
- 2- HEADER: ELASTICITY MODULUS: 8000Mpa min. (INITIAL CONDITION BEFORE AGEING)

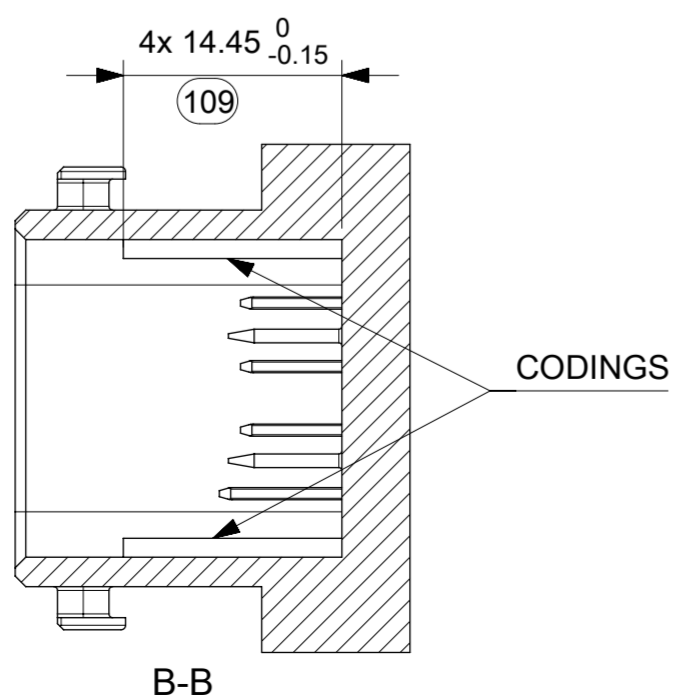

THIS DRAWING CONTAINS INFORMATION THAT IS PROPRIETARY TO MOLEX ELECTRONIC TECHNOLOGIES, LLC AND SHOULD NOT BE USED WITHOUT WRITTEN PERMISSION

DIMENSION UNITS	SCALE	CURRENT REV DESC: NX RE-MASTERING	
mm	2:1		
GENERAL TOLERANCES (UNLESS SPECIFIED)			
ANGULAR TOL	± 2.0°	EC NO:	603689
4 PLACES	± 0.10	DRWN:	SLAFAURE 2018/07/17
3 PLACES	± 0.10	CHK'D:	OPLESSIS 2018/08/31
2 PLACES	± 0.10	APPR:	SLAFAURE 2018/09/03
1 PLACE	± 0.10	INITIAL REVISION:	
0 PLACES	±	DRWN:	G.DESBRUERES 2008/10/02
		APPR:	OPLESSIS 2008/10/06
DRAFT WHERE APPLICABLE MUST REMAIN WITHIN DIMENSIONS	FIRST ANGLE PROJECTION	DRAWING	SERIES
		A2-SIZE	98644
DOCUMENT NUMBER		CUSTOMER	SHEET NUMBER
SD-98644-006		GENERAL MARKET	1 OF 3

32 & 48CKT CMC INTERFACE

PRODUCT CUSTOMER DRAWING

DOCUMENT NUMBER	DOC TYPE	DOC PART	REVISION
SD-98644-006	PSD	001	B1

PINS 0.635 DEFINITION

5:1

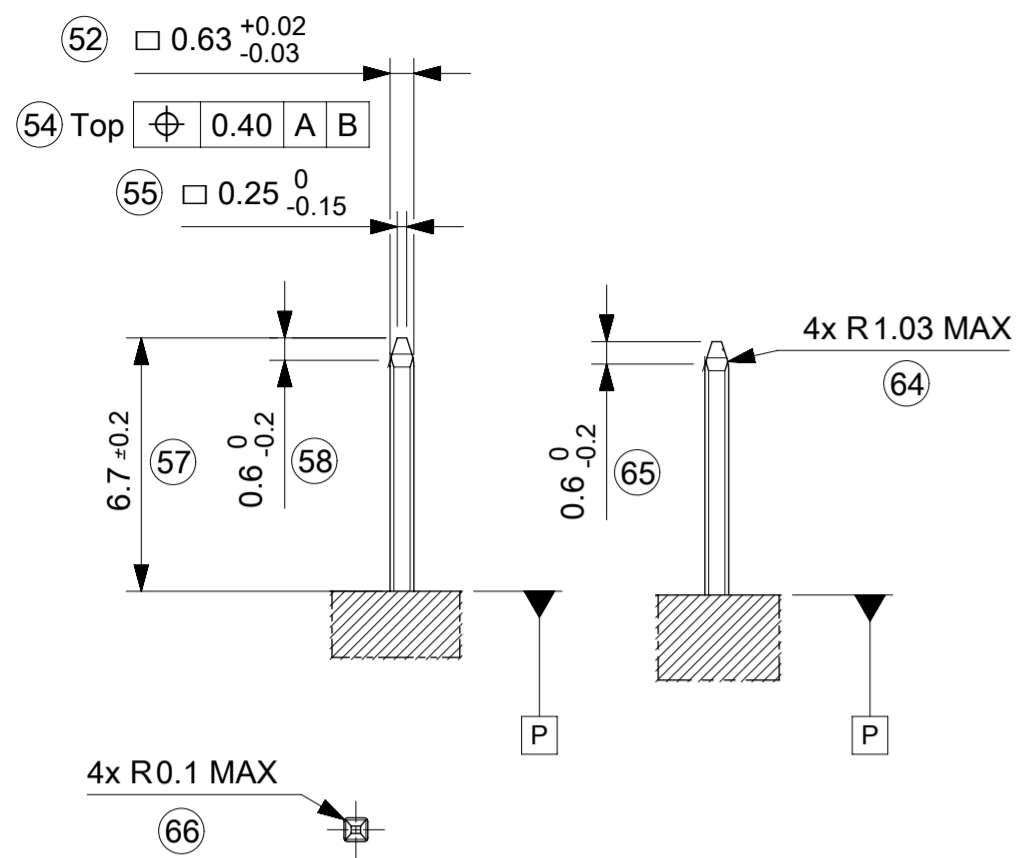

TABS 1.5 DEFINITION

5:1

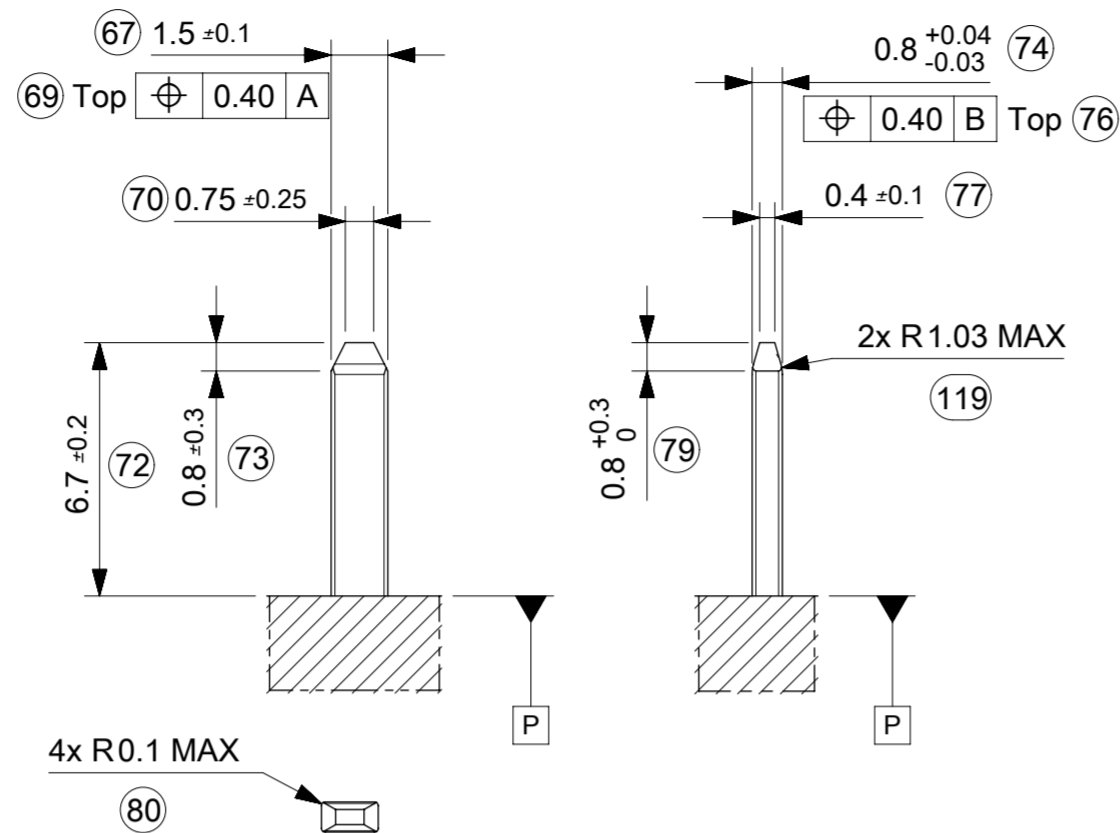

GROUND TABS 1.5 DEFINITION

5:1

FOR OTHER DIMENSIONS
SEE TABS 1.5 DEFINITION

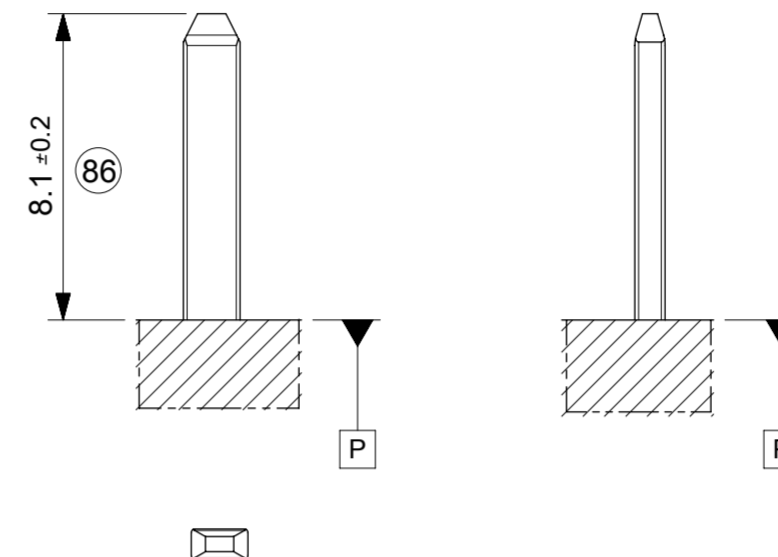

PROTECTION WALL DEFINITION

5:1

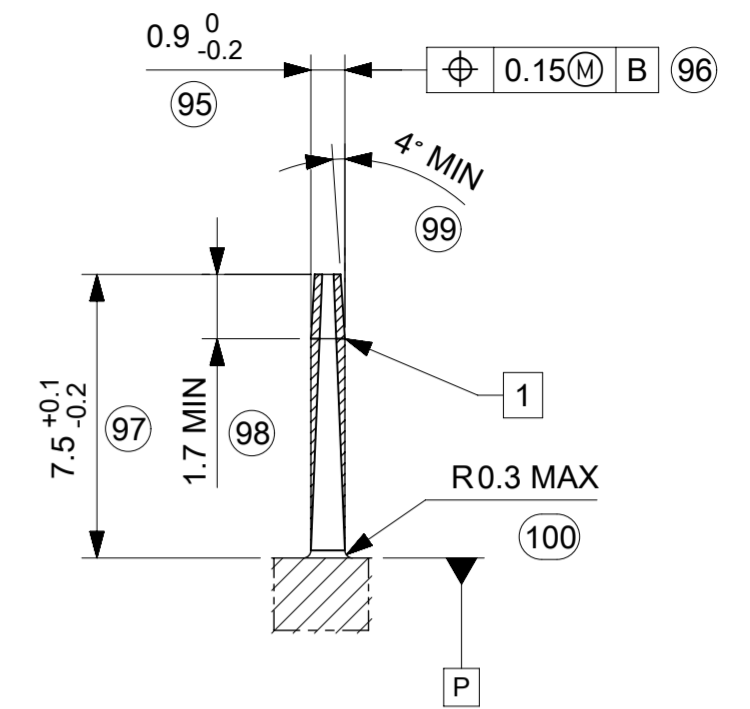

1 : SHAPES ALLOWED

LOCKING AXIS PROTECTION

5:1

MANDATORY OVERTHICKNESS: dimension noted (*)
IF THE LOCKING AXIS ARE OUT OF
EQUIPMENT OVERALL DIMENSIONS.

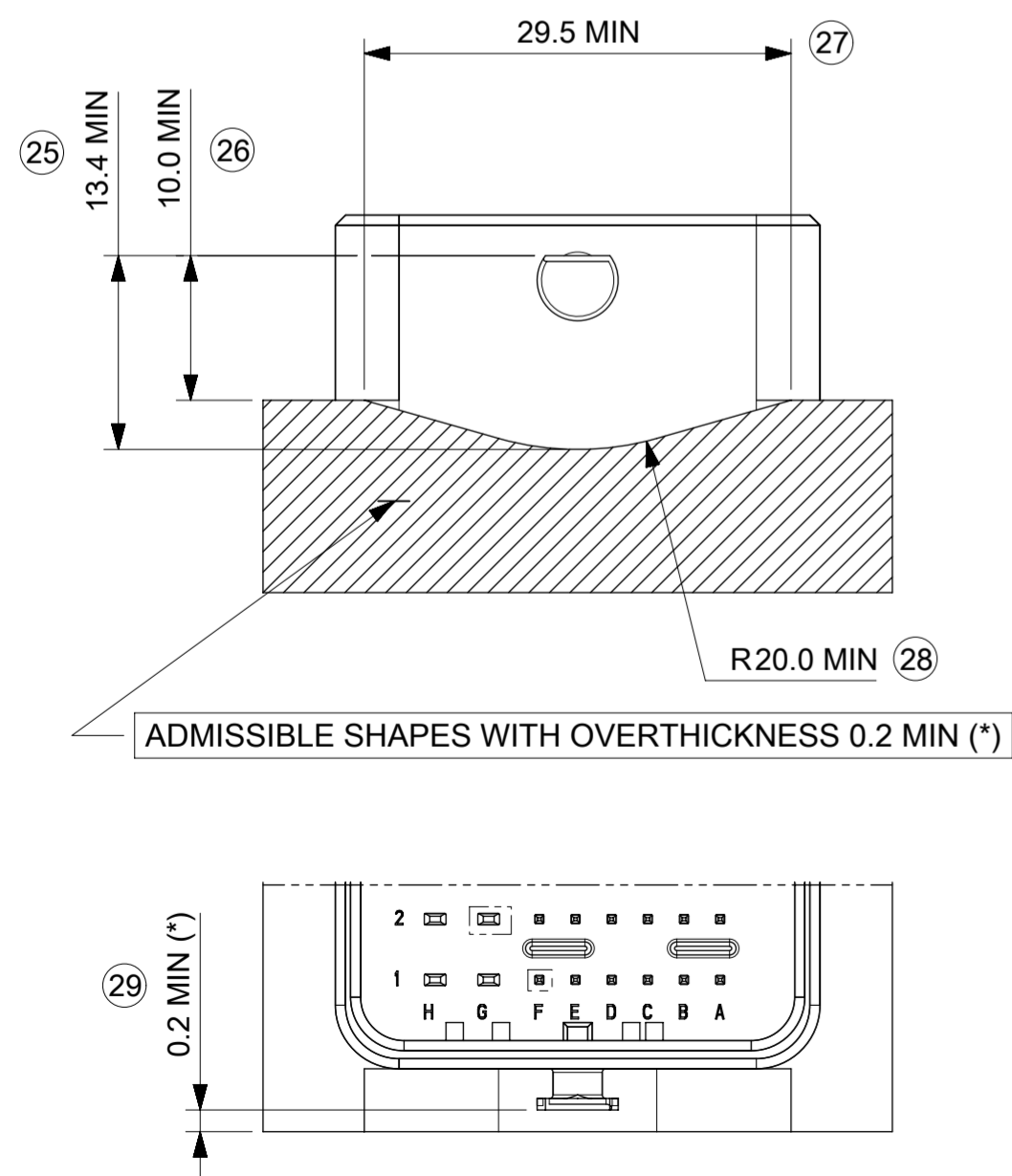

LOCKING AXIS DEFINITION

5:1

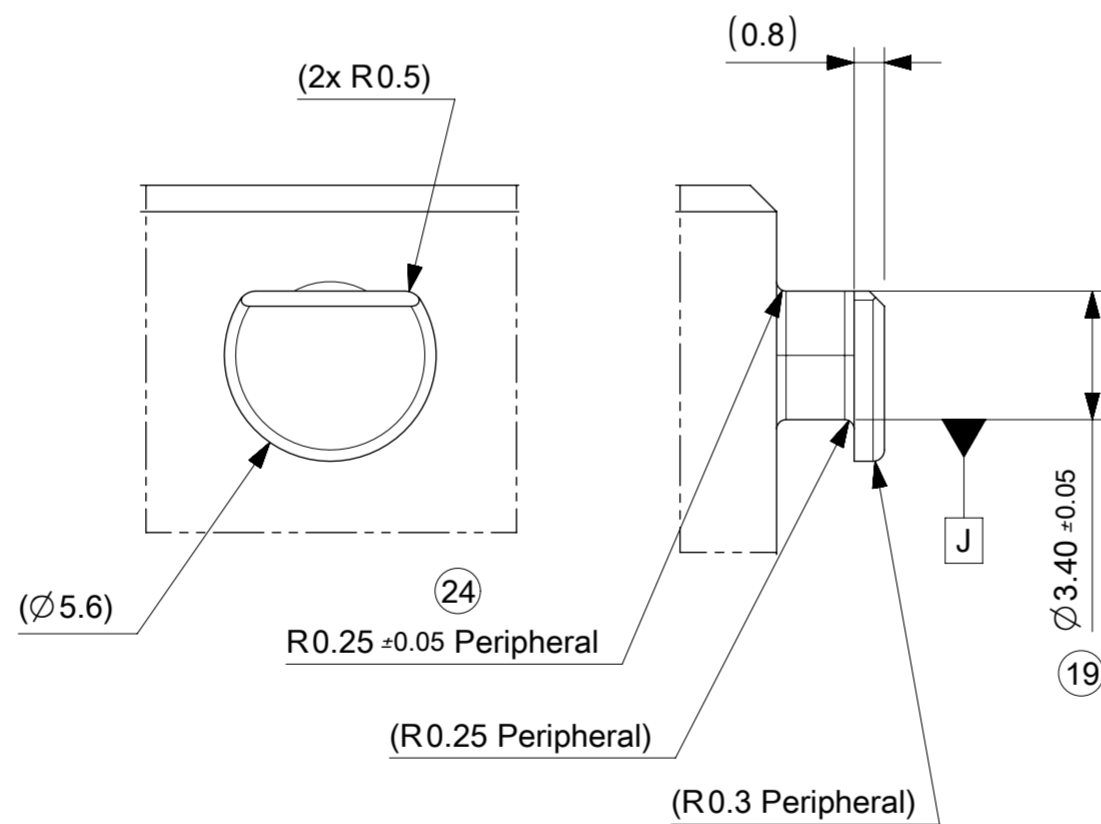

THIS DRAWING CONTAINS INFORMATION THAT IS PROPRIETARY TO MOLEX ELECTRONIC TECHNOLOGIES, LLC AND SHOULD NOT BE USED WITHOUT WRITTEN PERMISSION

DIMENSION UNITS	SCALE	CURRENT REV DESC: NX RE-MASTERING	
mm	1:1		
GENERAL TOLERANCES (UNLESS SPECIFIED)			
ANGULAR TOL	± 2.0°	EC NO:	603689
4 PLACES	± 0.1	DRWN:	GMANIVANNAN 2018/07/17
3 PLACES	± 0.1	CHK'D:	OPLESSIS 2018/08/31
2 PLACES	± 0.1	APPR:	SLAFAURE 2018/09/03
1 PLACE	± 0.1	INITIAL REVISION:	
0 PLACES	±	DRWN:	GDESBRUERES 2008/10/02
		APPR:	OPLESSIS 2008/10/06
DRAFT WHERE APPLICABLE MUST REMAIN WITHIN DIMENSIONS	FIRST ANGLE PROJECTION	DRAWING	SERIES
		A2-SIZE	98644
DOCUMENT STATUS	DOC TYPE	MATERIAL NUMBER	CUSTOMER
P1	PSD	N/A	GENERAL MARKET
RELEASE DATE	DOC PART	REVISION	SHEET NUMBER
2018/09/03	001	B1	2 OF 3
08:17:38			

molex

32 & 48CKT CMC INTERFACE

PRODUCT CUSTOMER DRAWING

SD-98644-006

LAYOUT FOR TWO INTERFACES T2 (32W)

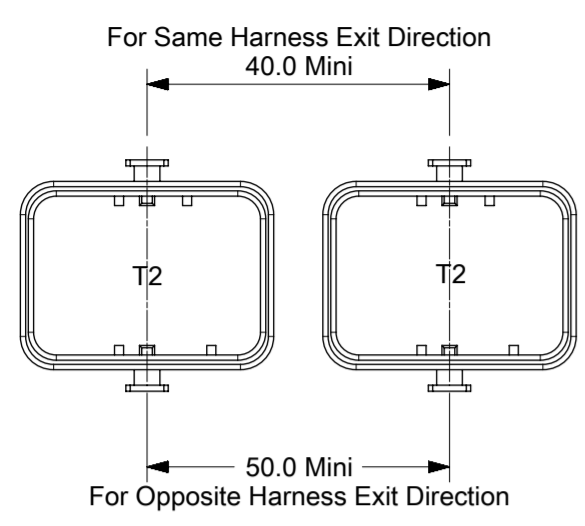

LAYOUT FOR TWO INTERFACES T2 (32W) AND T3 (48W)

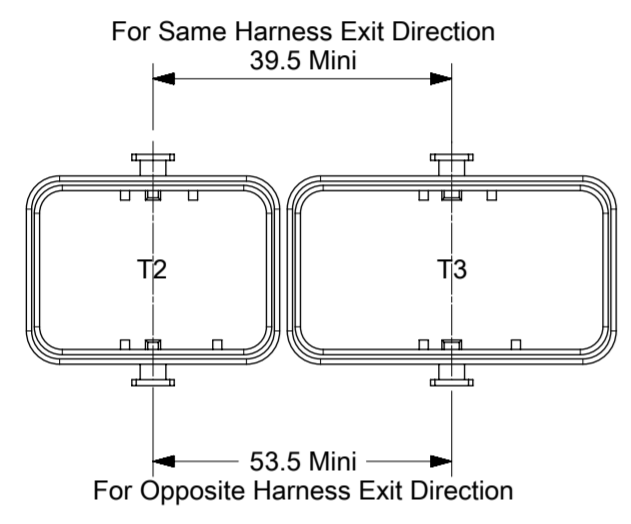

LAYOUT FOR TWO INTERFACES T3 (48W)

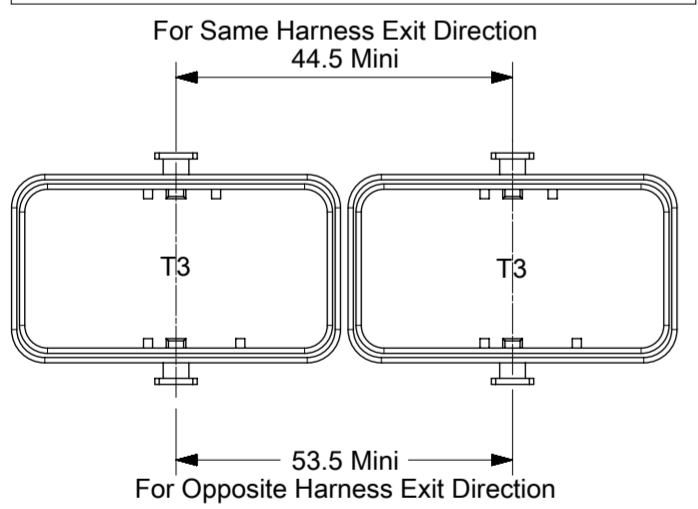

MULTI - HEADERS LAYOUT

CONNECTOR ON HEADER - OVERALL DIMENSIONS

UNLOCKED CONNECTOR - OVERALL DIMENSIONS

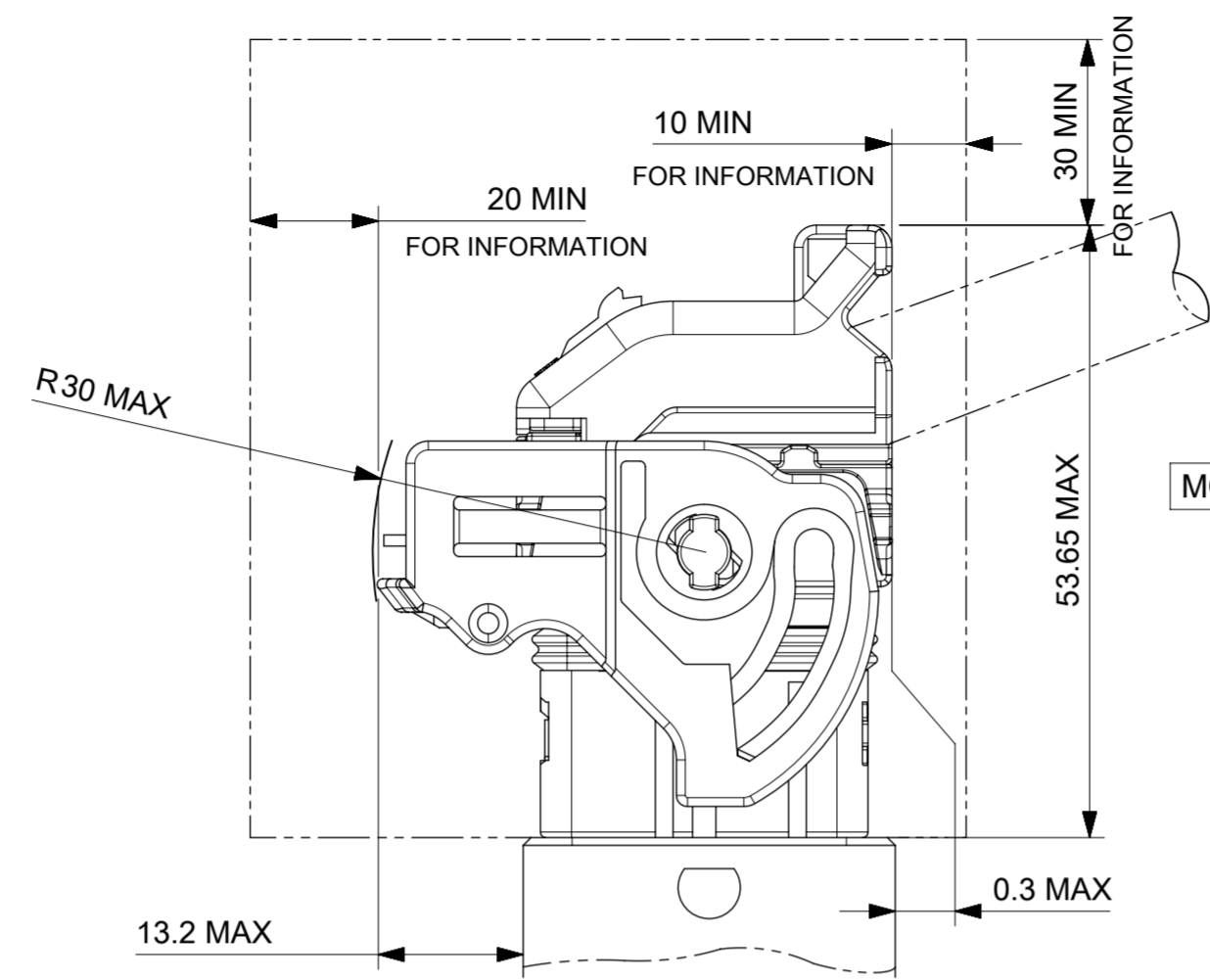

MODULE T2 (32W)

LOCKED CONNECTOR - OVERALL DIMENSIONS

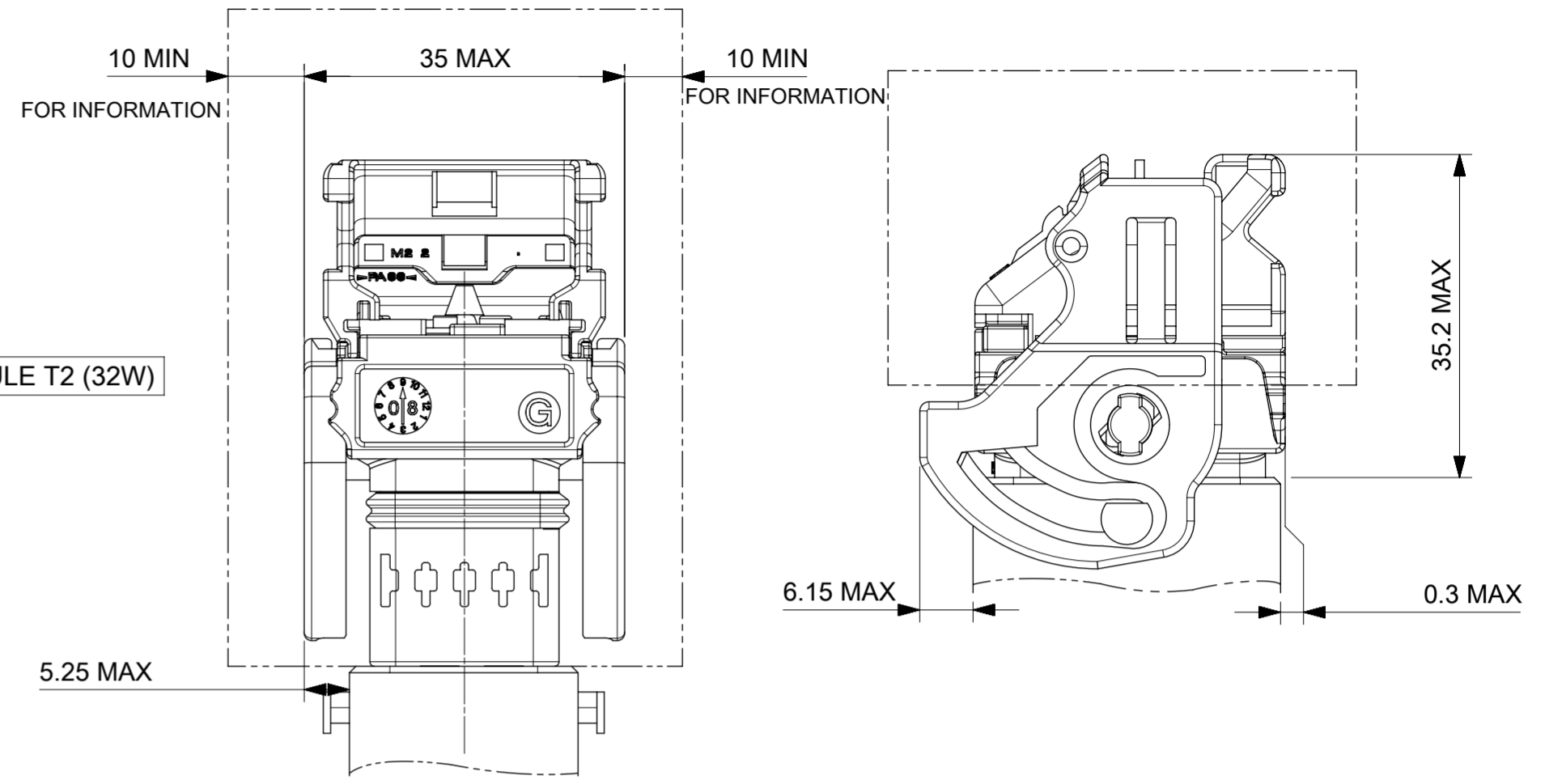

UNLOCKED CONNECTOR - OVERALL DIMENSIONS

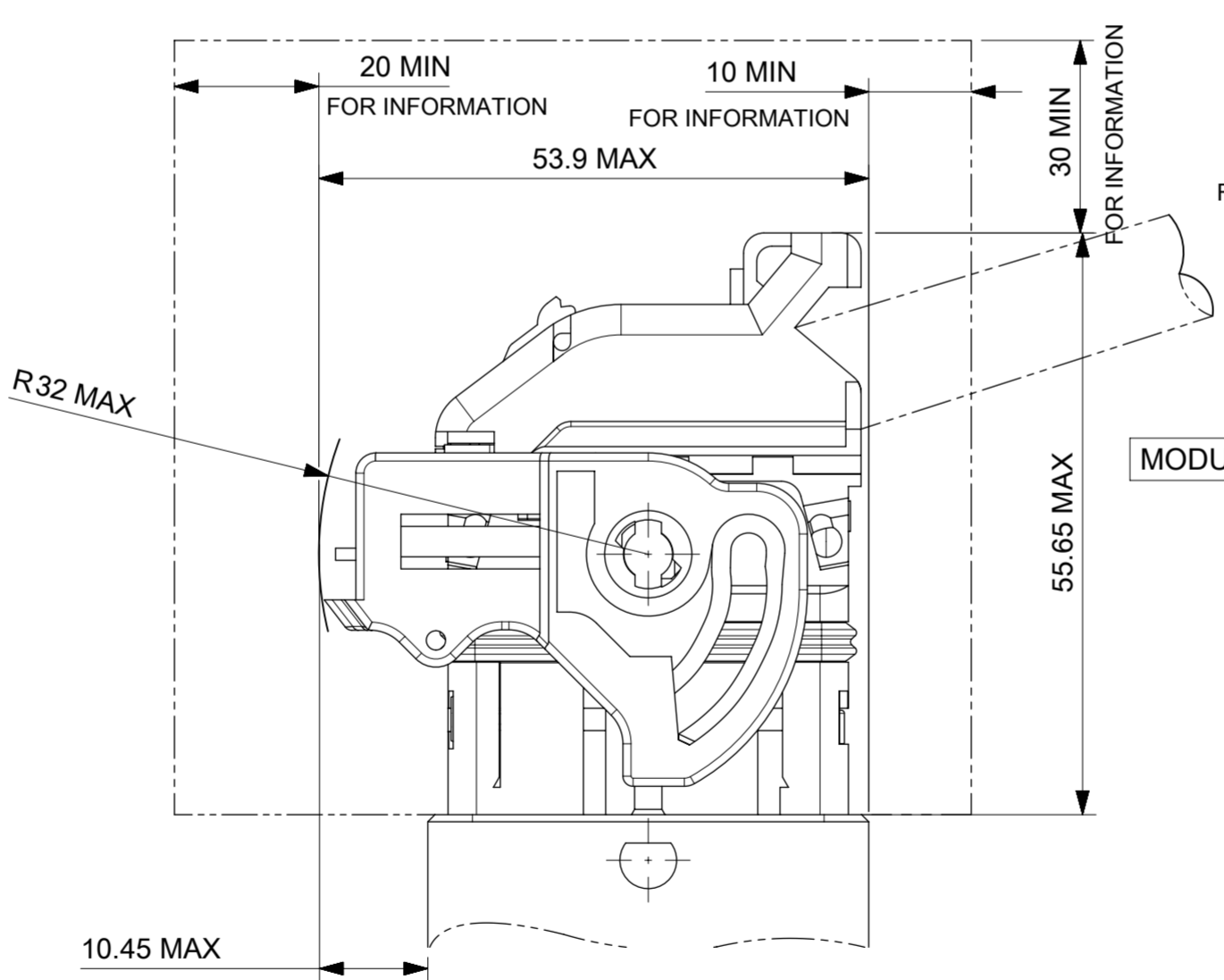

MODULE T3 (48W)

LOCKED CONNECTOR - OVERALL DIMENSIONS

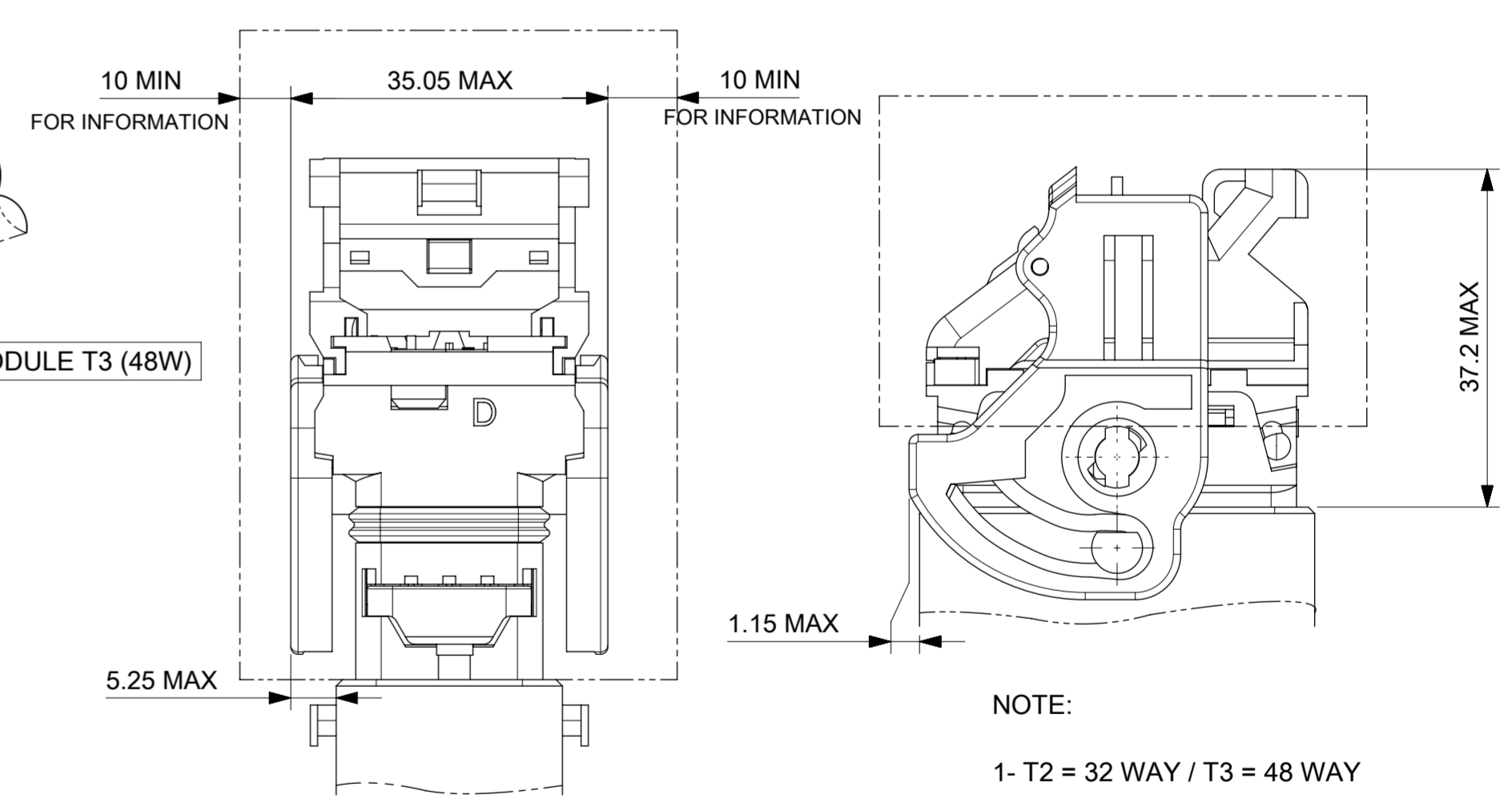

NOTE:
1- T2 = 32 WAY / T3 = 48 WAY

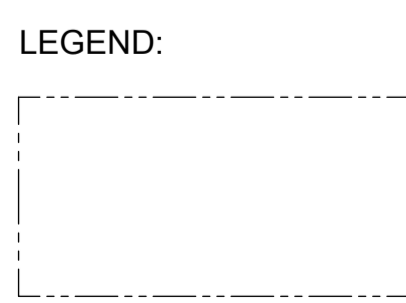

LEGEND:
FREE VOLUME FOR MANUAL LOCKING AND UNLOCKING
DIMENSIONS GIVEN FOR INFORMATION ONLY BE
CONFIRMED BASED UPON VEHICLE CONFIGURATION.

THIS DRAWING CONTAINS INFORMATION THAT IS PROPRIETARY TO MOLEX ELECTRONIC TECHNOLOGIES, LLC AND SHOULD NOT BE USED WITHOUT WRITTEN PERMISSION

DIMENSION UNITS	SCALE	CURRENT REV DESC: NX RE-MASTERING	
mm	1:1		
GENERAL TOLERANCES (UNLESS SPECIFIED)			
ANGULAR TOL	± 2.0°	EC NO:	603689
4 PLACES	± 0.1	DRWN:	SLAFAURE 2018/07/17
3 PLACES	± 0.1	CHK'D:	OPLESSIS 2018/08/31
2 PLACES	± 0.1	APPR:	SLAFAURE 2018/09/03
1 PLACE	± 0.1	INITIAL REVISION:	
0 PLACES	±	DRWN:	GDESBRUERES 2008/10/02
		APPR:	OPLESSIS 2008/10/06
DRAFT WHERE APPLICABLE MUST REMAIN WITHIN DIMENSIONS	FIRST ANGLE PROJECTION	DRAWING	SERIES
		A2-SIZE	98644
DOCUMENT STATUS	P1	RELEASE DATE	2018/09/03 08:17:38
		MATERIAL NUMBER	CUSTOMER
		N/A	GENERAL MARKET
		DOCUMENT NUMBER	DOC TYPE DOC PART REVISION
		SD-98644-006	PSD 001 B1
			SHEET NUMBER
			3 OF 3

ENCOMBREMENT PORTE-CLIPS D.V. POSITION MONTAGE CLIP
FEMALE MODULE LAYOUT SECONDARY LOCKING POSITION FOR CLIP ASSEMBLY

PORTE-CLIPS SORTIE DROITE
FEMALE MODULE RIGHT WIRE OUTPUT

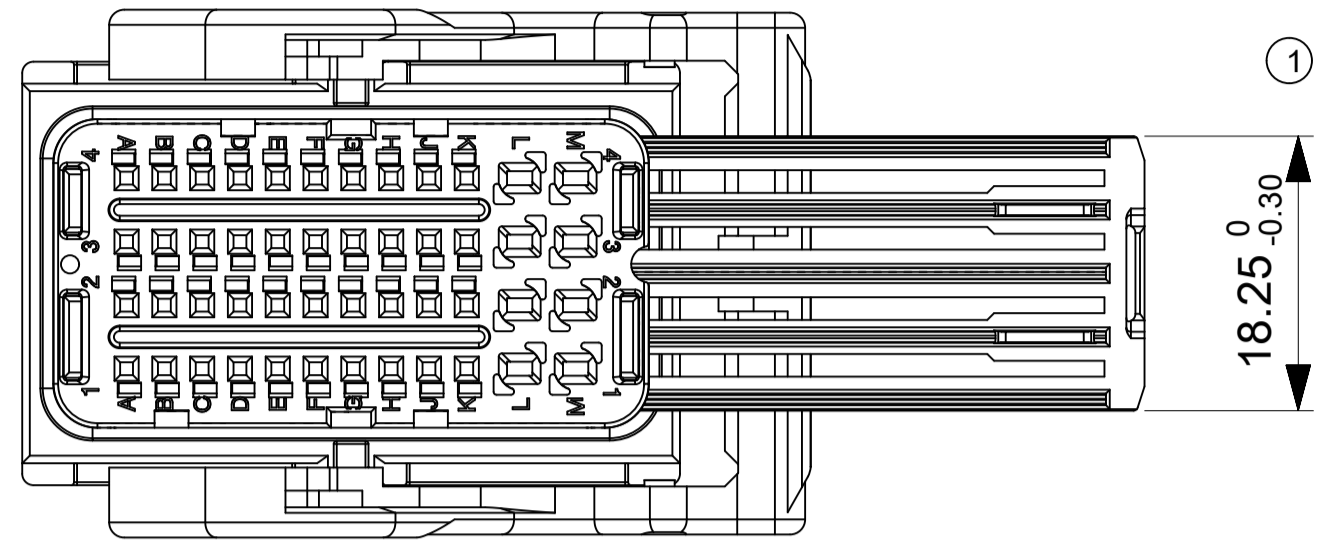

PORTE-CLIPS SORTIE GAUCHE
FEMALE MODULE LEFT WIRE OUTPUT

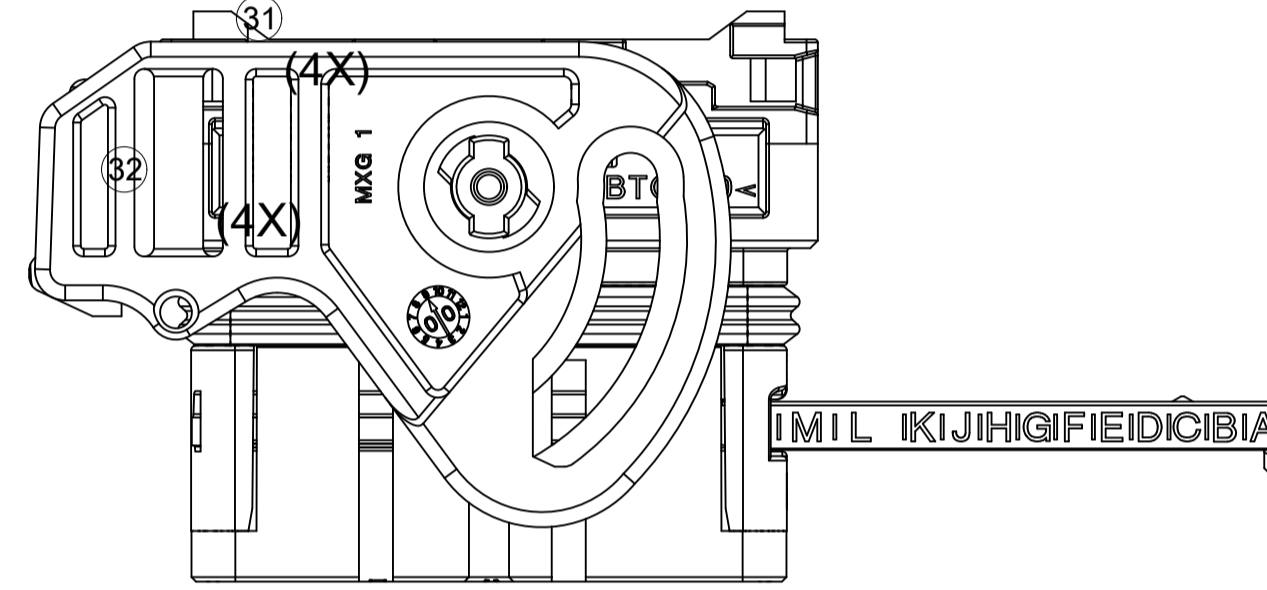
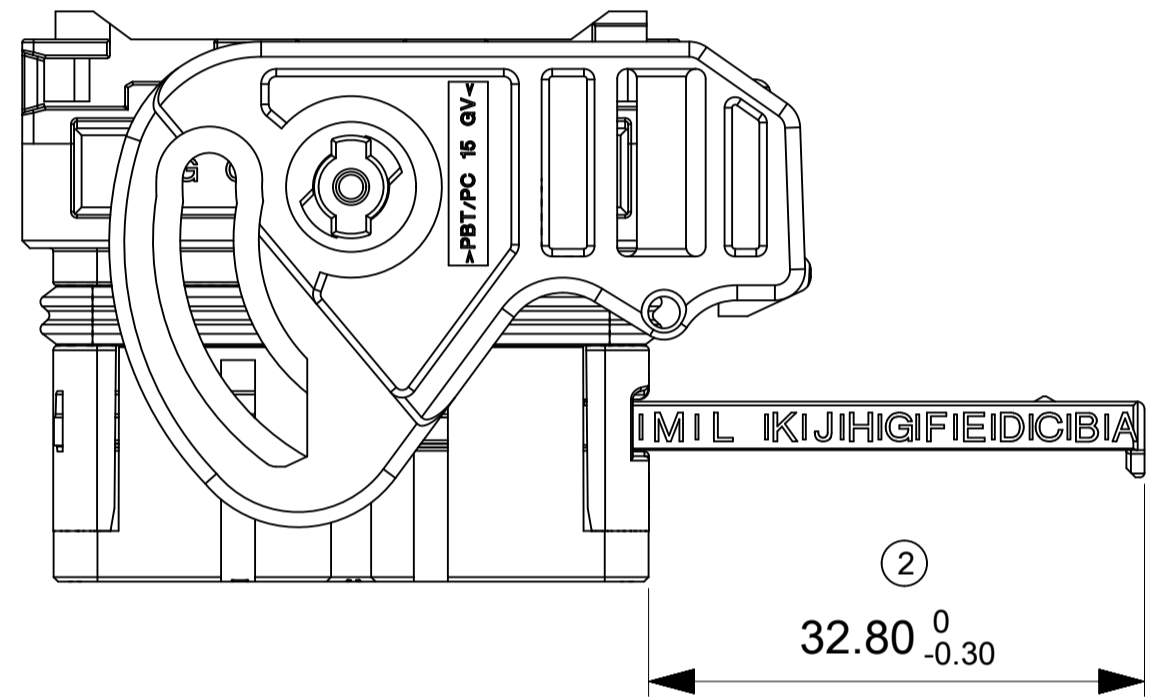
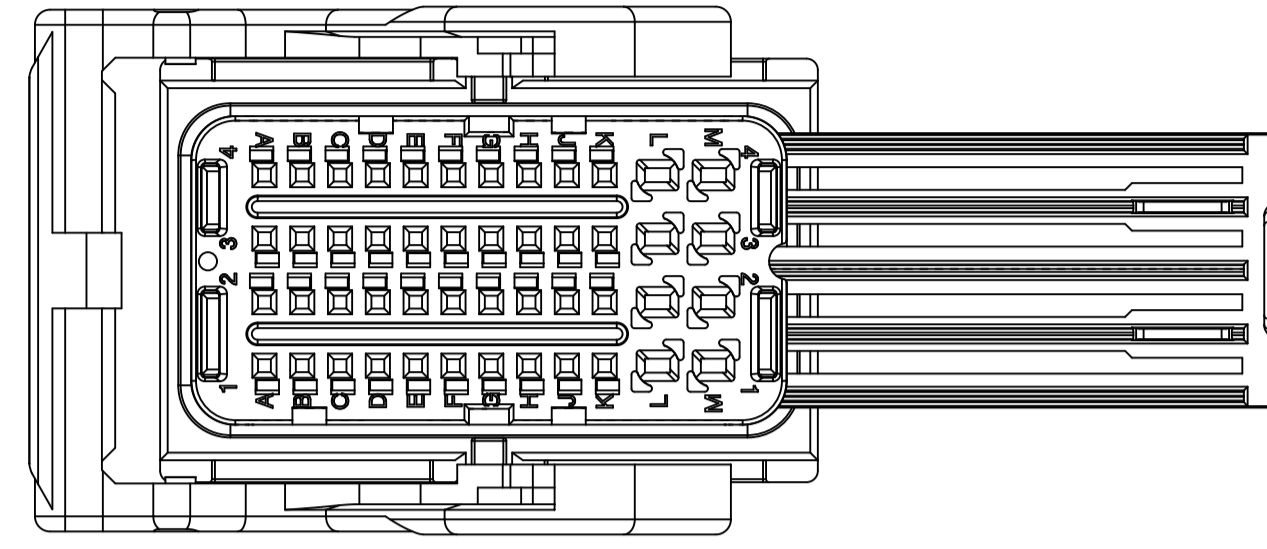

ENCOMBREMENT PORTE-CLIPS D.V. POSITION LIVRAISON
FEMALE MODULE LAYOUT SECONDARY LOCKING IN DELIVERY POSITION

PORTE-CLIPS SORTIE DROITE
FEMALE MODULE RIGHT WIRE OUTPUT

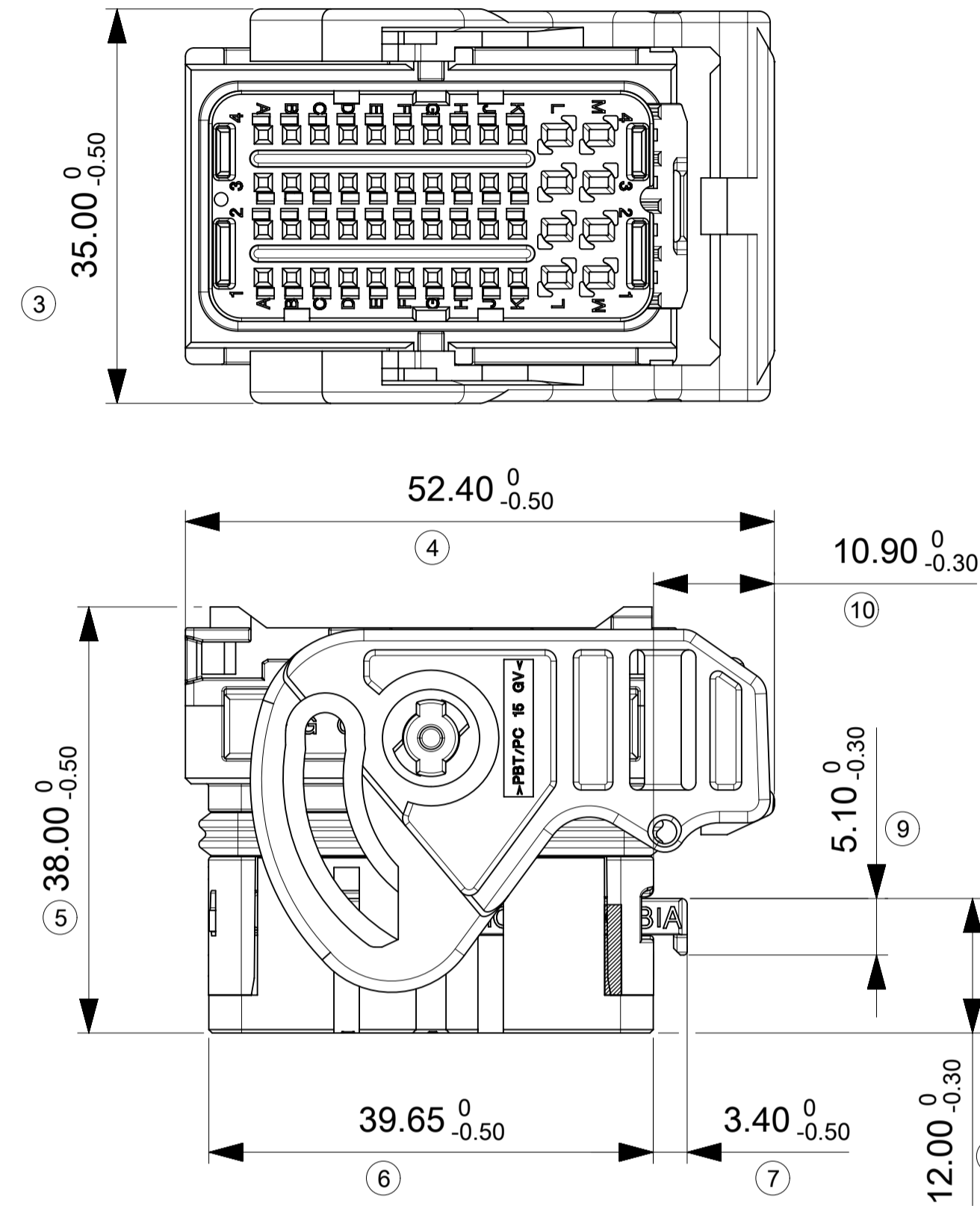

PORTE-CLIPS SORTIE GAUCHE
FEMALE MODULE LEFT WIRE OUTPUT

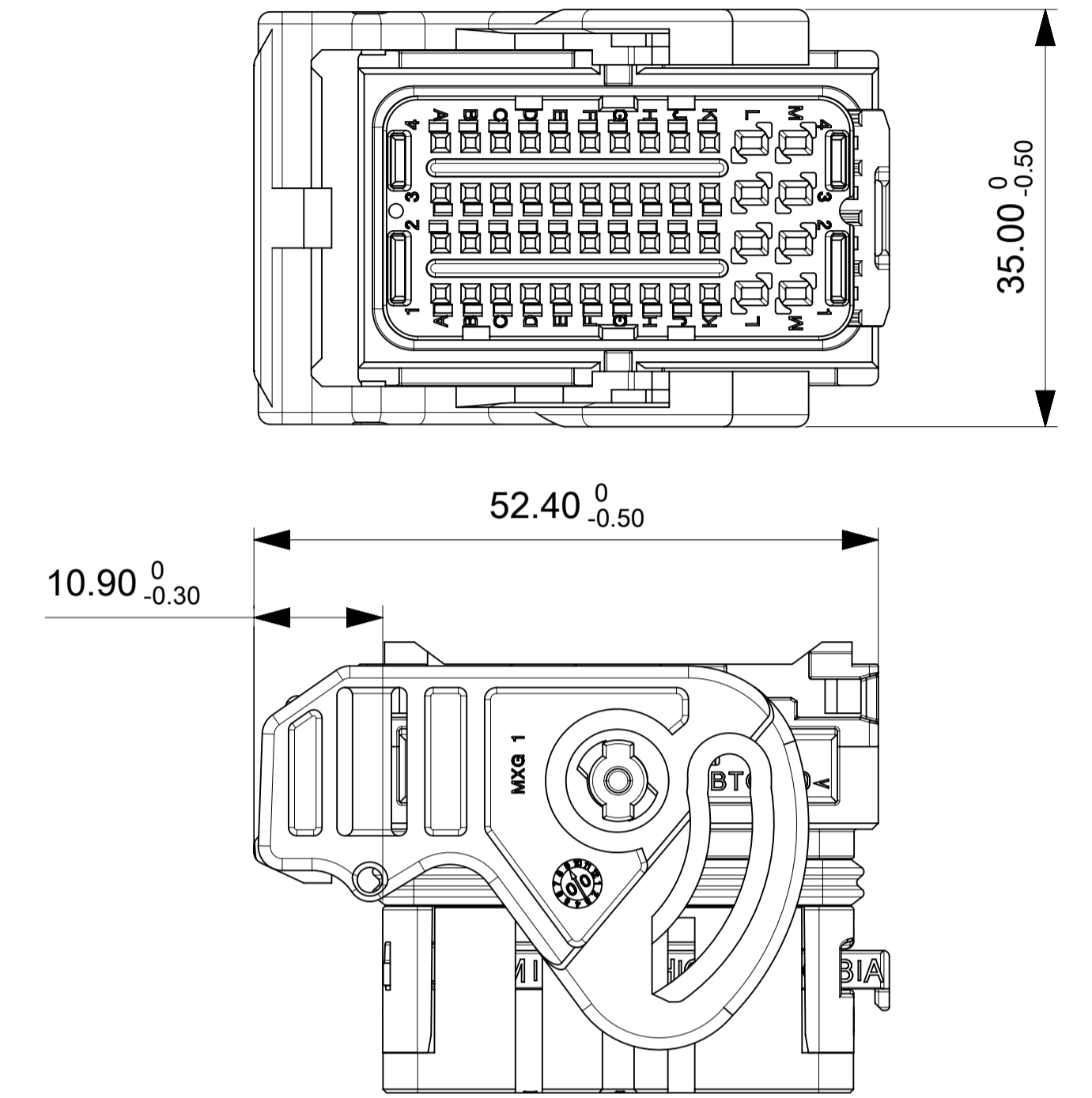

POSITION DES DETROMPAGES
CODING POSITION

COULEUR/COLOUR	DETROMPAGE/CODING	A ₀ ^{+0.10}	B ₀ ^{+0.10}	C ₀ ^{+0.10}	D ₀ ^{+0.10}	E ₀ ^{+0.10}
NOIR/BLACK	1	8.60	6.40	6.40	12.95	2.25
GRIS/GREY	2	12.95	8.60	8.60	10.75	2.25
MARRON/BROWN	3	12.95	12.95	10.75	8.60	2.25
VERT/GREEN	4	6.40	6.40	12.95	10.75	2.25
BLEU/BLUE	5	8.60	8.60	10.75	6.40	2.25

ENCOMBREMENT HORS-TOUT
OVERALL DIMENSION

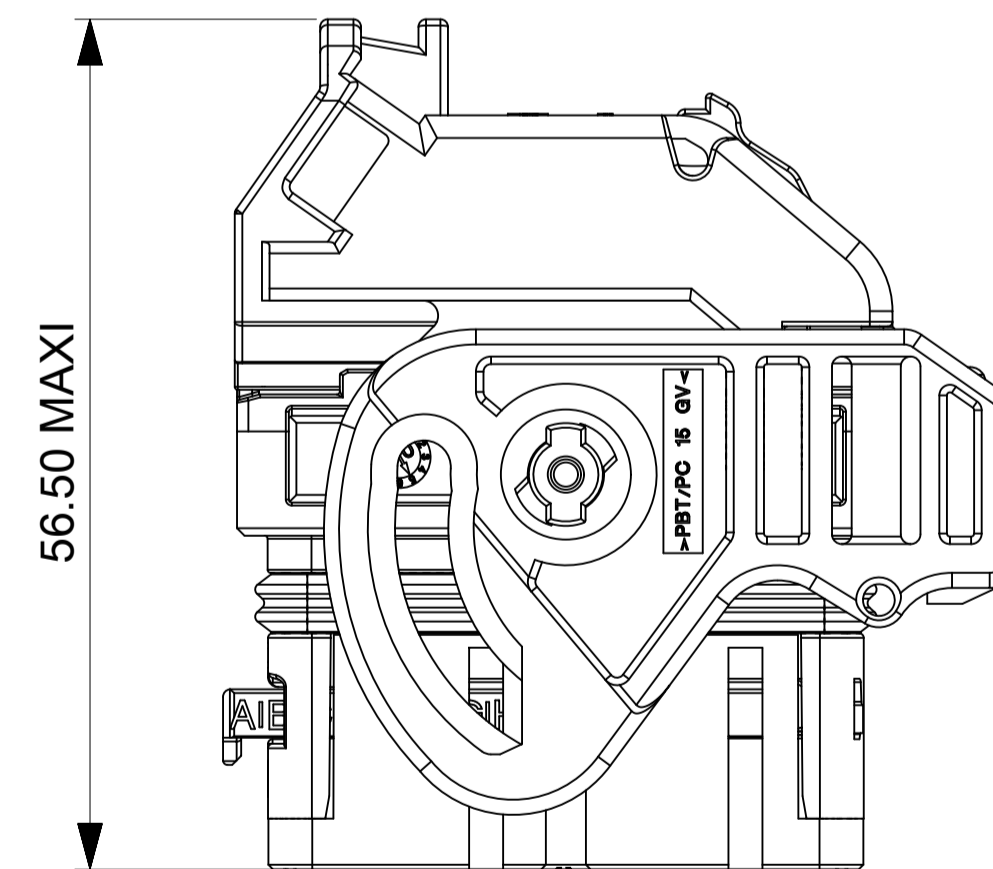

CONTACTS
FEMALE TERMINAL

REPERE ALVEOLES CAVITIES NUMBER	CONTACTS FEMALE TERMINAL	REF. MOLEX MOLEX P/N	DIAMETRE ISOLANT FIL MINI / MAXI MIN / MAX WIRE INSULATION DIAMETER
A1 à K1 A2 à K2 A3 à K3 A4 à K4	CLIP 0.63 (0.35mm2 à 0.60mm2)	0986581211	∅1.25 min / ∅1.90 max
	CLIP 0.63 (0.75mm2)	0986581212	∅1.60 min / ∅1.90 max
L1 à M4 L1 à M4	CLIP 1.5 (0.5mm2 à 1mm2)	0989151029	∅1.40 min / ∅2.15 max
	CLIP 1.5 (> 1mm2 à 2mm2)	0989151039	∅2.25 min / ∅2.65 max

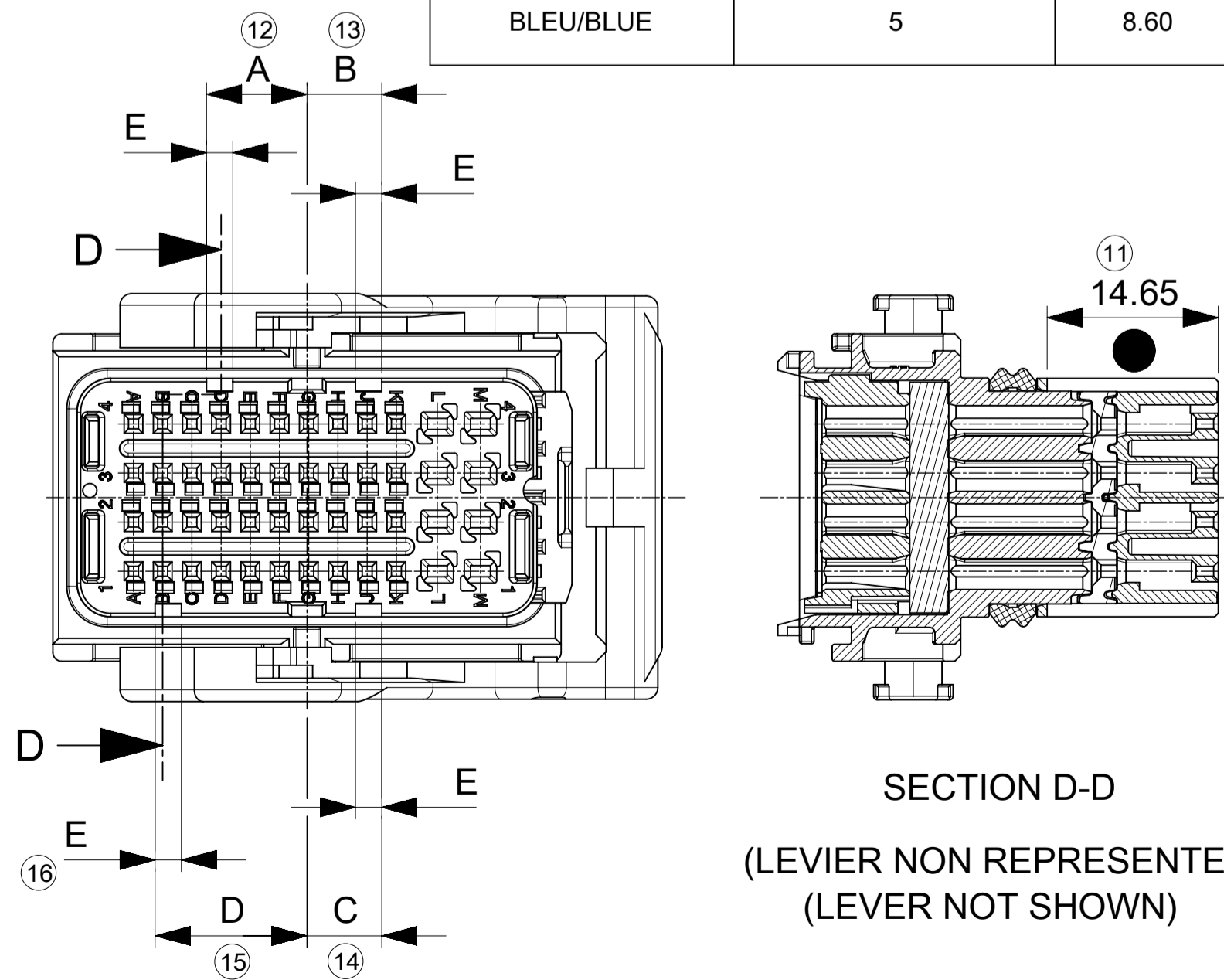

SECTION D-D
(LEVER NON REPRESENTE)
(LEVER NOT SHOWN)

INDICATION DIMENSIONS S.P.C
DENOTES S.P.C DIMENSIONS

INDICATION DIMENSIONS CRITIQUES
DENOTES CRITICAL DIMENSIONS

INDICATION DIMENSIONS FONCTIONNELLES
DENOTES FUNCTIONAL DIMENSIONS

QUANTITE PAR FEUILLE INDIVIDUELLE
QUANTITY PER INDIVIDUAL SHEET

0 0 1

THIS DRAWING CONTAINS INFORMATION THAT IS PROPRIETARY TO MOLEX ELECTRONIC TECHNOLOGIES, LLC AND SHOULD NOT BE USED WITHOUT WRITTEN PERMISSION

DIMENSION UNITS mm	SCALE 2:1	CURRENT REV DESC: OBSOLETE PART NUMBER		molex	
GENERAL TOLERANCES (UNLESS SPECIFIED)		EC NO: 632260	DRWN: VLOKESHA		
4 PLACES ±	±	3 PLACES ±	±	CHK'D: GGA	2020/02/28
2 PLACES ±	0.1	1 PLACE ±	0.15	APPR: GGA	2020/02/28
0 PLACES ±	±	ANGULAR TOL ±	1.0 °	INITIAL REVISION:	
DRAFT WHERE APPLICABLE MUST REMAIN WITHIN DIMENSIONS		FIRST ANGLE PROJECTION	DRAWING	SERIES	2000/02/02
		A1-SIZE	98950	MATERIAL NUMBER	CUSTOMER
		SEE CHART	GENERAL MARKET	SHEET NUMBER	
				2 OF 2	