

# Control cabinet feed-through - VS-BH-M12FS-8CON-RJ45/ 90 - 1405057

Please be informed that the data shown in this PDF Document is generated from our Online Catalog. Please find the complete data in the user's documentation. Our General Terms of Use for Downloads are valid (<http://download.phoenixcontact.com>)



Control cabinet feed-through, M12, 8-pos., A-coded on RJ45 socket, socket input 90°, IP65/67

## Key commercial data

Packing unit	0
Minimum order quantity	1
Catalog page	Page 295 (PC-2011)
GTIN	 4 046356 298544
Custom tariff number	85366990
Country of origin	GERMANY

## Technical data

### Mechanical characteristics

Number of positions	8
Shielded	Yes
Insertion/withdrawal cycles	≥ 100
Color	black
Ambient temperature (operation)	-25 °C ... 85 °C

### Material data

Inflammability class according to UL 94	V0
Housing material	PA
Contact material	Copper alloy
Degree of protection	IP65/67

### Electrical characteristics

Number of positions	8
Nominal voltage UN	50 V
Nominal current IN	1 A
Transmission characteristics (category)	CAT5 (IEC 11801:2002), CAT5e (TIA 568B:2001)
Rated current	1 A

# Control cabinet feed-through - VS-BH-M12FS-8CON-RJ45/ 90 - 1405057

## Classifications

### eclass

eCl@ss 4.0	272607xx
eCl@ss 4.1	27260701
eCl@ss 5.0	27260701
eCl@ss 5.1	27260701
eCl@ss 6.0	27279220
eCl@ss 7.0	27440103

### etim

ETIM 3.0	EC002061
ETIM 4.0	EC002061

### unspsc

UNSPSC 6.01	31261501
UNSPSC 7.0901	31261501
UNSPSC 11	31261501
UNSPSC 12.01	31261501
UNSPSC 13.2	31261501

## Approvals

### Approvals

---

Approvals

GOST

---

Ex Approvals

---

Approvals submitted

---

### Approval details

GOST 
------------------------------------------------------------------------------------------

## Drawings

# Control cabinet feed-through - VS-BH-M12FS-8CON-RJ45/ 90 - 1405057

Dimensioned drawing

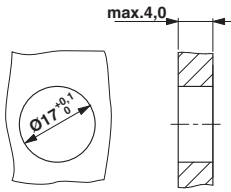

Panel cutout

Dimensioned drawing

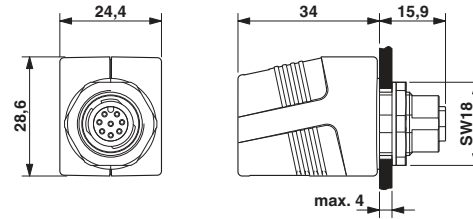

Panel cutout