

RECOMMENDED PANEL CUTOUT  
EMPFOHLENER FRONTPLATTEN AUSSCHNITT

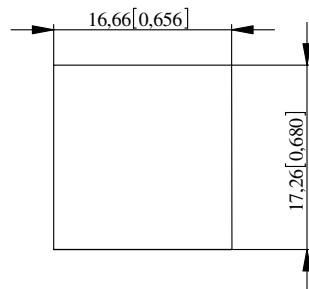

**MATERIALS AND FINISH**

HOUSING: GLASS FILLED POLYESTER UL 94 V-0 BLACK

SHIELDING: Cu ALLOY, PLATED WITH Ni

CONTACTS: PHOSPHOR BRONZE

CONTACT FINISH: Au, 0.8 µm (30 µin) OVER Ni

TERMINAL FINISH: Sn MATTE

LED LENS: EPOXY

**MECHANICAL CHARACTERISTICS**

DURABILITY: 1000 MATING CYCLES

OPERATING TEMPERATURE: 0°C TO 70°C

NOTE 1: RoHS COMPLIANT; PRINT "RC" WITH DATE CODE

NO. IDENT.-NR.	LED 2 LEFT LED 2 LINKS	LED 1 RIGHT LED 1 RECHTS	LED CODE
203342	YELLOW	GREEN	L1
203343	GREEN	YELLOW	L2
203344	GREEN	GREEN	L3
203345	GREEN	RED	L4
203346	ORANGE/GREEN	ORANGE/GREEN	L9

Information: SCHEMATIC NUMBER: M5B01		Tolerances 	Scale 2:1
All rights reserved. Only for Information. To insure that this is the latest version of this drawing, please contact one of the ERNI companies before using.		Subject to modification without prior notice. Drawing will not be updated.	Designation <b>MOD - JACK MJ1MV</b> 1x1,8C10T, VERTICAL, INT.MAG., LED
		www.ERNI.com	<b>203341</b>
A	30.03.2006		1 (1/2)
Index	Date		A3
		Class	MAXMI

Graphic produced in accordance with DIN 34

ELECTRICAL SCHEMATICS 1000 BASE T - M5B01  
ELEKTRISCHER SCHALTPLAN

RECOMMENDED PCB LAYOUT (COMPONENT SIDE VIEW)  
EMPFOHLENES LEITERPLATTEN-LAYOUT (BESTÜCKUNGSSEITE)  
TOL ±0.05 [0.002] UNLESS NOTED

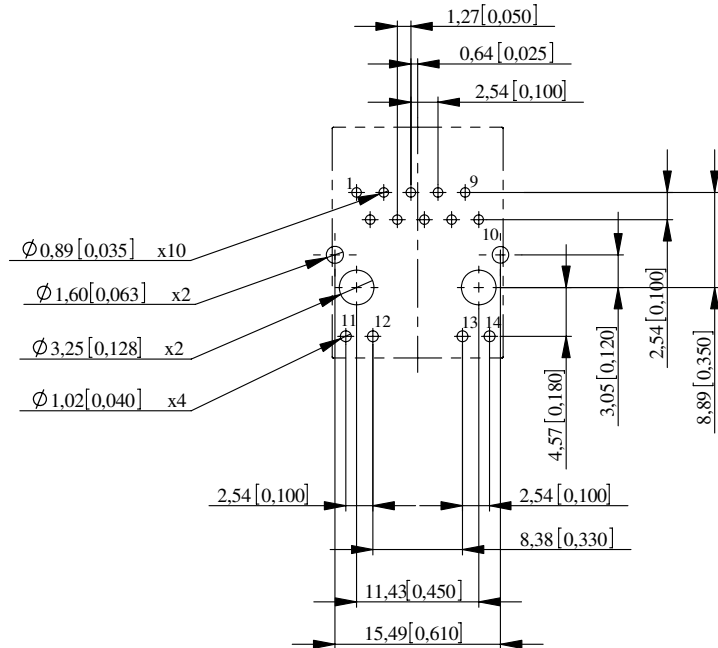

MAGNETICS SPECIFICATIONS @ 25°C  
 TURNS RATIO: 1CT:1CT ±3%  
 OCL(100 KHz, 0.1 V, 8 mA) 350 µH MIN  
 INSERTION LOSS:  
 1-100 MHz -1.1 dB MAX  
 RETURN LOSS:  
 1-40 MHz -18 dB MIN  
 60 MHz -14 dB MIN  
 80 MHz -12 dB MIN  
 100 MHz -10 dB MIN  
 CROSSTALK:  
 1-100 MHz -35 dB TYP  
 CMR:  
 0.1 - 30 MHz -50 dB TYP  
 30 - 60 MHz -40 dB TYP  
 60 - 100 MHz -35 dB TYP  
 ISOLATION 1500 Vrms

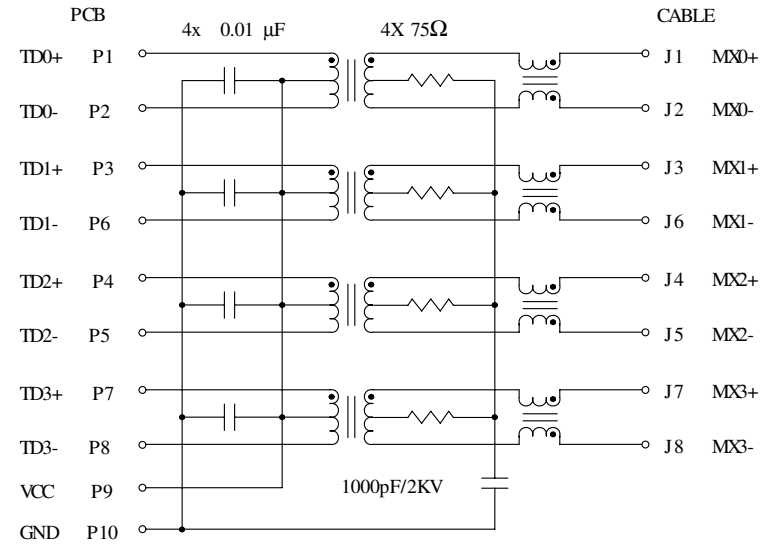

LED SPECIFICATIONS  
LED ANWEISUNG

COLOR FARBE	V <sub>f</sub> TYP	V <sub>f</sub> MAX	I <sub>f</sub> mA	CIRCUIT DIAGRAM SCHALTPLAN
YELLOW	2.1	2.5	20	
GREEN	2.2	2.5	20	
RED	2.25	2.5	20	
ORANGE/GREEN	2.05/2.2	2.5	20	

Information:	Tolerances All Dimensions in mm	Scale 2:1
All rights reserved. Only for Information. To insure that this is the latest version of this drawing, please contact one of the ERNI companies before using.	Subject to modification without prior notice. Drawing will not be updated.	Designation <b>MOD - JACK MJ1MV</b> 1x1,8C10T,VERTICAL,INT.MAG.,LED
www.ERNI.com	203341	1 (2/2) A3
Class		MAXMJ