

REVISIONS					
REV.	DESCRIPTION	ECO	DATE	DRWN	APPD
A	RELEASE TO PRODUCTION.	1418	11/09/09	SC	JAS

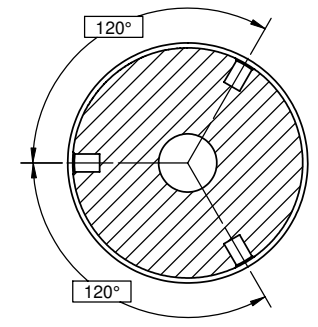

SECTION B-B

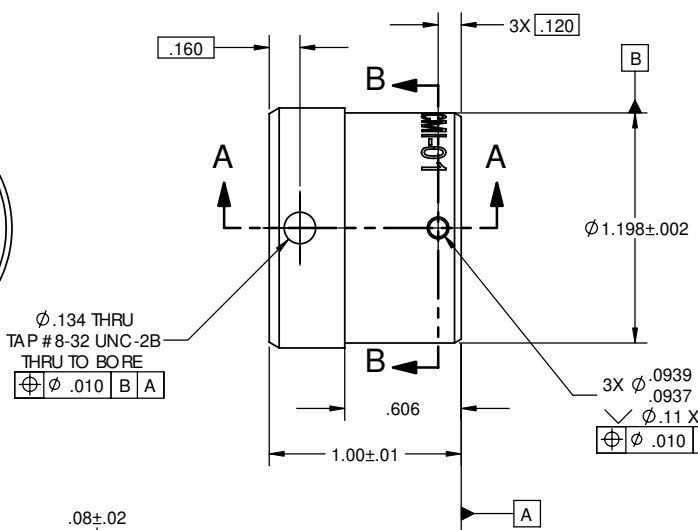
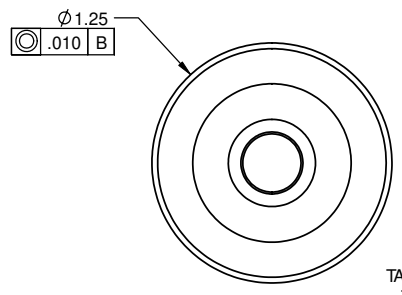
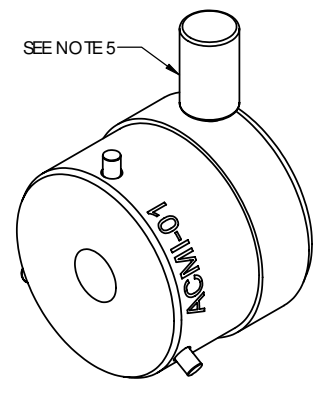
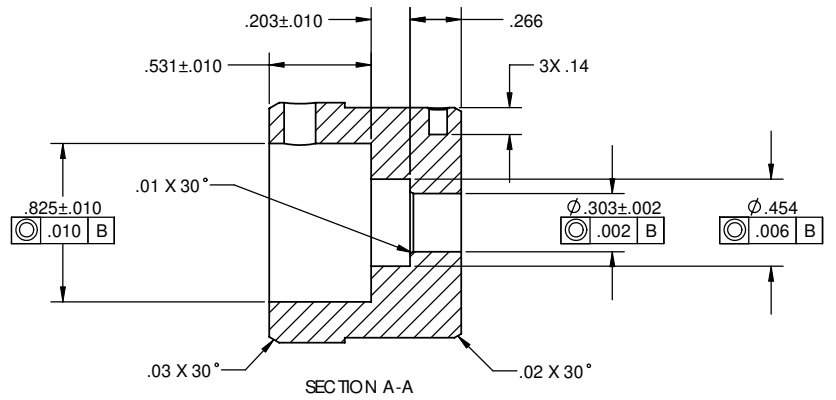
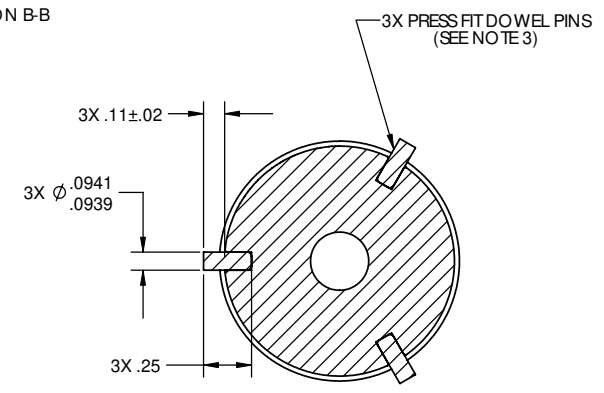
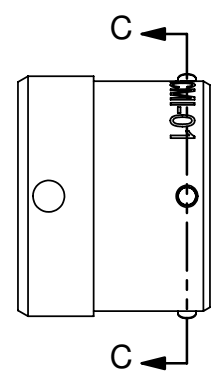
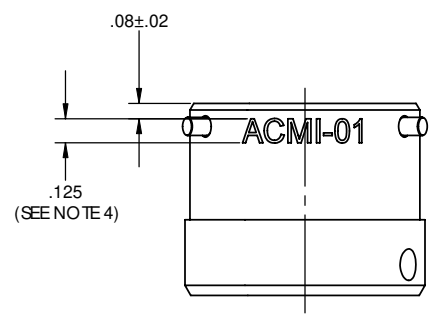

SECTION C-C

NOTES

- MATERIAL: 6061 ALUMINUM.
- FINISH: CLEAR ANODIZED.
- AMERICAN NATIONAL STANDARD HARDENED GROUND MACHINE DOWEL PINS OR APPROVED EQUIVALENT. DOWEL PINS TO BE ZINC PLATED.
- LASER MARKINGS TO BE ARIAL FONT (.125 HIGH), CENTERED BETWEEN 2 DOWEL PINS AS SHOWN WITH RESPECT TO THE # 8-32 TAP.
- THUMB SCREW (OPTO TECHNOLOGY P/N 63MT-0091) TO BE ASSEMBLED INTO # 8-32 TAP AS SHOWN.
- PART TO BE FREE OF BURRS, SHARP EDGES AND FOREIGN MATERIAL.
- UNLESS OTHERWISE SPECIFIED ALL FEATURES SHALL HAVE A PROFILE TOLERANCE OF .010 ALL OVER WITH RESPECT TO DATUMS A & B.
- PART MUST BE ROHS COMPLIANT PER EUROPEAN UNION 2002/95/EC.
- SEE CAD MODEL 64MT-0533_A_STEP FOR ADDITIONAL DIMENSIONS.

PROPRIETARY AND CONFIDENTIAL
THE INFORMATION CONTAINED IN THIS DRAWING IS THE SOLE PROPERTY OF OPTO TECHNOLOGY INC. ANY REPRODUCTION IN PART OR AS A WHOLE WITHOUT THE WRITTEN PERMISSION OF OPTO TECHNOLOGY INC. IS PROHIBITED.

UNLESS OTHERWISE SPECIFIED:		NAME	DATE	OPTO TECHNOLOGY INC. 160 E. Marquardt Drive, Wheeling IL 60090	
DIMENSIONS ARE IN INCHES	TOLERANCES	DRAWN	SC	04/13/09	TITLE ADAPTOR .299" DIA X .354" LG FERRULE (ACMI-01)
ANGULAR ± 1 DEG	TWO PLACE DECIMAL ±.010	CHECKED	JAS	10/15/09	
THREE PLACE DECIMAL ±.005		ENG APPR	JAS	10/15/09	
MATERIAL	FINISH	COMMENTS		DIMENSIONS APPLIED AFTER PLATING.	
APPLICATION	DO NOT SCALE DRAWING			SIZE C	DWG. NO. 64MT-0533
				SCALE 2:1	WEIGHT:
				SHEET 1 OF 1	