

PART NUMBER	TAIL PLATING	TAIL TYPE
10116519-001LF	Sn	PRESS-FIT

NOTE 5

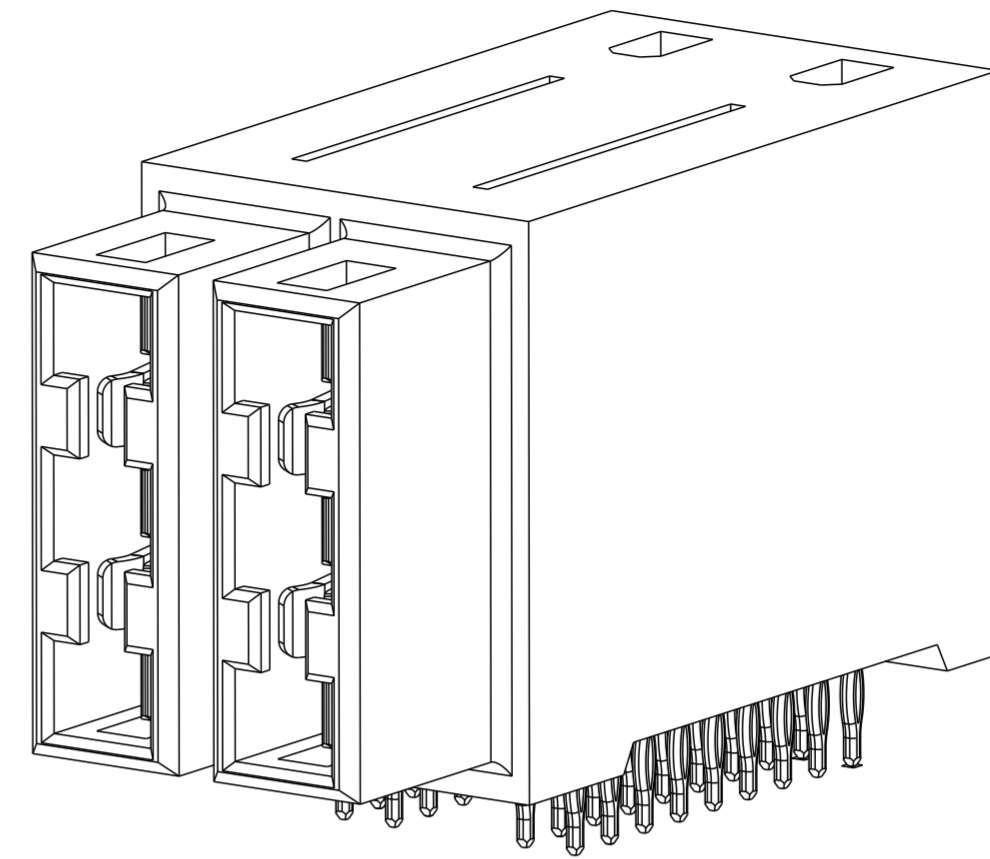
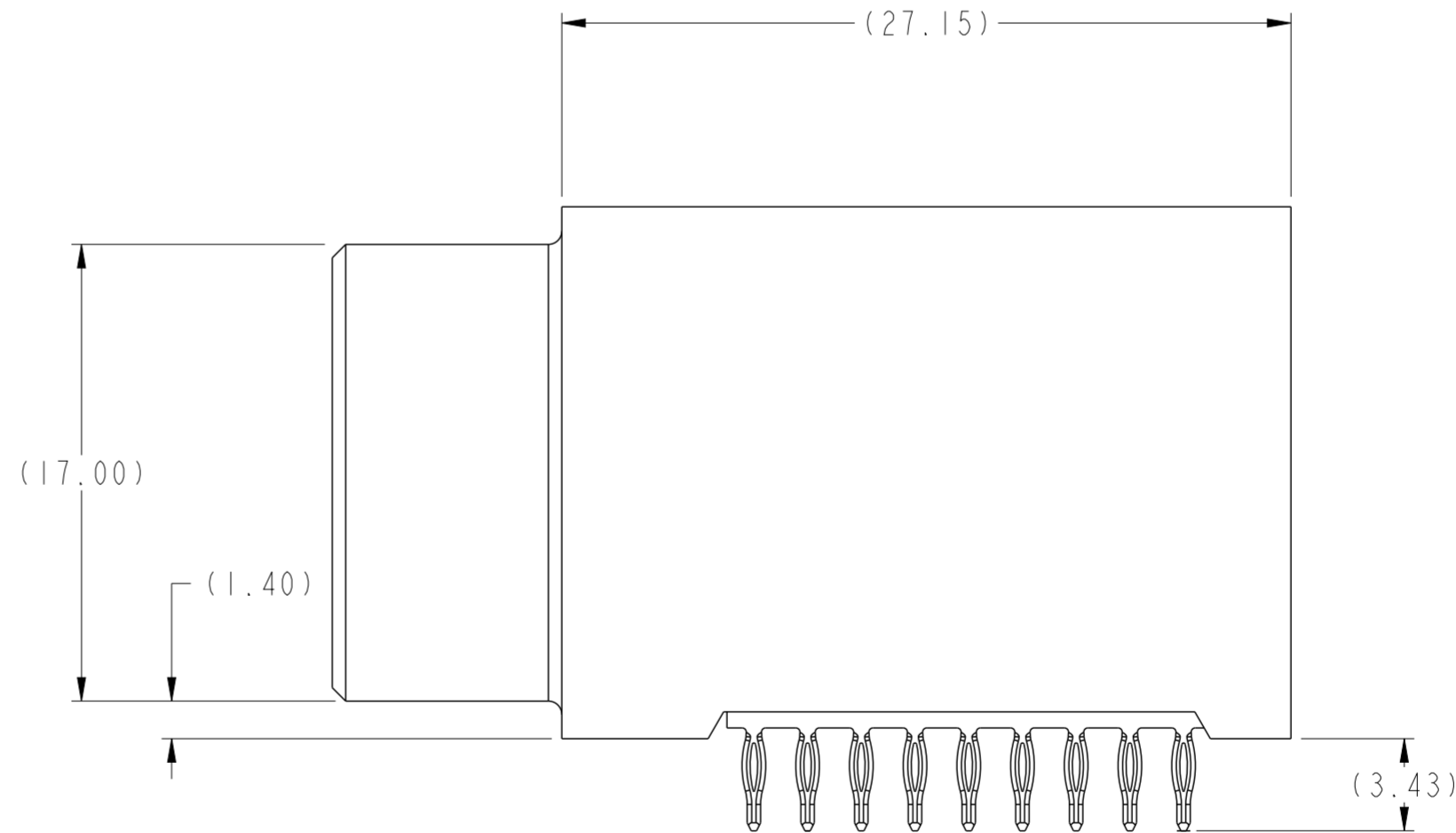
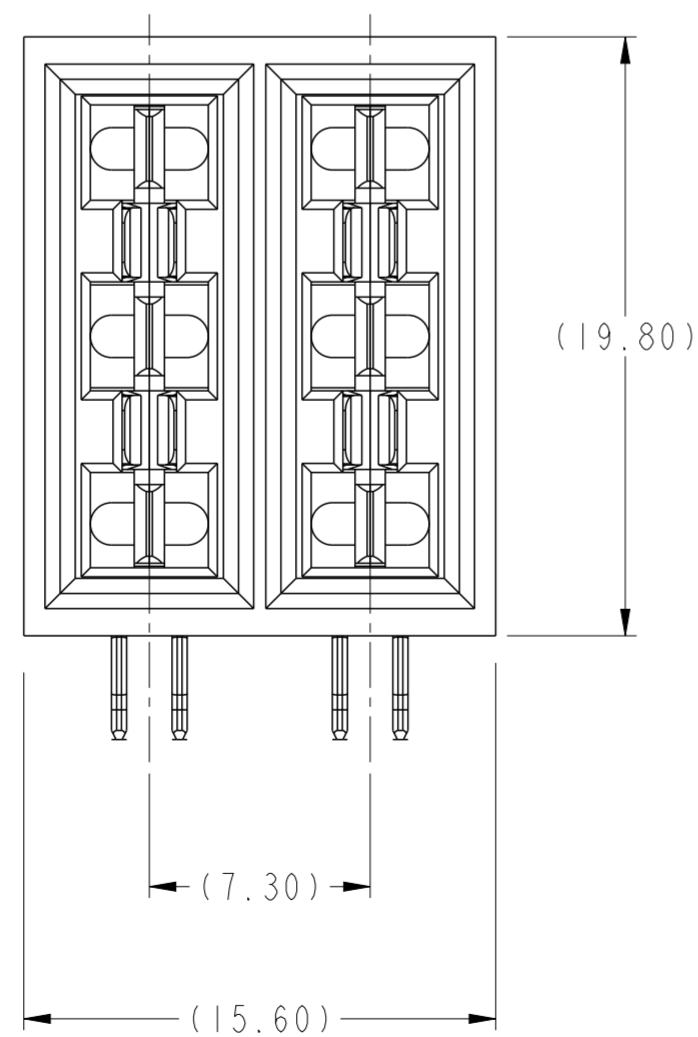
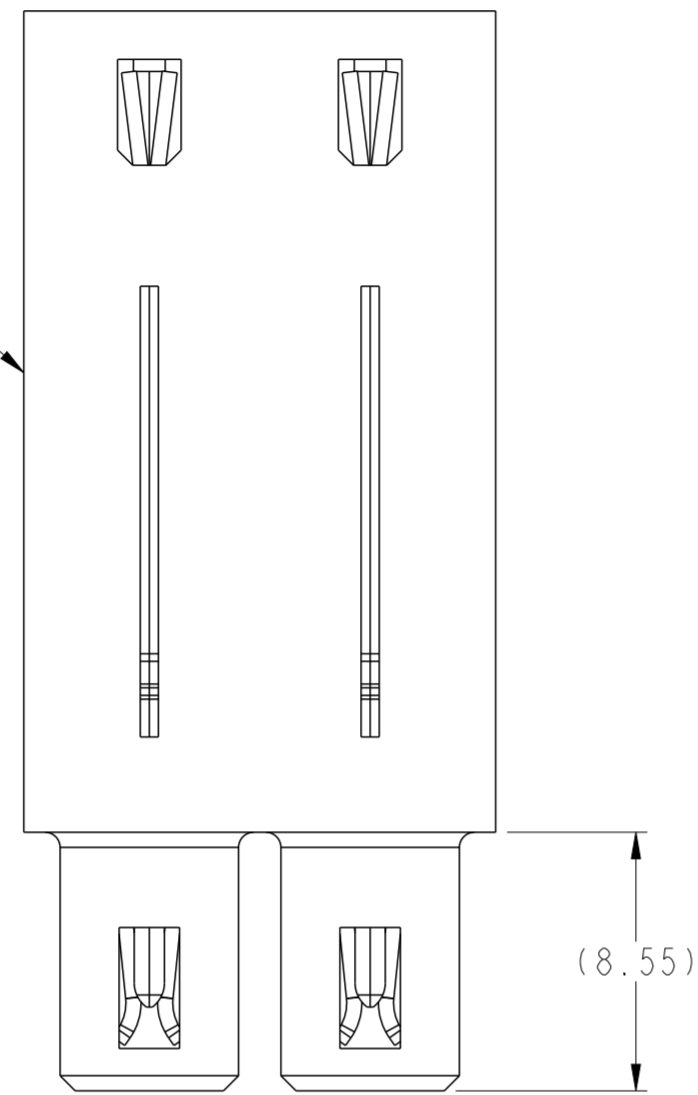

spec ref	-	dr	Ares Liu	2010/12/29	projection	MM	size	A2	scale	4:1							
tolerance std	-	eng	Walker Wei	2018/05/24			ecn no	ELX-DG-30266-1	rel level Released								
-	-	chr	Rainbow Zhan	2018/07/05			product family	HCI									
-	-	appr	Zheng, Pei-Min	2018/07/06			cat. no.	-		Product - Customer Drw	sheet 1 of 2						
surface	<table border="1"> <tr> <td>linear</td> <td>0.X</td> <td>±0.5</td> </tr> <tr> <td></td> <td>0.XX</td> <td>±0.30</td> </tr> <tr> <td></td> <td>0.XXX</td> <td>±0.10</td> </tr> <tr> <td>angular</td> <td>0°</td> <td>±2°</td> </tr> </table>	linear	0.X	±0.5		0.XX	±0.30		0.XXX	±0.10	angular	0°	±2°		title ASSEMBLY, RECEPT, R/A 2 POSN ISOLATED POWER CONTACT	dwg no 10116519	rev C
linear	0.X	±0.5															
	0.XX	±0.30															
	0.XXX	±0.10															
angular	0°	±2°															

TOP LAYER DESCRIPTION	TABLE 1 (HCl POWER) PLATED THROUGH-HOLE REQUIREMENTS							
	DRILLED HOLE DIAMETER	COPPER THICKNESS	TIN-LEAD THICKNESS	NICKEL THICKNESS	GOLD THICKNESS	TIN THICKNESS	SILVER THICKNESS	FINISHED HOLE DIAMETER
TIN-LEAD	0.81-0.86 (0.85 DRILL)	0.025 - 0.050	0.005 - 0.015	-	-	-	-	0.65 - 0.80
IMMERSION TIN	0.81-0.86 (0.85 DRILL)	0.025 - 0.050	-	-	-	0.9 - 1.5um	-	0.70 - 0.80
IMMERSION SILVER	0.81-0.86 (0.85 DRILL)	0.025 - 0.050	-	-	-	-	0.15 - 0.65um	0.70 - 0.80
COPPER (SEE NOTE 9)	0.81-0.86 (0.85 DRILL)	0.025 - 0.050	-	-	-	-	-	0.70 - 0.80
GOLD	0.81-0.86 (0.85 DRILL)	0.025 - 0.050	-	0.003 - 0.007	FLASH UP TO 0.0002	-	-	0.69 - 0.80

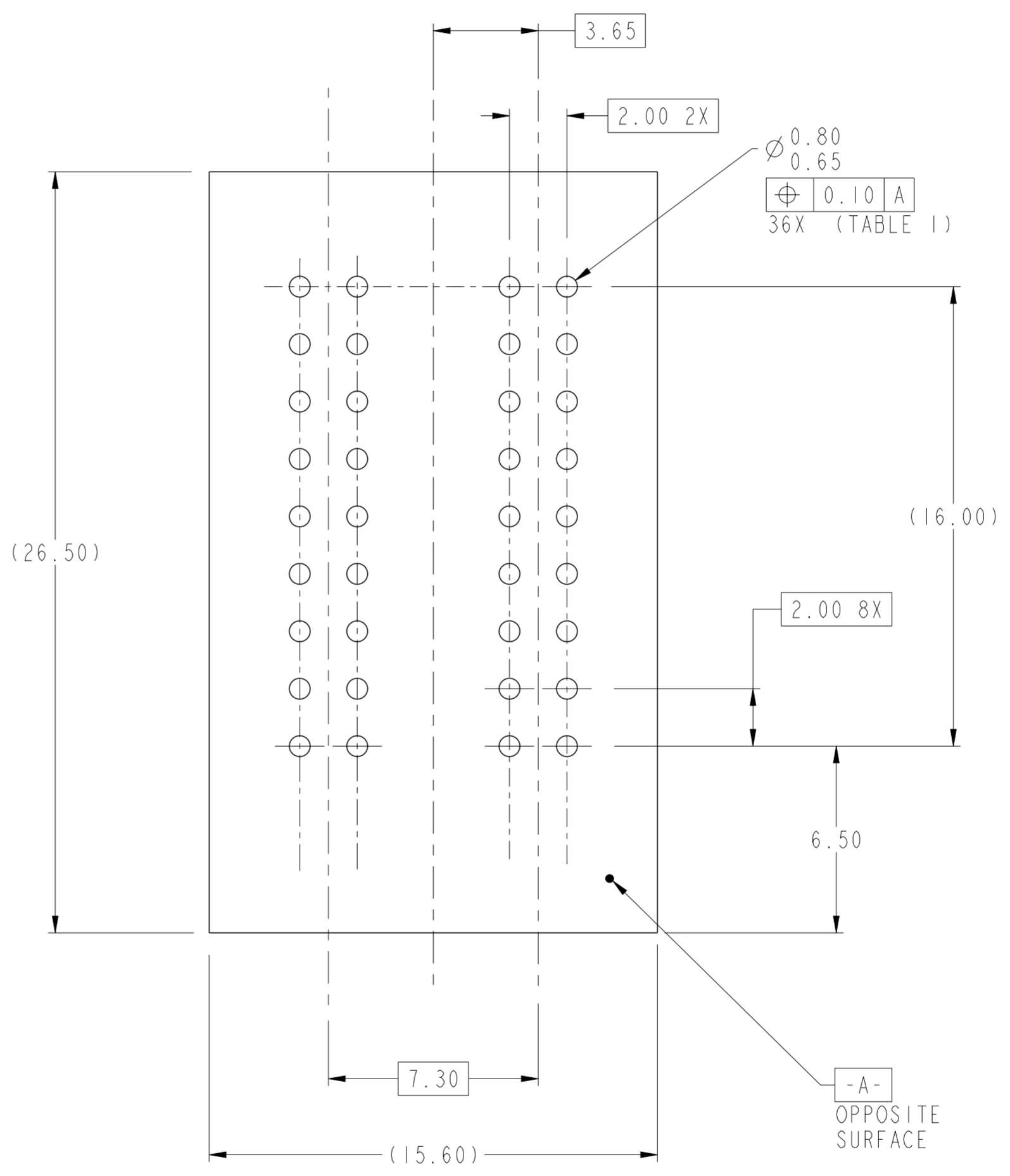

- NOTES:
- CONNECTOR MATERIALS:
HOUSING: HIGH TEMPERATURE THERMOPLASTIC, BLACK
UL 94V-0 COMPLIANT
CONTACTS: HIGH PERFORMANCE COPPER ALLOY
 - CONTACT FINISH (ref GS-12-380 SECTION 5.2)
 - PRODUCT SPECIFICATION: GS-12-380.
 - APPLICATION SPECIFICATION: GS-20-070.
 - PRODUCT MARKING (PRODUCT NUMBER & DATE CODE) ON HOUSING IN AREA SHOWN.
 - MINIMUM NOMINAL PCB THICKNESS: 1.6mm
 - PACKAGING MEETS FCI SPECIFICATION GS-14-1073.
 - HOUSING COMPONENT WILL WITHSTAND EXPOSURE TO 260°C PEAK TEMPERATURE FOR 10-30 SECONDS IN A CONVECTION, INFRA-RED, OR VAPOR PHASE REFLOW OVEN.
 - COPPER PLATING THICKNESS IN CENTER OF VIA-HOLE CAN BE NO MORE THAN 0.003 LESS THAN OTHER AREAS.
 - ALL HOLE SIZES ARE FINISHED HOLE SIZES.
 - MOUNTING HOLES ARE UNPLATED.
 - A \triangle SYMBOL WILL BE NEXT TO ANY DIMENSION, VIEW, OR NOTE WHICH HAS BEEN MODIFIED WITH THE CURRENT DRAWING REVISION

RECOMMENDED PCB LAYOUT
COMPONENT SIDE
SCALE 6:1

spec ref	-	dr	Ares Liu	2018/12/29	projection	MM	size	A2	scale	4:1	
tolerance std	-	eng	Walker Wei	2018/05/24			ecn no	ELX-DG-30266-1	rel level	Released	
	TOLERANCES UNLESS OTHERWISE SPECIFIED	chr	Rainbow Zhan	2018/07/05							
		appr	Zheng, Pei-Min	2018/07/06							
surface	linear	0.X	±0.5		product family HCl	title ASSEMBLY, RECEPT, R/A 2 POSN ISOLATED POWER CONTACT	dwg no 10116519	rev C	cat. no.	Product - Customer Drw	sheet 2 of 2
		0.XX	±0.30								
		0.XXX	±0.10								
	angular	0°	±2°								

Amphenol FCI

© 2016 AFCl