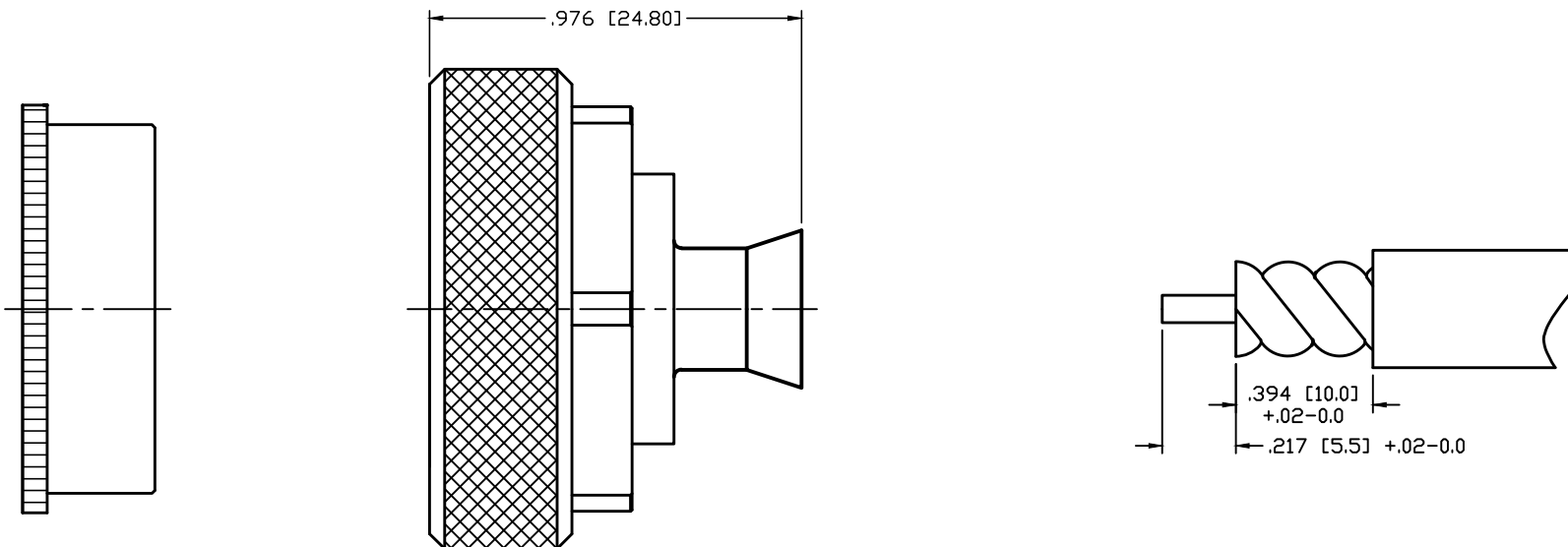

PART NO.

RFD-1601-HPL

REV	DESCRIPTION	DWN	DATE	APPROVED
-	ENGINEERING RELEASE	CZS	02/20/14	JDMc

CUSTOMER
OUTLINE DRAWINGALL DIMENSIONS
ARE REFERENCE ONLYUNLESS OTHERWISE SPECIFIED:
DIMENSIONS ARE IN INCHES
AND [MILLIMETERS]**RoHS
COMPLIANT**

PROPRIETARY AND CONFIDENTIAL
THIS DRAWING CONTAINS
INFORMATION PROPRIETARY TO
RF INDUSTRIES. ANY
UNAUTHORIZED USE OF THIS
DRAWING IS EXPRESSLY
PROHIBITED WITHOUT WRITTEN
PERMISSION FROM RF
INDUSTRIES. ANY VIOLATION IS
PUNISHABLE UNDER U.S.
COPYRIGHT LAWS.

RFconnectors7610 MIRAMAR RD.
SAN DIEGO, CA 92126
(858) 549-6340
DIVISION OF RF INDUSTRIES, LTD. (858) 549-6345 FAX**7/16 DIN PLUG**
FOR SSP250

#	DESCRIPTION	QTY	MATERIAL	FINISH
5	SHELL	1	BRASS	WHITE BRONZE
4	GASKET	1	RUBBER	----
3	PIN	1	BRASS	WHITE BRONZE
2	INSULATOR	1	PTFE	----
1	BODY	1	BRASS	WHITE BRONZE

DRAWN	C. ZUNIGA	02/20/14
CHECKED		
ORJ DRAWN	C. ZUNIGA	02/20/14

SIZE	CABLE GROUP	DWG NO.	REV
A	N/A	RFD-1601-HPL	—
SCALE:	ENGINEERING ID:	SHEET 1 OF 1	
NTS	001787		